



# ORACLE LIGHTING

## FORD F-150 TAIL LIGHTS

ORACLE PART #5910

### INSTALLATION GUIDE

**TOOLS NEEDED:**  
PHILLIPS HEAD SCREWDRIVER  
T-15 TORX BIT  
8MM SOCKET  
SOCKET WRENCH

## STEP: 1

SCAN QR CODE TO  
WATCH THE VIDEO

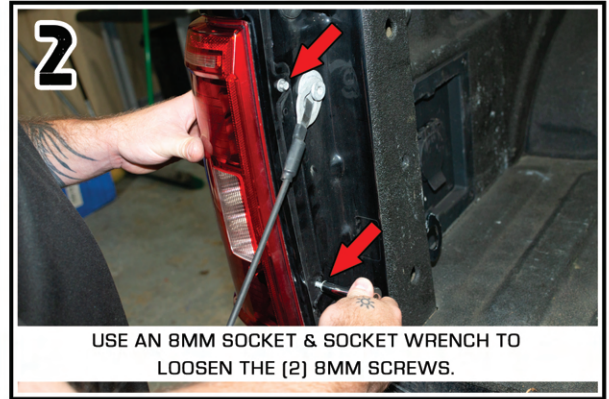

USE AN 8MM SOCKET & SOCKET WRENCH TO LOOSEN THE (2) 8MM SCREWS.

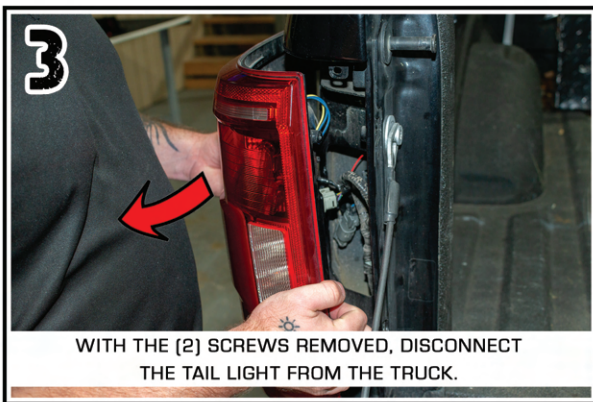

WITH THE (2) SCREWS REMOVED, DISCONNECT THE TAIL LIGHT FROM THE TRUCK.

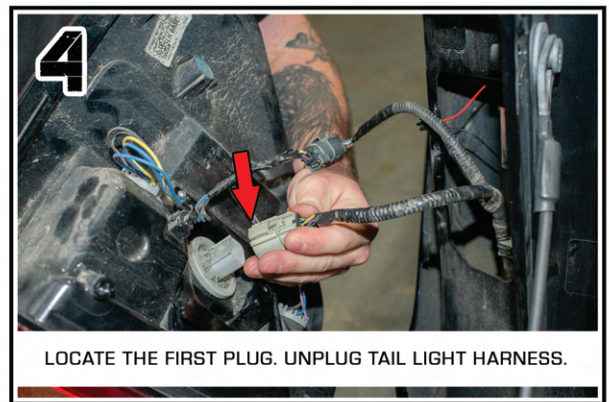

LOCATE THE FIRST PLUG. UNPLUG TAIL LIGHT HARNESS.

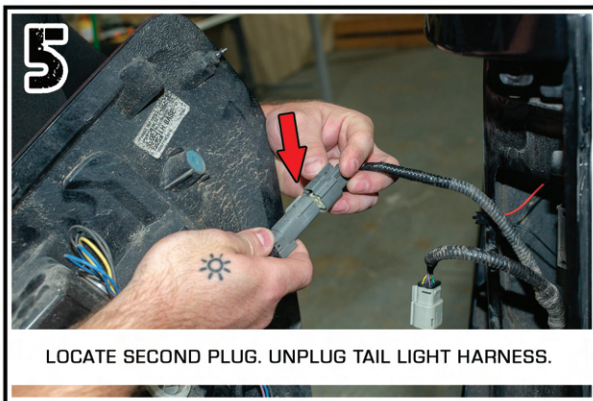

LOCATE SECOND PLUG. UNPLUG TAIL LIGHT HARNESS.

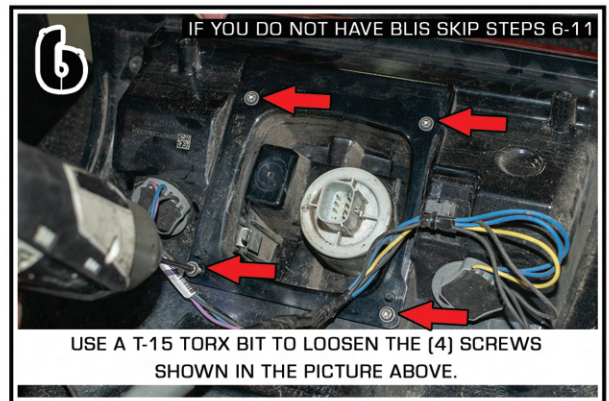

IF YOU DO NOT HAVE BLIS SKIP STEPS 6-11  
USE A T-15 TORX BIT TO LOOSEN THE (4) SCREWS SHOWN IN THE PICTURE ABOVE.

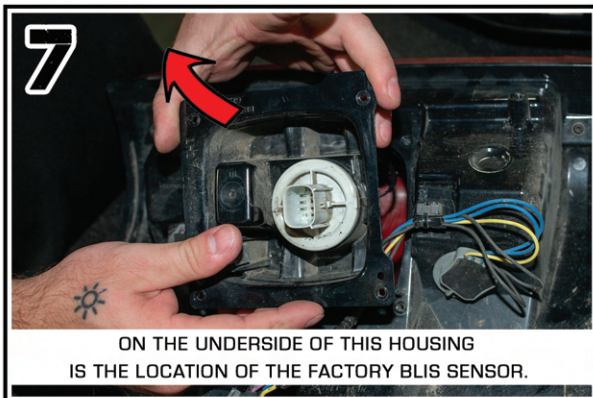

ON THE UNDERSIDE OF THIS HOUSING IS THE LOCATION OF THE FACTORY BLIS SENSOR.

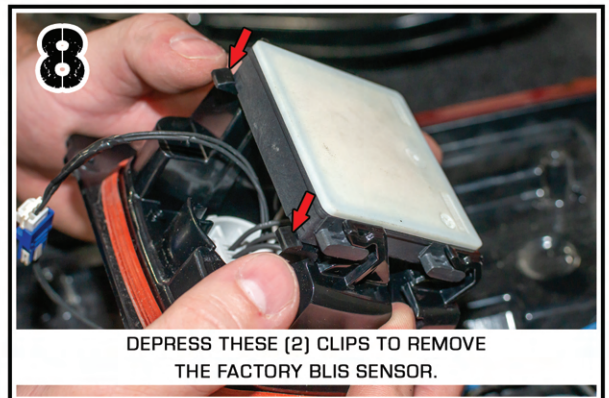

DEPRESS THESE (2) CLIPS TO REMOVE THE FACTORY BLIS SENSOR.



# ORACLE LIGHTING

## FORD F-150 TAIL LIGHTS

### ORACLE PART #5910

### INSTALLATION GUIDE

**TOOLS NEEDED:**  
PHILLIPS HEAD SCREWDRIVER  
T-15 TORX BIT  
8MM SOCKET  
SOCKET WRENCH

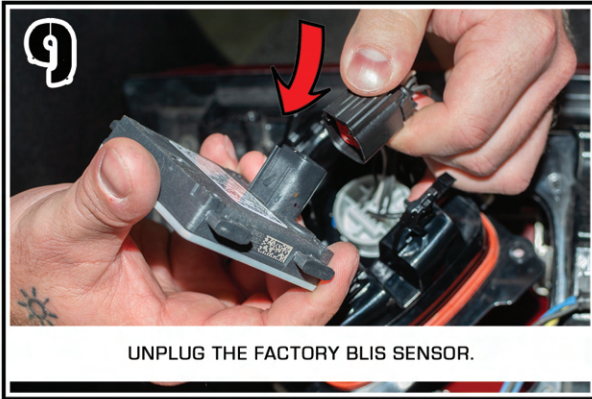

UNPLUG THE FACTORY BLIS SENSOR.

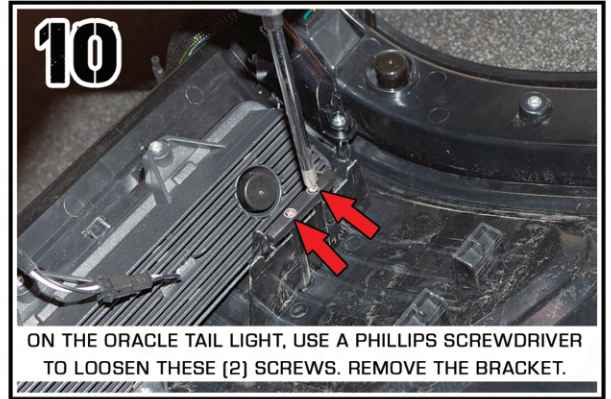

ON THE ORACLE TAIL LIGHT, USE A PHILLIPS SCREWDRIVER TO LOOSEN THESE (2) SCREWS. REMOVE THE BRACKET.

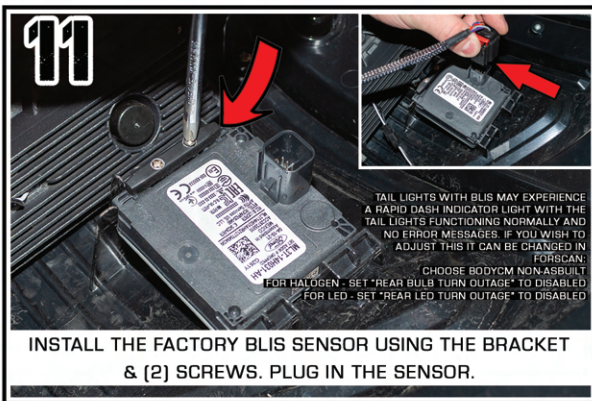

INSTALL THE FACTORY BLIS SENSOR USING THE BRACKET & (2) SCREWS. PLUG IN THE SENSOR.

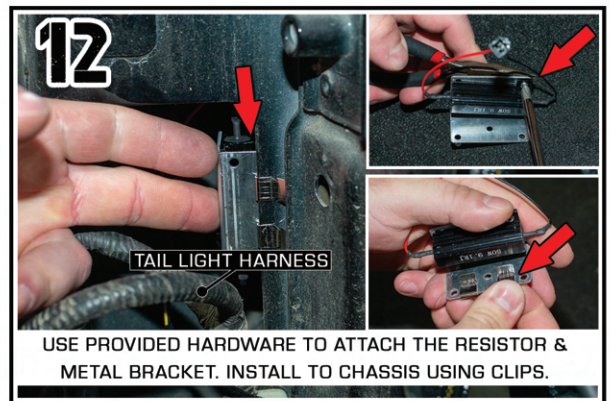

USE PROVIDED HARDWARE TO ATTACH THE RESISTOR & METAL BRACKET. INSTALL TO CHASSIS USING CLIPS.



PLUG IN ORACLE TAIL LIGHT TO FACTORY HARNESS.



PLUG IN ORACLE TAIL LIGHT TO FACTORY HARNESS.

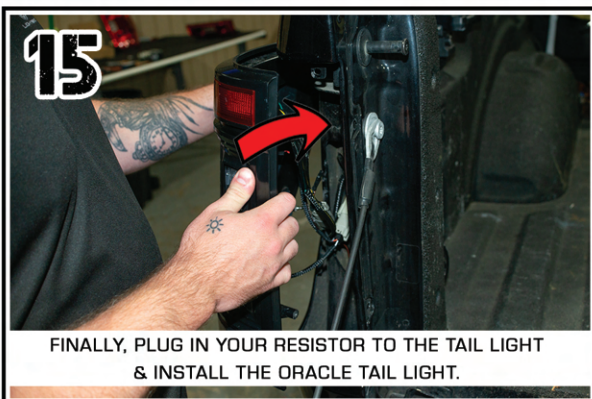

FINALLY, PLUG IN YOUR RESISTOR TO THE TAIL LIGHT & INSTALL THE ORACLE TAIL LIGHT.



USE AN 8MM SOCKET & SOCKET WRENCH TO TIGHTEN THE (2) 8MM SCREWS.