



ORACLE LIGHTING

F-250/350 FLUSH TAIL LIGHTS

ORACLE PART #5896-504

INSTALLATION GUIDE

TOOLS NEEDED:
7MM & 8MM SOCKET
SOCKET WRENCH
T-20 TORX BIT

STEP: 1

WATCH THE VIDEO
SCAN QR OR VISIT:

WWW.VIMEO.COM/770886826

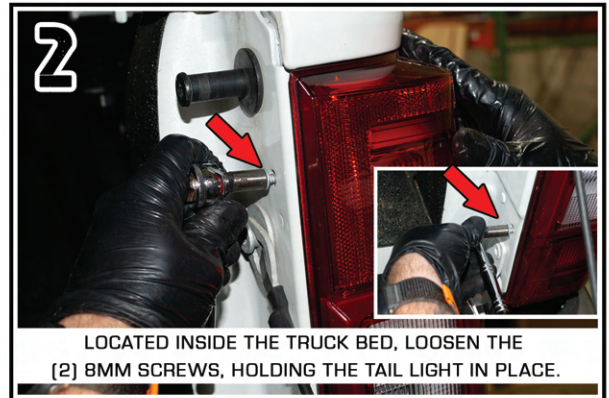

LOCATED INSIDE THE TRUCK BED, LOOSEN THE (2) 8MM SCREWS, HOLDING THE TAIL LIGHT IN PLACE.



REMOVE TAIL LIGHT FROM VEHICLE. BE SURE TO CAREFULLY DISENGAGE SIDE BODY CLIPS.



UNPLUG FACTORY HARNESS FROM THE TAIL LIGHT.

5

IF YOUR TAIL LIGHTS HAVE FACTORY BLIS SENORS INSTALLED, VIEW NEXT PAGE. IF NOT, THEN CONTINUE TO STEP 6.



PLUG IN ORACLE FLUSH TAIL LIGHT TO FACTORY HARNESS.

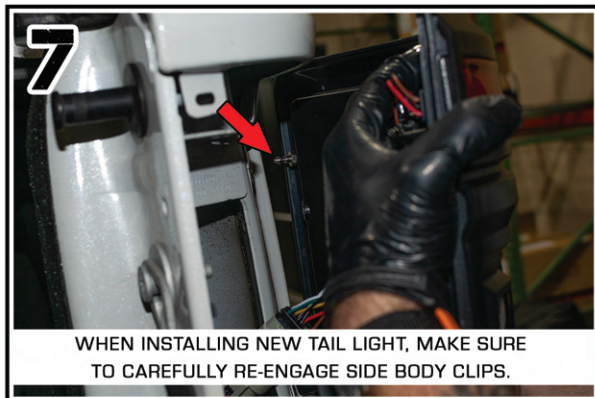

WHEN INSTALLING NEW TAIL LIGHT, MAKE SURE TO CAREFULLY RE-ENGAGE SIDE BODY CLIPS.



WITH NEW TAIL LIGHT IN PLACE, TIGHTEN THE (2) 8MM SCREWS. REPEAT THE FULL PROCESS ON OTHER TAIL LIGHT.



ORACLE LIGHTING

F-250/350 FLUSH TAIL LIGHTS

ORACLE PART #5896-504

INSTALLATION GUIDE

TOOLS NEEDED:
7MM & 8MM SOCKET
SOCKET WRENCH
T-20 TORX BIT

STEP: 1

WATCH THE VIDEO
SCAN QR OR VISIT:

WWW.VIMEO.COM/770886826

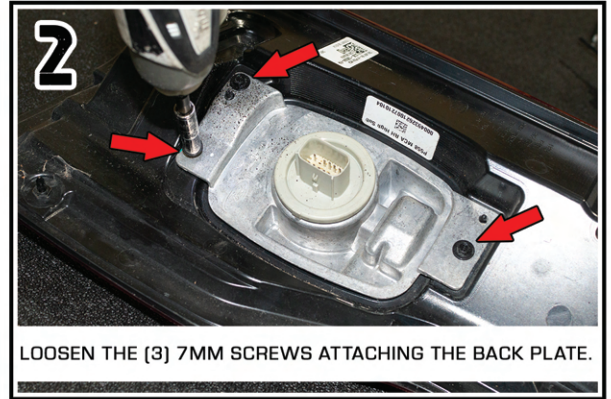

LOOSEN THE [3] 7MM SCREWS ATTACHING THE BACK PLATE.

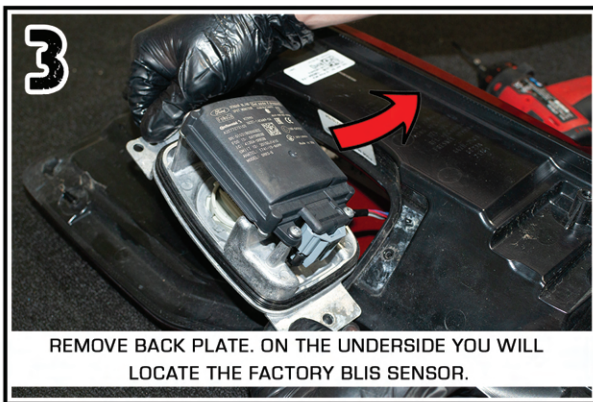

REMOVE BACK PLATE. ON THE UNDERSIDE YOU WILL LOCATE THE FACTORY BLIS SENSOR.

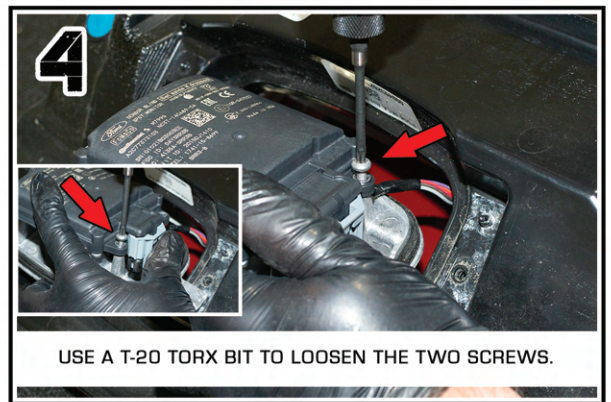

USE A T-20 TORX BIT TO LOOSEN THE TWO SCREWS.

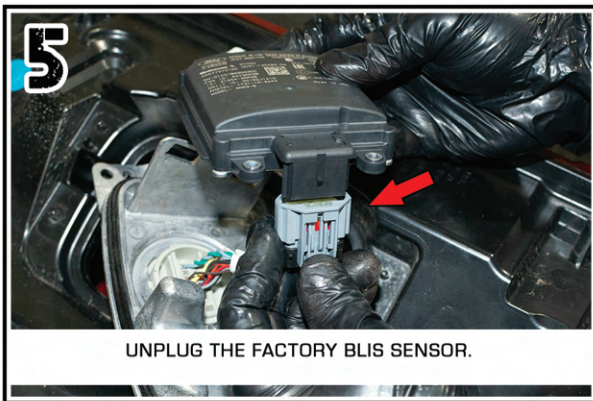

UNPLUG THE FACTORY BLIS SENSOR.

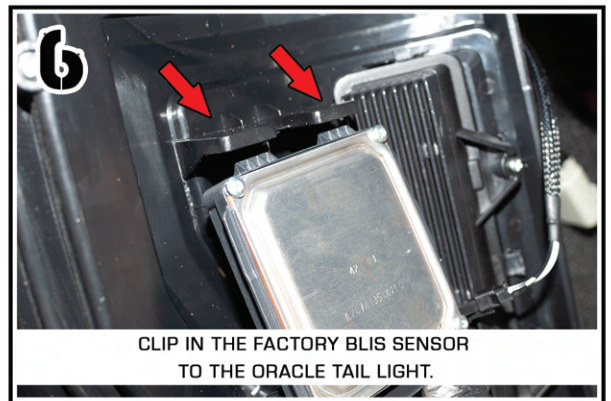

CLIP IN THE FACTORY BLIS SENSOR TO THE ORACLE TAIL LIGHT.

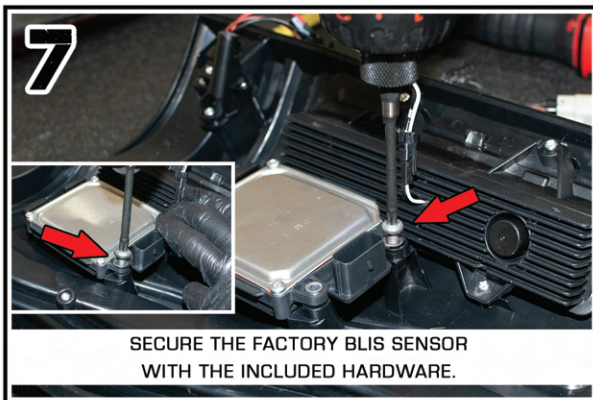

SECURE THE FACTORY BLIS SENSOR WITH THE INCLUDED HARDWARE.

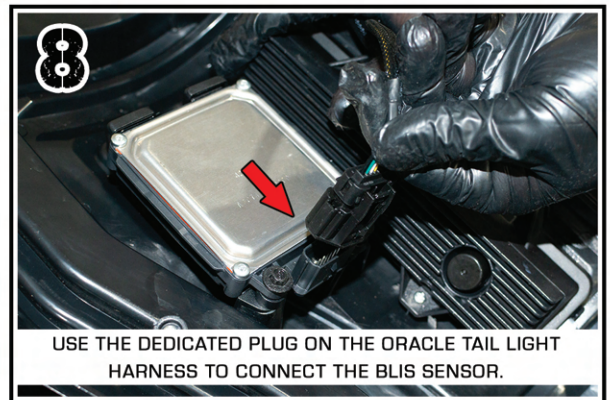

USE THE DEDICATED PLUG ON THE ORACLE TAIL LIGHT HARNESS TO CONNECT THE BLIS SENSOR.