



# ORACLE LIGHTING

## BRONCO LED DASH KIT

ORACLE PART #4237-333

### INSTALLATION GUIDE

**TOOLS NEEDED:**  
TRIM PANEL TOOL  
T-30 TORX BIT  
7MM NUT DRIVER/SOCKET  
PHILIPS SCREWDRIVER  
CUTTING TOOL



**1**  
REMOVE T-30 TORX SCREWS ON DRIVER AND PASSENGER SIDE DOOR HANDLE (8) TOTAL



**2**  
PUSH IN THESE (2) CLIPS TO DETACH THE GLOVE BOX

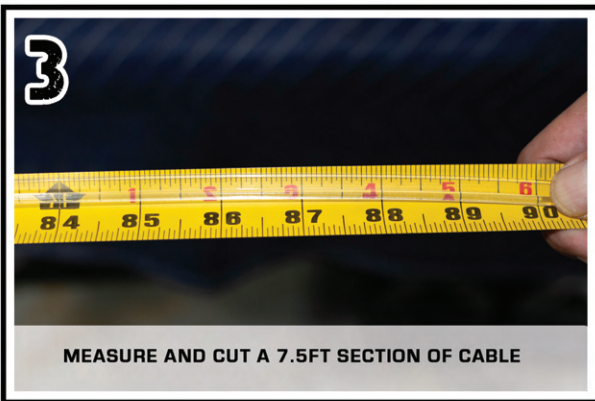

**3**  
MEASURE AND CUT A 7.5FT SECTION OF CABLE

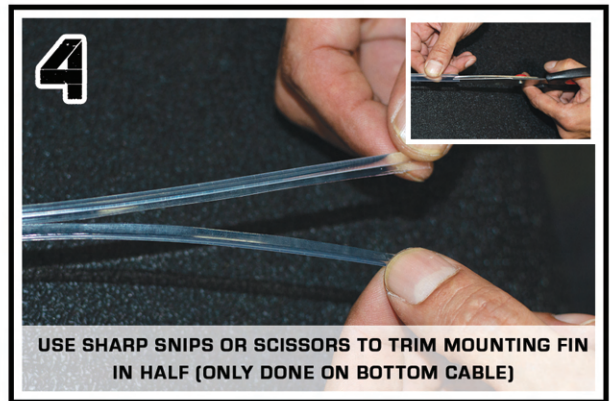

**4**  
USE SHARP SNIPS OR SCISSORS TO TRIM MOUNTING FIN IN HALF (ONLY DONE ON BOTTOM CABLE)



**5**  
ROUTE CABLE THROUGH DASH LEAVING APPROX. 8IN. OF EXCESS CABLE IN GLOVE BOX AREA

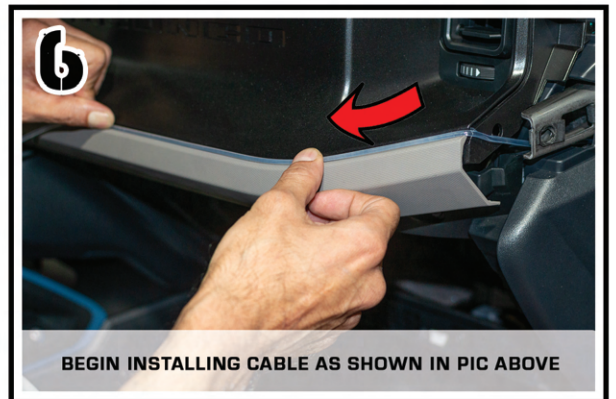

**6**  
BEGIN INSTALLING CABLE AS SHOWN IN PIC ABOVE



**7**  
CONTINUE INSTALLING CABLE ALONG DASH



**8**  
BEND CABLE AROUND CORNER WHILE INSTALLING (SLIGHTLY PULLING THIS PANEL OUTWARD HELPS)

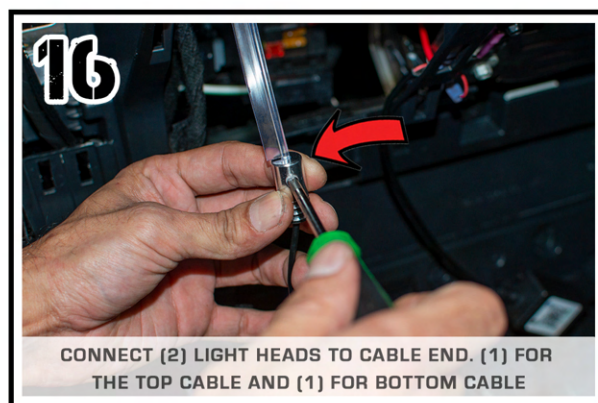
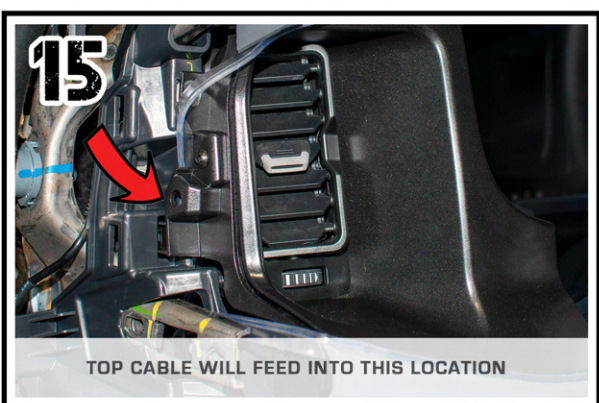
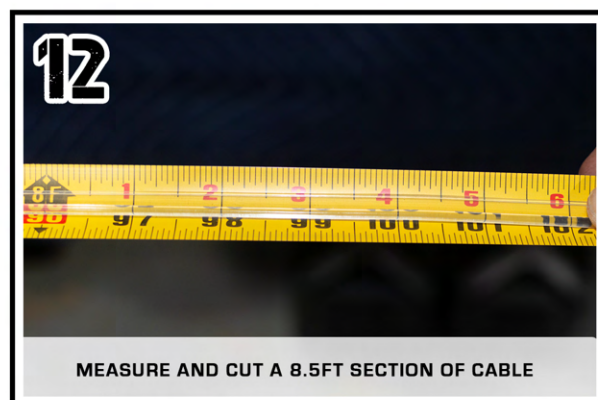

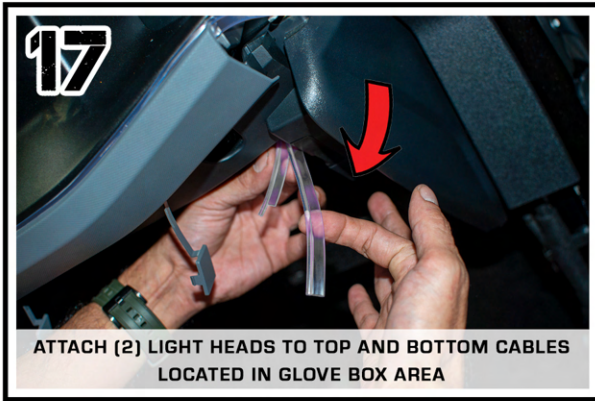

**ATTACH (2) LIGHT HEADS TO TOP AND BOTTOM CABLES LOCATED IN GLOVE BOX AREA**



**FEED CABLES INTO AREA BEHIND CENTER CONSOLE. RE-INSTALL ALL TRIM/PANEL PIECES**



**FEED CABLES INTO AREA BEHIND CENTER CONSOLE**

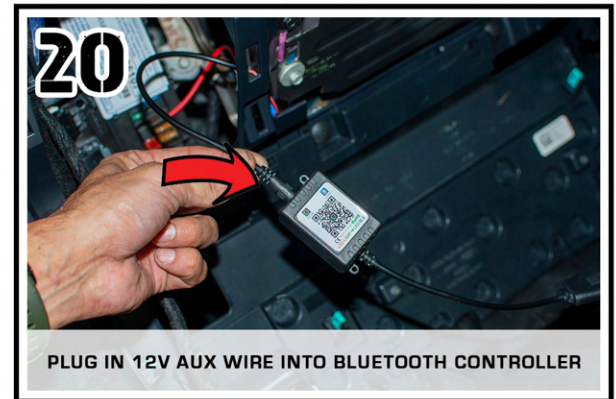

**PLUG IN 12V AUX WIRE INTO BLUETOOTH CONTROLLER**

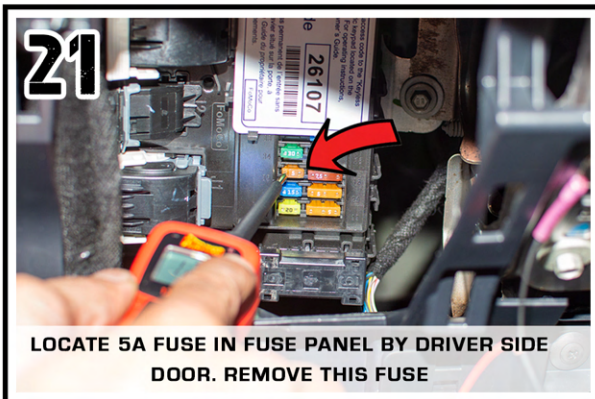

**LOCATE 5A FUSE IN FUSE PANEL BY DRIVER SIDE DOOR. REMOVE THIS FUSE**

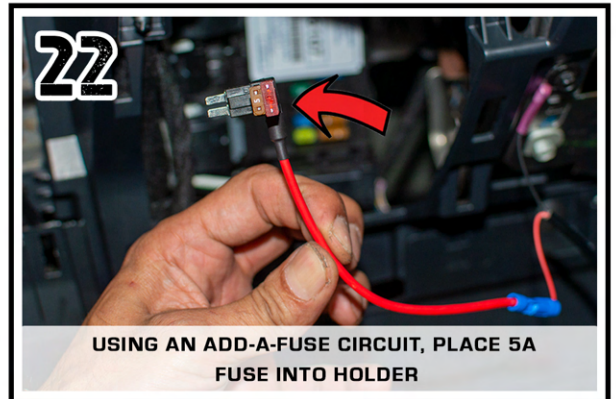

**USING AN ADD-A-FUSE CIRCUIT, PLACE 5A FUSE INTO HOLDER**

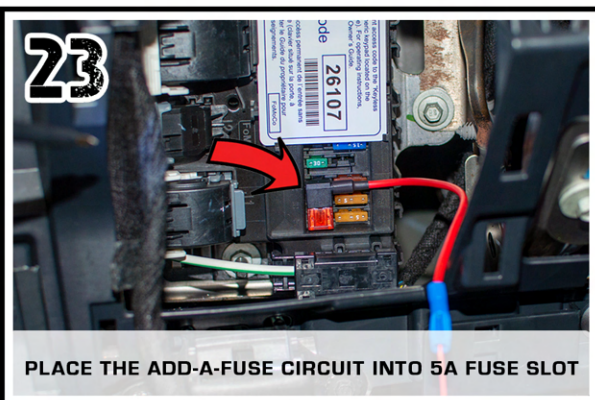

**PLACE THE ADD-A-FUSE CIRCUIT INTO 5A FUSE SLOT**

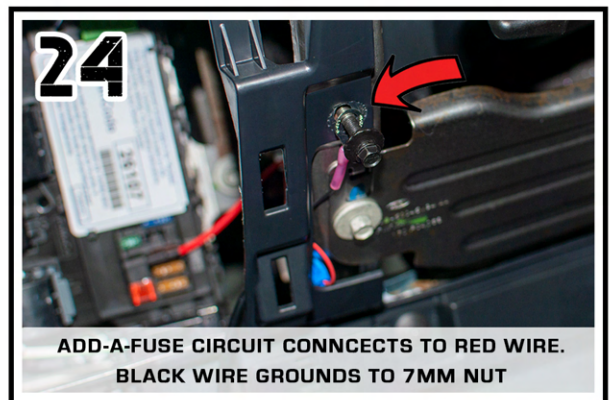

**ADD-A-FUSE CIRCUIT CONNECTS TO RED WIRE. BLACK WIRE GROUNDS TO 7MM NUT**