



AUTOMOTIVE PRODUCTS,

# INSTALLATION INSTRUCTIONS

## PRO TRAXX<sup>®</sup> 5 WHEEL-TO-WHEEL

APPLICATION: 2015-2017 Ford F-150 Super Cab 6.5 ft Bed  
 2015-2017 Ford F-150 Super Crew 6.5 ft Bed  
 PART NUMBER: 21-534610, 21-534615, 21-534630, 21-534635

ITEM	QUANTITY	DESCRIPTION	TOOLS NEEDED
1,2	2	STEP BAR ASSEMBLY DRIVER/PASSENGER	13MM SOCKET
3	2	FRONT MOUNTING BRACKET "A"	TORQUE WRENCH
4	2, 4*	REAR/CENTER MOUNTING BRACKET "B"	RATCHET
5	4, 6*	UNIVERSAL MOUNTING BRACKET	6MM HEX KEY
6,7	2	BOTTOM ISOLATOR BRACKET, DRIVER (6) AND PASSENGER (7)	SOCKET EXT.
8,9	2	TOP ISOLATOR BRACKET, DRIVER (8) AND PASSENGER (9)	16MM SOCKET
10	2	ISOLATOR KIT	18MM SOCKET
11	2	M12 HEX NUT (YELLOW ZINC)	18MM WRENCH
12	16, 24*	M8 HEX NUT (YELLOW ZINC)	
13	16, 24*	M8 FLAT WASHER (YELLOW ZINC)	
14	16, 24*	M8 SPLIT LOCK WASHER (YELLOW ZINC)	
15	4	M10 HEX HEAD BOLT (YELLOW ZINC)	
16	4	M10 U-NUT CLIP (YELLOW ZINC)	
17	4	M10 SPLIT LOCK WASHER (YELLOW ZINC)	
18	4	M10 FLAT WASHER (YELLOW ZINC)	
19	4, 6*	M8 ROUND HEAD SQUARE NECK BOLT (BLACK ZINC)	
20	12, 16*	M10 BUTTON HEAD CAP SCREW (BLACK ZINC)	
21	12, 16*	M10 INTERNAL TOOTHED LOCK WASHER (BLACK ZINC)	
22	12, 16*	M10 FLAT WASHER (BLACK ZINC)	
23	12, 18*	M8 PLASTIC RETAINER SQUARE	
24	6, 8*	PLASTIC BRACKET COVER	
25	12, 16*	M6 HEX HEAD CAP SCREW (YELLOW ZINC)	
26	24, 32*	M6 FLAT WASHER (YELLOW ZINC)	
27	12, 16*	M6 NYLON NUT (YELLOW ZINC)	

\*QUANTITIES INCLUDED/USED DEPEND UPON APPLICATION

ANTI-SEIZE LUBRICANT MUST BE USED ON ALL STAINLESS STEEL FASTENERS TO PREVENT THREAD DAMAGE AND GALLING

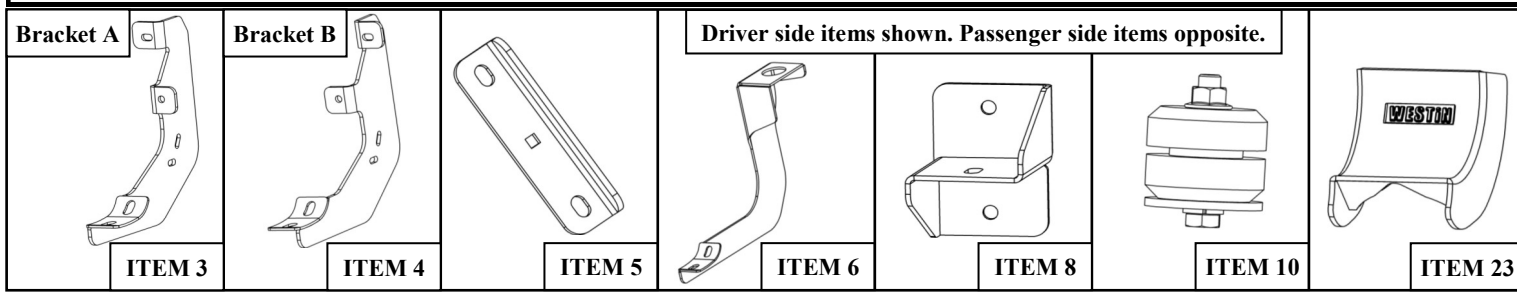

Westin Automotive Products, Inc.  
 320 W. Covina Blvd  
 San Dimas, Ca. 91773

Thank you for choosing Westin products  
 for additional installation assistance please call  
 Customer Service (800) 793-7846

## PROCEDURE

1. Remove contents from box, verify if all parts listed are present and free from damage.

Carefully read and understand all instructions before attempting installation.

**Failure to identify damage before installation could lead to a rejection of any claim.**

2. Start installation on the driver's side. On the rocker panel find locations of factory studs. In each location there should be 3 studs. **Note:** Super Cab has two locations and Super Crew has three locations. See **Figure 1**.
3. Insert (1) M8 Plastic Retainer Square (Item 22) on each factory stud. **Note:** There will be 6 extra plastic retainer squares for the Super Cab model. See **Figure 2**.

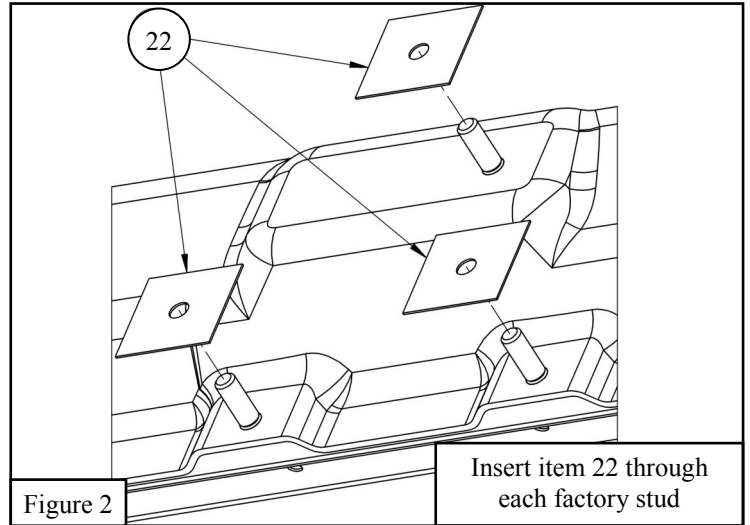
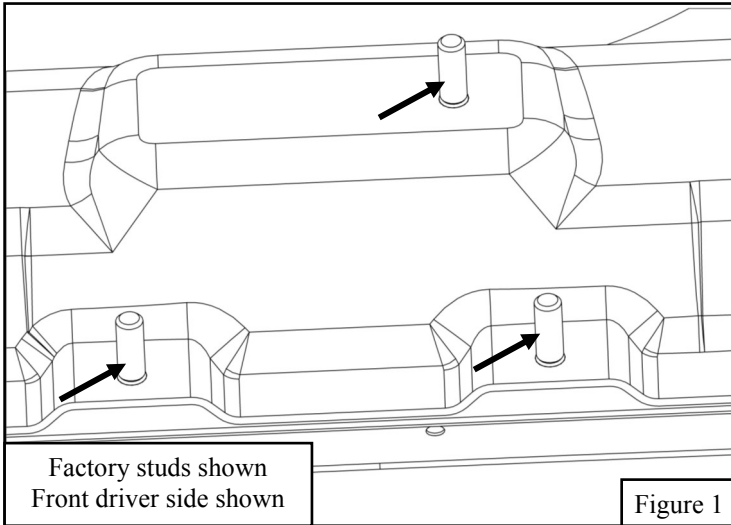

4. Insert the M8 round head square neck bolt (Item 18) through the Universal Mounting Bracket's square hole. Then assemble the Universal Mounting Bracket (Item 5) with the mounting brackets A/B (Items 3/4). Loosely secure it with (1) M8 hex nut, (1) M8 split lock washer, and (1) M8 flat washer. Repeat for the other mounting bracket A/B. **Note:** For Super Cab model there will be 4 Universal Mounting Brackets (Item 5) and for the Super Crew model there are 6. See **Figure 3**.
5. Return to the front location of factory studs. Loosely secure the Universal mount bracket and mount bracket A/B assembly onto the front factory studs. Loosely secure it with (3) M8 hex nut, (3) M8 split lock washer, and (3) M8 flat washer. See **Figure 4**.

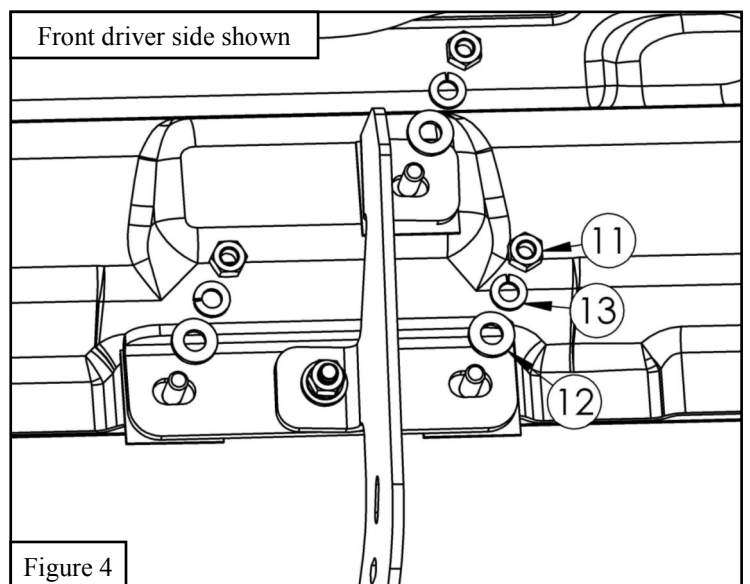
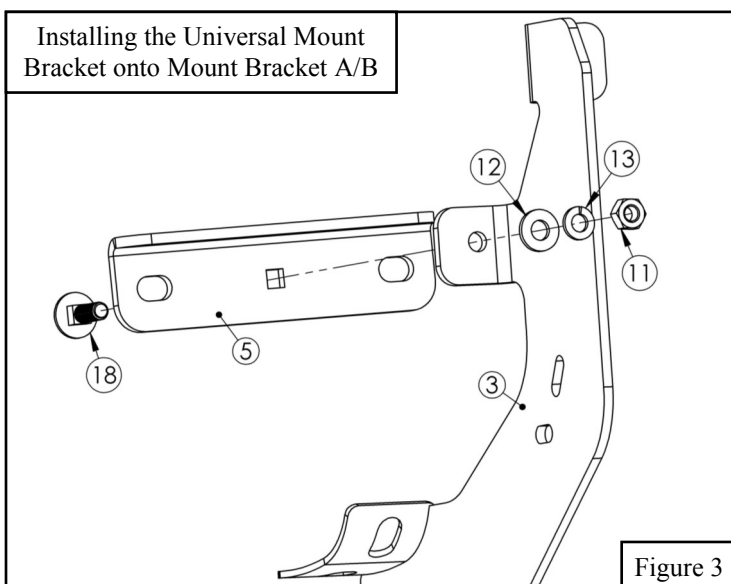

Westin Automotive Products, Inc.  
320 W. Covina Blvd  
San Dimas, Ca. 91773

Thank you for choosing Westin products  
for additional installation assistance please call  
Customer Service (800) 793-7846

6. For the rear and center location with the factory studs use Rear Mounting Bracket "B" (Item 4) and Universal Mount Bracket assembly. Use same hardware as in **Step 5** to loosely secure brackets. Super Cab model will have extra hardware. **Note:** The Super Crew model will have 2 extra Rear Mounting Brackets "B", due to an extra center location of factory studs. See **Figure 5**.
7. Locate two circular and two square holes on the frame, located near the rear of vehicle. See **Figure 6**.
8. Using (2) M10 U-Nut Clip (Item 15), insert them into the square holes on frame. Make sure that the circular holes of the frame are concentric with the circular holes of the M10 U-Nut Clips. See **Figure 7**.

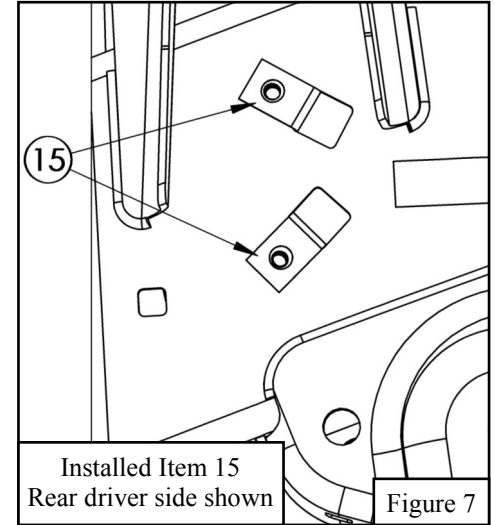
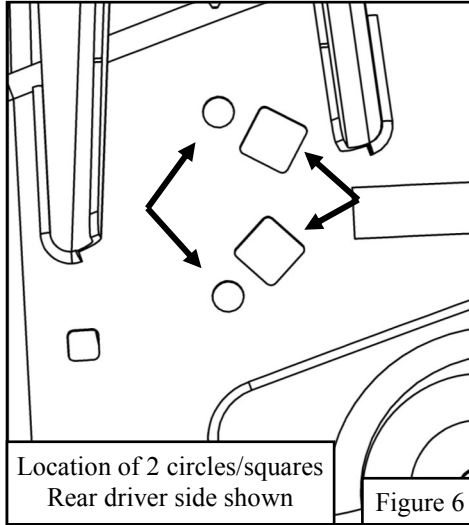
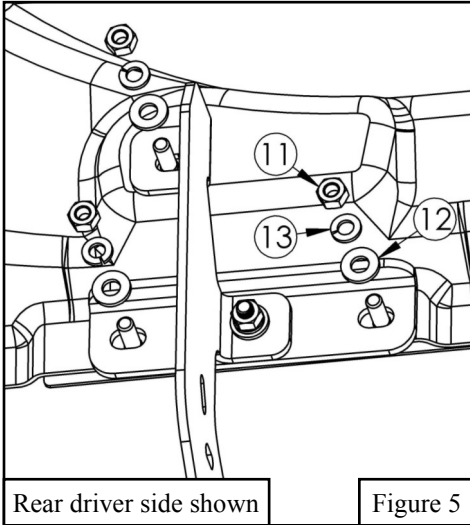

9. Locate Driver Top Isolator Bracket (Item 8). Align holes of the Driver Top Isolator Bracket with the holes of the frame and u-nut clips. Using (2) M10 hex bolt, (2) M10 split lock washer, and (2) M10 flat washer loosely secure the Driver Top Isolator Bracket to the frame. See **Figure 8**.
10. Locate the Isolator Kit (Item 10). Isolator Kit should have (1) isolator sleeve, (1) top isolator, (1) bottom isolator, (1) isolator washer, (1) M12 split lock washer, (1) M12 serrated nut, and (1) M12 bolt. Assemble the Isolator kit with the Driver Bottom Isolator Bracket (Item 6). See **Figure 9**.
11. Install assembly (Item 6 & Item 10) onto the Driver Top Isolator Bracket (Item 8). Loosely install using the (1) M12 serrated nut that comes with the Isolator Kit. See **Figure 10**.

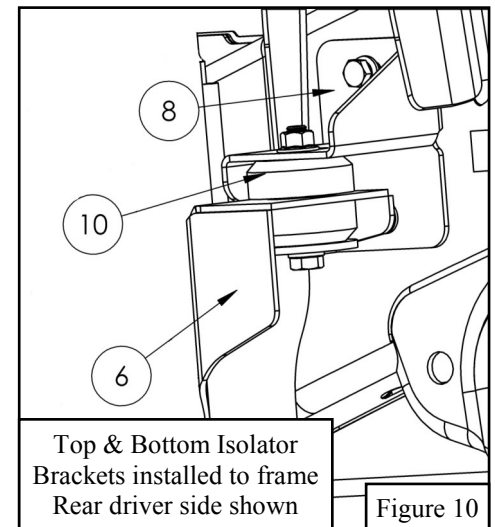
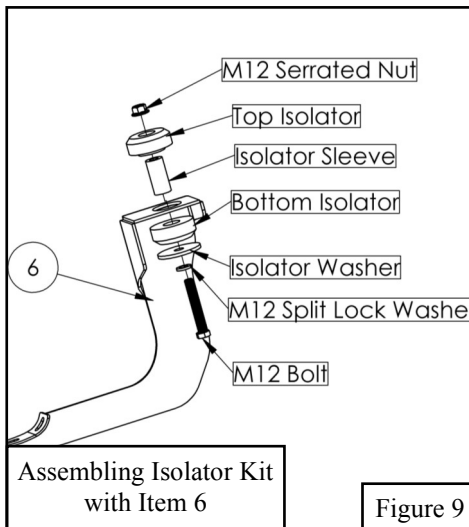
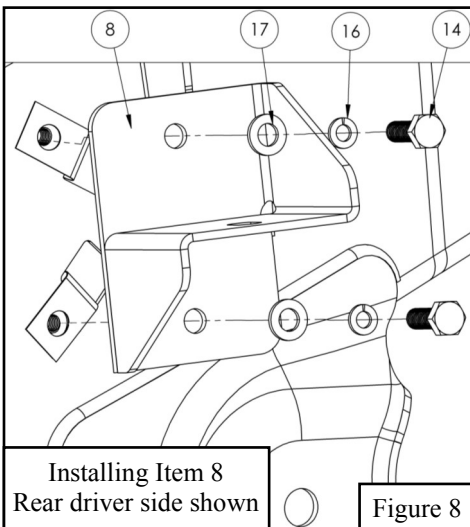

Westin Automotive Products, Inc.  
320 W. Covina Blvd  
San Dimas, Ca. 91773

12. Locate (1) Plastic Bracket Cover (Item 23) and loosely secure it to the brackets using the provided hardware: (2) M6 hex head cap screws, (4) M6 flat washers, and (2) M6 nylon lock nuts. Repeat for every bracket. See **Figure 11**.

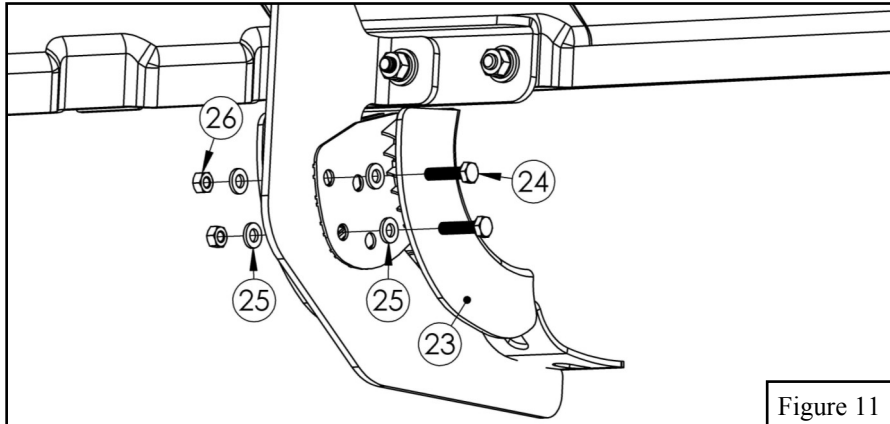

Figure 11

13. Locate the Driver Step Bar Assembly (Item 1) and align it with the brackets. **Note:** Super Cab model will have 3 brackets and Super Crew will have 4 brackets. See **Figures 12 & 13**.

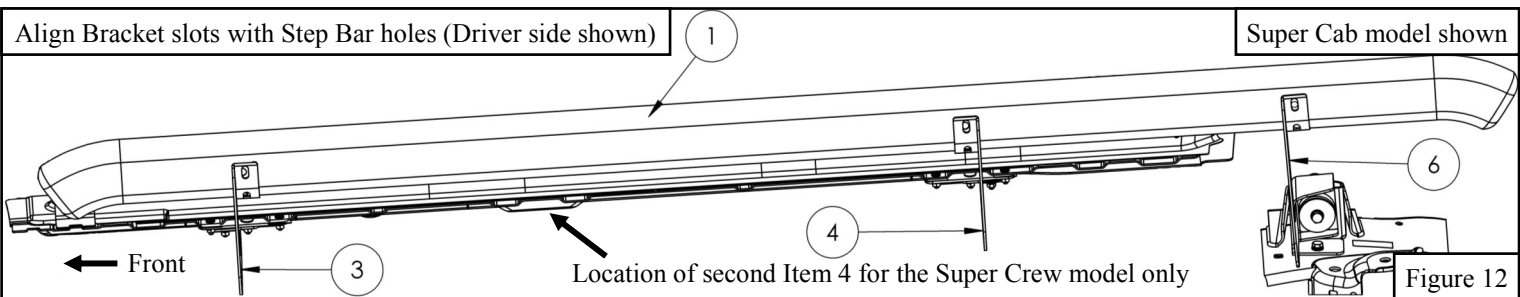

Figure 12

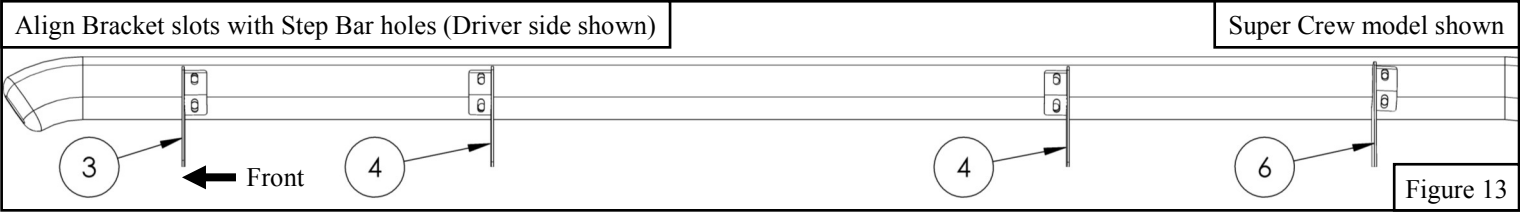

Figure 13

14. Loosely install the Driver Step Bar Assembly using M10 button head cap screw (Item 19), M10 internal toothed lock washer (Item 20), and M10 flat washer (Item 21). **Note:** Super Cab model will have extra hardware. See **Figure 14**.

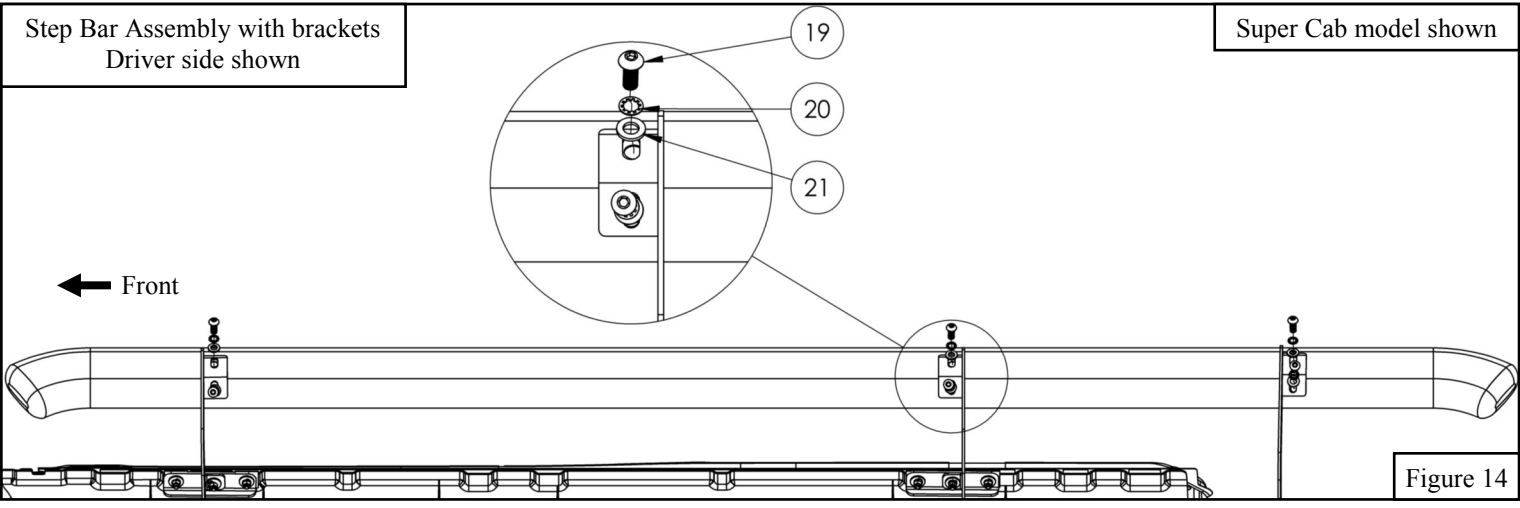

Figure 14



Westin Automotive Products, Inc.  
320 W. Covina Blvd  
San Dimas, Ca. 91773

Thank you for choosing Westin products  
for additional installation assistance please call  
Customer Service (800) 793-7846  
www.westinautomotive.com



15. Align and adjust the step bar and brackets as necessary then tighten and torque all fasteners as follows: M8 to 20 ft-lbs, M10 30 ft-lbs.

16. Repeat for the passenger side.



#### CARE INSTRUCTIONS

- REGULAR WAXING IS RECOMMENDED. DO NOT USE ANY TYPE OF POLISH OR WAX THAT MAY CONTAIN ABRASIVES.
- STAINLESS STEEL PRODUCTS CAN BE CLEANED WITH MILD SOAP AND WATER. STAINLESS STEEL POLISH SHOULD BE USED TO POLISH SMALL SCRATCHES.
- GLOSS BLACK FINISHES SHOULD BE CLEANED WITH MILD SOAP AND WATER.



Westin Automotive Products, Inc.  
320 W. Covina Blvd  
San Dimas, Ca. 91773

Thank you for choosing Westin products  
for additional installation assistance please call  
Customer Service (800) 793-7846  
[www.westinautomotive.com](http://www.westinautomotive.com)