

Part No. A0415SS

2015 – 2016
2017

FORD F150 SUPER CAB
F250-350-450-550 SUPER DUTY SUPER CAB



Installation Time: 60 - 180 min

Drilling Required : NO

Cutting Required : No

PARTS LIST:

Qty	Part Description	Qty	Part Description
1	Driver/left Sidebar	4	1/2" x 2" Hex Bolts
1	Passenger/right Sidebar	4	1/2" x 1-1/4" OD x 3/32" Flat Washers
2	Driver side front-passenger side rear Sidebar Brackets	4	1/2" Lock Washers
2	Passenger side front-driver side rear Sidebar Brackets	12	8mm x 24mm OD x 2mm Washers
12	8mm Plastic Washers	12	8-1.25mm Nylon Lock Nuts

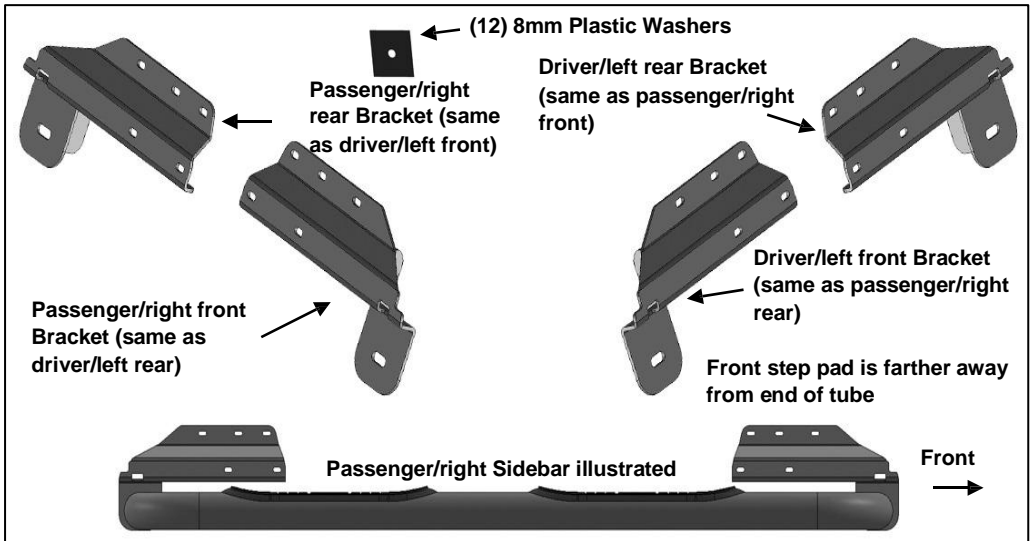

INSTALLATION PROCEDURE



DO NOT OVER TORQUE. STANDARD OPERATING LOAD FOR TIGHTEN BODY MOUNT NUTS & BOLTS VARIES FROM 45 TO 65 FOOT POUND.

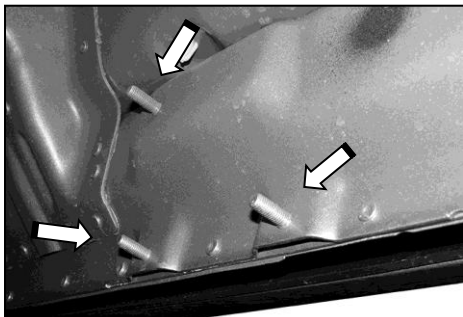

(Fig 1) Locate the (3) factory threaded studs at each location. Passenger side rear pictured

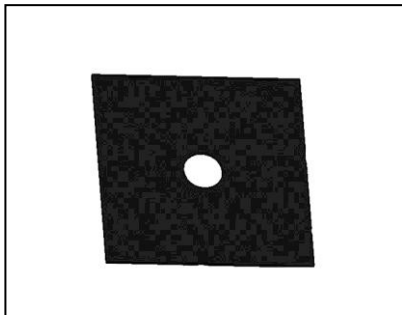

(Fig 2) Plastic Insulation Washer

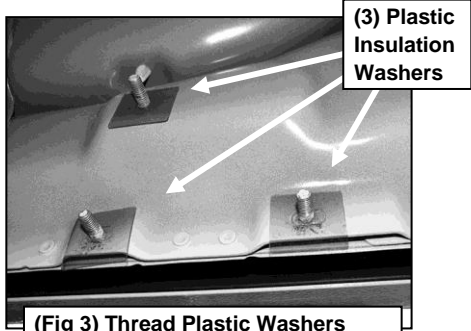

(Fig 3) Thread Plastic Washers onto all mounting studs. Passenger side rear pictured

1. Start the installation under the passenger side of the vehicle. Locate the front and rear factory running board mounting locations along the inner side of the body, (**Figure 1**).
2. Slide (1) Plastic Washer over each factory mounting stud in the body panel, (**Figures 2 & 3**). **IMPORTANT:** The Plastic Washers are designed to prevent corrosion between the aluminum body panel and the steel mounting brackets. Do not install the Brackets without the Plastic Washers.
3. Select (1) passenger side front Mounting Bracket. **NOTE:** Same bracket is used for the driver side rear installation. Attach the Mounting Bracket to the (3) factory studs with (3) 8mm Flat Washers and (3) 8mm Nylon Lock Nuts, (**Figure 5**). Snug but do not fully tighten the hardware.
4. Repeat **Steps 1—3** to install the passenger side rear Bracket, (**Figure 4**).
5. Select the passenger/right Sidebar. With assistance, position the Sidebar up to the (2) Mounting Brackets. Attach the Sidebar to the Mounting Brackets with the included (2) 1/2" x 2" Hex Bolts, (2) 1/2" Lock Washers, and (2) 1/2" Flat Washers, (**Figure 5**). Snug but do not tighten at this time.

(3) 8mm Plastic Washers
(3) 8mm Flat Washers
(3) 8mm Nylon Lock Nuts



(Fig 4) Passenger side rear Bracket installation

6. Level and adjust the Sidebar and tighten all hardware.
7. Repeat **Steps 1—6** to install the driver/left Sidebar.
8. Do periodic inspections to the installation to make sure that all hardware is secure and tight.



1/2" x 2" Hex Bolts
1/2" Flat Washers
1/2" Lock Washers

(Fig 5) Passenger side front Bracket installation

NOTE

This image shows a single sheet of white paper with horizontal ruling lines. The lines are evenly spaced and run across the width of the page. There are no margins, text, or other markings on the paper.