



Installation Guide

3" Side Bar



PREMIUM SERIES

REMOVE CONTENTS FROM BOX.
VERIFY ALL PARTS ARE PRESENT.
READ INSTRUCTIONS CAREFULLY BEFORE STARTING INSTALLATION.

PARTS IDENTIFICATION GUIDE

Driver Side tube packed using “Green” color foam sheet.
Passenger Side tube packed using “White” color foam sheet.

No.	Parts Identification
1.	Passenger Rear Bracket marked “PR”
2.	Driver Rear Bracket marked “DR”
3.	Passenger Center Bracket marked “PC”
4.	Driver Center Bracket marked “DC”
5.	Passenger Front Bracket marked “PF”
6.	Driver Front Bracket marked “DF”

NOTE

- This guide is to identify the parts and not a reference for part count
- Product / Bracket image is for representative purpose only
- Actual product design and part list may vary based on application
- Refer Parts List for Hardware

Part No. A0412SS

2005 - Current

Toyota Tacoma Double Cab



Installation Time: 60 - 180 min

Drilling Required : NO

Cutting Required : No

PARTS LIST:

Qty	Part Description	Qty	Part Description
1	Driver Sidebar	1	Driver/Left Rear Mounting Bracket
1	Passenger Sidebar	1	Passenger/Right Rear Mounting Bracket
1	Driver/Left Front Mounting Bracket	24	8-1.25mm x 30mm Hex Bolts
1	Passenger/Right Front Mounting Bracket	24	8mm Lock Washers
1	Driver/Left Middle Mounting Bracket	24	8mm ID x 24mm OD x 2mm Flat Washers
1	Passenger/Right Middle Mounting Bracket		

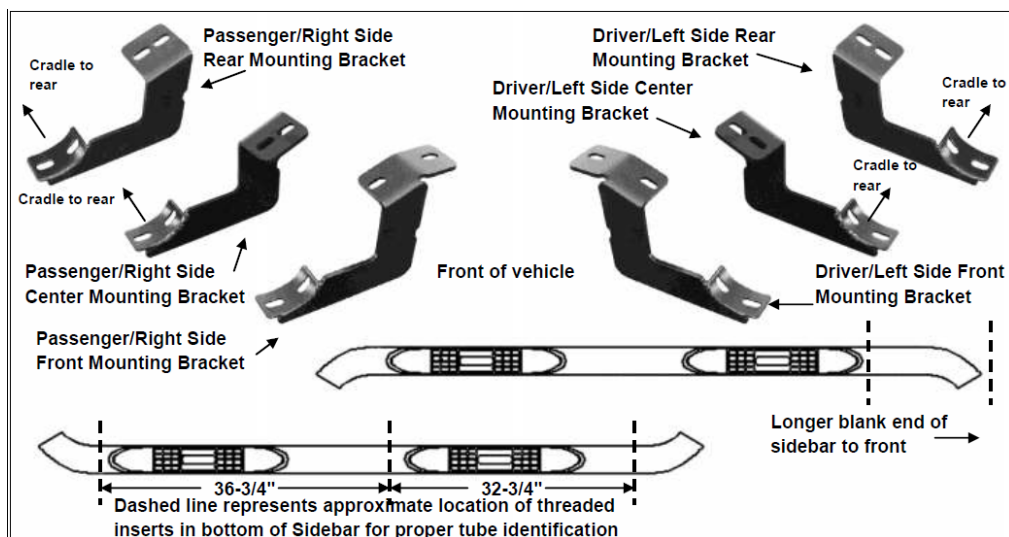

INSTALLATION PROCEDURE



DO NOT OVER TORQUE. STANDARD OPERATING LOAD FOR TIGHTEN BODY MOUNT NUTS & BOLTS VARIES FROM 45 TO 65 FOOT POUND.

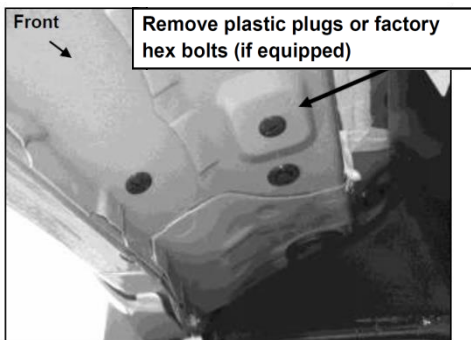

(Fig 1) Driver side front mounting location pictured

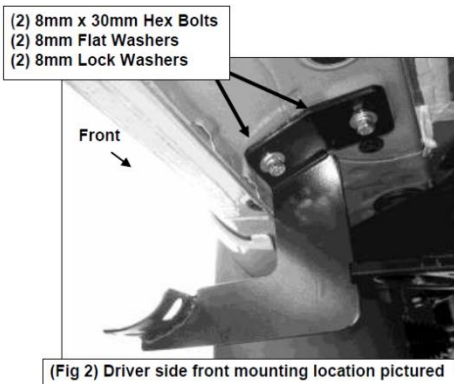

(Fig 2) Driver side front mounting location pictured

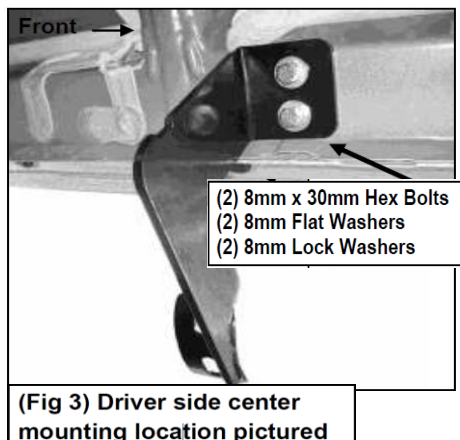

(Fig 3) Driver side center mounting location pictured

1. Starting on the driver side front of the vehicle, use a flat screw driver to remove the plastic plugs covering the threaded holes in the body panel, (Figure 1). Select the driver side front Mounting Bracket and bolt it to the vehicle using the included (2) 8mm Hex Bolts, (2) 8mm Lock Washers and (2) 8mm Flat Washers, (Figure 2). Do not tighten hardware at this time.
2. Repeat Step 1 for center and rear Mounting Bracket installation, (Figures 3 & 4).
3. **IMPORTANT:** Use the illustration on this page to identify the sidebars before continuing with the installation. Verify that the Brackets are in the correct locations as illustrated above. Carefully place the driver Sidebar onto the Brackets. Align the inserts in the bottom of the Sidebar with the slots on the Mounting Brackets. Attach the Sidebar to the Mounting Brackets with the included (6) 8mm Hex Bolts, (6) 8mm Lock Washers and (6) 8mm Flat Washers, (Figure 4). Do not tighten hardware at this time.

4. Level and adjust the Sidebar properly and tighten all hardware.
5. Repeat Steps 1 - 4 for passenger Sidebar installation.
6. Do periodic inspections to the installation to make sure that all hardware is secure and tight.

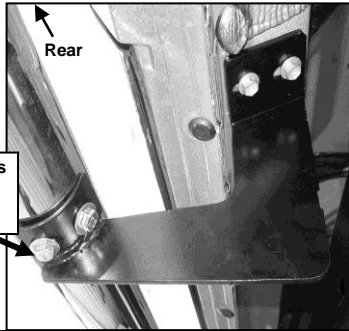

(2) 8mm x 30mm Hex Bolts
(2) 8mm Flat Washers
(2) 8mm Lock Washers

(Fig 4) Driver side rear mounting location pictured



NOTE

This image shows a single sheet of white paper with horizontal ruling lines. The lines are evenly spaced and run across the width of the page. There are no margins, text, or other markings on the paper.

PRODUCT CARE

1. Periodically check the product to ensure all fasteners are tight and components are intact.
2. Regular waxing is recommended to protect the finish of the product.
3. Use ONLY Non-Abrasive automotive wax. Use of any soap, polish or wax that contains an abrasive is detrimental and can scratch the finish leading to corrosion.
4. Aluminum polish may be used to polish small scratches and scuffs.
5. Mild soap may be used to clean the product.

FAQ's

1. **Hardware's are not of correct size.**
Please Re-check the Hardware's size mentioned in Installation guide.
2. **Mounting Bracket are not getting Installed properly.**
In some cases Illustration images shown in Installation manual may not be the exactly same as per actual vehicle images, also if Driver / Passenger side mounting brackets are very identical in the design, suggest referring Parts Identification guide to avoid fitment issue.
3. **Products are thumping / rattling after installation.**
Please ensure that all required mounting brackets / hardwares are installed & tighten correctly. Suggest using white lithium / regular grease between the metal to metal contact surfaces.
4. **Side Bar is not aligning with vehicle / Step Pads are not aligning with vehicle doors**
Side bar may be interchanged or mounting brackets are not installed at the correct position in the vehicle. Please refer Parts identification guide.
5. **Missing / Excess Hardware.**
Recheck hardware count as per the part list.
6. **Product not installing properly.**
Ensure make model year, cab length and bed size of your vehicle is listed in the application. All installation steps are followed correctly.

LIMITED LIFETIME WARRANTY

Keystone Automotive Operations Inc. (KAO) warrants this product to be free of defects in material and workmanship at the time of purchase by the original retail consumer. KAO disclaims any other warranties, express or implied, including the warranty of fitness for a particular purpose or an intended use. If the product is found to be defective, KAO may replace or repair the product at our option, when the product is returned prepaid, with proof of purchase. Alteration to, improper installation, or misuse of this product voids the warranty. KAO's liability is limited to repair or replacement of products found to be defective, and specifically excludes liability for any incidental or consequential loss or damage.



Other TrailFX Offerings



Bull Bars



Grille Guards



Winches



Running Boards

Ask us for more details on TrailFX Products today.

1.866.638.4870

Keystone Automotive Operations, Inc
44, Tunkhannock Avenue, Exeter, PA 18643
Email: support@trailfx.com



www.TrailFX.com