



# Grille Guard

## Part No. 81240/81241



**Fits: 2005 - 2007**  
**2005 - 2007**

**Ford Excursion**  
**Ford F250/F350/F450/F550HD Superduty**



THE GRILLE GUARD MAY INTERFERE WITH PARKING SENSORS, PROXIMITY SENSORS AND CRUISE CONTROL SENSORS



60-180 min



Cutting Not Required



Drilling Not Required



REMOVE CONTENTS FROM BOX. VERIFY ALL PARTS ARE PRESENT.



[support@trailfx.com](mailto:support@trailfx.com)



READ INSTRUCTIONS CAREFULLY BEFORE STARTING INSTALLATION.



1 866 638 4870

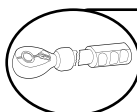

DO NOT OVER TORQUE. STANDARD OPERATING LOAD FOR TIGHTEN BODY MOUNT NUTS & BOLTS VARIES FROM 45 TO 65 FOOT POUND.



**POLISHED STAINLESS STEEL - LIMITED LIFETIME**  
**POWDER COATED BLACK - 3 YEARS**

### PARTS LIST:

Qty	Part Description	Qty	Part Description
1	Grille Guard	6	12-1.75mm x 35mm Hex Bolts
1	Driver/Left Mounting Bracket	12	12mm x 32mm OD x 3mm Flat Washers
1	Passenger/Right Mounting Bracket	6	12mm Nylon Lock Nuts

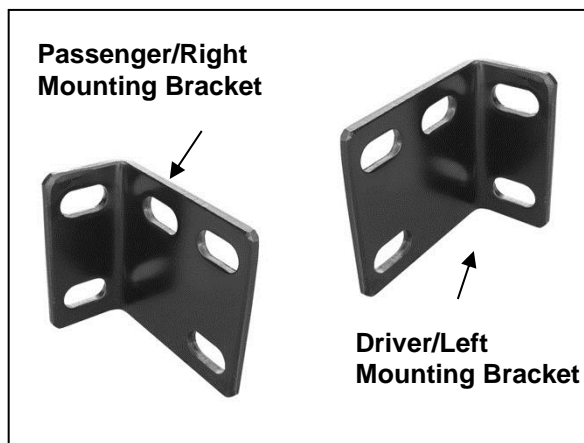

## INSTALLATION PROCEDURE

1. **IMPORTANT:** Before beginning installation, measure the gap between the headlight assembly and the bumper cover on both sides of the vehicle, **(Figure 1)**. Also note the gap between the grille shell and the bumper cover. Record these measurements as the installation requires removal of the bumper bolts and you will need these measurements to properly readjust the bumper to its original position.



**(Fig 1) Measure gap between headlight, grille and bumper before loosening bumper bolts**

2. Remove the (2) factory bumper bolts on the driver side, **(Figure 2)**. **WARNING!** Do not remove passenger and driver bumper bolts at the same time or the bumper may fall. Only install one Frame Mounting Bracket at a time. **NOTE:** Bumper bolts are held in place by thin metal retaining clips installed between the bumper and the bumper bracket. The clips must be removed to install the Bracket. Unthread both bolts from the double nut plate and remove the plate, **(Figure 3)**. Pull the bumper outward and reach behind the bumper to hold the clip. It may be necessary to loosen the passenger side bumper bolts **two turns only** to make room to access the clips. Continue to unthread the bolt from the clip and discard the clips.

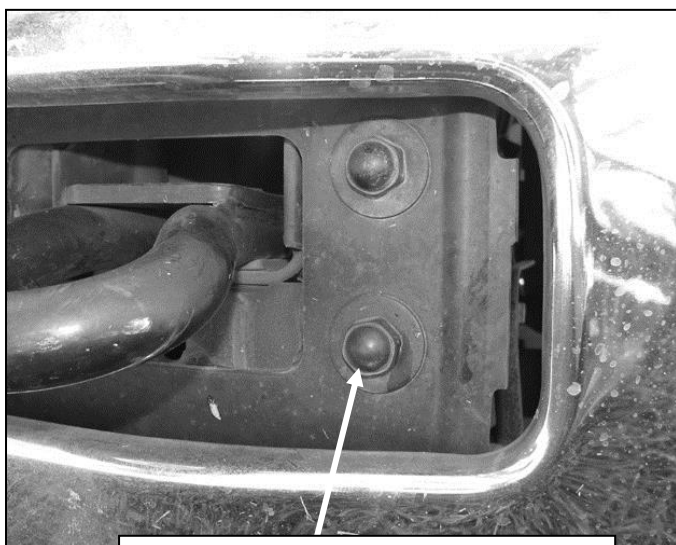

**(Fig 2) Remove factory bumper bolts**

**Remove clips on bumper bolts between bumper and bumper bracket**

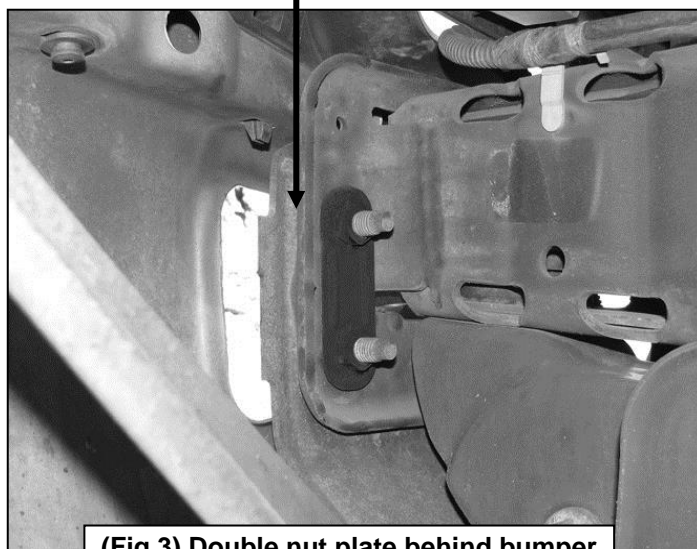

**(Fig 3) Double nut plate behind bumper**

3. Select the driver side Frame Mounting Bracket. Bolt the Bracket to the vehicle using the factory bolts and double nut plate, **(Figure 4)**. Move the Bracket outward in the slots as much as possible. Check the bumper alignment and tighten the (2) bumper bolts at this time. **NOTE:** It may be necessary to loosen and readjust the bumper once the Grille Guard has been completely installed. Due to manufacturer tolerances, it may be necessary to remove the tow hook for clearance.
4. Repeat **Steps 2 & 3** for passenger side Mounting Bracket installation.

5. With assistance, position the Grille Guard up to the inside of the Frame Mounting Brackets, **(Figure 4)**. Attach the Grille Guard to the Brackets with the included (6) 12mm Hex Bolts, (12) 12mm Flat Washers and (6) 12mm Nylon Lock Nuts. Do not fully tighten hardware at this time.
6. Level and adjust Grille Guard and bumper, (if necessary), and tighten all hardware.
7. Do periodic inspections to the installation to make sure that all hardware is secure and tight.

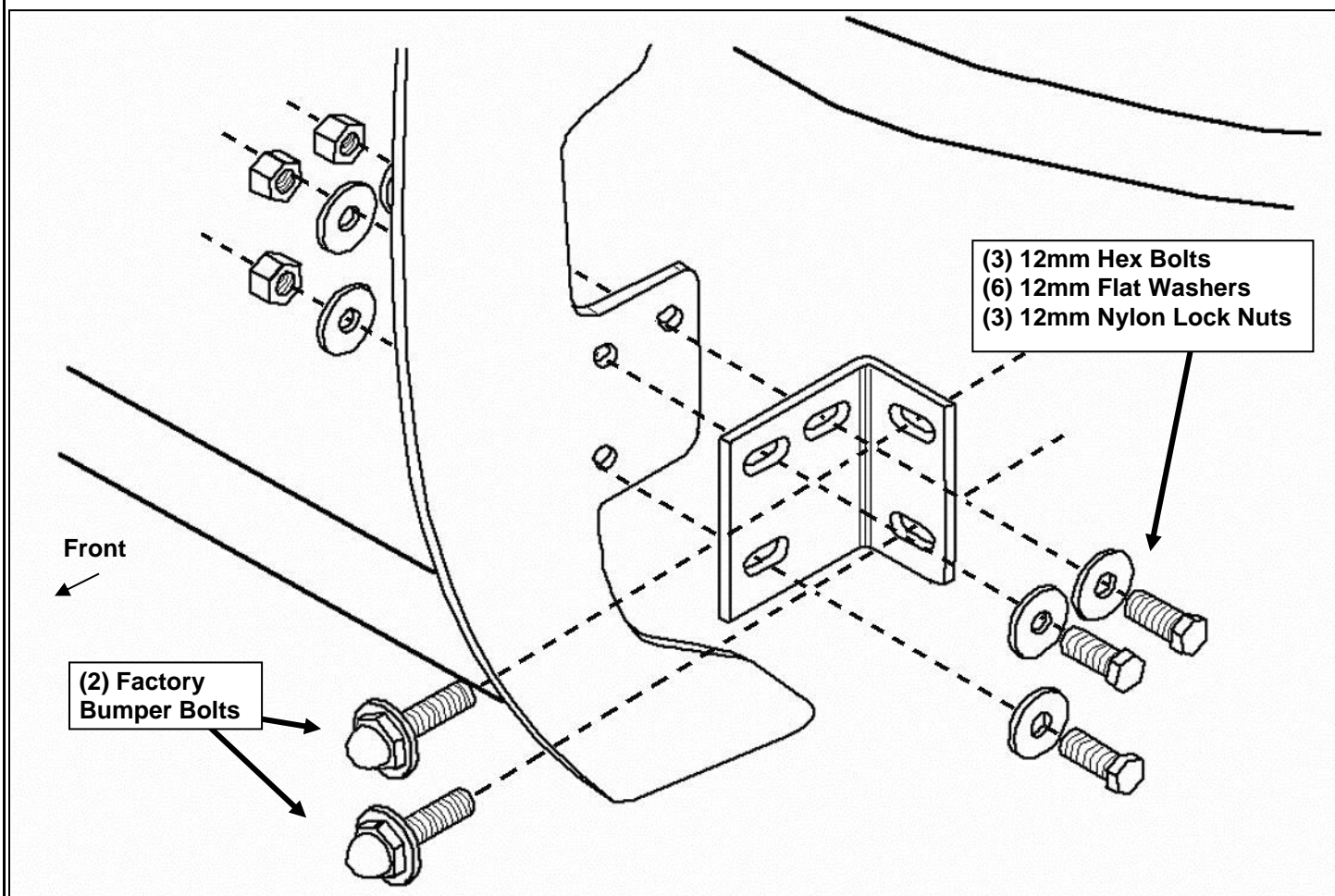

**(Fig 4) Driver side installation illustrated**

**WARNING!** Do not remove passenger and driver bumper bolts at the same time or bumper may fall. Only remove and install one Frame Mounting Bracket at a time.

**PRODUCT CARE**

- Periodically check the product to ensure all fasteners are tight and components are intact.
- Regular waxing is recommended to protect the finish of the product.
- **Use ONLY Non-Abrasive automotive wax.** Use of any soap, polish or wax that contains an abrasive is detrimental and can scratch the finish leading to corrosion.
- Aluminum polish may be used to polish small scratches and scuffs for **Stainless Steel finish.**
- Mild soap may be used to clean the product for both **Stainless Steel and Black finish.**

**FAQ's****1. Hardware's are not of correct size.**

*In GMC / Chevrolet truck model 2006 & up, customer needs to reuse the factory body bolts to install the bracket. If your vehicle is not GMC / Chevrolet 2006 & up, ensure that holes are not partially covered with any plastic grommet or rust? If it is, remove the plastic grommet & rust from the thread holes & re-try the installation.*

**2. Mounting Bracket are not getting Installed properly.**

*In some cases Illustration images shown in Installation manual may not be the exactly same as per actual vehicle images ,also if Driver / Passenger side mounting brackets are very identical in the design, suggest referring Parts Identification guide to avoid fitment issue.*

**3. Products are thumping / rattling after installation.**

*Ensure that all required mounting brackets / hardware's are installed & tighten correctly. Suggest using white lithium / regular grease between the metal to metal contact surfaces.*

**4. Side Bar is not aligning with vehicle / Step Pads are not aligning with vehicle doors.**

*Side bar may be interchanged or mounting brackets are not installed at the correct position in the vehicle. Refer Parts identification guide.*

**5. Missing / Excess Hardware.**

*Recheck hardware count as per the part list.*

**6. Product not installing properly.**

*Ensure make model year, cab length and bed size of your vehicle is listed in the application. All installation steps are followed correctly.*

**Check out these other TrailFX Products!!**

**www.TrailFX.com**



**SIDE BAR**

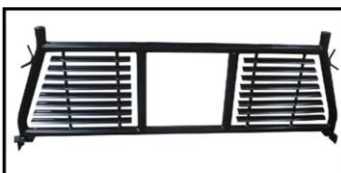

**HEADACHE RACKS**

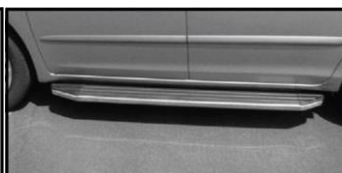

**RUNNING BOARDS**



**ROCKER GUARDS**

*Keystone Automotive Operations Inc. (KAO) warrants this product to be free of defects in material and workmanship at the time of purchase by the original retail consumer. KAO disclaims any other warranties, express or implied, including the warranty of fitness for a particular purpose or an intended use. If the product is found to be defective, KAO may replace or repair the product at our option, when the product is returned prepaid, with proof of purchase. Alteration to, improper installation, or misuse of this product voids the warranty. KAO's liability is limited to repair or replacement of products found to be defective, and specifically excludes liability for any incidental or consequential loss or damage.*