



Grille Guard

Part No. 81120/1



Fits: **2000-2004**
1999-2004

Ford Excursion
F250/350/450/550 Superduty



60-180 min

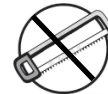

CUTTING NOT
REQUIRED



DRILLING NOT
REQUIRED



REMOVE CONTENTS FROM BOX. VERIFY ALL PARTS ARE PRESENT.



support@trailfx.com



READ INSTRUCTIONS CAREFULLY BEFORE STARTING INSTALLATION.



1 866 638 4870

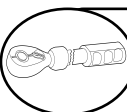

DO NOT OVER TORQUE. STANDARD OPERATING LOAD FOR TIGHTEN BODY MOUNT NUTS & BOLTS VARIES FROM 45 TO 65 FOOT POUND.



POLISHED STAINLESS STEEL - LIMITED LIFETIME
POWDER COATED BLACK - 3 YEARS

PARTS LIST:

Qty	Part Description	Qty	Part Description
1	Grille Guard	6	12-1.75mm x 30mm Hex Bolts
1	Driver/Left Standard Frame Mounting Bracket	12	12mm x 32mm OD x 3mm Flat Washers
1	Passenger/Right Standard Frame Mounting Bracket	6	12mm Nylon Lock Nuts
1	Driver/Left 1" Longer Frame Mounting Bracket		
1	Passenger/Right 1" Longer Frame Mounting Bracket		

INSTALLATION PROCEDURE:

ASSISTANCE IS RECOMMENDED TO AVOID POSSIBLE INJURY OR DAMAGE TO THE VEHICLE. CUTTING MAY BE REQUIRED.

- Before beginning installation, measure the gap between the headlight assembly and the bumper cover on both sides of the vehicle. Also note the gap between the grille shell and the bumper cover. Record these measurements as the installation requires removal of the bumper bolts and you will need these measurements to properly readjust the bumper height to its original position if required.
- Starting at the front-driver side, remove the (2) factory bumper bolts, **(Figure 1)**. **WARNING!** Do not remove passenger and driver bumper bolts at the same time or the bumper may fall. Only remove and install one Frame Mounting Bracket at a time. **NOTE:** Bumper bolts are held in place by thin metal retaining clips. Discard the clips and remove the bolts.
- Match up the driver and passenger side standard length Frame Mounting Brackets. Place the driver side Frame Mounting Bracket onto the vehicle and line it up with the (2) mounting bolt holes, **(Figure 1)**. Make sure there is a minimum of 1/8" clearance between the top and bottom of the Mounting Bracket and the opening in the bumper. Secure the Mounting Bracket to the vehicle using the factory bolts and double nut plate, **(Figure 1)**. Check bumper alignment and tighten these (2) bolts at this time. **NOTE:** It may be necessary to loosen and readjust the bumper once the Grille Guard has been installed.

IMPORTANT: (2) Pairs of Mounting Brackets have been included. The Grille Guard is designed to fit reasonably close to the vehicle. On some models and years of vehicles, it may be necessary to use the included 1" longer brackets to move the Grille Guard slightly away from the vehicle

- Repeat steps 2 & 3 for passenger side Frame Mounting Bracket installation.
- With assistance, position the Grille Guard up to the inside of the Frame Mounting Brackets. Attach the Grille Guard to the Frame Mounting Brackets using the included (6) 12mm Hex Bolts, (12) 12mm Flat Washers and (6) 12mm Nylon Lock Nuts, **(Figure 5)**. Do not tighten hardware at this time.
- Level and adjust Grille Guard and bumper, (if necessary), and tighten all hardware at this time.
- Do periodic inspections to the installation to make sure that all hardware is secure and tight.

Use the Standard length brackets. If more clearance is required, longer Brackets have been included

- (3) 12mm Hex Bolts
- (6) 12mm Flat Washers
- (3) 12mm Nylon Lock Nuts

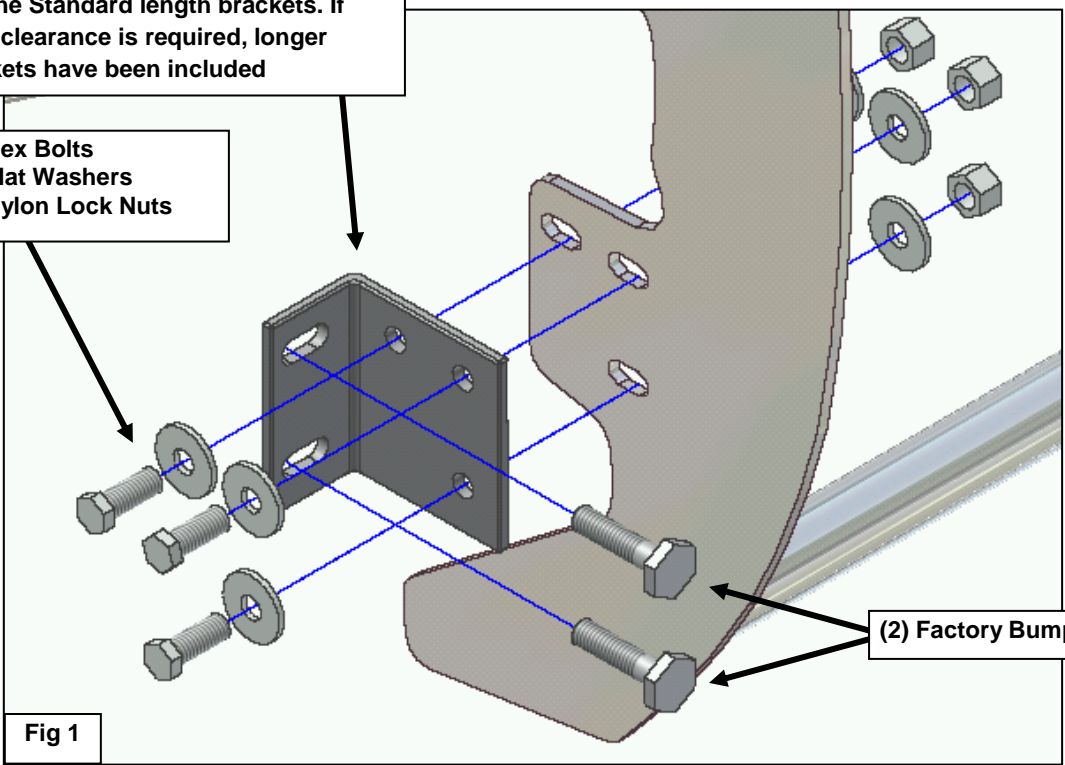

(2) Factory Bumper Bolts

Fig 1

WARNING! Do not remove passenger and driver bumper bolts at the same time or bumper may fall. Only remove and install one Frame Mounting Bracket at a time.

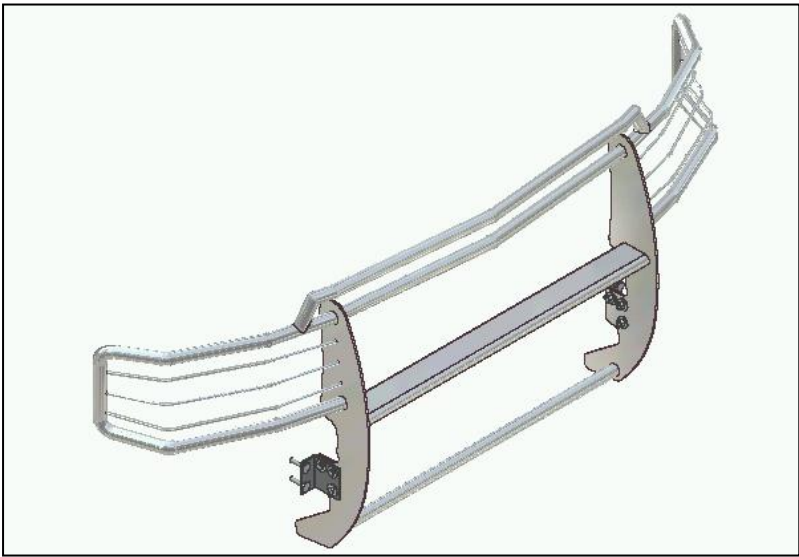

PRODUCT CARE

- Periodically check the product to ensure all fasteners are tight and components are intact.
- Regular waxing is recommended to protect the finish of the product.
- **Use ONLY Non-Abrasive automotive wax.** Use of any soap, polish or wax that contains an abrasive is detrimental and can scratch the finish leading to corrosion.
- Aluminum polish may be used to polish small scratches and scuffs for **Stainless Steel finish.**
- Mild soap may be used to clean the product for both **Stainless Steel and Black finish.**

FAQ's**1. Hardware's are not of correct size.**

In GMC / Chevrolet truck model 2006 & up, customer needs to reuse the factory body bolts to install the bracket. If your vehicle is not GMC / Chevrolet 2006 & up, please ensure that holes are not partially covered with any plastic grommet or rust? If it is, please remove the plastic grommet & rust from the thread holes & re-try the installation.

2. Mounting Bracket are not getting Installed properly.

In some cases Illustration images shown in Installation manual may not be the exactly same as per actual vehicle images ,also if Driver / Passenger side mounting brackets are very identical in the design, suggest referring Parts Identification guide to avoid fitment issue.

3. Products are thumping / rattling after installation.

Please ensure that all required mounting brackets / hardware's are installed & tighten correctly. Suggest using white lithium / regular grease between the metal to metal contact surfaces.

4. Side Bar is not aligning with vehicle / Step Pads are not aligning with vehicle doors.

Side bar may be interchanged or mounting brackets are not installed at the correct position in the vehicle. Please refer Parts identification guide.

5. Missing / Excess Hardware.

Recheck hardware count as per the part list.

6. Product not installing properly.

Ensure make model year, cab length and bed size of your vehicle is listed in the application. All installation steps are followed correctly.

Check out these other TrailFX Products!!

www.FX-Products.com



BULL BARS



HEADACHE RACKS



BED RAILS



RUNNING BOARDS

Keystone Automotive Operations Inc. (KAO) warrants this product to be free of defects in material and workmanship at the time of purchase by the original retail consumer. KAO disclaims any other warranties, express or implied, including the warranty of fitness for a particular purpose or an intended use. If the product is found to be defective, KAO may replace or repair the product at our option, when the product is returned prepaid, with proof of purchase. Alteration to, improper installation, or misuse of this product voids the warranty. KAO's liability is limited to repair or replacement of products found to be defective, and specifically excludes liability for any incidental or consequential loss or damage.