



## 4" Oval Nerf Bar

### Part No. 2982826011/3



Fits: 2001-2006

Honda MDX/Pilot



30-60 min

Cutting Not  
RequiredDrilling Not  
Required

REMOVE CONTENTS FROM BOX. VERIFY ALL PARTS ARE PRESENT.



support@trailfx.com



READ INSTRUCTIONS CAREFULLY BEFORE STARTING INSTALLATION.

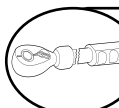

1 866 638 4870

DO NOT OVER TORQUE. STANDARD OPERATING LOAD FOR TIGHTEN  
BODY MOUNT NUTS & BOLTS VARIES FROM 45 TO 65 FOOT POUND.POLISHED STAINLESS STEEL – LIMITED LIFETIME  
POWDER COATED BLACK – 3 YEARS

#### PARTS LIST:

Qty	Part Description	Qty	Part Description
1 Set	Oval step bar	32	M8-1.25 Flange Nut
1 Set	Front Bracket (2 pieces per side)	12	M10-1.5 x 25mm Button Head Bolt
1 Set	Center Bracket (3 pieces per side)	12	M10 Flat Washer
1 Set	Rear Bracket (2 pieces per side)	12	M10 Lock Washer
24	M8-1.25 x 30mm Long Flange Bolt	32	M8-1.25 x 25mm Short Flange Bolt

DRIVER (LEFT) FRONT



PASSENGER (RIGHT) FRONT

DRIVER (LEFT) FRONT



PASSENGER (RIGHT) FRONT

DRIVER (LEFT) CENTER



PASSENGER (RIGHT) CENTER

DRIVER (LEFT) CENTER



PASSENGER (RIGHT) CENTER

DRIVER (LEFT) CENTER



PASSENGER (RIGHT) CENTER

DRIVER (LEFT) REAR



PASSENGER (RIGHT) REAR

DRIVER (LEFT) REAR



PASSENGER (RIGHT) REAR

## INSTALLATION PROCEDURE

1. Please prepare the tools for installation, follow as :14-17 wrench.
2. Locate the Front bracket, Center bracket and the Rear bracket with the M8-1.25 x 30mm long flange bolt on the girder of the car, and then tighten them.
3. Connect the Front bracket (2 pieces per side) using the M8-1.25 x 25mm short flange bolt ,and then tighten it.
4. Connect the Center bracket (3 pieces per side) using the M8-1.25 x 25mm short flange bolt, and then tighten it.
5. Connect the Rear bracket (2 pieces per side) using the M8-1.25 x 25mm short flange bolt, and then tighten it.
6. Attach the bracket to the Side bar using the Button head bolt, and then tighten it.
7. Test and make sure the Side Bar with all hardware are steadily fixed.

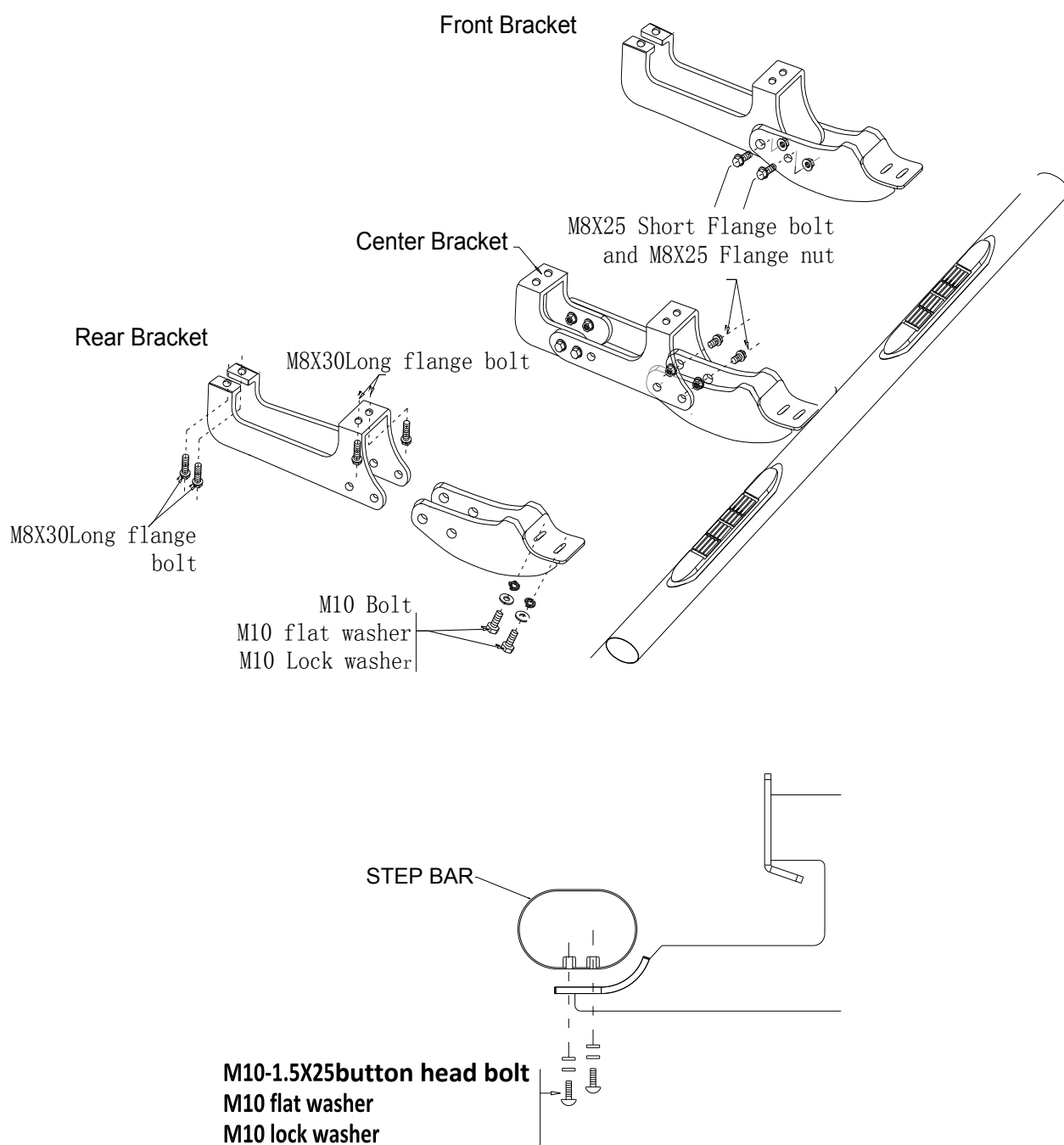

## PARTS IDENTIFICATION GUIDE

**Driver Side tube taped in "Red" Color. Passenger Side tube taped in "Blue" Color.**

No.	Parts Identification
1	Passenger / Right 'Rear' Bracket marked "RR"
2	Driver / Left 'Rear' Bracket marked "RL"
3	Passenger / Right 'Center' Bracket marked "CR"
4	Driver / Left 'Center' Bracket marked "CL"
5	Passenger / Right 'Front' Bracket marked "FR"
6	Driver / Left 'Front' Bracket marked "FL"
7	'Left' marked "L"
8	'Right' marked "R"

**Note:**

- This guide is to identify the parts and not a reference for part count.
- Product / Bracket image is for representative purpose only.
- Actual design may vary based on application.
- Refer Parts List for Hardware.

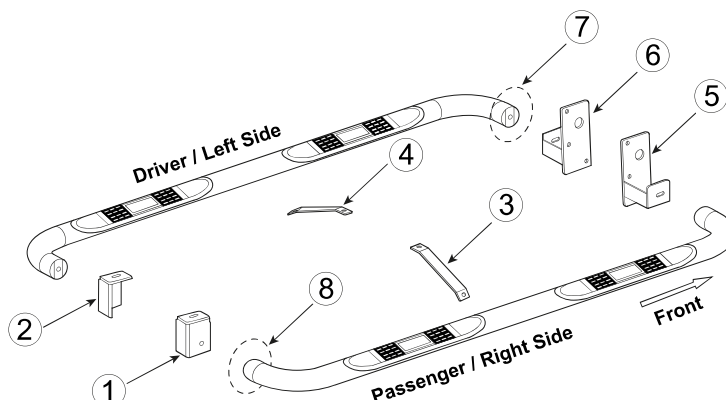

## PRODUCT CARE

- Periodically check the product to ensure all fasteners are tight and components are intact.
- Regular waxing is recommended to protect the finish of the product.
- Use ONLY Non-Abrasive automotive wax.** Use of any soap, polish or wax that contains an abrasive is detrimental and can scratch the finish leading to corrosion.
- Aluminum polish may be used to polish small scratches and scuffs for **Stainless Steel finish**.
- Mild soap may be used to clean the product for both **Stainless Steel and Black finish**.

## FAQ's

### 1. Hardware's are not of correct size.

In GMC / Chevrolet truck model 2006 & up, customer needs to reuse the factory body bolts to install the bracket. If your vehicle is not GMC / Chevrolet 2006 & up, ensure that holes are not partially covered with any plastic grommet or rust? If it is, remove the plastic grommet & rust from the thread holes & re-try the installation.

### 2. Mounting Bracket are not getting Installed properly.

In some cases Illustration images shown in Installation manual may not be the exactly same as per actual vehicle images ,also if Driver / Passenger side mounting brackets are very identical in the design, suggest referring Parts Identification guide to avoid fitment issue.

### 3. Products are thumping / rattling after installation.

Ensure that all required mounting brackets / hardware's are installed & tighten correctly. Suggest using white lithium / regular grease between the metal to metal contact surfaces.

### 4. Side Bar is not aligning with vehicle / Step Pads are not aligning with vehicle doors.

Side bar may be interchanged or mounting brackets are not installed at the correct position in the vehicle. Refer Parts identification guide.

### 5. Missing / Excess Hardware.

Recheck hardware count as per the part list.

### 6. Product not installing properly.

Ensure make model year, cab length and bed size of your vehicle is listed in the application. All installation steps are followed correctly.

Check out these other TrailFX Products!!

www.TrailFX.com



**BULL BARS**



**GRILLE GUARDS**



**BED RAILS**



**RUNNING BOARDS**

Keystone Automotive Operations Inc. (KAO) warrants this product to be free of defects in material and workmanship at the time of purchase by the original retail consumer. KAO disclaims any other warranties, express or implied, including the warranty of fitness for a particular purpose or an intended use. If the product is found to be defective, KAO may replace or repair the product at our option, when the product is returned prepaid, with proof of purchase. Alteration to, improper installation, or misuse of this product voids the warranty. KAO's liability is limited to repair or replacement of products found to be defective, and specifically excludes liability for any incidental or consequential loss or damage.