



4" Oval Nerf Bar

Part No. 2930346991/3



Fits: 1999 - 2016

Ford F250/350/450/550HD Superduty-Super Cab

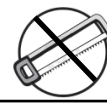

30-60 min

Cutting Not
RequiredDrilling Not
Required

REMOVE CONTENTS FROM BOX. VERIFY ALL PARTS ARE PRESENT.



support@trailfx.com



READ INSTRUCTIONS CAREFULLY BEFORE STARTING INSTALLATION.

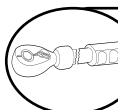

1 866 638 4870

DO NOT OVER TORQUE. STANDARD OPERATING LOAD FOR TIGHTEN
BODY MOUNT NUTS & BOLTS VARIES FROM 45 TO 65 FOOT POUND.POLISHED STAINLESS STEEL – LIMITED LIFETIME
POWDER COATED BLACK – 3 YEARS

PARTS LIST:

Qty	Part Description	Qty	Part Description
1 Set	Oval step bar	8	M10-1.5 U-clip Nut
1 Set	Front Bracket	8	M10-1.5 Hex Nut
1 Set	Rear Bracket	32	M10 Flat Washer
16	M10-1.5 x 30mm Hex Head Bolt	24	M10 Lock Washer
8	M10-1.5 x 30mm Button Head Bolt		

DRIVER (LEFT)FRONT	DRIVER (LEFT)REAR	PASSENGER (RIGHT)REAR	PASSENGER (RIGHT)FRONT

INSTALLATION PROCEDURE

1. Read installation manual and installation drawing completely. Identify all brackets & bolts before installation.
2. Insert M10 U-clip to holes in front and rear of inside pinch weld where brackets will mount. Mount U-clips as shown. (See Fig. B.)
3. Mount front and rear bracket to inside pinch weld using hex head bolts M10x30, lock M10 and flat M10 washers to U-clips M10 through top set of holes on brackets as shown (See Fig. A.) Use hex head bolts M10x30, lock M10 and flat M10 washers and hex head nuts M10 through pinch weld and bottom set of hole on brackets as shown (Fig. B.)
4. Mount step bar to mounting brackets using M10X30 Button Head Bolt, lock M10 flat M10 washers and as shown (Fig. A.). Hand tighten into nut sort on the bottom of the step bar. Adjust position of step bar and tighten all bolts.
5. Torque the 10mm bolts to 30ft/lbs.

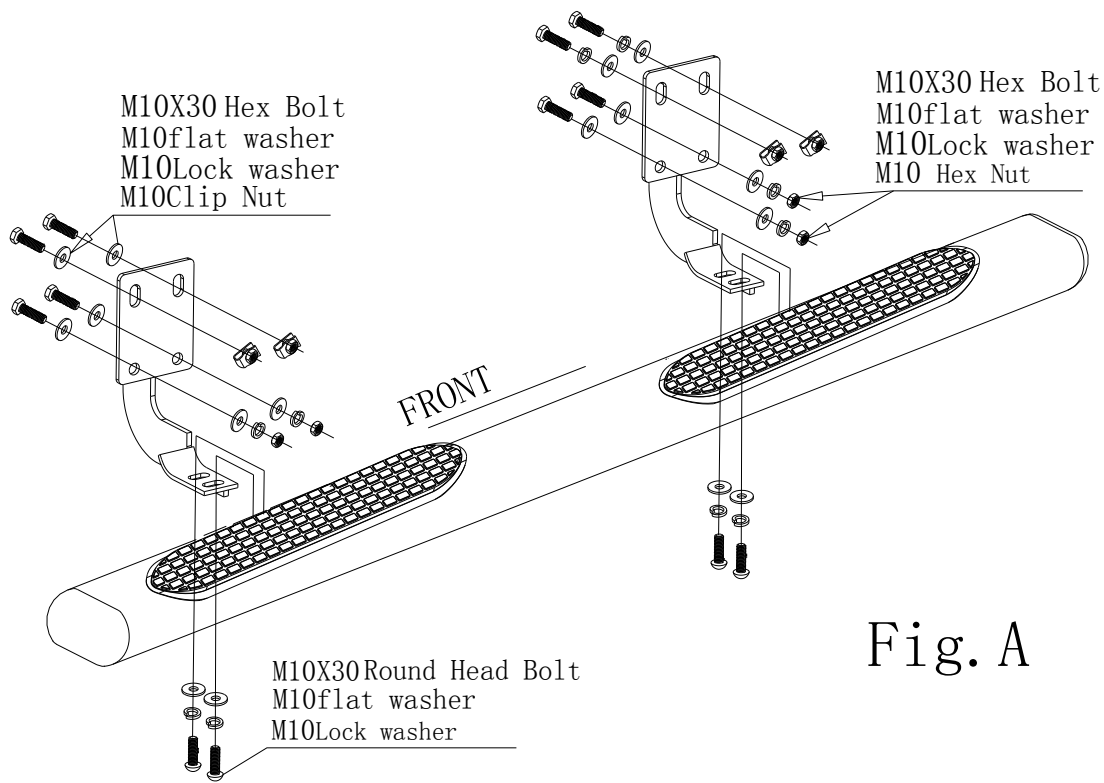

Fig. A

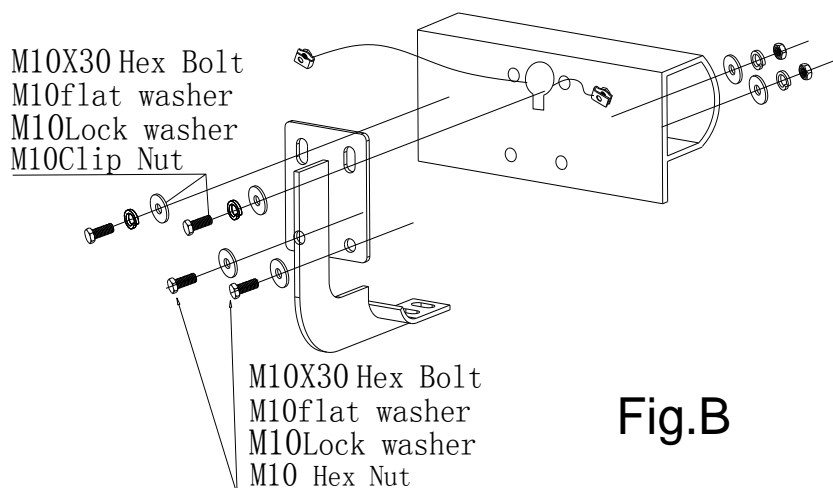

Fig.B

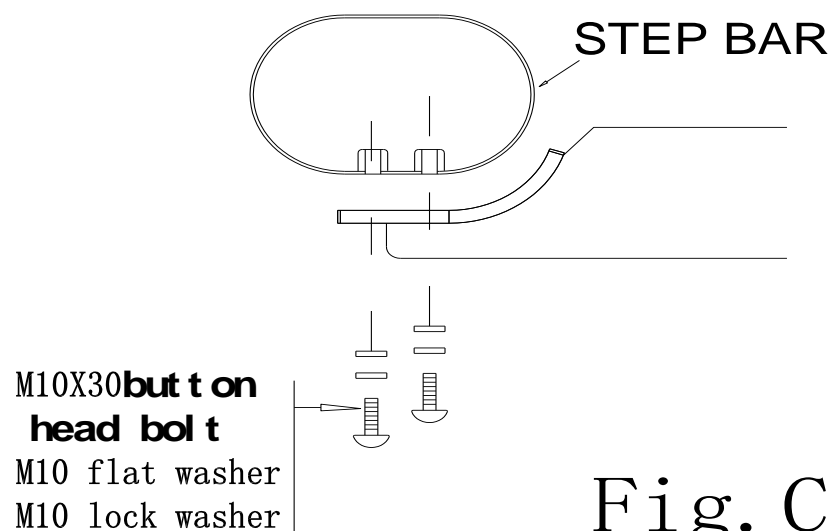

Fig. C

PARTS IDENTIFICATION GUIDE

Driver Side tube taped in "Red" Color. Passenger Side tube taped in "Blue" Color.

No.	Parts Identification
1	Passenger / Right 'Rear' Bracket marked "RR"
2	Driver / Left 'Rear' Bracket marked "RL"
3	Passenger / Right 'Center' Bracket marked "CR"
4	Driver / Left 'Center' Bracket marked "CL"
5	Passenger / Right 'Front' Bracket marked "FR"
6	Driver / Left 'Front' Bracket marked "FL"
7	'Left' marked "L"
8	'Right' marked "R"

Note:

- This guide is to identify the parts and not a reference for part count.
- Product / Bracket image is for representative purpose only.
- Actual design may vary based on application.
- Refer Parts List for Hardware.

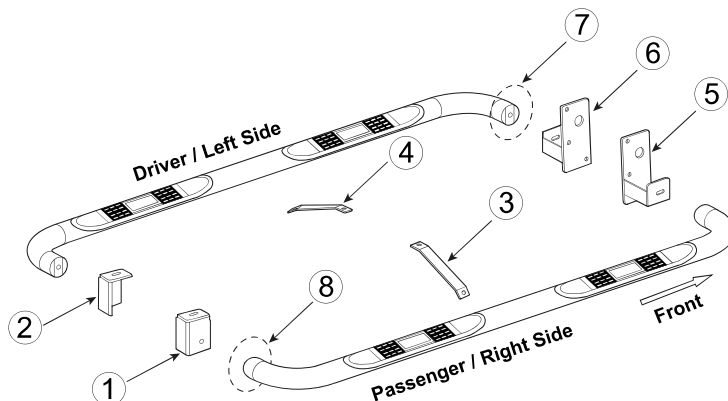
**PRODUCT CARE**

- Periodically check the product to ensure all fasteners are tight and components are intact.
- Regular waxing is recommended to protect the finish of the product.
- Use ONLY Non-Abrasive automotive wax.** Use of any soap, polish or wax that contains an abrasive is detrimental and can scratch the finish leading to corrosion.
- Aluminum polish may be used to polish small scratches and scuffs for **Stainless Steel finish**.
- Mild soap may be used to clean the product for both **Stainless Steel and Black finish**.

FAQ's**1. Hardware's are not of correct size.**

In GMC / Chevrolet truck model 2006 & up, customer needs to reuse the factory body bolts to install the bracket. If your vehicle is not GMC / Chevrolet 2006 & up, ensure that holes are not partially covered with any plastic grommet or rust? If it is, remove the plastic grommet & rust from the thread holes & re-try the installation.

2. Mounting Bracket are not getting Installed properly.

In some cases Illustration images shown in Installation manual may not be the exactly same as per actual vehicle images ,also if Driver / Passenger side mounting brackets are very identical in the design, suggest referring Parts Identification guide to avoid fitment issue.

3. Products are thumping / rattling after installation.

Ensure that all required mounting brackets / hardware's are installed & tighten correctly. Suggest using white lithium / regular grease between the metal to metal contact surfaces.

4. Side Bar is not aligning with vehicle / Step Pads are not aligning with vehicle doors.

Side bar may be interchanged or mounting brackets are not installed at the correct position in the vehicle. Refer Parts identification guide.

5. Missing / Excess Hardware.

Recheck hardware count as per the part list.

6. Product not installing properly.

Ensure make model year, cab length and bed size of your vehicle is listed in the application. All installation steps are followed correctly.

Check out these other TrailFX Products!!

www.TrailFX.com



Keystone Automotive Operations Inc. (KAO) warrants this product to be free of defects in material and workmanship at the time of purchase by the original retail consumer. KAO disclaims any other warranties, express or implied, including the warranty of fitness for a particular purpose or an intended use. If the product is found to be defective, KAO may replace or repair the product at our option, when the product is returned prepaid, with proof of purchase. Alteration to, improper installation, or misuse of this product voids the warranty. KAO's liability is limited to repair or replacement of products found to be defective, and specifically excludes liability for any incidental or consequential loss or damage.