

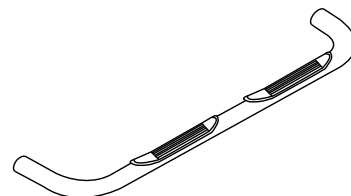

3" Side Bar

Part No. 1130340041/3



Fits: 2004-2008

Ford F150 Super Crew



REMOVE CONTENTS FROM BOX. VERIFY ALL PARTS ARE PRESENT.



READ INSTRUCTIONS CAREFULLY BEFORE STARTING INSTALLATION.

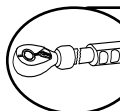

DO NOT OVER TORQUE. STANDARD OPERATING LOAD FOR TIGHTEN BODY MOUNT NUTS & BOLTS VARIES FROM 45 TO 65 FOOT POUND.

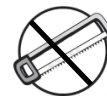

30-60 min

Cutting Not
RequiredDrilling Not
Required

support@trailfx.com



1 866 638 4870

POLISHED STAINLESS STEEL – LIMITED LIFETIME
POWDER COATED BLACK – 3 YEARS

PARTS LIST:

Qty	Part Description	Qty	Part Description
1 Set	Side Bar	8	3/8"-16 Clip Nut Long
1 Set	Front Bracket	8	3/8"-16 Hex Nut
1 Set	Rear Bracket	24	3/8" Flat Washer
4	1/2"-13 x 1 3/4" Hex Head Bolt	16	3/8" Lock Washer
4	1/2"-13 Hex Nut	16	3/8"-16 x 1 1/4" Hex Head Bolt
8	1/2" Lock Washer	4	1/2"-13 x 1 1/2" "T" Bolt plate
8	1/2" Flat Washer		

DRIVER (LEFT) FRONT	DRIVER (LEFT) REAR	PASSENGER (RIGHT) REAR	PASSENGER (RIGHT) FRONT

INSTALLATION PROCEDURE

⚠ IMPORTANT: A magnetic pick up tool is recommended to assist with the installation.

1. Remove the end caps on the side bars before beginning installation.
2. Remove black rubber plugs on inside rocker panel that line up with bracket installation.
3. Install passenger front mounting bracket by placing the bolt plate through hole in body as shown in Figure #1. NOTE: You may need to tape the bolt plate into position with duct tape so that it will stay there while you slide on the bracket. Install 3/8" clip nuts as shown in figure #2. Position front bracket with downward sloping end towards front of vehicle. Attach bracket to bolt plate with 1/2" flat washer, 1/2" lock washer, and 1/2" nut as shown in figure #3. Next, attach 3/8" inch bolts to clip nuts with 3/8" flat washers, 3/8" lock washers, and 3/8" hex nuts as shown in figure #3. Assemble finger tight only.
4. Install rear mounting bracket same as front only with downward sloping end facing rear of vehicle. Again, assemble finger tight.

5. Place step bar tube up to front and rear brackets and fasten with $\frac{1}{2}$ " x 1 $\frac{1}{2}$ " hex head bolts, $\frac{1}{2}$ " flat washers, and $\frac{1}{2}$ " lock washers. Finger tight only.
6. After all mounting points are in place, tighten all bracket bolts accordingly. Next tighten side bar bolts. Recheck bolts periodically.

Front passenger side bolt plate installation

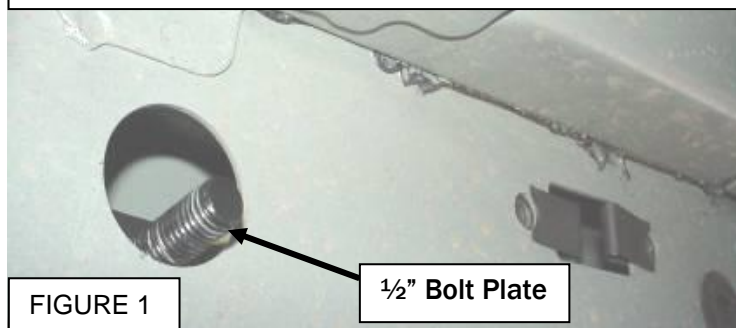

Installation of 3/8" clip nuts

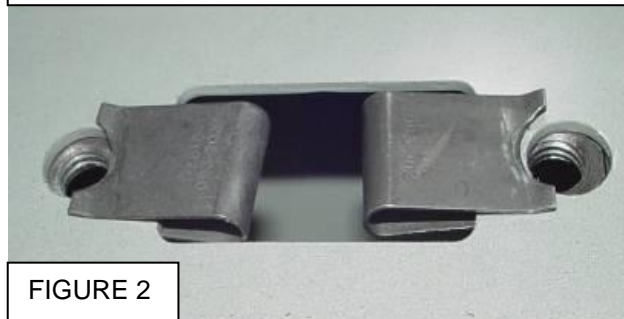

Front Passenger's Side Bracket installation

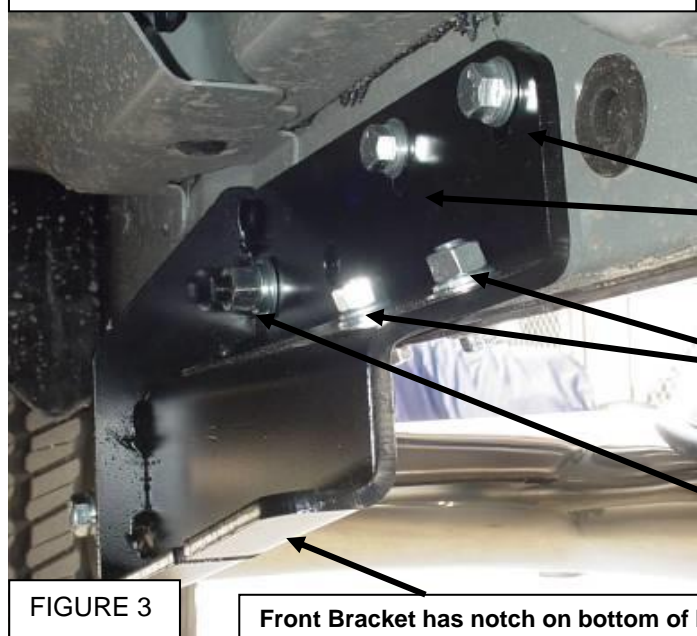

Attach to 3/8" Clip Nuts

Attach through existing holes in rocker panel edge with 3/8" bolts, lock washers, flat washers, and nuts

Attach to rear bolt plate with $\frac{1}{2}$ " nut, flat washer, and lock washer.

Front Bracket has notch on bottom of bracket.

Rear Passenger's Bolt Plate Installation

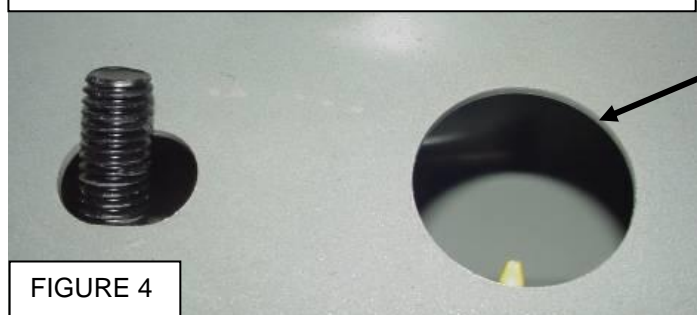

Install Rear Bolt Plate Through



Rear Passenger's Bracket Installation

Attach through existing holes in rocker panel edge with 3/8" bolts, lock washers, flat washers, and nuts

Attach to rear bolt plate with 1/2" nut, flat washer, and lock washer.

FIGURE 5

Passenger Side Rear Mounting Bracket



Passenger Side Front Mounting Bracket



PARTS IDENTIFICATION GUIDE

Driver Side tube taped in "Red" Color. Passenger Side tube taped in "Blue" Color.

No.	Parts Identification
1	Passenger / Right 'Rear' Bracket marked "RR"
2	Driver / Left 'Rear' Bracket marked "RL"
3	Passenger / Right 'Center' Bracket marked "CR"
4	Driver / Left 'Center' Bracket marked "CL"
5	Passenger / Right 'Front' Bracket marked "FR"
6	Driver / Left 'Front' Bracket marked "FL"
7	'Left' marked "L"
8	'Right' marked "R"

Note:

- This guide is to identify the parts and not a reference for part count.
- Product / Bracket image is for representative purpose only.
- Actual design may vary based on application.
- Refer Parts List for Hardware.

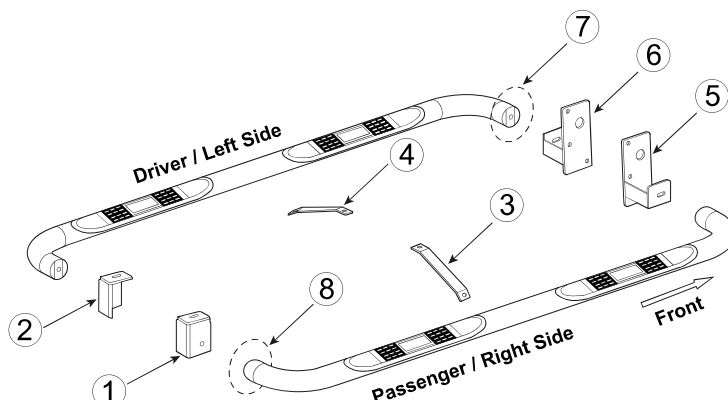

PRODUCT CARE

- Periodically check the product to ensure all fasteners are tight and components are intact.
- Regular waxing is recommended to protect the finish of the product.
- **Use ONLY Non-Abrasive automotive wax.** Use of any soap, polish or wax that contains an abrasive is detrimental and can scratch the finish leading to corrosion.
- Aluminum polish may be used to polish small scratches and scuffs for **Stainless Steel finish.**
- Mild soap may be used to clean the product for both **Stainless Steel and Black finish.**

FAQ's

1. Hardware's are not of correct size.

In GMC / Chevrolet truck model 2006 & up, customer needs to reuse the factory body bolts to install the bracket. If your vehicle is not GMC / Chevrolet 2006 & up, ensure that holes are not partially covered with any plastic grommet or rust? If it is, remove the plastic grommet & rust from the thread holes & re-try the installation.

2. Mounting Bracket are not getting Installed properly.

In some cases Illustration images shown in Installation manual may not be the exactly same as per actual vehicle images ,also if Driver / Passenger side mounting brackets are very identical in the design, suggest referring Parts Identification guide to avoid fitment issue.

3. Products are thumping / rattling after installation.

Ensure that all required mounting brackets / hardware's are installed & tighten correctly. Suggest using white lithium / regular grease between the metal to metal contact surfaces.

4. Side Bar is not aligning with vehicle / Step Pads are not aligning with vehicle doors.

Side bar may be interchanged or mounting brackets are not installed at the correct position in the vehicle. Refer Parts identification guide.

5. Missing / Excess Hardware.

Recheck hardware count as per the part list.

6. Product not installing properly.

Ensure make model year, cab length and bed size of your vehicle is listed in the application. All installation steps are followed correctly.

Check out these other TrailFX Products!!

www.TrailFX.com



BULL BARS



GRILLE GUARDS



BED RAILS



RUNNING BOARDS

Keystone Automotive Operations Inc. (KAO) warrants this product to be free of defects in material and workmanship at the time of purchase by the original retail consumer. KAO disclaims any other warranties, express or implied, including the warranty of fitness for a particular purpose or an intended use. If the product is found to be defective, KAO may replace or repair the product at our option, when the product is returned prepaid, with proof of purchase. Alteration to, improper installation, or misuse of this product voids the warranty. KAO's liability is limited to repair or replacement of products found to be defective, and specifically excludes liability for any incidental or consequential loss or damage.