

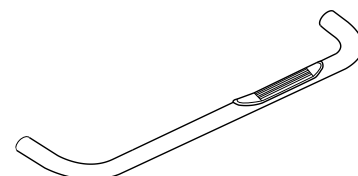

3" Side Bar

Part No. 1120221021/3



Fits: **2002 - 2008 Dodge Ram 1500 Standard Cab**
2003 - 2007 Dodge Ram 2500/3500 Standard Cab



REMOVE CONTENTS FROM BOX. VERIFY ALL PARTS ARE PRESENT.



READ INSTRUCTIONS CAREFULLY BEFORE STARTING INSTALLATION.



DO NOT OVER TORQUE. STANDARD OPERATING LOAD FOR TIGHTEN BODY MOUNT NUTS & BOLTS VARIES FROM 45 TO 65 FOOT POUND.



30-60 min

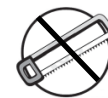

Cutting Not Required



Drilling Not Required



support@trailfx.com



1 866 638 4870



POLISHED STAINLESS STEEL – LIMITED LIFETIME
 POWDER COATED BLACK – 3 YEARS

PARTS LIST:

Qty	Part Description	Qty	Part Description
1 Set	Side Bar	4	3/8"-16 x 1 1/4" Hex Head Bolt
1 Set	Front Bracket	12	3/8" Flat Washer
1 Set	Rear Bracket	8	3/8" Lock Washer
1 Set	Front Support Bracket	8	3/8"-16 Hex Nut
1 Set	Rear Support Bracket	4	3/8"-16 x 1 1/2" Bolt Plate
8	1/2" Flat Washer	4	1/2"-13 x 1 1/2" Hex Head Bolt
8	1/2" Lock Washer	4	M12-1.75 x 120mm Hex Head Bolt
8	3/8" Plastic Washer		

DRIVER (LEFT) FRONT	DRIVER (LEFT) REAR	PASSENGER (RIGHT) REAR	PASSENGER (RIGHT)FRONT
DRIVER (LEFT)FRONT SUPPORT	DRIVER(LEFT) REAR SUPPORT	PASSENGER (RIGHT) REAR SUPPORT	PASSENGER (RIGHT)FRONT SUPPORT

INSTALLATION PROCEDURE

⚠ IMPORTANT: A magnetic pick up tool is recommended to assist with the installation.

1. Remove the end caps on the side bars before beginning installation.
2. Remove the four body mounting bolts from the vehicle. These are M12-1.75 metric bolts that are not reused in the installation. The body mounting steel washer plate and rubber cushion are reused between the body mount and the side bar mounting brackets. Remove the two black rubber plugs over the holes on each inside face of the rocker panel that are in front of each rear body mount.

3. Use the M12-1.75x120mm Hex Head Bolt and 1/2" Flat and Lock Washers to install the front and rear side bar brackets onto the body mounts as shown. Hands tighten only.
4. Position and install the rear support brackets between the side bar brackets and the rocker panel as shown. Install the rocker panel end with the 3/8" bolt plate, 3/8" nut, lock washer and flat washer. Install the other end to the side bar bracket with a 3/8" x 1 1/2" bolt and 3/8" washer, lock washer and nut. Again, tighten only hand tight.
5. Place the side step tube up to the front bracket and fasten with the 1/2" x 1 1/2" hex head bolt and 1/2" lock washer and washer. Repeat process for the rear. Again only finger tight.
6. Now tighten body mount bolts first then align side step and tighten the support brackets and side step bolts. (1/2" Bolts – 65 FT/LBS, 3/8" – 28 FT/LBS.)
7. Recheck bolts periodically.



Passenger Side Rear Main Bracket and Rear Auxiliary Bracket (Looking towards rear of truck).



Passenger Side Rear Main Bracket and Rear Auxiliary Bracket (Looking towards front of truck).



Hook front auxiliary bracket to inside of Rocker panel just like the rear.

Driver's Side Front Bracket (Looking towards front of truck) Attach front auxiliary bracket to front main bracket here with 3/8".

PARTS IDENTIFICATION GUIDE

Driver Side tube taped in "Red" Color. Passenger Side tube taped in "Blue" Color.

No.	Parts Identification
1	Passenger / Right 'Rear' Bracket marked "RR"
2	Driver / Left 'Rear' Bracket marked "RL"
3	Passenger / Right 'Center' Bracket marked "CR"
4	Driver / Left 'Center' Bracket marked "CL"
5	Passenger / Right 'Front' Bracket marked "FR"
6	Driver / Left 'Front' Bracket marked "FL"
7	'Left' marked "L"
8	'Right' marked "R"

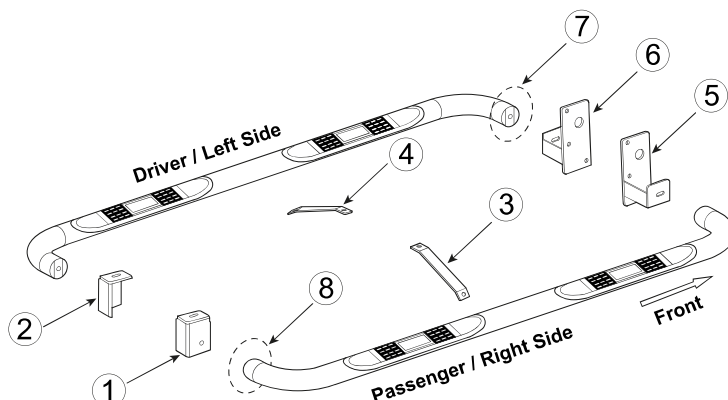

- Note:**
- This guide is to identify the parts and not a reference for part count.
 - Product / Bracket image is for representative purpose only.
 - Actual design may vary based on application.
 - Refer Parts List for Hardware.

PRODUCT CARE

- Periodically check the product to ensure all fasteners are tight and components are intact.
- Regular waxing is recommended to protect the finish of the product.
- **Use ONLY Non-Abrasive automotive wax.** Use of any soap, polish or wax that contains an abrasive is detrimental and can scratch the finish leading to corrosion.
- Aluminum polish may be used to polish small scratches and scuffs for **Stainless Steel finish.**
- Mild soap may be used to clean the product for both **Stainless Steel and Black finish.**

FAQ's**1. Hardware's are not of correct size.**

In GMC / Chevrolet truck model 2006 & up, customer needs to reuse the factory body bolts to install the bracket. If your vehicle is not GMC / Chevrolet 2006 & up, ensure that holes are not partially covered with any plastic grommet or rust? If it is, remove the plastic grommet & rust from the thread holes & re-try the installation.

2. Mounting Bracket are not getting Installed properly.

In some cases Illustration images shown in Installation manual may not be the exactly same as per actual vehicle images ,also if Driver / Passenger side mounting brackets are very identical in the design, suggest referring Parts Identification guide to avoid fitment issue.

3. Products are thumping / rattling after installation.

Ensure that all required mounting brackets / hardware's are installed & tighten correctly. Suggest using white lithium / regular grease between the metal to metal contact surfaces.

4. Side Bar is not aligning with vehicle / Step Pads are not aligning with vehicle doors.

Side bar may be interchanged or mounting brackets are not installed at the correct position in the vehicle. Refer Parts identification guide.

5. Missing / Excess Hardware.

Recheck hardware count as per the part list.

6. Product not installing properly.

Ensure make model year, cab length and bed size of your vehicle is listed in the application. All installation steps are followed correctly.

Check out these other TrailFX Products!!

www.TrailFX.com



BULL BARS



GRILLE GUARDS



BED RAILS



RUNNING BOARDS

Keystone Automotive Operations Inc. (KAO) warrants this product to be free of defects in material and workmanship at the time of purchase by the original retail consumer. KAO disclaims any other warranties, express or implied, including the warranty of fitness for a particular purpose or an intended use. If the product is found to be defective, KAO may replace or repair the product at our option, when the product is returned prepaid, with proof of purchase. Alteration to, improper installation, or misuse of this product voids the warranty. KAO's liability is limited to repair or replacement of products found to be defective, and specifically excludes liability for any incidental or consequential loss or damage.