

## FORD Mustang BTS

**Please note: The installation of springs and struts should be performed by qualified and experienced persons.**

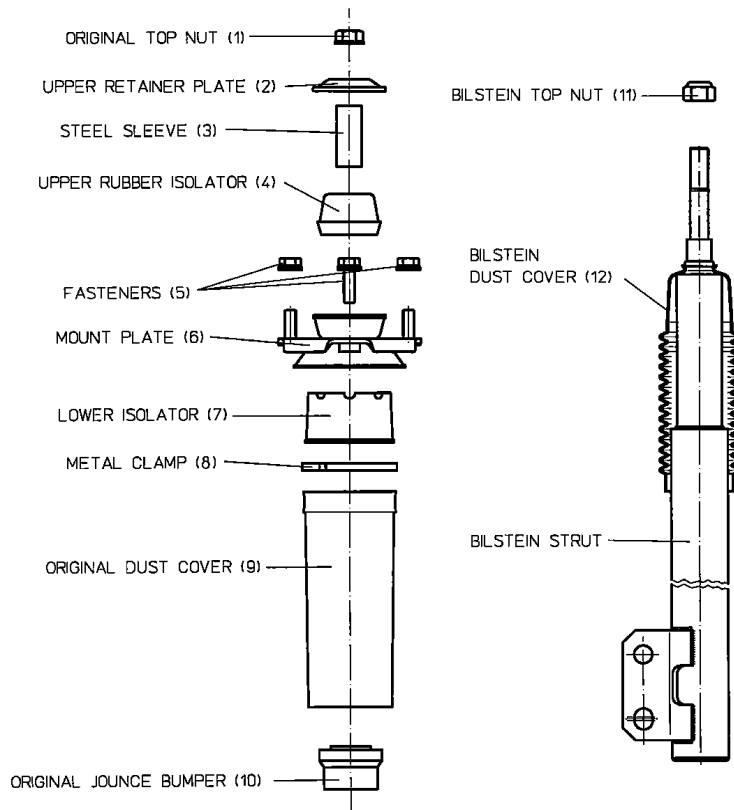

### Front strut installation

1. Remove OE strut from vehicle, referring to manufacturer's Service Manual.
2. Discard original jounce bumper (10) located on OE strut piston rod or inside OE dust cover (9). The Bilstein strut has a built-in jounce bumper.
3. Decide whether to re-use OE dust cover, or Bilstein replacement dust cover (12).
  - If Bilstein dust cover (12) is used, remove the metal clamp (8) from the top of the OE dust cover (9), and pull the dust cover downward off of the lower isolator (7). Discard the clamp and dust cover.
  - If original dust cover will be used, pull the Bilstein dust cover (12) upward off the Bilstein strut, and discard.
4. Assemble the upper mounting parts to the Bilstein strut as follows:
  - Lower isolator (7) (with OE dust cover, if re-used).
  - Mount plate (6)
  - Upper rubber isolator (4)
  - Steel sleeve (3)
  - Upper retainer plate (2)
  - Bilstein top nut (11); torque to 75 – 125 Nm (55 – 100 ft/lbs) (discard original top nut (1))
5. Mount Bilstein strut into vehicle, referring to instructions in vehicle manufacturer's Service Manual.
6. Torque lower strut mount bolts to 215 – 235 Nm (160 – 180 ft/lbs)
7. Set front wheel alignment to O.E. specifications

### Rear shock installation

Torque specifications:

Upper mount 25Nm (20 ft/lbs)  
Lower mount 45Nm (35 ft/lbs)

**Upper spring isolators and pinion snubber, when supplied, are to be used for the following:**

	<u>FRONT</u>	<u>REAR</u>	<u>SNUBBER</u>
'87-93 Coupe	None	None	199012
'87-93 Convertible	None	199010	199012
'94-'02 Coupe	199011	None	199012
'94-'02 Convertible	199011	199010	199012
'99-'01 Cobra	199011	None	None