

ROUGH COUNTRY

SUSPENSION SYSTEMS®

JEEP 2015-19 WK2 Forged Tow Hooks

Thank you for choosing Rough Country for all your vehicle needs.

Please read instructions before beginning installation. Check the kit hardware against the kit contents shown below. Be sure you have all needed parts and know where they go.

If question exist, please call us @1-800-222-7023. We will be happy to answer any questions concerning this product.

Check all fasteners for proper torque. Check to ensure for adequate clearance between all components.

Periodically check all hardware for tightness.

KIT CONTENTS:
 Driver Tow Hook x1
 Passenger Tow Hook x1

TOOLS NEEDED:
 10mm Wrench or Socket
 13mm Socket
 17mm Socket
 30mm Socket or Wrench
 Ratchet
 Pry Tool

HARDWARE INCLUDED:
 10mm-1.5 x 35mm Hex Head Bolts x4
 10mm Flat Washer x4
 10mm Lock Washer x4



Torque Specs:

Size	Grade 5	Grade 8	Size	Class 8.8	Class 10.9
5/16"	15 ft/lbs	20ft/lbs	6MM	5ft/lbs	9ft/lbs
3/8"	30 ft/lbs	35ft/lbs	8MM	18ft/lbs	23ft/lbs
7/16"	45 ft/lbs	60ft/lbs	10MM	32ft/lbs	45ft/lbs
1/2"	65 ft/lbs	90ft/lbs	12MM	55ft/lbs	75ft/lbs
9/16"	95 ft/lbs	130ft/lbs	14MM	85ft/lbs	120ft/lbs
5/8"	135ft/lbs	175ft/lbs	16MM	130ft/lbs	165ft/lbs
3/4"	185ft/lbs	280ft/lbs	18MM	170ft/lbs	240ft/lbs



INSTALLATION INSTRUCTONS

1. Remove the 2 bolts on each side of the inner fender well using a 10mm wrench. Retain hardware. **See Photo 1.**
2. Remove the 4 bolts in the rear skid plate using a 15mm socket. Set the skid plate and hardware aside for reuse. See Photo 2.

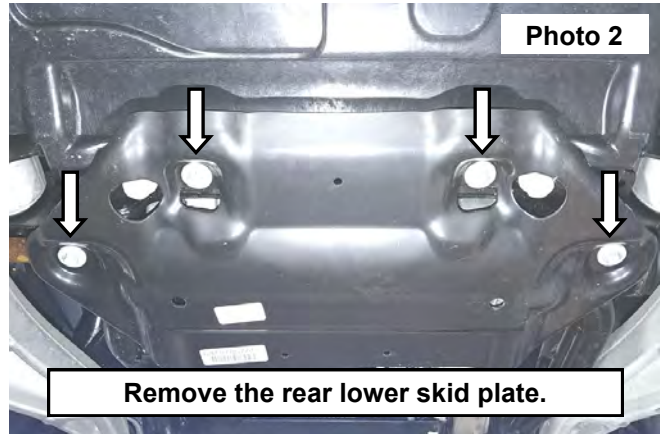
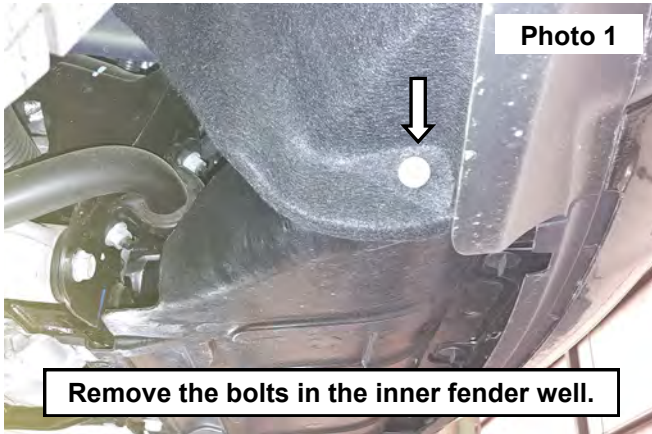

3. Support while removing the (3) bolts using a 13mm socket and (1) push pin in the front skid plate using a auto trim puller. **See Photo 3.**
4. Remove the nut from the rear of the tow hook using a 30mm socket. **See Photo 4.**

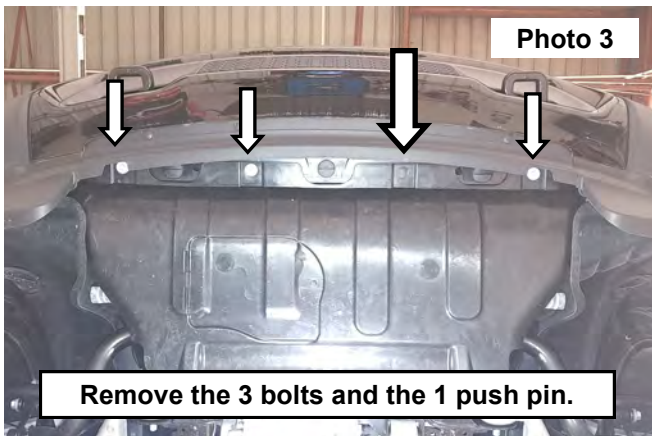

5. Remove the (2) bolts in the front of the tow hook using a 17mm wrench. Remove the tow hook. **See Photo 5.**
6. Remove the front bolt in the tow hook mount using a 17mm socket. **See Photo 6.**

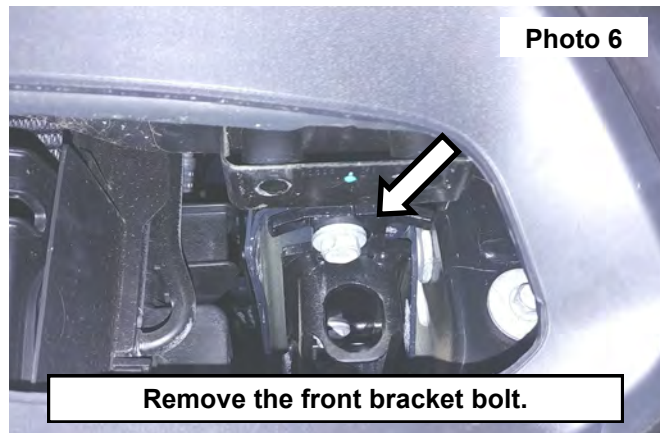
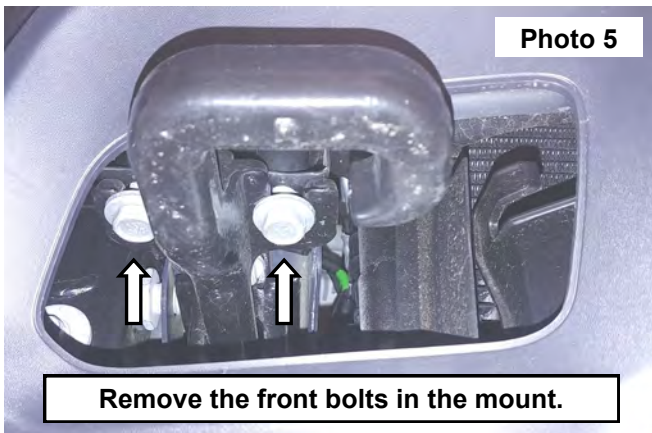

7. Remove the rear bolt in the tow hook mount using a 17mm socket. Remove the tow hook mount. **See Photo 7.**
8. Install the new tow hook using (2) of the supplied 10mm-1.5 x 35mm hex head bolts, (2) 10mm lock washers and (2) 10mm flat washers. **See Photos 8 and 9.**



9. Install the front and rear skid plates using the retained OE hardware. Tighten using a 13mm & 15mm wrench. **See Photo 10.**



10. Install the fender well bolts using the retained OE hardware. Tighten using a 10mm wrench. **See Photo 11.**
11. Showing the tow hook installed. **See Photo 12.**

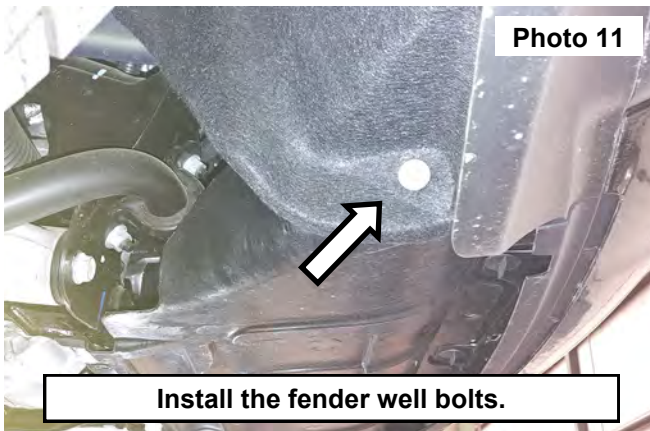

By purchasing any item sold by Rough Country, LLC, the buyer expressly warrants that he/she is in compliance with all applicable, State, and Local laws and regulations regarding the purchase, ownership, and use of the item. It shall be the buyers responsibility to comply with all Federal, State and Local laws governing the sales of any items listed, illustrated or sold. The buyer expressly agrees to indemnify and hold harmless Rough Country, LLC for all claims resulting directly or indirectly from the purchase, ownership, or use of the items.



