

POLARIS 2017-2021 RZR 1000 Winch Mounting Plate

Thank you for choosing Rough Country for all your vehicle needs.

Please read instructions before beginning installation. Check the kit hardware against the kit contents shown below. Be sure you have all needed parts and know where they go.

If question exist, please call us @1-800-222-7023. We will be happy to answer any questions concerning this product. Check all fasteners for proper torque. Check to ensure for adequate clearance between all components.

Periodically check all hardware for tightness.

KIT CONTENTS:

RS4500 Winch Kit x1
Winch Plate x1
Hawse Fairlead Mount x1

TOOLS NEEDED:

T40 Torx Bit
Ratchet
9/16 Wrench
13mm Wrench and Socket
14mm Wrench and Socket
15mm Wrench and Socket
19mm Socket

HARDWARE INCLUDED:

3/8-16 x3/4 Carriage Bolts x4
3/8-16 Flange Lock Nuts x4



Torque Specs:

Size	Grade 5	Grade 8	Size	Class 8.8	Class 10.9
5/16"	15 ft/lbs	20ft/lbs	6MM	5ft/lbs	9ft/lbs
3/8"	30 ft/lbs	35ft/lbs	8MM	18ft/lbs	23ft/lbs
7/16"	45 ft/lbs	60ft/lbs	10MM	32ft/lbs	45ft/lbs
1/2"	65 ft/lbs	90ft/lbs	12MM	55ft/lbs	75ft/lbs
9/16"	95 ft/lbs	130ft/lbs	14MM	85ft/lbs	120ft/lbs
5/8"	135ft/lbs	175ft/lbs	16MM	130ft/lbs	165ft/lbs
3/4"	185ft/lbs	280ft/lbs	18MM	170ft/lbs	240ft/lbs



INSTALLATION INSTRUCTONS

1. Removing the front headlight support for installation of the winch shown in photos 1-6.
2. Disconnect the headlights on the driver and passenger side. **See Photo 1.**
3. Remove the top access cover and set aside. Then using a T40 torx bit to remove the top (2) bolts from the middle of the support. **See Photo 2.** Retain hardware.

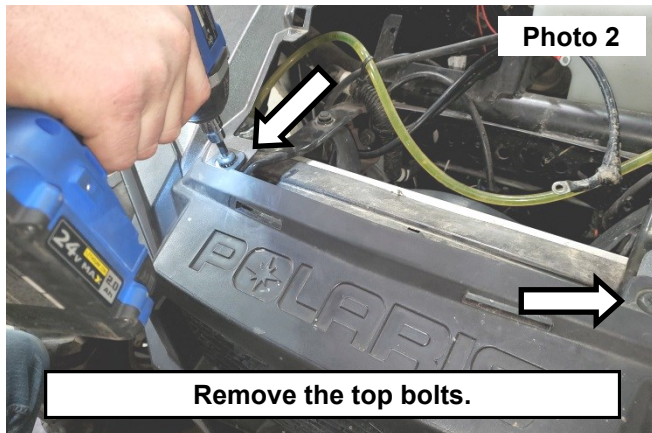
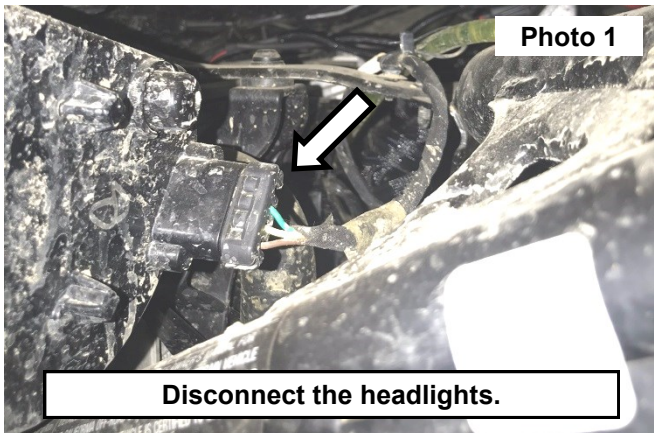

4. Remove the front center (2) bolts in the support using a T40 torx bit. **See Photo 3.** Retain hardware.
5. Remove the lower (2) bolts in the support using a T40 torx bit. **See Photo 4.** Retain hardware.

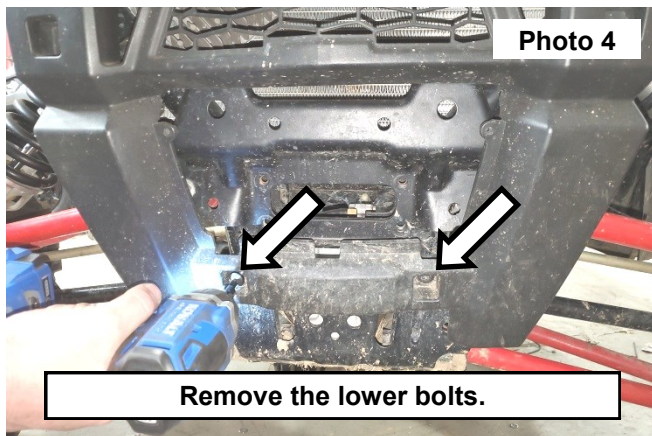
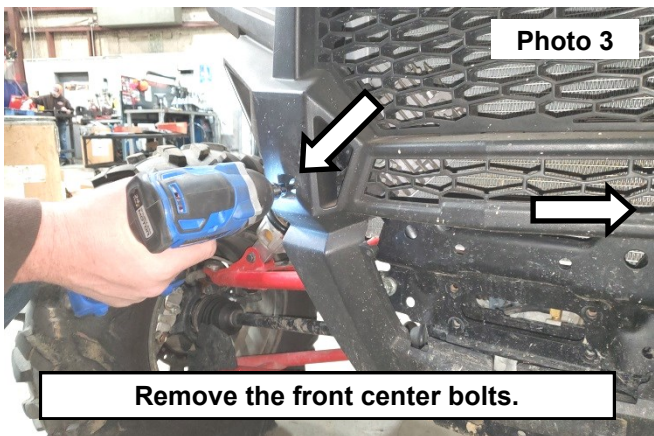

6. Remove the (2) bolts on the driver and passenger side of the headlight using a T40 torx bit. **See Photo 5.**
7. Remove the headlight support, set aside in a safe place. **See Photo 6.**

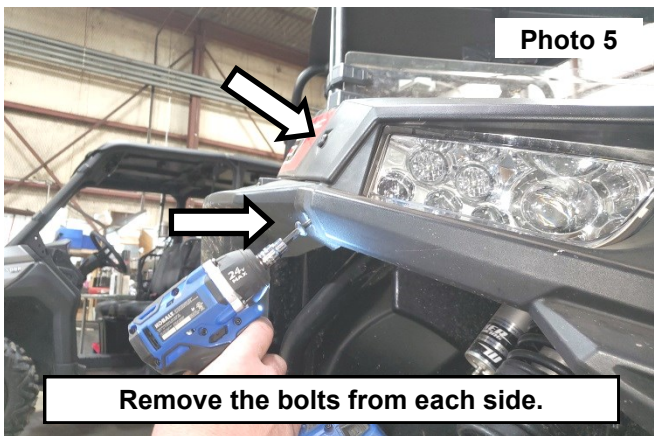

8. Using a 15mm socket remove the (2) nuts from the upper control arm mount. **See Photo 7.** Retain hardware.
9. Remove the control arm plate from the UTV. **See Photo 8.**

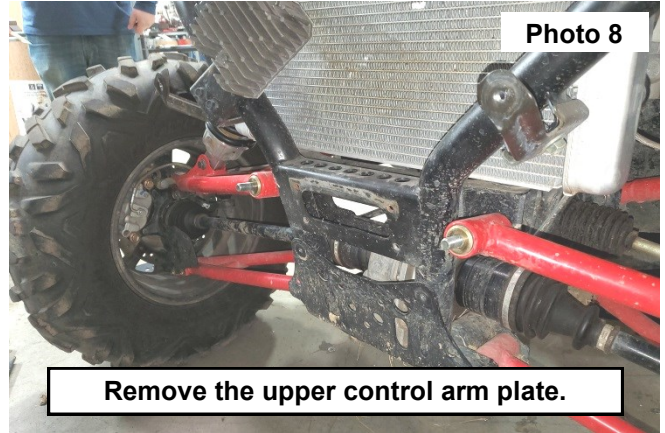

10. Install the hawse fairlead onto the front of the fairlead mount using (2) of the supplied 8mm-1.25 x 25mm hex head bolts, (4) 8mm washers, (2) lock washers and (2) nuts. Tighten the hardware using a 13mm socket on the bolt and a 14mm wrench on the nut. **See Photos 9 and 10.**

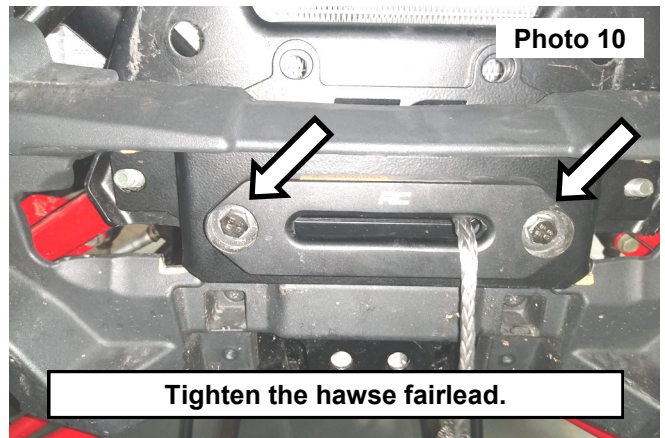
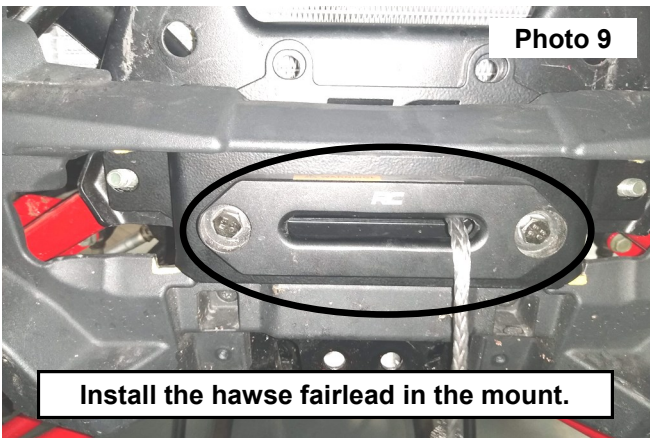

11. Install the assembled hawse fairlead mount on the bolts of the upper control arm. Then secure using the OE nuts. Tighten using a 15mm socket. **See Photo 11.**
12. Using a jack raise up the front of the UTV. Then place jack stands on each side of the frame rail and lower the jack.
13. Remove the left front wheel using a 19mm socket. **See Photo 12.**

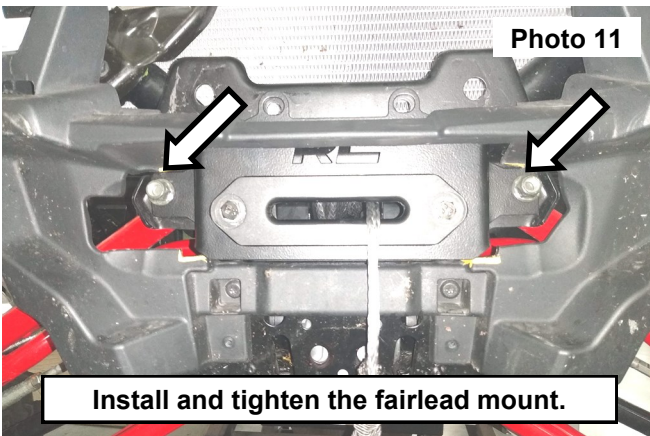

14. Using a 15mm socket remove the bolt from the lower Coilover mount in the upper control arm. **See Photo 13.** Retain hardware.
15. With the upper mount still connected swing the Coilover up to make room for the winch to be installed in step 18.
16. Install the (4) square nuts into the mounts of the winch. **See Photo 14.**

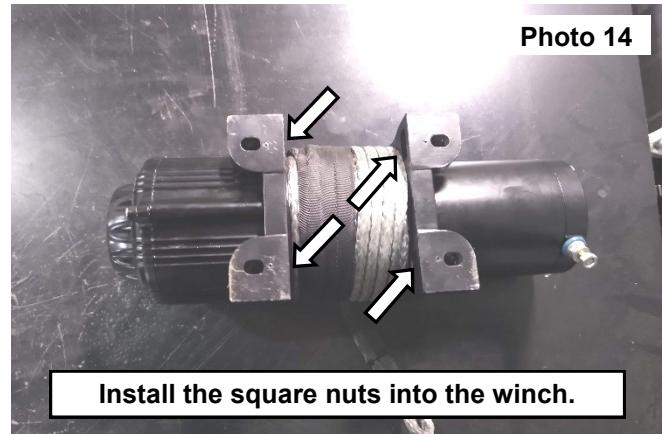
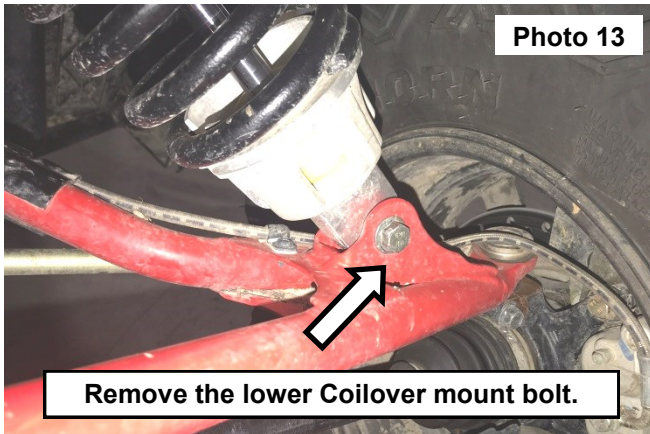

17. Install the winch plate onto the winch using (4) of the supplied 8mm-1.25 x 25mm hex head bolts, (4) lock washers and (4) flat washers. The cable of the winch will exit to the front of the mount. Tighten using a 13mm socket. **See Photo 15.**
18. Tighten the hardware using a 13mm socket. **See Photo 16.**

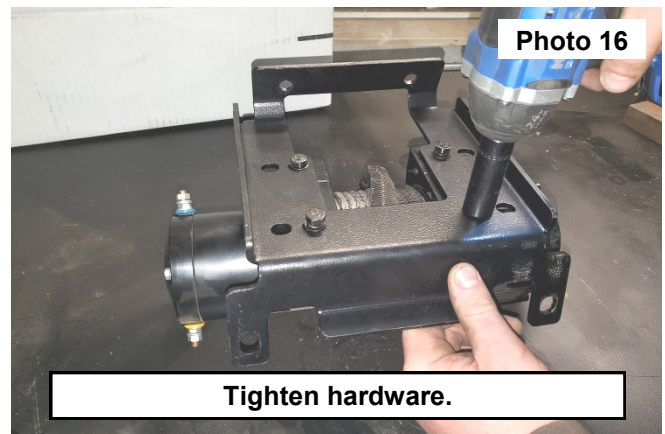
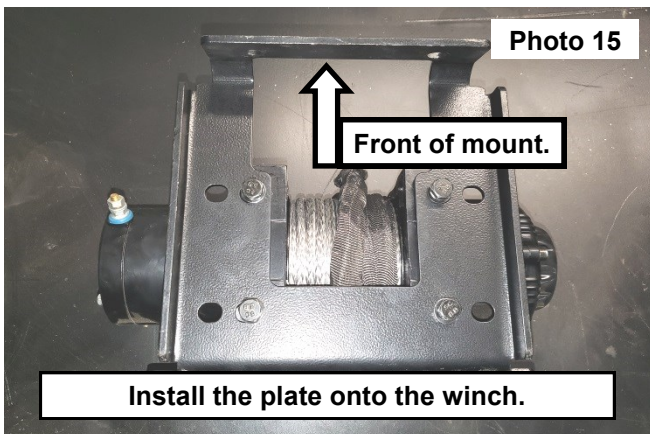

19. Raise the Coilover up to clear the assembled winch and winch plate into the center of the UTV. **See Photo 17.**
20. Secure the winch plate using (4) of the supplied 3/8-16 x 3/4 carriage bolts and (4) of the 3/8-16 flange lock nuts. Tighten using a 9/16 wrench. **See Photo 18.**

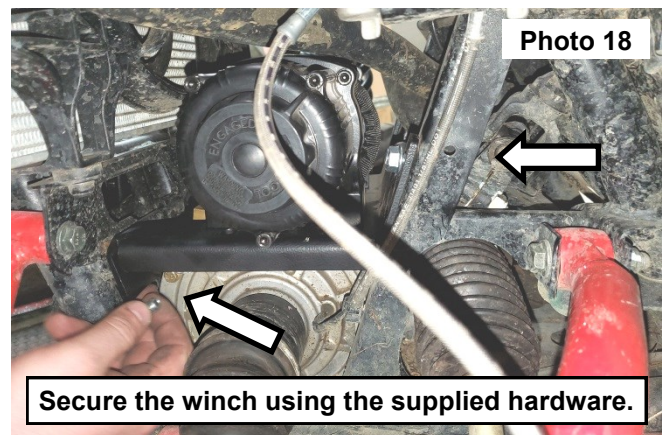
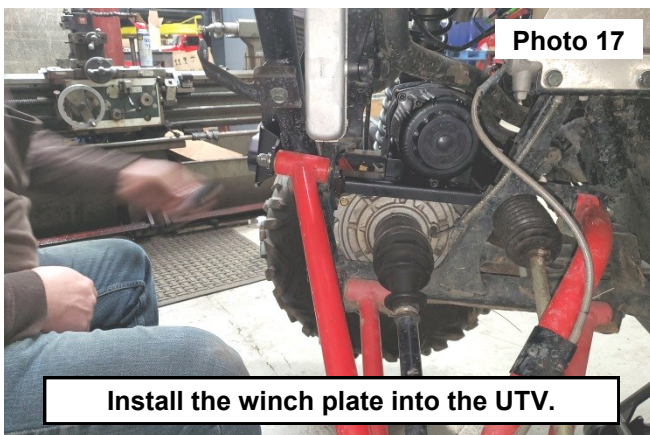

21. Mount the relay box and connect the power wires to the UTV using the corresponding instruction sheet supplied with the winch kit. **See Photo 19.**
22. Place the Coilover into the lower mount using the retained OE bolt. Then tighten using a 15mm wrench and socket. **See Photo 20.**
23. Install the wheel and tire and tighten using a 19mm socket. Using a jack raise the front of the UTV up and remove the jack stands. Then lower onto the ground.

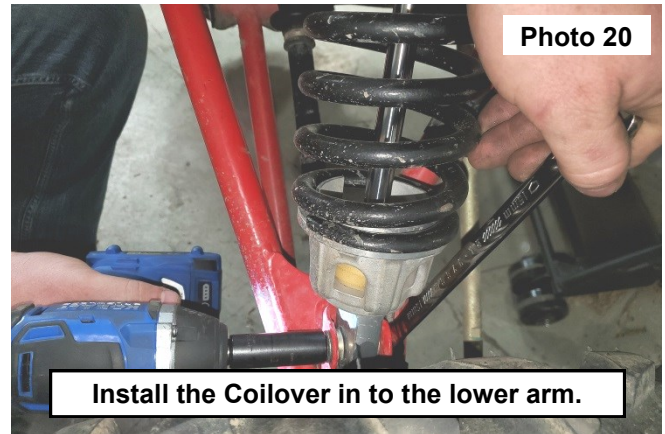
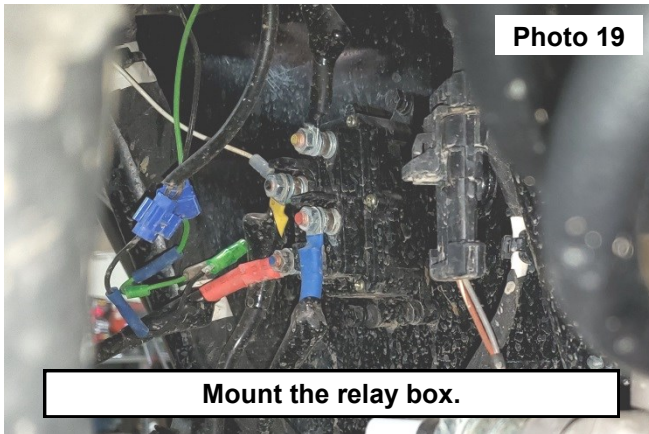

24. Insert the rope through the fairlead and install the hook and pin. Secure with the supplied cotter pin. **See Photo 21.**
25. Install the headlight support using the retained OE hardware. Tighten using a T40 torx bit. **See Photos 22 and 23.**
NOTE: On Premium models, the facia may require some trimming to clear the fairlead bracket.

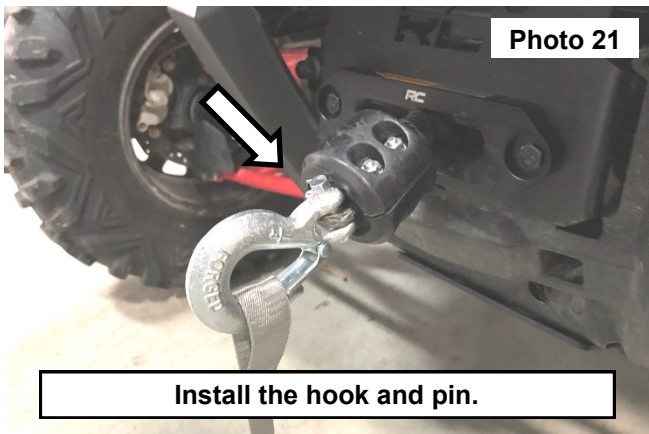

26. Install the top access cover. **See Photo 24.**
27. Connect the head light plugs on the driver and passenger side.

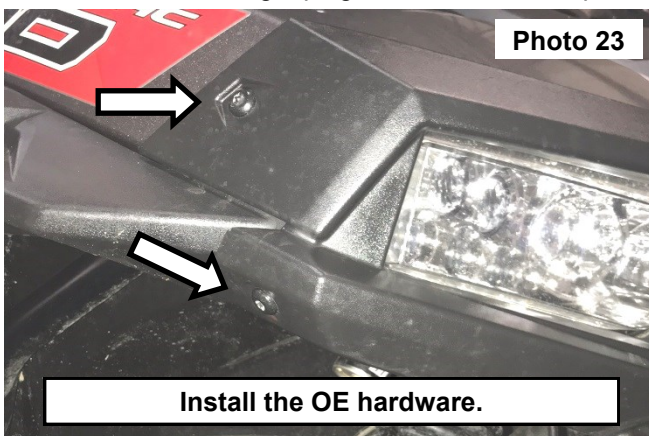

By purchasing any item sold by Rough Country, LLC, the buyer expressly warrants that he/she is in compliance with all applicable, State, and Local laws and regulations regarding the purchase, ownership, and use of the item. It shall be the buyers responsibility to comply with all Federal, State and Local laws governing the sales of any items listed, illustrated or sold. The buyer expressly agrees to indemnify and hold harmless Rough Country, LLC for all claims resulting directly or indirectly from the purchase, ownership, or use of the items.



