

Installation Manual



WIRELESS AIR SPRING REMOTE

Requires Air Springs & Air Spring Controls *(sold separately)*

Giving you the ability to adjust your air spring pressure from the palm of your hand with the touch of a button. It's the perfect means to control your vehicle's air suspension system from inside or outside your vehicle!

Thank you and congratulations on the purchase of a Wireless Air Spring Remote.

IMPORTANT

For safe and proper operation of the vehicle, never exceed a maximum of 100PSI in the air springs. Staying under the pressure limit will ensure maximum air spring life. **Failure in doing so may result in damage to your vehicle and/or a void warranty.**

Safety Warnings!

! Please read and abide the instructions found in this manual, paying close attention to the helpful, cautionary or dangerous warning icons highlighting important safety recommendations and maintenance suggestions throughout this manual.

HELPFUL INSTALL TIP
 Additional information that could potentially make the job a little easier.

PLEASE USE CAUTION
 Unsafe practices could result in damage to you or your vehicle, or others.

DANGER WARNING
 Hazards which could result in severe personal injury or death.

! Do not use the device while driving or otherwise operating a motor vehicle.

! Serious personal injury or death may result from an air spring failure or accident due to improper air spring pressure operation or maintenance.

! Inflating an unsecured air spring is dangerous. If it bursts, it could be hurled into the air with explosive force resulting in serious personal injury or death. Never inflate an air spring unless it is secured to the vehicle.

ADDITIONAL WARNINGS AND PRECAUTIONS

- Prevent the charging port from coming into contact with foreign materials such as metal, liquids, or dust
- Do not expose the device to impact, bending, or other physical damage
- Do not disassemble, crush, or puncture the device
- Do not turn on, use, or plug in the device if the battery pack is exposed, damaged or leaking
- Do not use the device in a hot environment or near open flame
- If any part of the device smokes, or emits a burning odor, stop using the device immediately

THIS DEVICE MAY BE DAMAGED IF WATER OR DUST ENTERS THE DEVICE

- Do not immerse the device in water or keep it submerged for extended duration
- If the device is exposed to water, dry it thoroughly with a clean, soft cloth. If the device is exposed to oil, grease, chemicals, or other liquids, carefully rinse it with clean, fresh water and dry it thoroughly with a clean, soft cloth

Failure to follow these instructions may affect the device's performance and/or appearance

DISPOSAL

- This device contains a Lithium-Ion battery. For safe disposal options, contact your nearest service center
- Be sure to dispose of your device properly. In some areas, the disposal of batteries in household or business trash may be prohibited

WIRELESS AIR SPRING CONTROLS

POWERING THE DEVICE

A Power ON — Press and hold the power button (on the right side of the device).

Power OFF — Press and hold the power button, then choose ‘Shut Down’ in the pop-up menu.

Restart Device — Press and hold the power button, then choose ‘Restart’ in the pop-up menu.

B CHARGING DEVICE

The device can be charged by connecting via the **USB Type-C** port to a certified charging head.

The device can be used while charging.

+ *The device may heat up when charging. This is normal and will not affect the life or performance of the device*

CONNECTING THE DEVICE

Once the device is powered ON, press the **Connect Device** button.

REMOTE FUNCTIONALITY

C BLUETOOTH TOGGLE

Tap the **Bluetooth** toggle to manually connect or disconnect from the controller.

+ *The remote automatically connects to the most recent paired device if it is active and in range on start-up*

D SETTINGS MENU

UNITS — Pressure read out can be changed from either **PSI** or **KPA**.

CHANNEL MODE — Select between **Single** or **Dual Channel** Air Spring Controls depending on the kit purchased.

+ *Single Channel Mode must be selected when using a single channel kit, since there will be unexpected behaviours if dual-channel mode is used with single channel hardware*

CALIBRATE — to recalibrate the pressure sensors, ensure the air springs are fully drained and then press **Calibrate**.

SCREEN BRIGHTNESS — use the slider to adjust the brightness of the remote's screen.

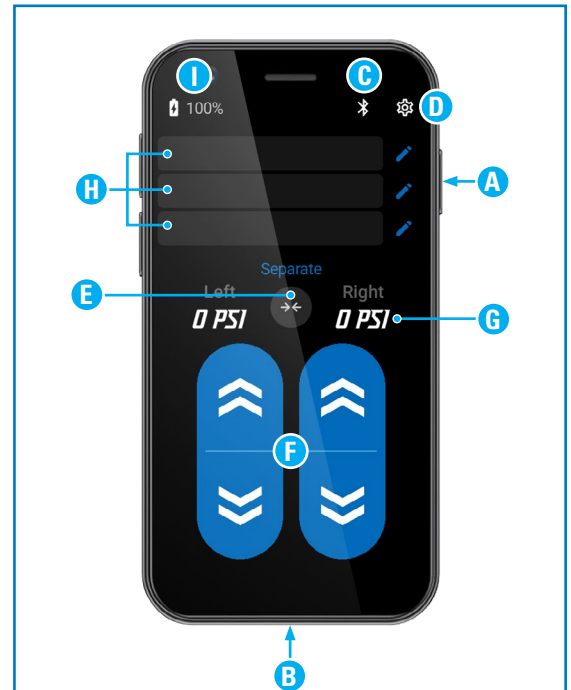

WIRELESS REMOTE	
A	Power ON / Power OFF Button
B	Charging Port [USB Type-C]
C	Bluetooth
D	Settings / Help
E	Air Spring Selection: Combined / Separate
F	Air Spring Pressure Control
G	Pressure Indicator
H	Preset Tabs
I	Battery

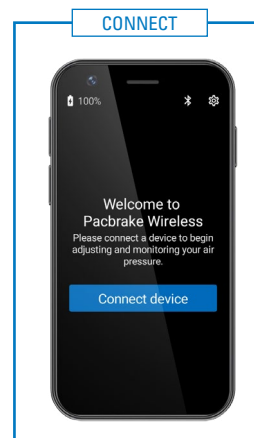

E AIR SPRING SELECTION

Use the **Air Spring Selection** tab/button to select which air spring(s) to inflate/deflate.

- ↔ **Combined** — inflates/deflates both springs simultaneously
- < **Separate** — inflates/deflates each air spring independently

F AIR SPRING PRESSURE CONTROL

Press and hold the **Inflation** (↗) or **Deflation** (↘) button to adjust the pressure in the air springs.

! PLEASE NOTE: *The wireless remote does not limit the minimum or maximum pressure in your air springs. Inflate your air springs according to your air spring manufacturer's guidelines.*

G PRESSURE INDICATOR

The **Pressure Indicator** shows the pressure of each air spring with an accuracy of $\pm 5\%$ over the entire range.

The presets allow for rapid adjustment to the desired pressure (± 1 PSI).

H PRESETS TABS

Use the 3 **Presets Tabs** to save pressure presets.

To save a preset, press the edit tab button next to the preset line you wish to edit.

In the pop-up menu, you can name the preset and save the current pressures by tapping the overwrite with current button.

+ *A message on the bottom of the screen will indicate that the preset has been saved.*

Use these presets anytime to quickly adjust to the desired pressure.

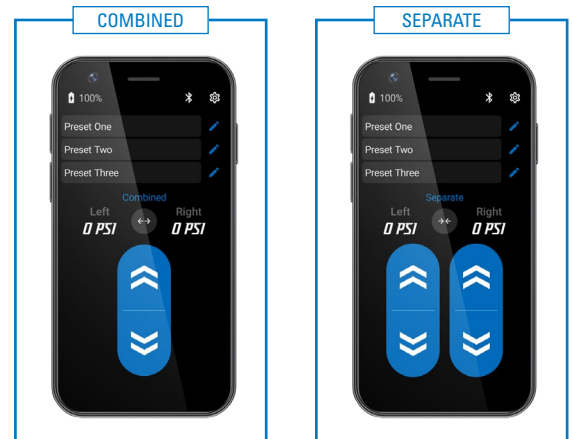

DISCLAIMER

Driving while distracted can result in loss of vehicle control that may lead to an accident, severe personal injury, or death.

The driver’s primary responsibility is in the safe and legal operation of a vehicle, and use of any handheld devices, other equipment, or vehicle systems which take the driver’s eyes, attention and focus away from the safe operation of a vehicle or which are not permissible by law should never be used during operation of the vehicle.

FCC NOTICE

This device complies with Part 15 of the FCC Rules. Operation is subject to the following two conditions:

1. This device may not cause harmful interference
2. This device must accept any interference received, including interference that may cause undesired operation

NOTE 1: This equipment has been tested and found to comply with the limits for a Class B digital device, pursuant to part 15 of the FCC Rules. These limits are designed to provide reasonable protection against harmful interference in a residential installation. This equipment generates, uses and can radiate radio frequency energy and, if not installed and used in accordance with the instructions, may cause harmful interference to radio communications. However, there is no guarantee that interference will not occur in a particular installation. If this equipment does cause harmful interference to radio or television reception, which can be determined by turning the equipment off and on, the user is encouraged to try to correct the interference by one or more of the following measures:

- Reorient or relocate the receiving antenna.
- Increase the separation between the equipment and receiver.
- Connect the equipment into an outlet on a circuit different from that to which the receiver is connected.
- Consult the dealer or an experienced radio/TV technician for help.

NOTE 2: Any changes or modifications not expressly approved by the party responsible for compliance could void the user’s authority to operate the equipment.

