



# INSTALLATION GUIDE

Performance Intercooler, Fits 2023+ Toyota GR Corolla

SKU: MMINT-GRC-23

## TABLE OF CONTENTS

- Pg 1** RESOURCES AND CONTACT INFORMATION
- Pg 2** IMPORTANT SAFETY INFORMATION  
REQUIRED TOOLS  
INSTALLATION INSTRUCTIONS
- Pg 7** DISPOSAL INSTRUCTIONS  
WARRANTY INFORMATION

## RESOURCES & CONTACT

-  **CALL 1-877-GOMISHI**  
CUSTOMER SERVICE HOURS: MON-FRI 8:30AM-5:00PM EST
-  **MISHIMOTO**
-  **GOMISHIMOTO**
-  **MISHIMOTO**
-  **WEBSITE**  
[WWW.MISHIMOTO.COM](http://WWW.MISHIMOTO.COM)
-  **ENGINEERING BLOG**  
[WWW.MISHIMOTO.COM/ENGINEERING](http://WWW.MISHIMOTO.COM/ENGINEERING)

## PARTS BREAKDOWN

PART NUMBER	DESCRIPTION	QTY
MM91469	INTERCOOLER	1
MM10026-01	ADAPTER	2
MM10035-01	RETAINER	2
MM10038-01	LOWER DUCT	1
MM10038-02	UPPER DUCT	1
MM10038-03	BRACKET 1	1
MM10038-04	BRACKET 2	1

## PARTS BREAKDOWN

PART NUMBER	DESCRIPTION	QTY
HF5X0.8-10B	M5 BOLT (10MM LENGTH)	4
HF5X0.8-14B	M5 BOLT (14MM LENGTH)	4
HF6X1.0-10B	M6 BOLT (10MM LENGTH)	6
HF6X1.0-30D	M6 BOLT (30MM LENGTH)	3
MM1152-24	M6 WASHER	1
MM1165-07	1/8" NPT PLUG	1

\* PART IS REUSED FROM OEM INTERCOOLER AND IS NOT PROVIDED BY MISHIMOTO

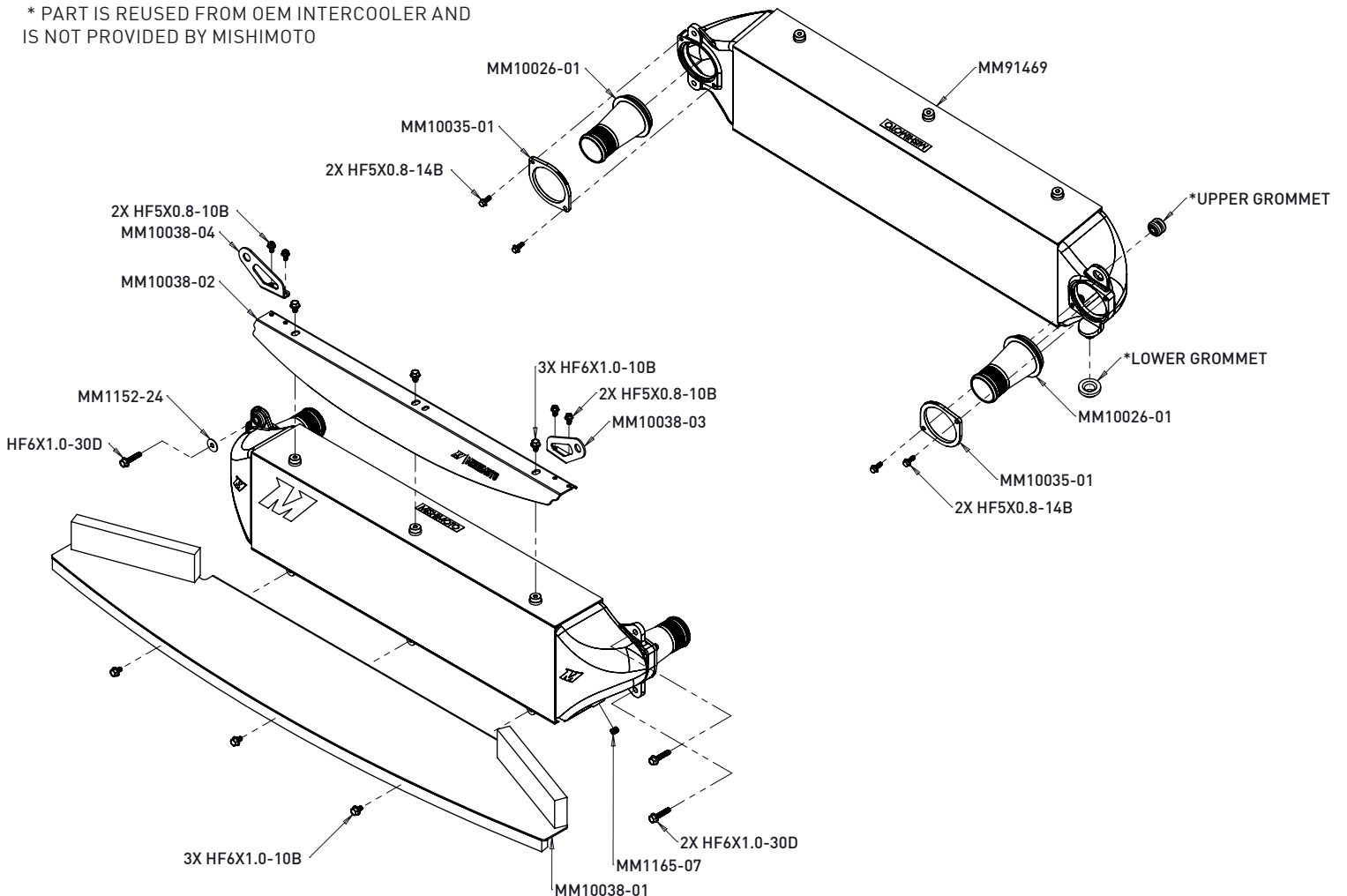

Continued on next page

## IMPORTANT SAFETY INFORMATION

- › Mishimoto recommends you use safety glasses and protective gloves during the installation of our products
- › Raise vehicle only on jack stands or on a vehicle lift
- › Allow vehicle to cool completely prior to attempting installation
- › Do not run the engine or drive the vehicle while overheating; serious damage can occur
- › Please dispose of any liquids properly
- › Mishimoto is not responsible for any vehicle damage or personal injury due to installation errors, misuse, or removal of Mishimoto products
- › If you need any assistance while installing our products, reach out to our Customer Service Team at 1-877-GOMISHI

## REQUIRED TOOLS

RATCHET  
EXTENSION  
10MM SOCKET  
12MM SOCKET  
14MM SOCKET  
FLATHEAD SCREWDRIVER  
POP CLIP TOOL (OPTIONAL)  
PANEL TOOLS (OPTIONAL)

**INSTALL TIME: 4 HOURS**

**INSTALL DIFFICULTY:** 

## INSTALLATION INSTRUCTIONS

1. Jack up the front of the vehicle and place it on jack stands.
2. Using a 10mm socket, remove the ten (10) bolts that secure the lower bumper tray. Then, remove the nine (9) pop clips that secure the splash shield using a flathead screwdriver or pop clip tool. Remove the tray and splash shield.

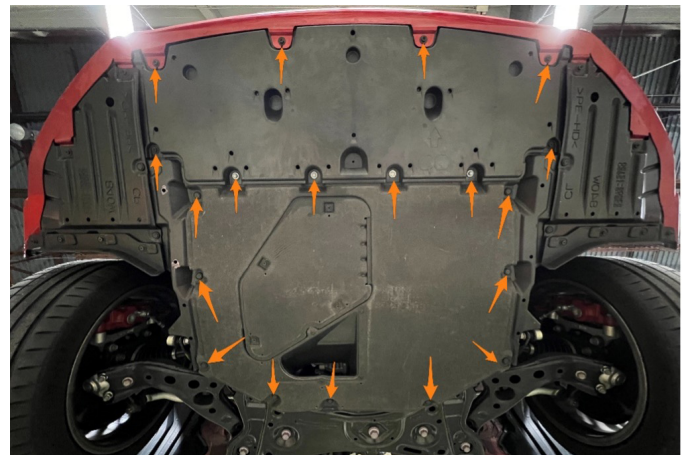

3. Remove the remaining six (6) bolts securing the bumper.



Continued on next page

4. Remove the two (2) pop clips. Using a flathead screwdriver, remove the bumper clip. Repeat on the other wheel well.



5. Remove the seven (7) pop clips securing the plastic tray at the front of the engine bay and remove the tray from the vehicle.



6. Using a 10mm socket, remove the three (3) bolts securing the top of the bumper to the vehicle. Then, remove the pop clip securing the snorkel duct.



7. Disconnect the electrical connector from the ADAS radar in the center of the bumper. Then, carefully pull each end of the bumper away from the vehicle to begin to disconnect it. Disconnect the electrical connectors from the fog light on each side of the bumper before entirely removing the bumper.



8. Remove the bumper.

9. Remove the foam from the crash bar by pulling it straight out.

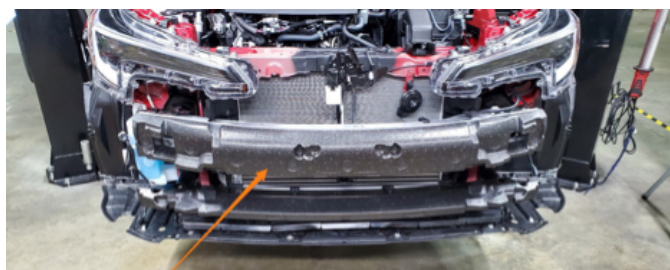

10. Using a 10mm socket, remove the nut that attaches the bracket to the bottom center of the crash bar. Then, unclip the plastic wire harness mount from the top of the crash bar. Then, using a 14mm socket, remove the eight (8) bolts that secure the crash bar and remove the bar from the vehicle. During reassembly torque the crash bar bolts to 49 ft-lb (67Nm).

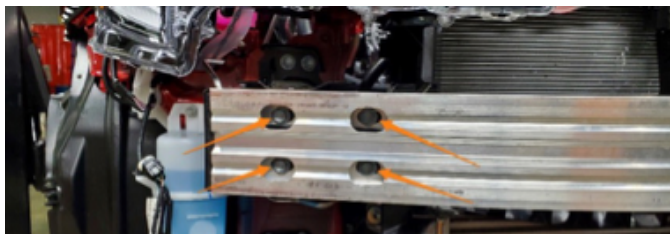
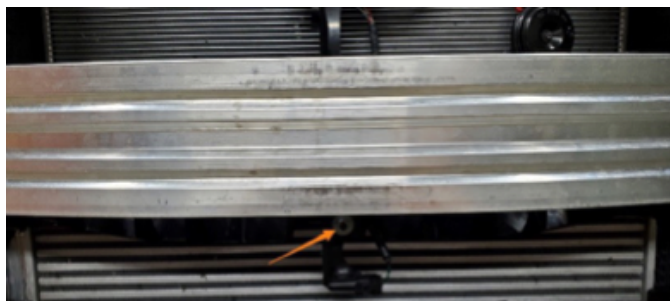

Continued on next page

**11.** Remove the two (2) pop clips securing the lower intercooler shroud, then remove the shroud.



**12.** Using a 12mm socket, remove the two (2) nuts securing the support bar and then remove the support bar. During reassembly, torque the nuts to 24 ft-lb (32 Nm).



**13.** Remove the two (2) pop clips from the air duct. Disengage the clips connecting the left and right shrouds to the air duct. Remove the ambient air temperature sensor tree clip from the duct, and then remove the duct.



**14.** Remove the left and right plastic shrouds by pulling straight out until the clips disengage and the shrouds are free.

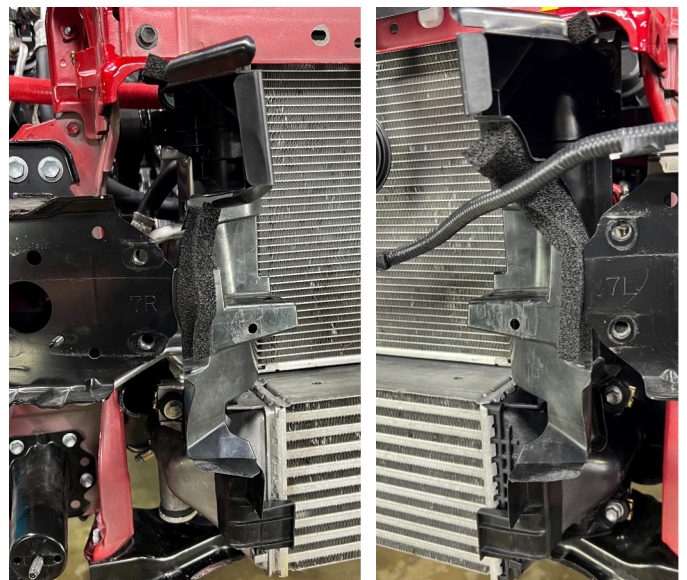

**15.** Loosen the hot side and cold side intercooler coupler clamps. Disconnect the couplers from the intercooler.

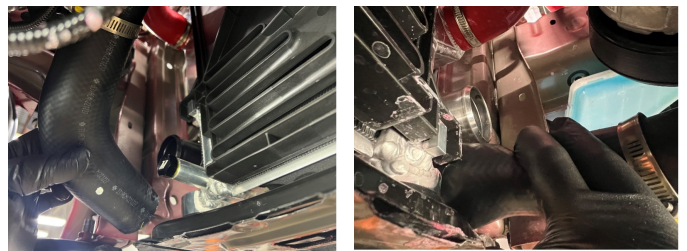

**16.** Using a 10mm socket, remove the three (3) bolts securing the intercooler.

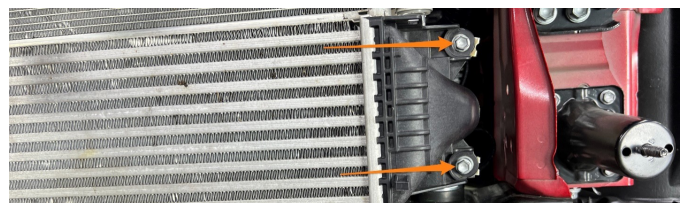

Continued on next page

17. Lift up on the left side of the intercooler, then pull the intercooler straight out. Once out, lower the intercooler to avoid the ambient air temperature sensor.

18. Remove the rubber grommets from the stock intercooler and install them onto the Mishimoto intercooler.



19. Using a silicone-based lubricant, lubricate the O-rings on the intercooler inlet and outlet adapters.



20. Carefully press the inlet and outlet adapters into the intercooler O-ring grooves. Place the locking rings over the flanges. Using a 8mm socket, secure the locking rings with the four (4) included bolts. Torque the bolts to the specified torque, do not over tighten.

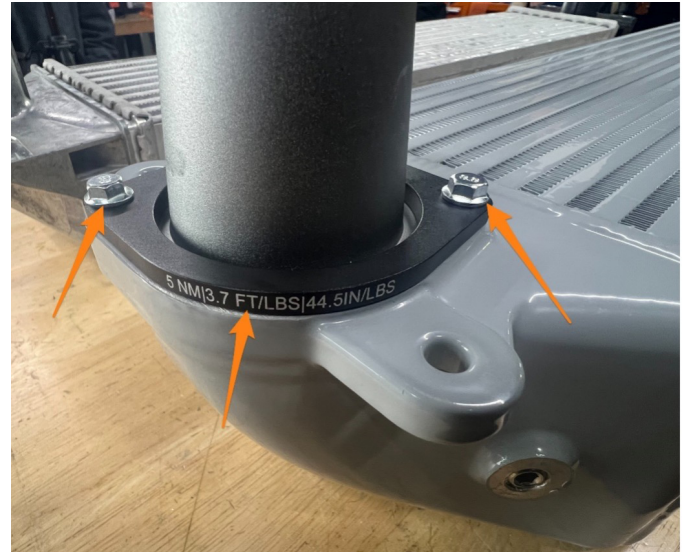

21. Place the Mishimoto intercooler into the vehicle. Be careful not to damage the ambient air temperature sensor. Ensure the intercooler post and grommet are sitting in the lower mount. Using a 10mm socket, install the three (3) included bolts and washer. The washer goes on the longer bolt installed on the intercoolers passenger side. Torque the bolts to 44.5 lb.in (5Nm).

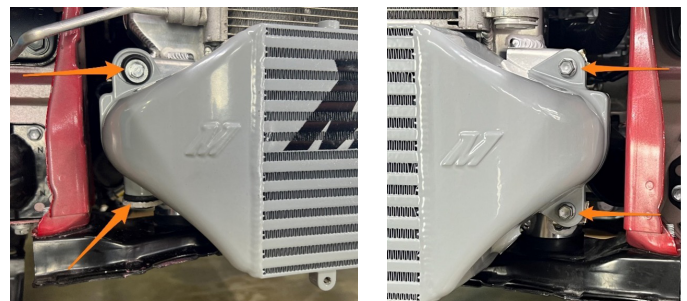

Continued on next page

22. Reinstall the left and right shrouds.

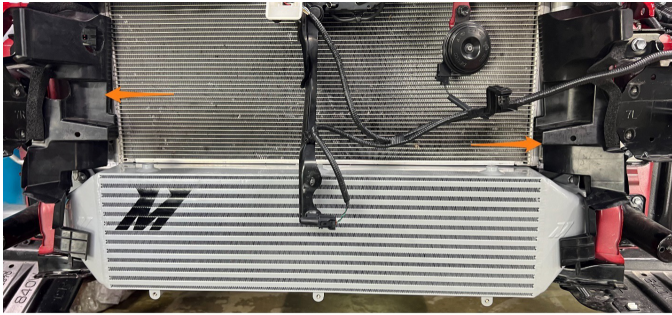

23. Install the Mishimoto upper intercooler shroud. Use a 10mm socket to install the three (3) included bolts. Reinstall the two (2) pop clips for the left and right ducts. Insert the ambient air temperature sensor tree clip into the provided hole.



24. Install the Mishimoto lower intercooler shroud. Using a 10mm socket, secure the shroud with the three (3) included bolts.



25. Reinstall the remaining components in the reverse of removal.

**Congratulations! You have completed the installation.**

## DISPOSAL INSTRUCTIONS

- › Do not dispose of any product as unsorted municipal waste. Use separate collection facilities. Contact your local authority for information regarding the collection systems available.
- › Never improperly dispose of any coolant, oil, or other chemicals.

## WARRANTY INFORMATION



- › All claims must be accompanied with a picture of the Mishimoto product showing the issue for which the claim is being submitted.
- › Mishimoto asks that the customer inspect their purchased item for any damage immediately upon arrival.
- › Any product deemed dead on arrival (DOA) must be claimed within 14 business days of delivery. Claims outside of this time frame will not be covered under the Mishimoto Lifetime Warranty.
- › This warranty does not include payment and/or reimbursement of the cost of labor in connection with the removal of any product returned pursuant to the warranty policy or in connection with the installation of any replacement items provided under the warranty policy.
- › Mishimoto has the right to refuse a claim at any time.

- › When Mishimoto accepts a claim, Mishimoto retains full discretion to choose if it will: (i) repair or replace purchaser's original Mishimoto product; (ii) replace purchaser's original Mishimoto product with the most current available model; or (iii) provide the purchaser with a gift card redeemable on [Mishimoto.com](https://www.mishimoto.com) in the amount of the original purchase price of the original Mishimoto product. The provision of a replacement of a Mishimoto product is subject to availability and Mishimoto retains the right to substitute any warranty claim item with a comparable item or credit at any time.
- › If Mishimoto determines that it will provide a replacement item in connection with a claim under this warranty policy, and such item is out of stock, Mishimoto will place the customer on backorder and ship the replacement product to the purchaser once it becomes available.
- › Mishimoto is not liable for incorrect shipments in connection with a claim if a claim form is completed incorrectly, or if a model number is not included in a claim.
- › If you have a vehicle equipped with an automatic transmission, please make sure to specify this within the text box on the claim form. Mishimoto is not responsible for incorrect replacement shipments if transmission type is not indicated.



**WARNING**  
Cancer and  
Reproductive Harm  
[www.P65Warnings.ca.gov](https://www.P65Warnings.ca.gov)

This product can expose you to chemicals which are known to the state of California to cause cancer. For more information visit: [www.p65warnings.ca.gov](https://www.p65warnings.ca.gov)