

MISHIMOTO

INSTALLATION INSTRUCTIONS

1. REMOVE THE ENGINE COVER.
2. REMOVE THE STOCK PCV HOSE.
3. INSTALL THE 2X FITTINGS ONTO THE CATCH CAN.
4. INSTALL BRACKET 2 ONTO THE CATCH CAN WITH THE 3X M4 BUTTON HEAD FLANGED BOLTS.
5. INSERT THE 2X M6 HEX HEAD FLANGED BOLTS FROM THE INSIDE OF THE PASSENGER SIDE WHEEL ARCH INTO THE 2X EXISTING HOLES BEHIND THE STRUT.
6. INSTALL BRACKET 1 IN THE ENGINE BAY ONTO THE 2X BOLTS THAT WERE JUST INSTALLED AND SECURE IT WITH THE 2X M6 LOCKING NUTS.
7. INSTALL BRACKET 2 WITH THE CATCH CAN ATTACHED ONTO BRACKET 1 WITH THE 2X M6 BUTTON HEAD FLANGED BOLTS.
8. CONNECT THE PRE-INSTALLED FITTING ON HOSE 1 TO THE PCV VALVE AND CONNECT THE OTHER END TO THE FITTING ON THE CATCH CAN LABELED "IN" SECURING IT WITH 1X WORM GEAR CLAMP
9. CONNECT THE PRE-INSTALLED FITTING ON HOSE 2 TO THE INTAKE MANIFOLD PORT AND CONNECT THE OTHER END TO THE FITTING ON THE CATCH CAN LABELED "OUT" SECURING IT WITH THE REMAINING WORM GEAR CLAMP
10. REINSTALL THE ENGINE COVER

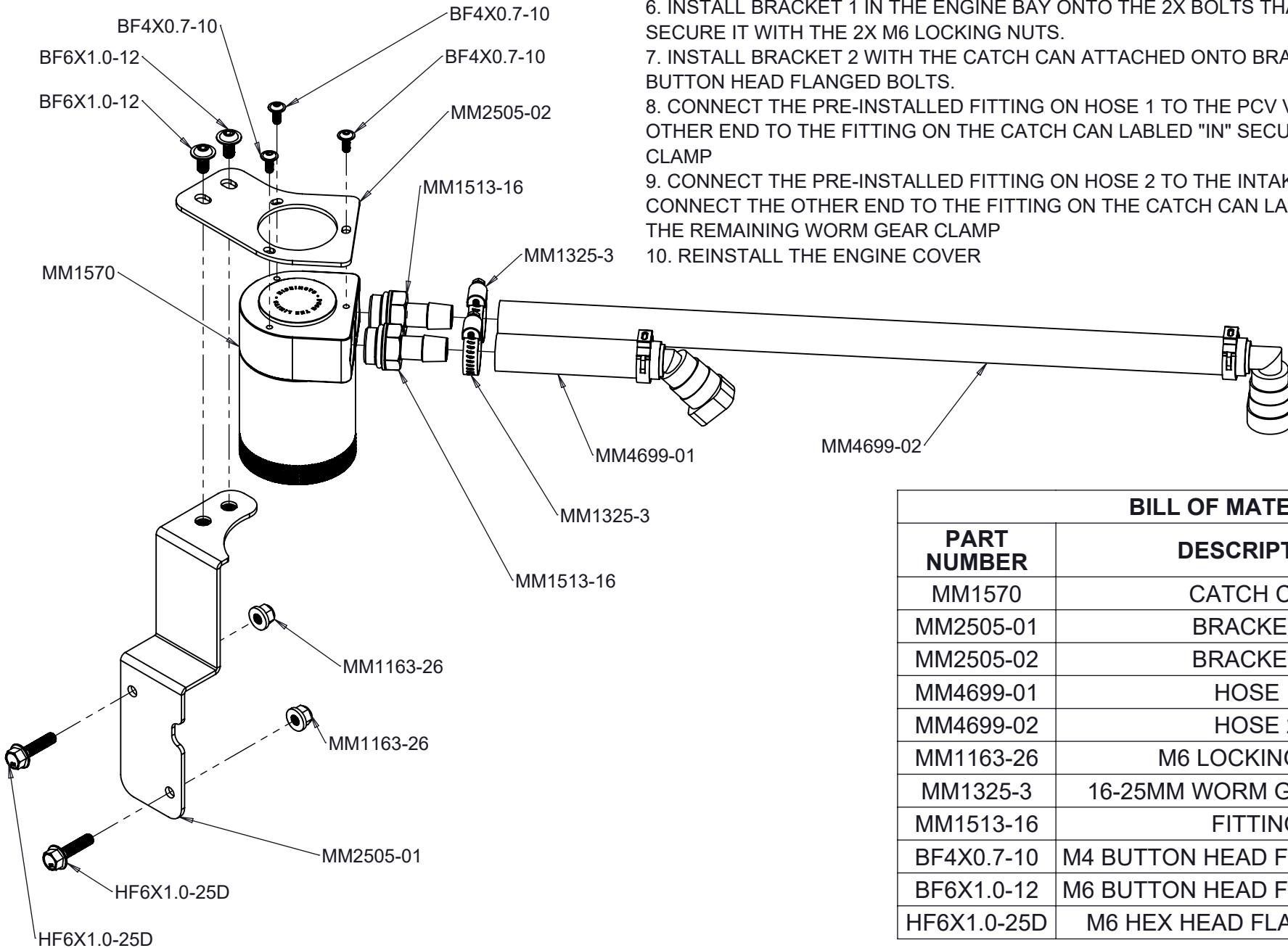

BILL OF MATERIALS

PART NUMBER	DESCRIPTION	QUANTITY
MM1570	CATCH CAN	1
MM2505-01	BRACKET 1	1
MM2505-02	BRACKET 2	1
MM4699-01	HOSE 1	1
MM4699-02	HOSE 2	1
MM1163-26	M6 LOCKING NUT	2
MM1325-3	16-25MM WORM GEAR CLAMP	2
MM1513-16	FITTING	2
BF4X0.7-10	M4 BUTTON HEAD FLANGED BOLT	3
BF6X1.0-12	M6 BUTTON HEAD FLANGED BOLT	2
HF6X1.0-25D	M6 HEX HEAD FLANGED BOLT	2