

MISHIMOTO

INSTALLATION GUIDE

Performance Intake, Fits 2023+ Honda Civic Type R
SKU: MMAI-CTR-23

TABLE OF CONTENTS

1. RESOURCES & CONTACT INFO
2. EXPLODED VIEW
3. IMPORTANT SAFETY INFORMATION
INSTALL TIME & REQUIRED TOOLS
INSTALLATION INSTRUCTIONS
8. DISPOSAL & WARRANTY INFORMATION

RESOURCES & CONTACT



CALL 1.877.466.4744

CUSTOMER SERVICE HOURS: MON-FRI 9:00AM-9:00PM ET



@MISHIMOTO



@GOMISHIMOTO



MISHIMOTO



@MISHIMOTO



ENGINEERING BLOG

WWW.MISHIMOTO.COM/ENGINEERING

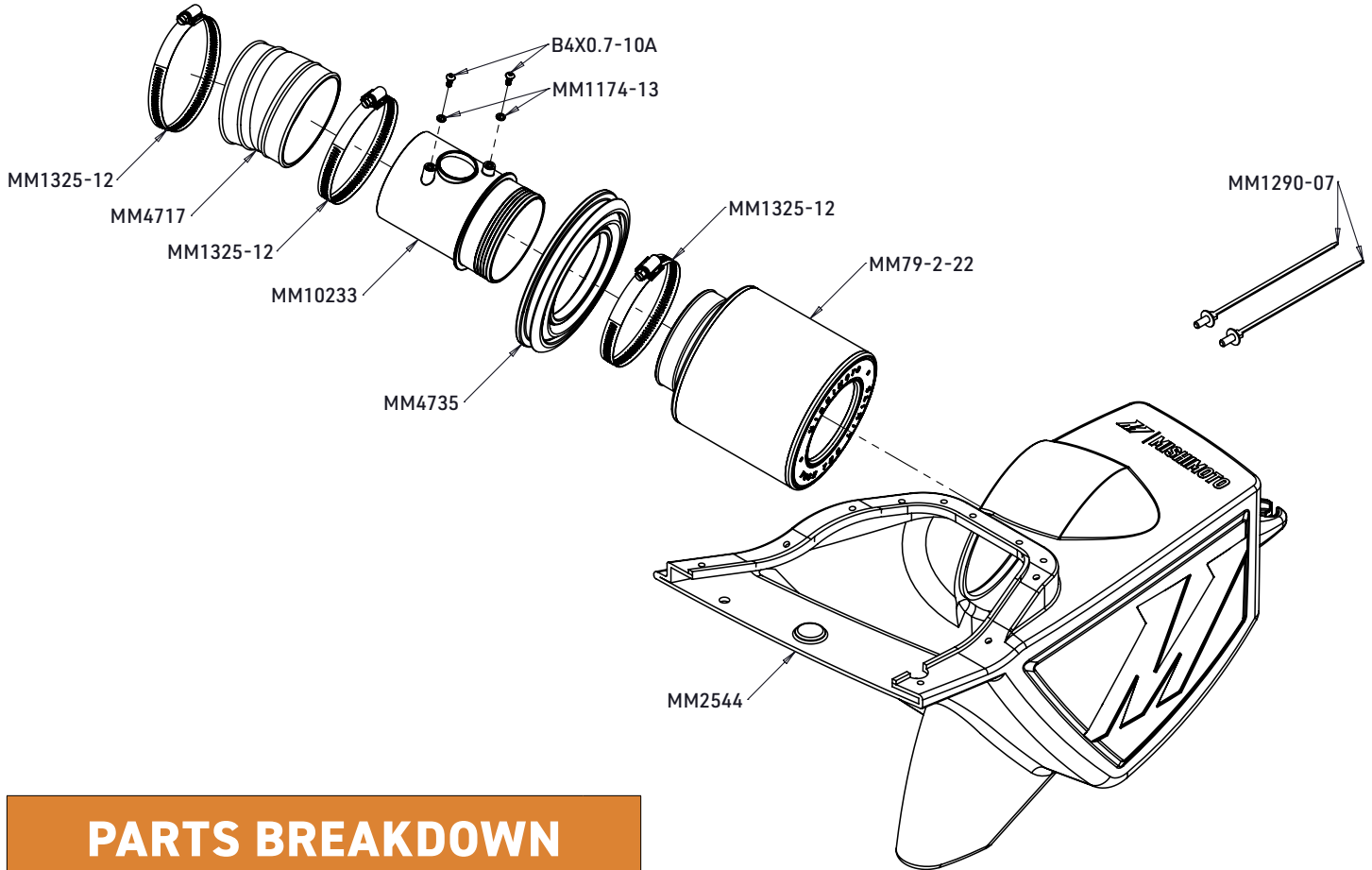

PARTS BREAKDOWN		
PART NUMBER	DESCRIPTION	QTY
MM2544	AIRBOX	1
MM4735	GROMMET	1
MM79-2-22	AIR FILTER BOTTOM CAP	1
MM10233	MAF HOUSING	1
MM4717	COUPLER	1
MM1174-13	LOCK WASHER	2
B4X0.7-10A	M4 BUTTON HEAD BOLT	2
MM1325-12	80-100MM WORM GEAR CLAMP	3
MM1290-07	TREE CLIP ZIP TIE	2

IMPORTANT SAFETY INFORMATION

- › Mishimoto recommends you use safety glasses and protective gloves during the installation of our products
- › Raise vehicle only on jack stands or on a vehicle lift
- › Allow vehicle to cool completely prior to attempting installation
- › Do not run the engine or drive the vehicle while overheating; serious damage can occur
- › Please dispose of any liquids properly
- › Mishimoto is not responsible for any vehicle damage or personal injury due to installation errors, misuse, or removal of Mishimoto products
- › If you need any assistance while installing our products, reach out to our Customer Service Team at 1.877.466.4744

REQUIRED TOOLS

- | | |
|----------------------------|--------------------------|
| 1/4" RATCHET AND EXTENSION | 2.5MM ALLEN WRENCH |
| 5.5MM SOCKET | PHILIPS HEAD SCREWDRIVER |
| 7MM SOCKET | PICK TOOL |
| 10MM SOCKET | |

INSTALL TIME: 1 HOURS

INSTALL DIFFICULTY:

INSTALLATION INSTRUCTIONS

1. Disconnect the mass air flow (MAF) sensor and unclip the wire harness from the stock air box.

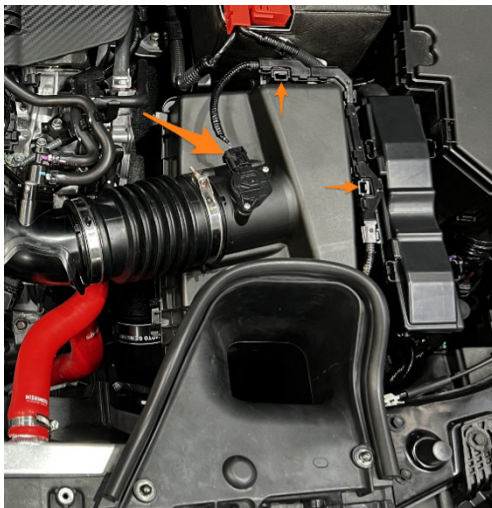

2. Loosen the clamp securing the intake hose to the intake EVAP joint.



3. Remove the four 10mm bolts securing the stock air box in place. Once removed, remove the air box from the vehicle. (4x 10mm bolts)

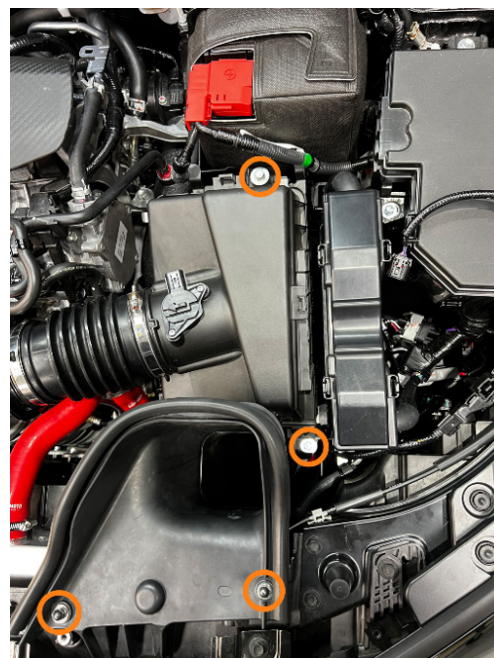

Continued on next page

4. Remove the two Phillips head screws securing the MAF sensor to the stock air box, then remove the MAF sensor. (2x Phillips head screws)

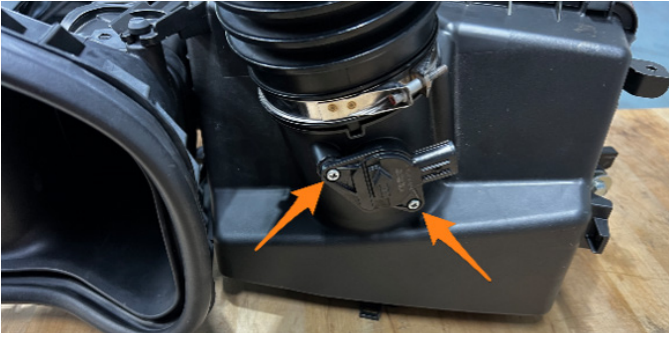

5. Install the MAF sensor into the Mishimoto MAF housing and secure it in place using the provided hardware. (2x M4 button head bolts, 2x M4 lock washers)



6. Install the grommet to the MAF housing, followed by the air filter. Secure the air filter in place with the provided worm gear clamp. (1x worm gear clamp)

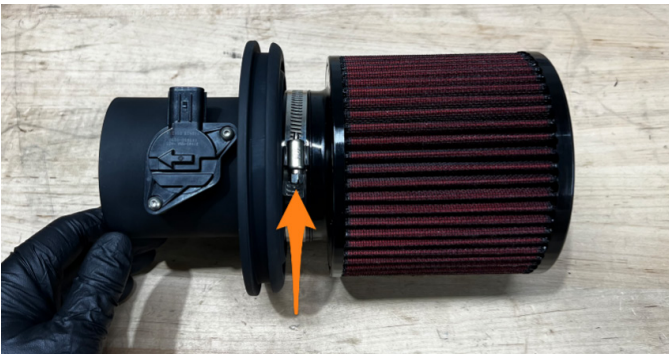

7. Transfer the rubber gasket from the top of the stock air box to the Mishimoto air box. (See image on the right)

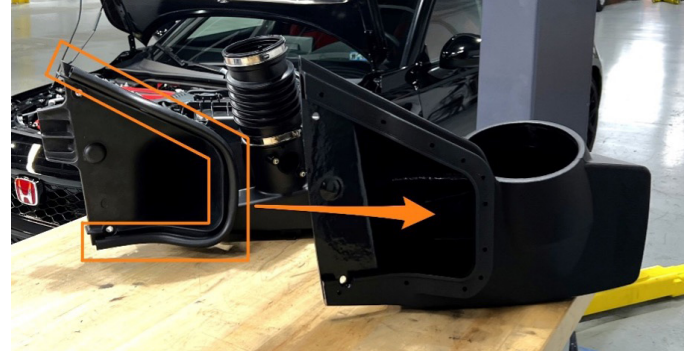

8. Transfer the lower mounting grommet from the bottom of the stock air box to the Mishimoto air box.



9. Transfer the rear mounting grommet from the stock air box to the Mishimoto air box.



Continued on next page

10. Insert the two provided tree clip zip ties into the small holes located on the Mishimoto air box. Feed the end of the zip tie into the ratcheting mechanism just enough to engage, leaving a large open loop. (2x tree clip zip ties)



11. Insert the air filter/MAF housing assembly into the Mishimoto air box, then work your way around the grommet, pushing it down to secure it in place.



12. Place two of the provided worm gear clamps onto the Mishimoto coupler, then install the side with the larger inside diameter to the MAF housing. Do not tighten the clamps. (2x worm gear clamps)



13. Open the MAF wire harness cover by depressing all the tabs. Once opened, remove the MAF wiring harness from the cover. Next, disconnect the MAF wire harness from the bracket on the front of the ECU.

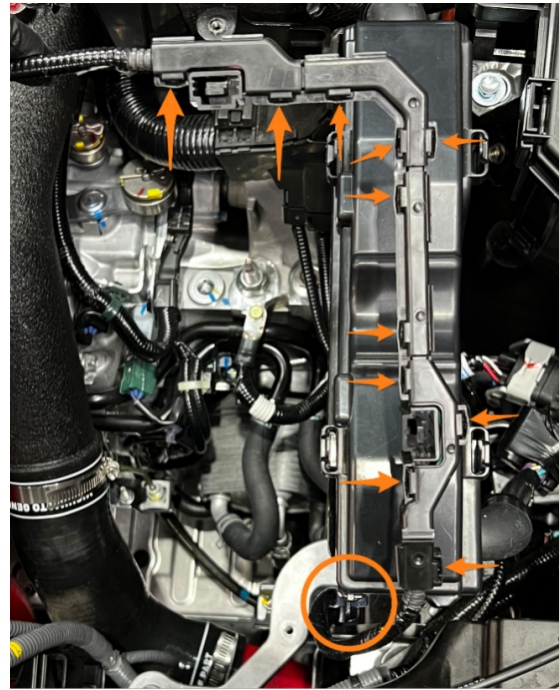

Continued on next page

14. Install the provided split-loom wire cover to the MAF wire harness.

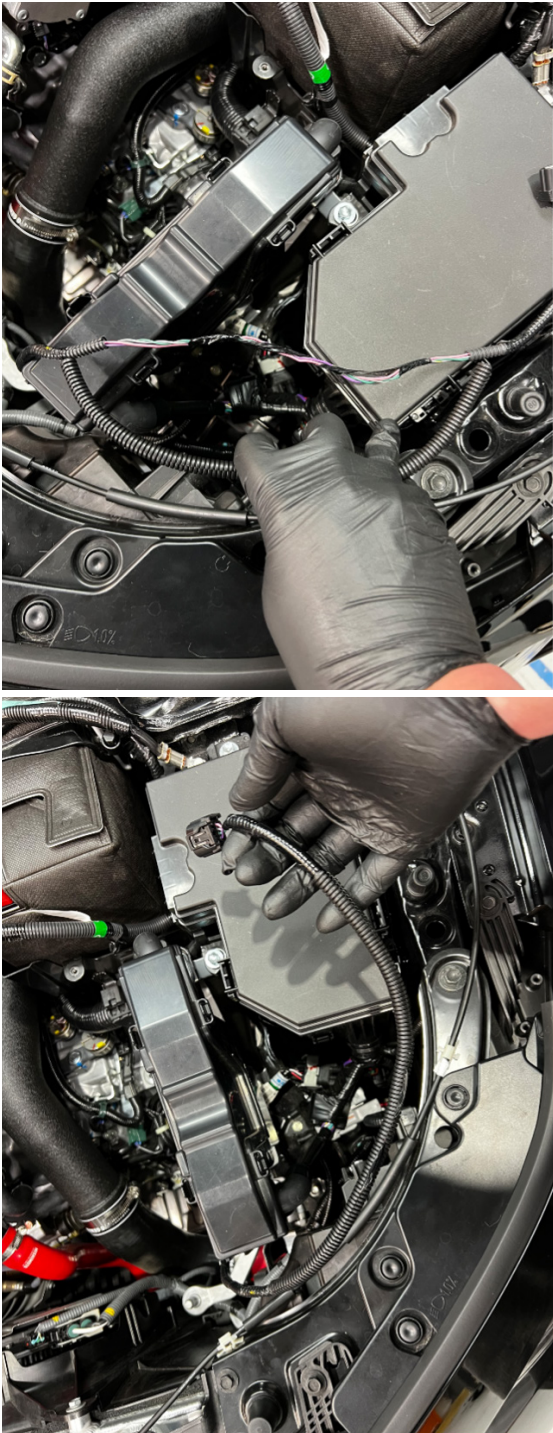

15. Install the Mishimoto air box assembly into the vehicle, then reinstall the previously removed 10mm bolt to secure the rear section of the air box in place. (1x 10mm bolt)

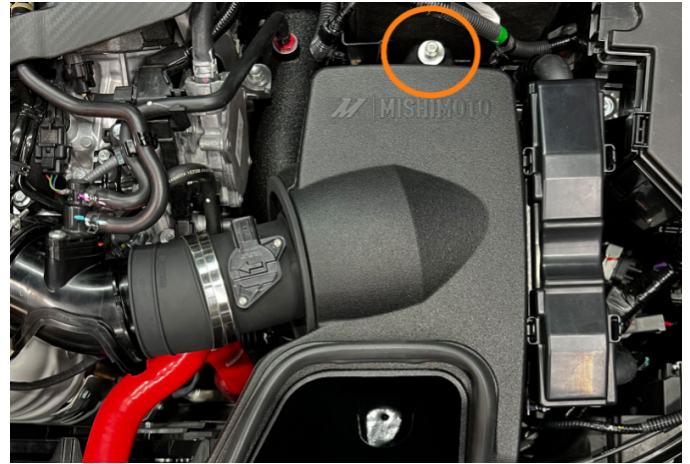

16. Secure the front section of the Mishimoto air box in place using the previously removed bolts. (2x 10mm bolts)

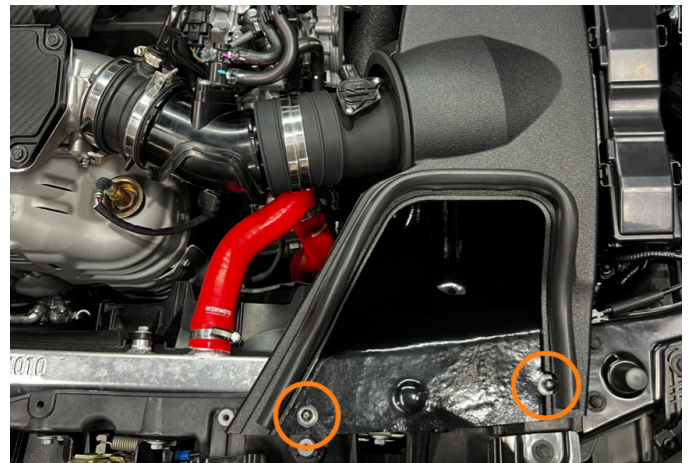

17. Secure the Mishimoto coupler to the MAF housing and intake EVAP joint using the provided worm gear clamps. (2x worm gear clamps)
(See images on the following page)

Continued on next page

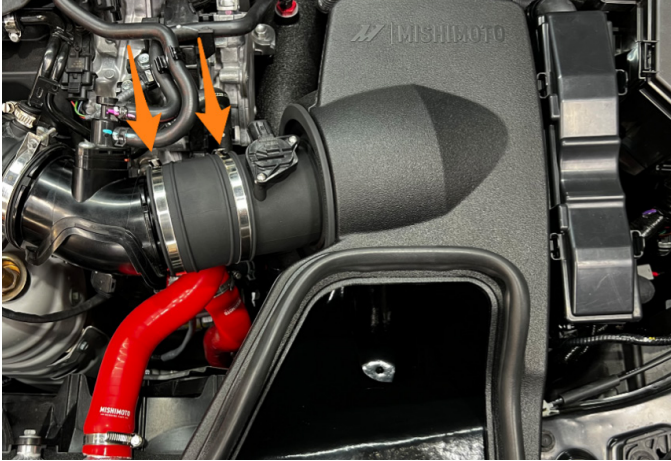

18. Route the MAF wire harness under the Mishimoto air box and through both of the previously installed zip ties, then route it up to the back side of the MAF housing. Reconnect the wire harness to the MAF sensor, then secure it in place with the zip ties.



This concludes the install.

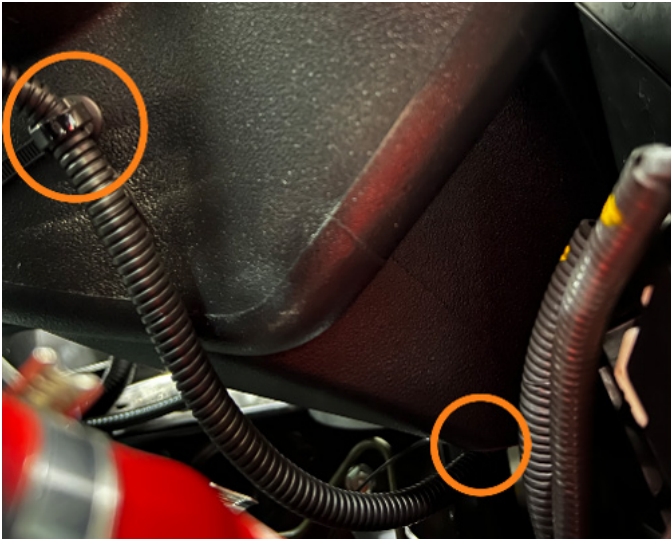

Continued on next page

DISPOSAL INSTRUCTIONS

- › Do not dispose of any product as unsorted municipal waste. Use separate collection facilities. Contact your local authority for information regarding the collection systems available.
- › Never improperly dispose of any coolant, oil, or other chemicals

WARRANTY INFORMATION



This product is backed by Mishimoto's Lifetime Limited Warranty. Please visit mishimoto.com/lifetime-warranty to see the full warranty.

ACTIVATE YOUR WARRANTY

Scan the QR code to activate your warranty. Every Mishimoto product is covered by our Mishimoto Lifetime Warranty, which also includes accident protection. Registration is easy. Visit: mishimoto.com/register and save the receipt for your records.



WARNING
Cancer and
Reproductive Harm
www.P65Warnings.ca.gov

- › This product can expose you to chemicals which are known to the state of California to cause cancer. For more information visit: www.p65warnings.ca.gov