

MISHIMOTO

INSTALLATION STEPS:

1. USING A TRIM REMOVAL TOOL, REMOVE THE TOW HOOK COVER FROM THE FRONT BUMPER AND DETACH IT FROM THE VEHICLE.

2. INSTALL MM10057-01 INTO THE OPENING IN THE ORIENTATION SHOWN HERE.

3. ATTACH MM10057-02, WITH THE NOTCH ON THE BOTTOM, TO MM10057-01 WITH B8X1.25-30. TIGHTEN THE BOLT TO 88.5IN/LBS (10NM).

4. ATTACH MM10064 IN THE ORIENTATION SHOWN TO MM10057-02 WITH (2) BF8X1.2-16B. MM10064 MUST BE MOUNTED WITH THE BOLTS IN THE SLOTS SHOWN TO AVOID INTERFERENCE WITH PARKING SENSORS.

5. ATTACH YOUR LICENSE PLATE AND THE PLATE FRAME TO MM10064 WITH (4) BF6X1.0-12B.

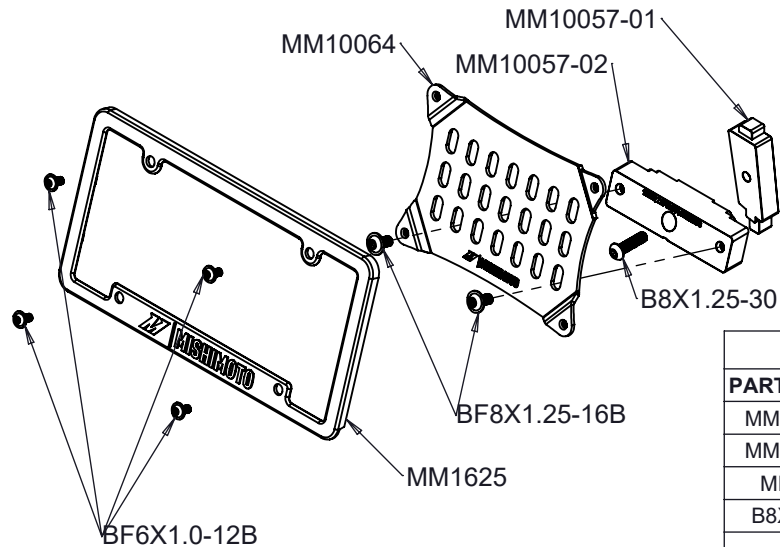

FOR QUESTIONS OR ASSISTANCE WITH YOUR MISHIMOTO PRODUCT,
CONTACT US AT 1.877.GOMISHI OR SUPPORT@MISHIMOTO.COM

BILL OF MATERIALS		
PART NUMBER	DESCRIPTION	QUANTITY
MM10057-01	INNER PART ASSEMBLY	1
MM10057-02	OUTER PART ASSEMBLY	1
MM10064	LP BRACKET	1
B8X1.25-30	M8 BUTTON HEAD BOLT	1
BF8X1.25-16B	M8 BUTTON HEAD FLANGED BOLT	2
BF6X1.0-12B	M6 BUTTON HEAD FLANGED BOLT	4
MM1625	PLATE FRAME	1