



INSTALLATION INSTRUCTIONS



2021 FORD BRONCO AXLE BACK | PART NO. 19558

BILL OF MATERIALS:

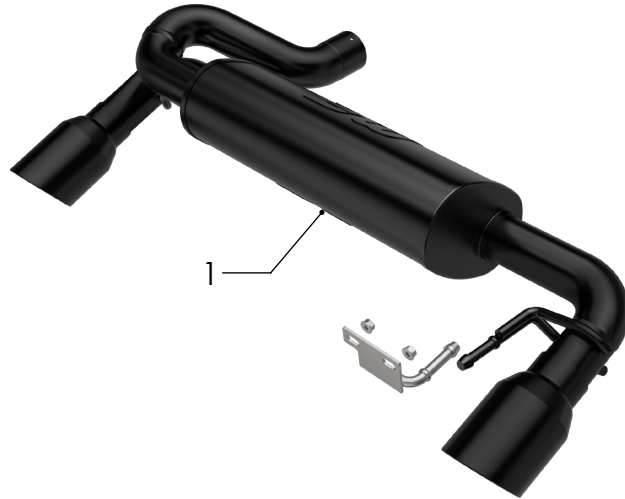

1. MUFFLER ASSEMBLY.



WEAR SAFETY GLASSES



READ INSTRUCTIONS THOROUGHLY BEFORE INSTALLING PRODUCT



SPRAY LUBRICANT

To ease removal of existing exhaust components (especially on older vehicles) spray penetrating lubricant on all fasteners and hangers/insulators that will be loosened or removed and let soak before disassembly.

HARDWARE KIT:

- 1.[1] Hanger Bracket Assy
- 2.[2] M8 Nuts

SHOP SUPPLIES:

MINIMUM REQUIRED TOOLS:



10,15 mm



Hanger Tool (Or Pry Bar)

MAGNAFLOW RECOMMENDS PROFESSIONAL INSTALLATION ON ALL THEIR PRODUCTS



WARNING: When working on, under, or around any vehicle exercise caution. Please allow the vehicle's exhaust system to cool before removal, as exhaust system temperatures may cause severe burns. If working without a lift always consult vehicle manual for correct lifting specifications. Always wear safety glasses and ensure a safe work area. Serious injury or death could occur if safety measures are not followed.

ATTENTION: Always install any supplied band or U-bolt clamps to the proper torque specifications of 40-45 ft-lb for band clamps and 30-35 ft-lb for U-bolt clamps. Over tightening will result in the clamps breaking and will NOT be warranted by MagnaFlow.

MAGNAFLOW: 1901 Corporate Centre Dr - Oceanside, CA 92056 | 1(800)990-0905
Technical Support: 1(800) 959-9226 | Email: moreinfo@magnaflow.com

INSTALLATION INSTRUCTIONS

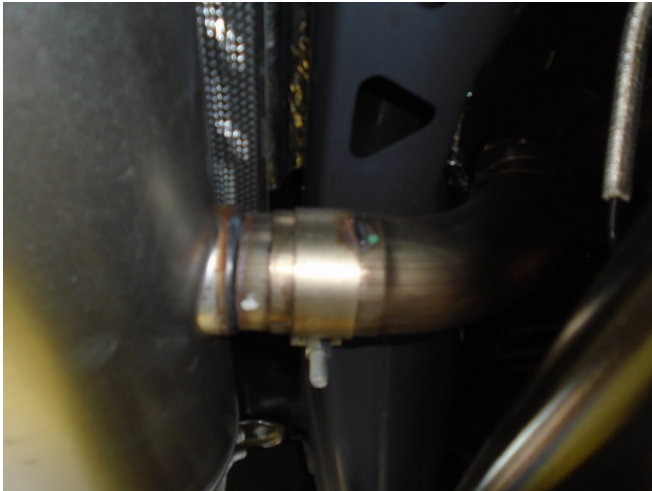

Step 1. Remove the OEM muffler assembly by first loosening the clamp attaching the muffler inlet to the midpipe. Disengage the two welded hangers from the rubber insulators. The muffler assembly may now be removed.

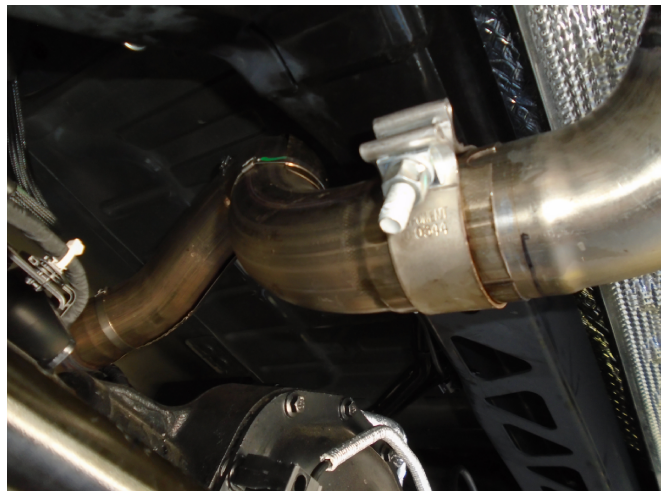

Step 3. Next install the OE clamp onto the Muffler Assembly insert the inlet to the OEM mid pipe outlet. Keep the clamp loose until final installation is complete.



Step 2. Begin installing your new Axle Back system by mounting the supplied Hanger Bracket OVER the OEM hanger and fasten using the supplied M8 nuts.

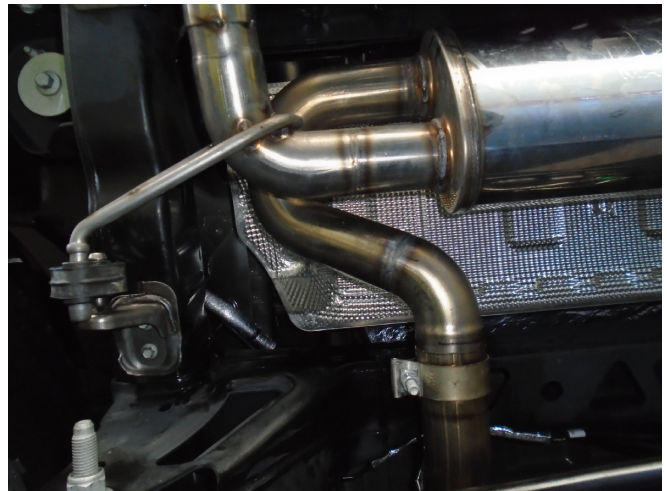

Step 4. Finish by engaging both welded hangers to the rubber insulators.

INSTALLATION INSTRUCTIONS



Step 5. Once a final position has been chosen for the new exhaust system, evenly tighten the OEM clamp using the manufacturers torque specifications . Inspect all fasteners after 25-50 miles of operation and re-tighten if necessary.