

S7001

2014-2019 CHEVROLET CORVETTE, 6.2L,
X PIPE KIT

MBRP®

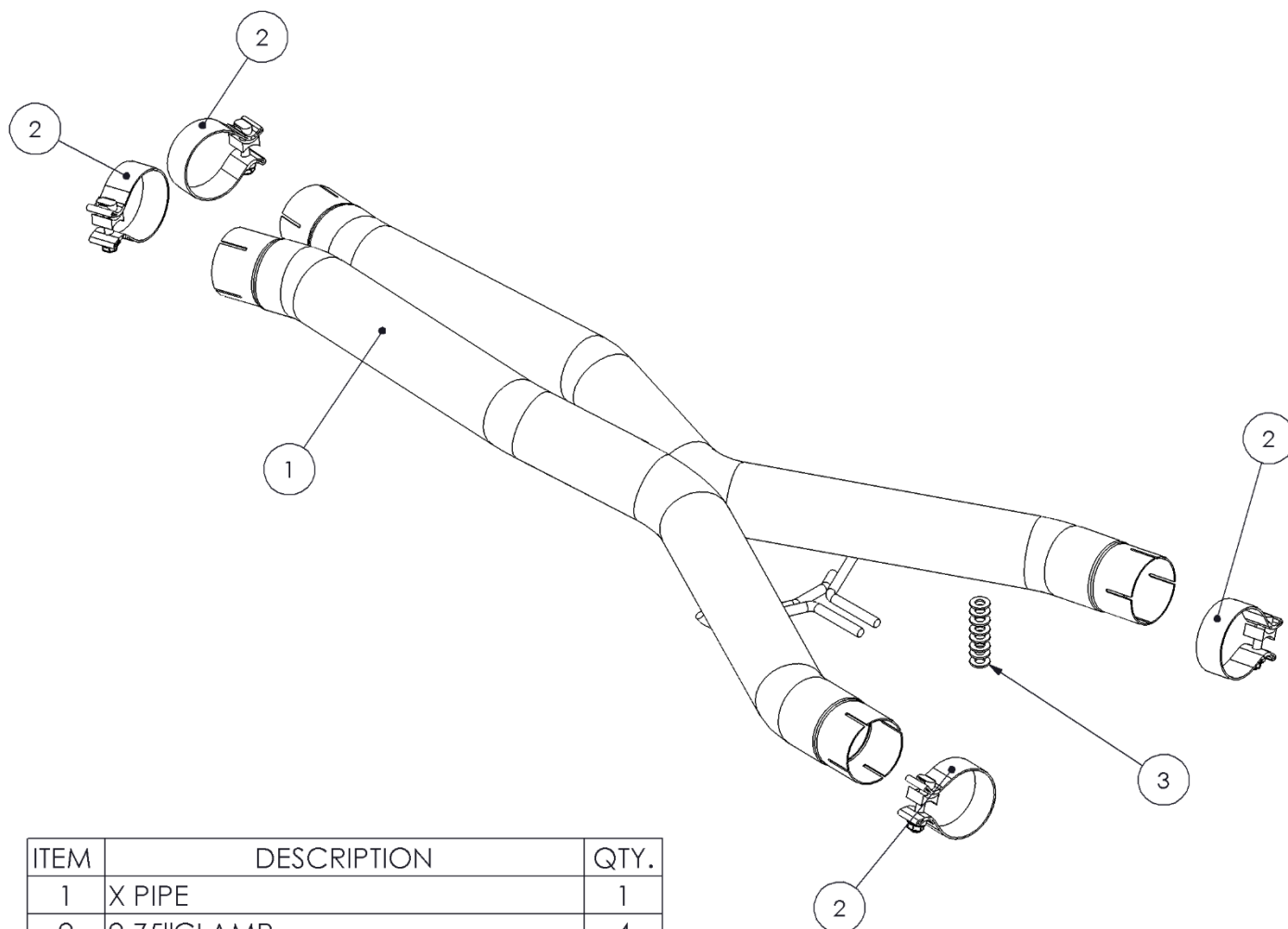

ITEM	DESCRIPTION	QTY.
1	X PIPE	1
2	2.75"CLAMP	4
3	M10 FLAT WASHER	8

Refer to this LOT NUMBER when contacting customer service: _____

PLEASE READ BEFORE STARTING INSTALLATION

While MBRP has made every effort to ensure that all components of this system are of superior quality and properly packaged, it is the installer's responsibility to ensure the following before removal of the factory exhaust:

- that ALL components shown above are present.
- that ALL mating components fit together.
- that there are no damaged components.
- that the system you have purchased is appropriate for your vehicle year, model and configuration.
- that the system will not interfere with any modifications previously installed or planned.
- that you have read and understand these instructions.

If you have any questions or are uncertain about any aspect of the installation of this system to your vehicle please contact your dealer before commencing installation.

THIS KIT REQUIRES CUTTING THE OE X-PIPE FOR INSTALLATION

Removal of Stock System

1. Apply a penetrating lubricant liberally to all exhaust fasteners, hangers and rubber insulators.
2. Remove the undercar tunnel brace.
3. Loosen both outlet clamps on the OE X pipe assembly.
Refer to Figure 1.
4. Remove the 4 flange nuts on the inlets of the OE X pipe assembly.
Refer to Figure 2.
5. Unbolt the hanger bracket from the transmission housing and remove the OE X pipe assembly. Remove the hanger bracket from the pipe assembly as it will be reused.
Refer to Figure 1.

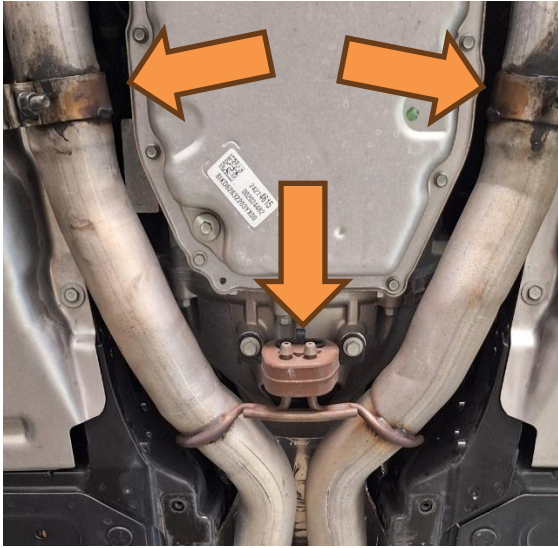

Figure 1



Figure 2



Figure 3



Figure 4

Installation of MBRP Inc. Performance Exhaust

1. Lay the **X-Pipe** on top of the OE x pipe assembly. Mark each catalytic converter as driver and passenger side.
- Mark the OE pipes at the FULL DEPTH OF THE REDUCED LENGTH ON THE **X-PIPE**.
- Cut the OE X pipe at the marks and retain the catalytic converter assemblies.
Refer to Figures 3 and 4.

MBRP®

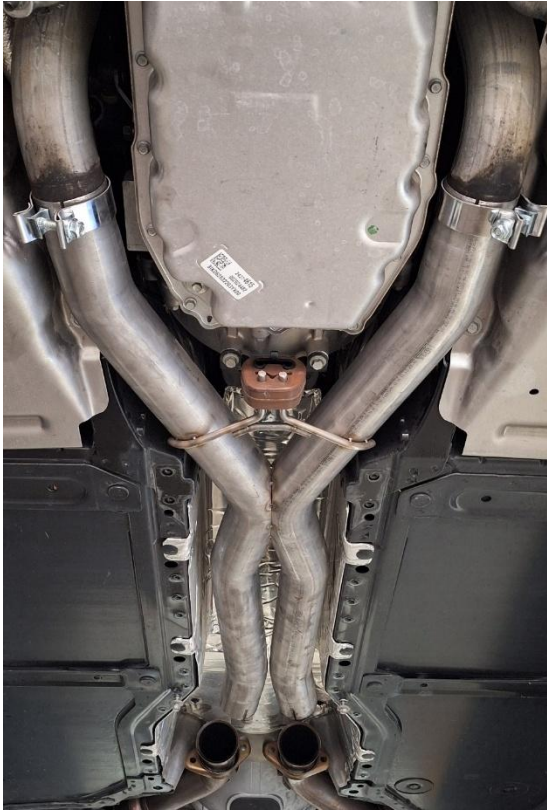

Figure 5



Figure 6

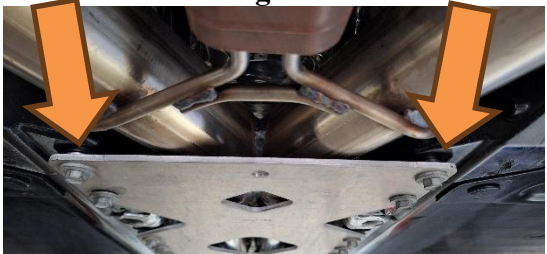

Figure 7

2. Install **2.75" Clamps** onto the outlets of the **X-Pipe**, then install the assembly onto the over axle pipes. Note orientation of clamps so the hardware fits into the cutouts in the heat shields.

Refer to Figure 5.

3. Install the hanger bracket onto the **X-Pipe**.

Refer to Figure 5.

4. Install both catalytic converters loosely onto the **X-Pipe** inlets using the supplied **2.75" Clamps**. Be sure the converters are in their proper locations, and the clamps are positioned with the hardware on the outboard sides. Loosely connect both converters to the front pipes.

Refer to Figure 6.

5. Connect the hanger bracket to the transmission and adjust the **X-Pipe** to position it centered in the tunnel. Tighten all hardware.

6. Install the tunnel brace. It may be required to shim the 4 rear mounting points to clear the larger 3" diameter tubing. Use the supplied **M10 Flat Washers** if required.

Refer to Figure 7.

7. Check along the full length of the exhaust system to ensure there is adequate clearance for fuel lines, vent lines, brake lines, frame, bodywork, suspension, and any wiring, etc. If there is any interference detected, relocate, or adjust to provide adequate clearance. Ensure all clamp connections are secure and components are unable to rotate or slide. Band clamps require approximately 45 lb-ft (60 N-m) of torque. Verify clearances, system security and band clamp torque after 30-60 miles (50-100 km) of driving.

Congratulations! You are ready to begin experiencing the improved performance and driving pleasure of your **MBRP performance exhaust system. We know you will enjoy your purchase**