

# S6058

2016-2022 CHEV/GMC  
COLORADO/CANYON, 2.8L DURMAX,  
FILTER BACK, 3.0" SINGLE

# MBRP®

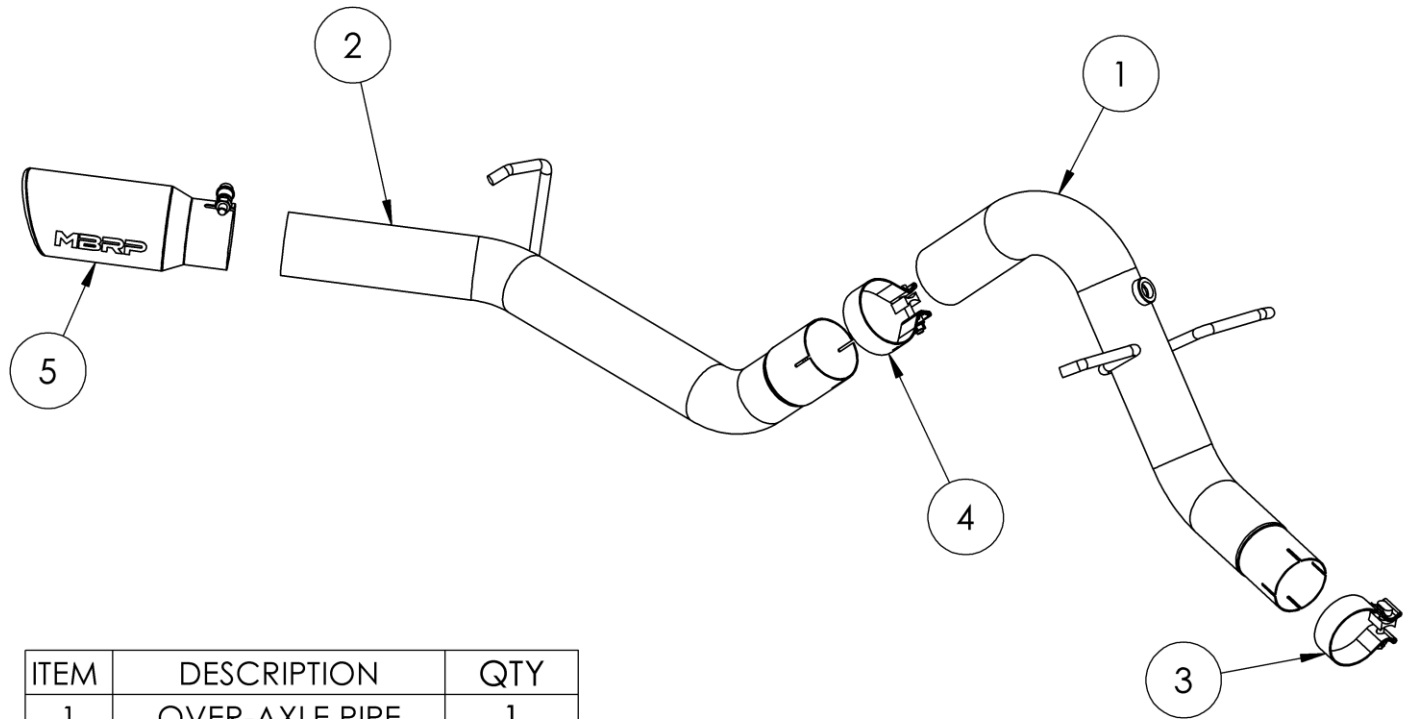

ITEM	DESCRIPTION	QTY
1	OVER-AXLE PIPE	1
2	TAIL PIPE	1
3	3.0" CLAMP	1
4	2.75" CLAMP	1
5	EXHAUST TIP	1

Refer to this LOT NUMBER when contacting customer service: \_\_\_\_\_

## PLEASE READ BEFORE STARTING INSTALLATION

While MBRP has made every effort to ensure that all components of this system are of superior quality and properly packaged, it is the installer's responsibility to ensure the following before removal of the factory exhaust:

- that ALL components shown above are present.
- that ALL mating components fit together.
- that there are no damaged components.
- that the system you have purchased is appropriate for your vehicle year, model and configuration.
- that the system will not interfere with any modifications previously installed or planned.
- that you have read and understand these instructions.

If you have any questions or are uncertain about any aspect of the installation of this system to your vehicle please contact your dealer before commencing installation.

# MBRP®

## Removal of Stock System:



Figure 1

1. Apply penetrating lubricant liberally to all exhaust fasteners, hangers and rubber insulators.
2. Remove sensor located in the tail pipe.  
**Refer to Figure 1.**

3. Mark a cut line 7 1/8" for 128.3" wheelbases (Crew Cab Short Box and Extended Cab Long Box) and 19 1/8" for 140.5" wheelbase (Crew Cab Long Box) behind the rear weld of the DPF (arrow).  
**Refer to Figure 2.**



Figure 2

4. Cut the tail pipe at the cut line. **Installation Note:** Hold up the **Over-Axle Pipe** in line with the rubber insulators to verify cut length. The cut pipe should extend approximately 3" into the **Over-Axle Pipe**.
5. Remove the factory tail pipe.

## Installation of MBRP System:

1. Using a **2.75" Band Clamp** install the **Over-Axle Pipe** onto the stock pipe previously cut, install the hangers into the rubber insulators.  
**Refer to Figure 3.**

2. Using a **3" Band Clamp** install the **Tail Pipe** hanger into the rear rubber isolator and install the **Tail Pipe** onto the **Over-Axle Pipe**, securing it with the **3" Band Clamp**.  
**Refer to Figure 4.**



Figure 3

3. Install and adjust the **Exhaust Tip**.
4. Carefully align the system and tip. Align the edge of each band clamp with the edge of the joint it is connecting. Tighten all hardware and clamps, starting at the front and working rearward to secure the system. Check along the full length of the exhaust system to ensure there is adequate clearance for fuel lines, vent lines, brake lines, frame, bodywork, suspension and any wiring, etc. If there is any interference detected, relocate or adjust to provide adequate clearance. Ensure all clamp connections are secure and components are unable to rotate or slide. Band clamps require approximately 45 lb-ft (60 N-m) of torque. Verify clearances, system security and band clamp torque after 30-60 miles (50-100 km) of driving.

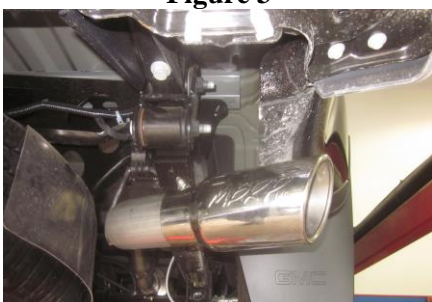

Figure 4

**Congratulations!** You are ready to begin experiencing the improved power, sound and driving experience of your **MBRP** Performance Exhaust.

We know you will enjoy your purchase!