

# S5223

2019-2023 Ranger,  
2.3L ECOBOOST, DUAL SPLIT REAR

# MBRP®

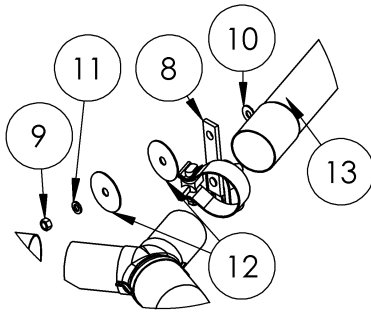

DETAIL A

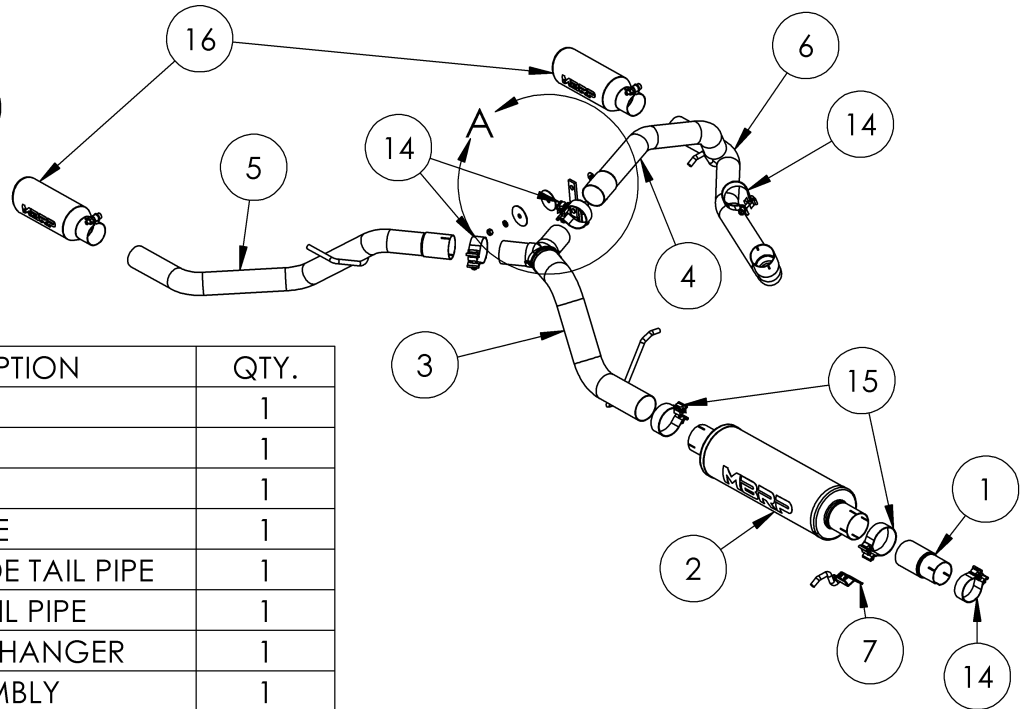

ITEM	DESCRIPTION	QTY.
1	ADAPTOR PIPE	1
2	MUFFLER	1
3	Y-PIPE	1
4	OVER-AXLE PIPE	1
5	PASSENGER-SIDE TAIL PIPE	1
6	DRIVER-SIDE TAIL PIPE	1
7	HANG TIGHT™ HANGER	1
8	HANGER ASSEMBLY	1
9	3/8" HEX NUT	1
10	3/8" FLAT WASHER	1
11	3/8" LOCK WASHER	1
12	7/16" FENDER WASHER	2
13	3/8" X 4.5" HEX BOLT	1
14	2.5" CLAMP	4
15	3.0" CLAMP	2
16	TIP	2

Refer to this LOT NUMBER when contacting customer service: \_\_\_\_\_

## PLEASE READ BEFORE STARTING INSTALLATION

While MBRP has made every effort to ensure that all components of this system are of superior quality and properly packaged, it is the installer's responsibility to ensure the following before removal of the factory exhaust:

- that ALL components shown above are present.
- that ALL mating components fit together.
- that there are no damaged components.
- that the system you have purchased is appropriate for your vehicle year, model and configuration.
- that the system will not interfere with any modifications previously installed or planned.
- that you have read and understand these instructions.

If you have any questions or are uncertain about any aspect of the installation of this system to your vehicle please contact your dealer before commencing installation.

# MBRP

## Removal of Stock System



Figure 1

1. Apply penetrating lubricant liberally to all exhaust fasteners, hangers and rubber insulators.

2. Support the front pipe and loosen the clamp in front of the muffler. Refer to Figure 1.

3. Unbolt the factory tail pipe insulator from the frame. Refer to Figure 2.

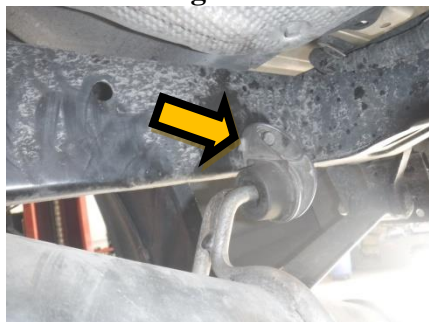

Figure 2

4. Remove the remaining two hangers from the factory rubber insulators and remove the muffler and tail pipe assembly from the vehicle.

## Installation of MBRP Performance Exhaust

1. Using a 2.5" Clamp, install the Adaptor Pipe. Do not fully tighten until all parts are installed. Take care that the boss on the factory pipe goes into the notch of the Adaptor Pipe. The 2.5" Clamp is a tight fit. Refer to Figure 3.



Figure 3

2. Install the Hang Tight™ Hanger onto a 3.0" Band Clamp using the procedure shown below. (Hang Tight™ Hanger not exactly as shown)

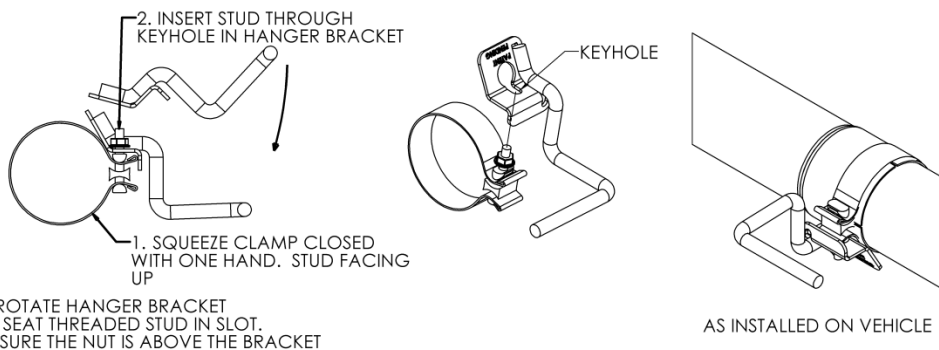

Figure 4

3. Place the previously assembled 3.0" Band Clamp and Hang Tight™ Hanger onto the Muffler. Install the Muffler onto the Adaptor Pipe and place the Hang Tight™ Hanger into the factory isolator. When tightening, pull down on the isolator end of the Hang Tight™ Hanger to ensure the isolator is taking some weight. Refer to Figure 4.

4. Using a 3.0" Clamp, loosely install the Y-Pipe into the Muffler and into the factory isolator. Refer to Figure 5.



Figure 5

# MBRP



Figure 6

5. Using a **2.5" Clamp**, loosely install the **Passenger-Side Tail Pipe** and re-install the factory tail pipe insulator to the frame.  
**Refer to Figure 6.**



Figure 7

6. Using a **2.5" Clamp**, loosely install the **Over-Axle Pipe** onto the **Y-Pipe**.  
**Refer to Figure 7.**

7. Using the supplied **Hardware**, attach the **Hanger Assembly** to the outside of the driver-side frame rail. The **Hanger Assembly** can be adjusted up and down to fine-tune **Tip** alignment.  
**Refer to Figures 8 (outside), 9 (inside) and the first page exploded view.**



Figure 8

8. Using a **2.5" Band Clamp**, loosely install the **Driver-Side Tail Pipe** onto the **Over-Axle Pipe** and into the **Hanger Assembly**.  
**Refer to Figure 10.**

9. Loosely install the exhaust **Tips** and carefully adjust and align the pipes to provide equal spacing of the tips. The **Tips** can be adjusted to your liking.

10. Tighten all hardware and clamps, starting at the front and working rearward to secure the system. Check along the full length of the exhaust system to ensure there is adequate clearance for fuel lines, vent lines, brake lines, frame, bodywork, suspension and any wiring, etc. If there is any interference detected, relocate or adjust to provide adequate clearance. Ensure all clamp connections are secure and components are unable to rotate or slide. Band clamps require approximately 45 lb-ft (60 N-m) of torque. Verify clearances, system security and band clamp torque after 30-60 miles (50-100 km) of driving.



Figure 9



Figure 10



**Congratulations!** You are ready to begin experiencing the improved power, sound and driving experience of your **MBRP** Performance Exhaust. We know you will enjoy your purchase!