

S5216

2008-2010 Ford F250/F350,
Crew Cab Long Box/Short Box and Extended
Cab Long Box,
5.4L/6.2L/6.8L, Cat-Back, 3.0" Single Side

MBRP®

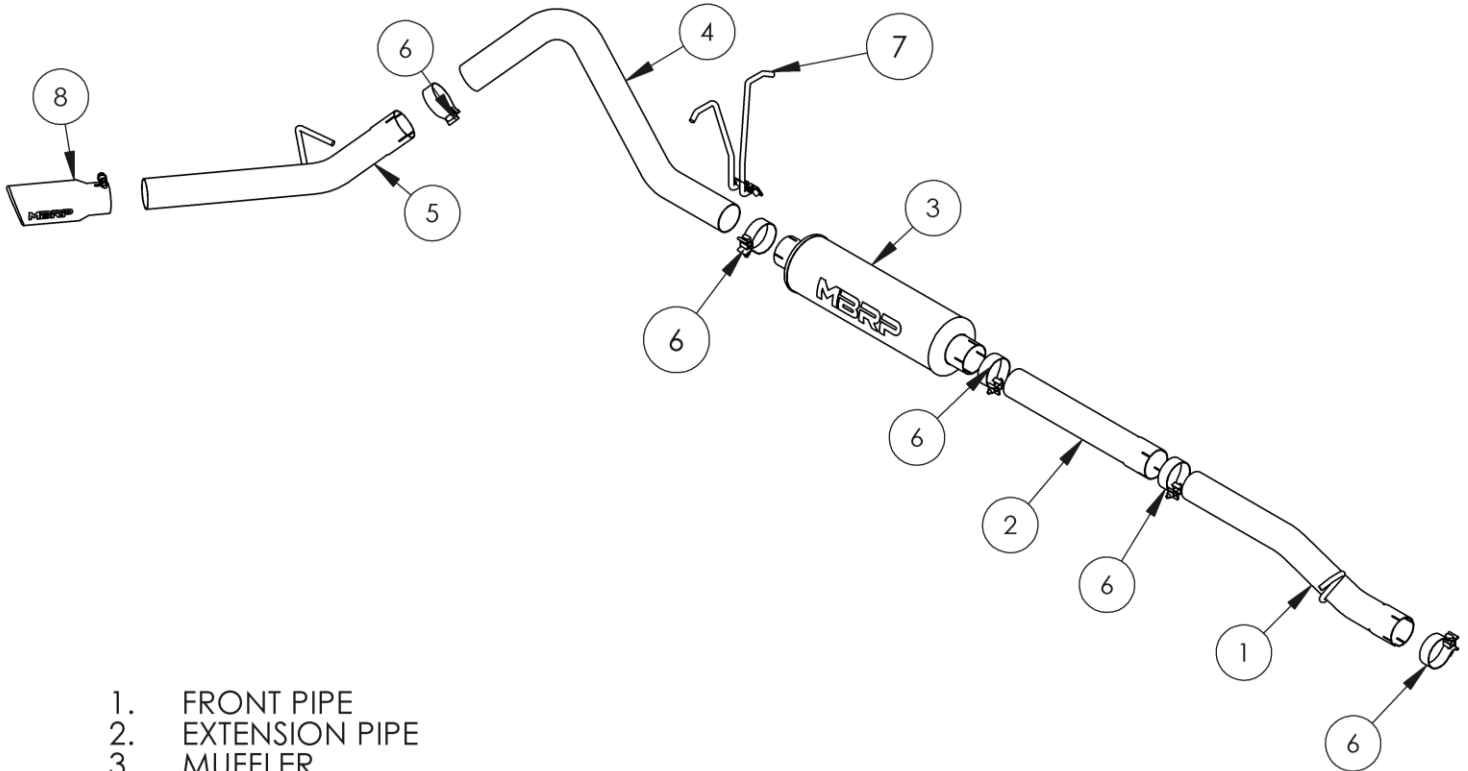

1. FRONT PIPE
2. EXTENSION PIPE
3. MUFFLER
4. OVER AXLE PIPE
5. TAIL PIPE
6. 3" BAND CLAMP (4 PCS)
7. HANG TIGHT™ HANGER
8. EXHAUST TIP

PLEASE READ BEFORE STARTING INSTALLATION

While MBRP has made every effort to ensure that all components of this system are of superior quality and properly packaged, it is the installer's responsibility to ensure the following before removal of the factory exhaust:

- that ALL components shown above are present.
- that ALL mating components fit together.
- that there are no damaged components.
- that the system you have purchased is appropriate for your vehicle year, model and configuration.
- that the system will not interfere with any modifications previously installed or planned.
- that you have read and understand these instructions.

If you have any questions or are uncertain about any aspect of the installation of this system to your vehicle please contact your dealer before commencing installation.

MBRP®



Figure 1

Removal of Stock System:

1. Apply a penetrating lubricant liberally to all exhaust fasteners, hangers and rubber insulators.

2. Loosen the clamp located rearward of the “Y” pipe and flange.
Refer to Figures 1.



Figure 2

3. Remove the hangers from the rubber insulators and remove the exhaust from the vehicle. If a hoist or hydraulic lift is not being used the tail pipe may need to be cut to clear the rear axle. **Refer to Figures 2 & 3.**



Figure 3

Installation of MBRP Inc. Performance Exhaust:

1. Install the **Front Pipe** to the vehicle using one of the **3” Clamps** provided. Attach the **Front Pipe** hanger to the existing rubber isolator.
Refer to Figure 4.

2. Slide a **3” Clamp** over the **Front Pipe** and install the **Extension Pipe** over the **Front Pipe**.

Note: The **Extension Pipe** is only required for the Crew Cab Long Box (174.2” Wheelbase)



Figure 4

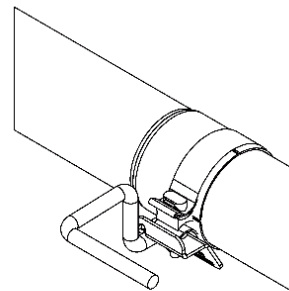
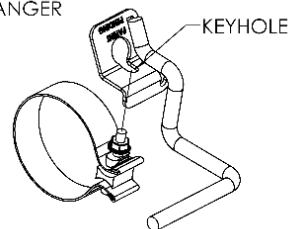
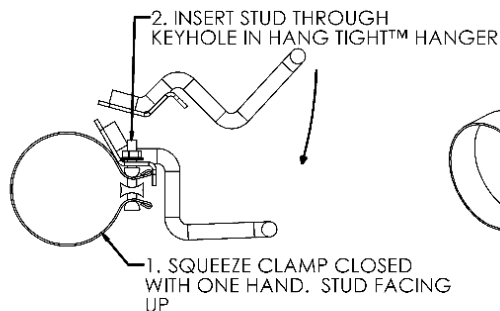

Figure 5

3. Slide a **3" Clamp** over the **Extension Pipe** and install the **Muffler** onto the **Extension Pipe**. Install the **Hang Tight™ Hanger** (see **Figure 10** below for instal instructions) loosely to outlet of the **Muffler** placing the hangers into the existing rubber isolators. Refer to **Figures 5 & 6**.



Figure 6



3. ROTATE HANG TIGHT™ HANGER TO SEAT THREADED STUD IN SLOT. BE SURE THE NUT IS ABOVE THE BRACKET

Figure 10



Figure 7

4. Loosely install the **Over Axle Pipe** connecting it to the **Muffler** outlet using the **Hang Tight™ Hanger**. Refer to **Figure 7**.

5. Attach the expanded end of the **Tail Pipe** and connect it to the **Over Axle Pipe** using the remaining **3" Clamp**. Slide the **Tail Pipe** hanger into the factory rubber isolator. Refer to **Figure 8**.



Figure 8

6. Install and adjust the **Exhaust Tip** to suit. Using a 17mm wrench tighten the lock bolt on the **Exhaust Tip**. Refer to **Figure 9**.

7. Tighten all hardware and clamps, starting at the front and working rearward to secure the system. Check along the full length of the exhaust system to ensure there is adequate clearance for fuel lines, vent lines, brake lines, frame, bodywork, suspension, and any wiring, etc. If there is any interference detected, relocate, or adjust to provide adequate clearance. Ensure all clamp connections are secure and components are unable to rotate or slide. Band clamps require approximately 45 lb-ft (60 N-m) of torque. Verify clearances, system security and band clamp torque after 30-60 miles (50-100 km) of driving.



Figure 9

Congratulations! You are ready to begin experiencing the improved power, sound and driving excitement of your MBRP Inc. performance exhaust system. We know you will enjoy your purchase.