

# S5090P

2017-2022 CHEV/GMC  
CANYON/COLORADO,  
2.5L/3.6L, 3" SINGLE SIDE

# MBRP®

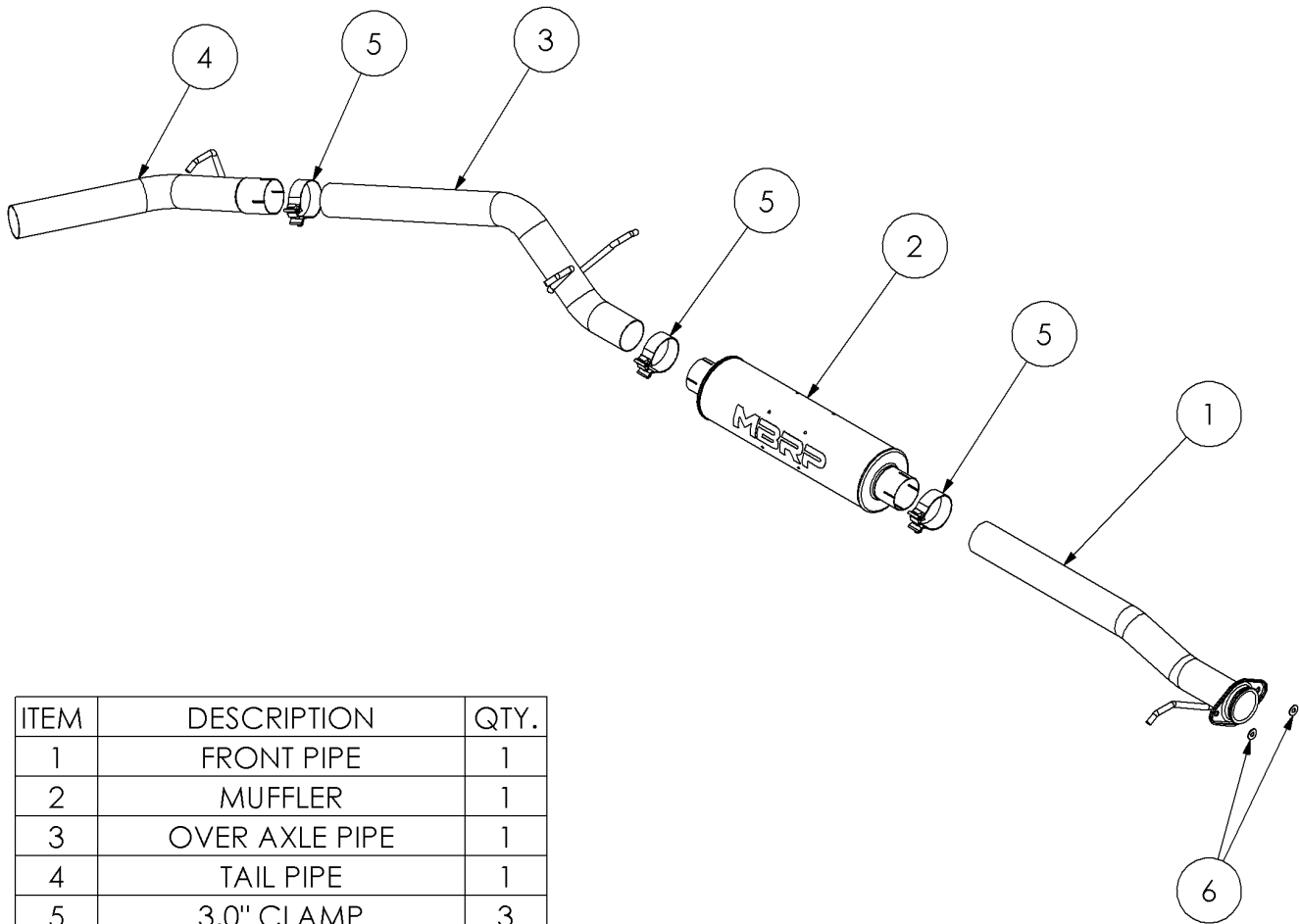

ITEM	DESCRIPTION	QTY.
1	FRONT PIPE	1
2	MUFFLER	1
3	OVER AXLE PIPE	1
4	TAIL PIPE	1
5	3.0" CLAMP	3
6	3/8" FLAT WASHER	2

## PLEASE READ BEFORE STARTING INSTALLATION

While MBRP has made every effort to ensure that all components of this system are of superior quality and properly packaged, it is the installer's responsibility to ensure the following before removal of the factory exhaust:

- that ALL components shown above are present.
- that ALL mating components fit together.
- that there are no damaged components.
- that the system you have purchased is appropriate for your vehicle year, model and configuration.
- that the system will not interfere with any modifications previously installed or planned.
- that you have read and understand these instructions.

If you have any questions or are uncertain about any aspect of the installation of this system to your vehicle please contact your dealer before commencing installation.

# MBRP®

## Removal of Stock System:



**Figure 1**

1. Apply a penetrating lubricant liberally to all hangers and rubber isolators.
2. Remove two flange nuts at the front flex pipe flange. Save the flange nuts as they will be used for the installation.

**Refer to Figure 1.**

3. Remove the factory hangers from the rubber isolators and remove the factory system.

## Installation of MBRP Performance Exhaust:



**Figure 3**

1. The **Front Pipe** is supplied to fit the long wheelbase (CCLB) truck. If you have a short wheelbase truck (CCSB, ECLB) you will need to cut 12.25" off the **Front Pipe**.

**Refer to Figure 2.**



**Figure 4**

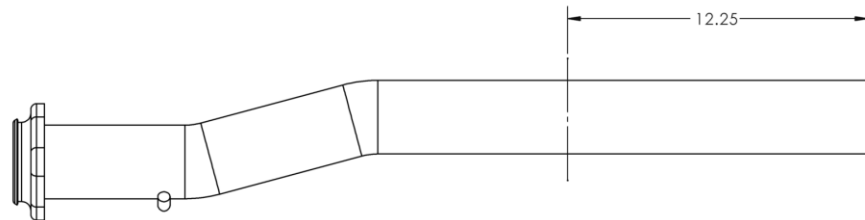

**Figure 2.**

2. Loosely install the **Front Pipe** using the supplied **3/8" Washers**, factory flange nuts and rubber isolator. Take care to install the flange nuts equally.
- Refer to Figure 3.**



**Figure 5**

3. Connect the **Tail Pipe** with the **Over-Axle Pipe** separate from the vehicle. Then install the **Tail Pipe** and **Over-Axle Pipe** into the factory rubber isolators. It may be easiest to remove one of the front isolators and install onto the **Over-Axle Pipe** hanger first, then back onto the factory frame hanger.

**Refer to Figures 4 and 5.**



**Figure 6**

4. Place a **3" Clamp** over the **Front Pipe** and **Over-Axle Pipe**.

5. Install the **Muffler** onto the **Front Pipe** then the **Over-Axle Pipe**.
- Refer to Figure 6**



6. Tighten all hardware and clamps, starting at the front and working rearward to secure the system. Check along the full length of the exhaust system to ensure there is adequate clearance for fuel lines, vent lines, brake lines, frame, bodywork, suspension, and any wiring, etc. If there is any interference detected, relocate, or adjust to provide adequate clearance. Ensure all clamp connections are secure and components are unable to rotate or slide. Band clamps require approximately 45 lb-ft (60 N-m) of torque. Verify clearances, system security and band clamp torque after 30-60 miles (50-100 km) of driving.

**Congratulations!** You are ready to begin experiencing the improved performance and driving pleasure of your **MBRP** Performance Exhaust system. We know you will enjoy your purchase.