

AT-9111PT

2015-UP HONDA FOREMAN RUBICON 500/520,
2015-UP HONDA FOREMAN 420 IRS

MBRP®

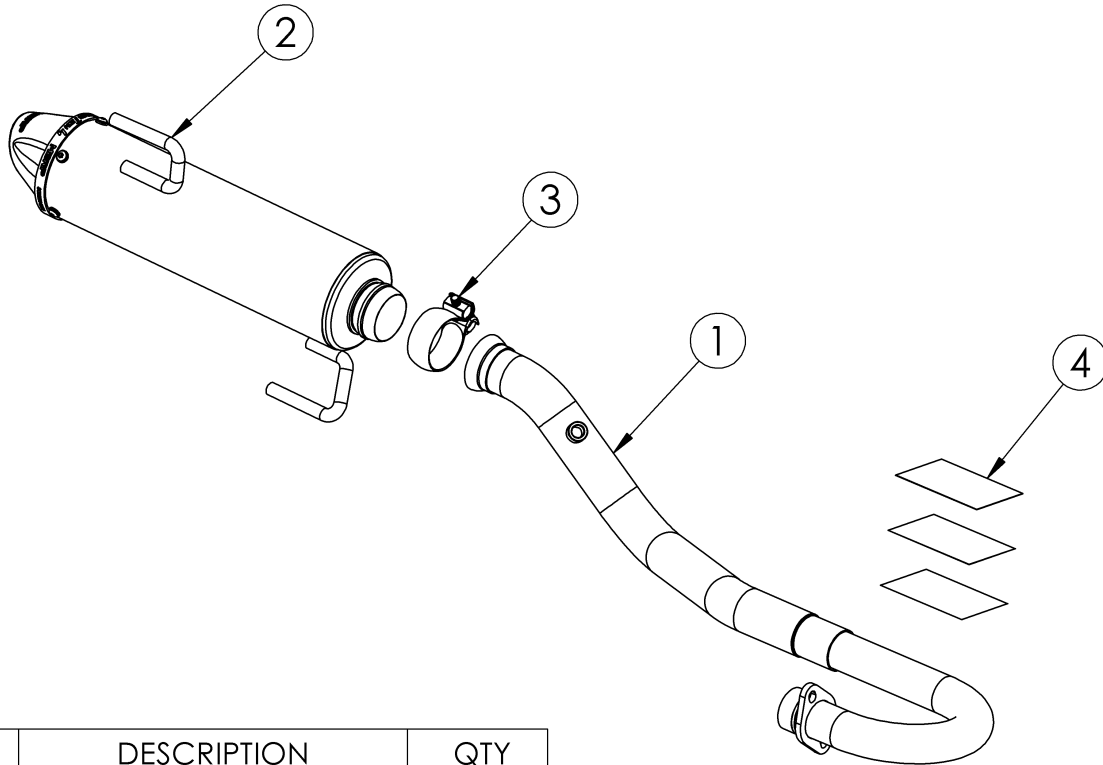

ITEM NO.	DESCRIPTION	QTY
1	FRONT PIPE	1
2	MUFFLER ASSEMBLY	1
3	CLAMP	1
4	FOIL TAPE	3

Refer to this LOT NUMBER when contacting customer service: _____

PLEASE READ BEFORE STARTING INSTALLATION

While MBRP has made every effort to ensure that all components of this system are of superior quality and properly packaged, it is the installer's responsibility to ensure the following before removal of the factory exhaust:

- that ALL components shown above are present.
- that ALL mating components fit together.
- that there are no damaged components.
- that the system you have purchased is appropriate for your vehicle year, model and configuration.
- that the system will not interfere with any modifications previously installed or planned.
- that you have read and understand these instructions.

If you have any questions or are uncertain about any aspect of the installation of this system to your vehicle please contact your dealer before commencing installation.

MBRP

Removal of Stock Exhaust:

CAUTION: ALLOW THE EXHUAST TO FULLY COOL BEFORE PERFORMING THIS INSTALLATION.



Figure 1

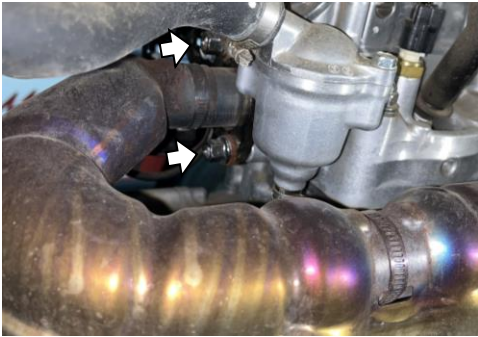

Figure 2

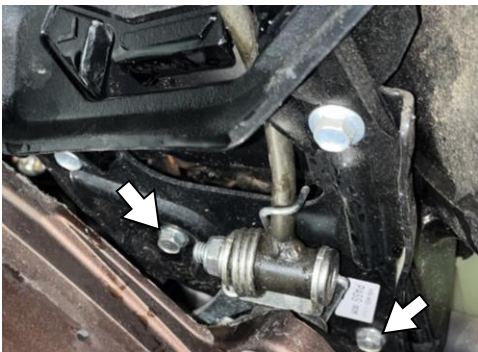

Figure 3



Figure 4



Figure 5

1. Remove the seat and side panels to access the front of the exhaust. **Refer to Figure 1.**

2. Loosen and remove the two (2) nuts and washers securing the flange at the inlet of the exhaust. **Refer to Figure 2.**

3. Remove the sensor from the stock exhaust.

4. In order to remove the exhaust, the shifter must first be temporarily moved. Remove the two bolts that hold the shifter in place to allow it to move outward. **Refer to Figure 3.**

5. Push the exhaust forward to free the inlet pipe, then slide the exhaust out from the rear, disengaging the hangers from the rubber isolators.

Installation of MBRP Exhaust:

1. Slide the **Muffler Assembly** into position, with the hangers going into the factory isolators from the front. **Refer to Figure 4.**

2. With the **Clamp** loosened and placed over the **Muffler Assembly** inlet, install the **Front Pipe**. With the **Front Pipe** in place and aligned to the **Muffler Assembly**, slide the **Clamp** over the **Inlet Pipe** flare and tighten it just enough to prevent movement.

3. Apply two (2) pieces of the supplied **Foil Tape** to the gas tank shield in the area closest to the **Front Pipe**, adjacent to the stock heat tape. **Refer to Figure 5.**

Refer to Figure 5.

4. Reinstall the two (2) nuts and washers to secure the inlet flange. Verify the alignment of the **Muffler** and **Front Pipe**, then fully tighten the **Clamp** (35Nm).

5. Replace the exhaust sensor and reattach the shifter.

6. The third piece of **Foil Tape** can be applied to the inner rear fender in the area nearest to the exhaust pipe, if the stock foil is missing or damaged.

7. Replace the side panels and seat.

It is recommended that the muffler end cap screws be retightened (60 in-lbs /6.8 Nm) after the first ride and checked periodically thereafter, tightening if necessary.

Congratulations! You are ready to begin experiencing the improved performance, sound and driving experience of your **MBRP** performance exhaust system. We know you will enjoy your purchase.



Figure 1



Figure 2



Figure 3



Figure 4

Spark Arrestor Maintenance

In order to maintain optimal performance, the spark arrestor screen should be cleaned after the first 3 hours of use. Afterwards, clean every 30-35 hours of use.

Clean-out Instructions:

Make sure the vehicle is cool before completing the clean-out procedure.

1. Using a 4mm hex key, remove the 4 screws securing the outlet cap or tip. **(Figure 1)**
2. Remove the outlet cap to expose the spark arrestor screen insert. **(Figure 2)**
3. Remove the screen insert. **(Figure 3)**
4. Using a wire brush, thoroughly brush the screen to remove residue. **(Figure 4)**
5. Replace the screen and cap.
6. Tighten the screws to 60 in-lbs (6.8 Nm).