

AT-6109SP

SPORT MUFFLER - SLIP-ON SYSTEM
2007-2013 HONDA FOREMAN/RANCHER 420
2014 HONDA RANCHER AT 420
2012-2013 HONDA FOREMAN/RANCHER 500
(ALL EXCLUDING AUTOMATIC MODELS)

MBRP®

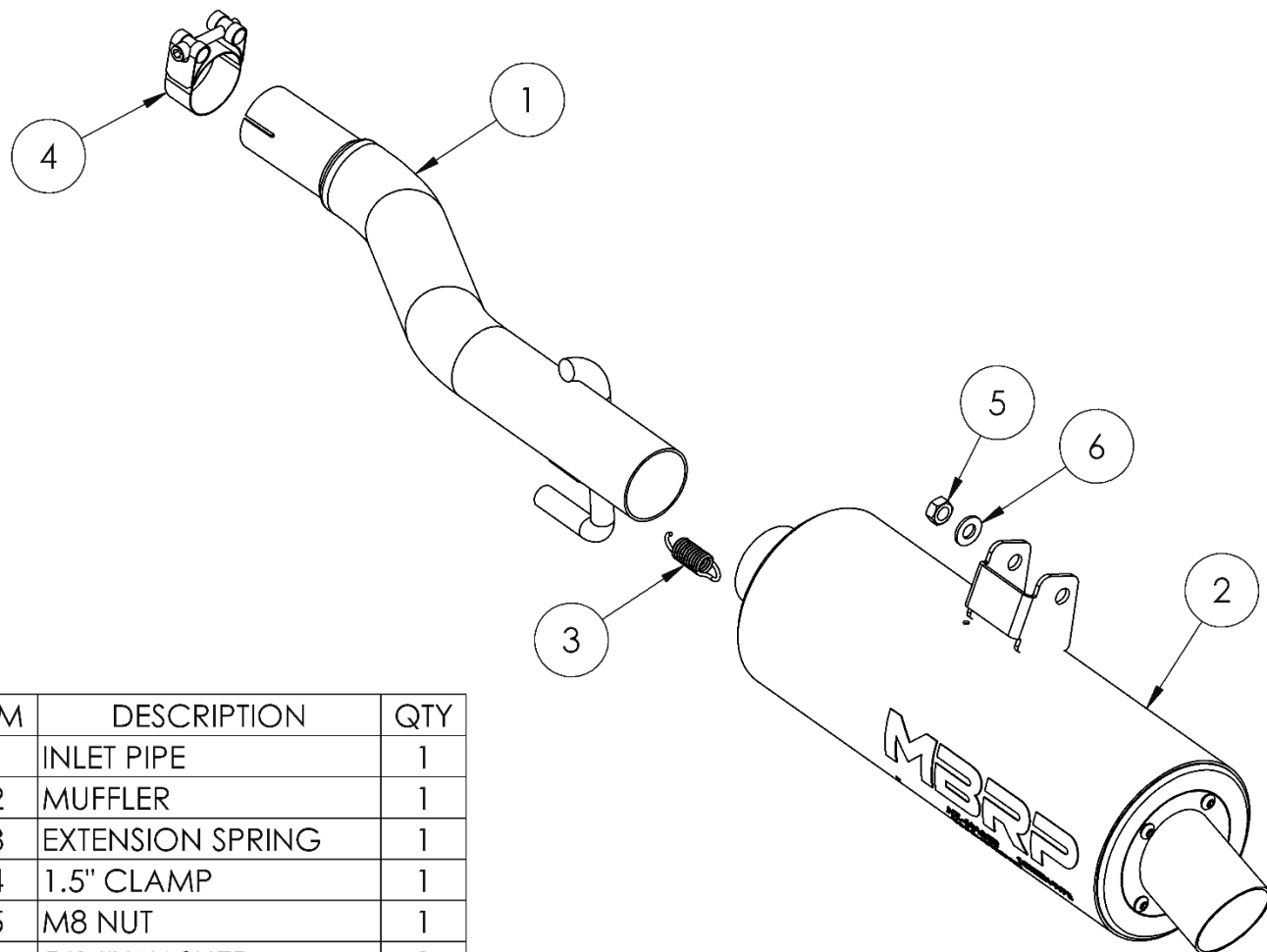

ITEM	DESCRIPTION	QTY
1	INLET PIPE	1
2	MUFFLER	1
3	EXTENSION SPRING	1
4	1.5" CLAMP	1
5	M8 NUT	1
6	5/16" WASHER	1

PLEASE READ BEFORE STARTING INSTALLATION

While MBRP has made every effort to ensure that all components of this system are of superior quality and properly packaged, it is the installer's responsibility to ensure the following before removal of the factory exhaust:

- that ALL components shown above are present.
- that ALL mating components fit together.
- that there are no damaged components.
- that the system you have purchased is appropriate for your vehicle year, model and configuration.
- that the system will not interfere with any modifications previously installed or planned.
- that you have read and understand these instructions.

If you have any questions or are uncertain about any aspect of the installation of this system to your vehicle please contact your dealer before commencing installation.

MBRP

Removal of Stock System



Figure 1

1. Remove the seat and 2 left side panels to gain access to the exhaust. **Refer to Figure 1.** (420 shown)

2. Undo the hose clamps that fasten the heat shield onto factory front pipe. Slide the heat shield forwards to gain access to the clamp for the muffler. Completely remove the (2) clamp bolts attaching the muffler to the front pipe.

Refer to Figure 1.

3. Remove the bolt securing the muffler at the rear of the bike and rotate the muffler counter-clockwise to remove rearward. Retain hardware for installation

Refer to Figure 2.



Figure 2

Installation of MBRP Performance Exhaust:

Note: High heat silicone may be desired at joints to prevent any exhaust leaks.

1. Slide together the **Muffler** and **Inlet Pipe**, securing with the **Extension Spring**.

Refer to Figure 3.



Figure 3

2. Place the **1.5" Clamp** onto the **Inlet Pipe** and rotate the **Muffler/Inlet Pipe** onto the factory front pipe and into the factory hanger isolator.

Refer to Figure 4.

3. Reinstall the factory bolt through the bracket on the **Muffler** and use the supplied **5/16" Washer** and **M8 Nut** to secure.

Refer to Figure 5.



Figure 4

4. Tighten the **1.5" Clamp** being sure to tighten down in a spot that won't interfere with plastics. Reinstall all plastics.

If a quieter tone is desired contact your local dealer to purchase T14373.



Figure 5



Congratulations! You are ready to begin experiencing the improved power, sound and driving experience of your **MBRP** performance exhaust system. We know you will enjoy your purchase.

MBRP

Spark Arrestor Maintenance

In order to maintain optimal performance, the spark arrestor screen should be cleaned after every 30-35 hours of use.

Clean-out Instructions:

Make sure the vehicle is cool before completing the clean-out procedure.

1. Using a 1/8" hex key, remove the 4 screws securing the outlet cap. (Figure 1).
2. Remove the outlet cap to expose the spark arrestor screen insert. (Figure 2)
3. Remove the screen insert. (Figure 3)
4. Using a wire brush, thoroughly brush the screen to remove residue. (Figure 4)
5. Replace the screen and cap.
6. Tighten the screws to 23 in-lbs (2.6 Nm).



Figure 1



Figure 2



Figure 3



Figure 4