

LOWE'S
DESTROYER SERIES
JK
JEEP JK 4DR DESTROYER
SLIDERS

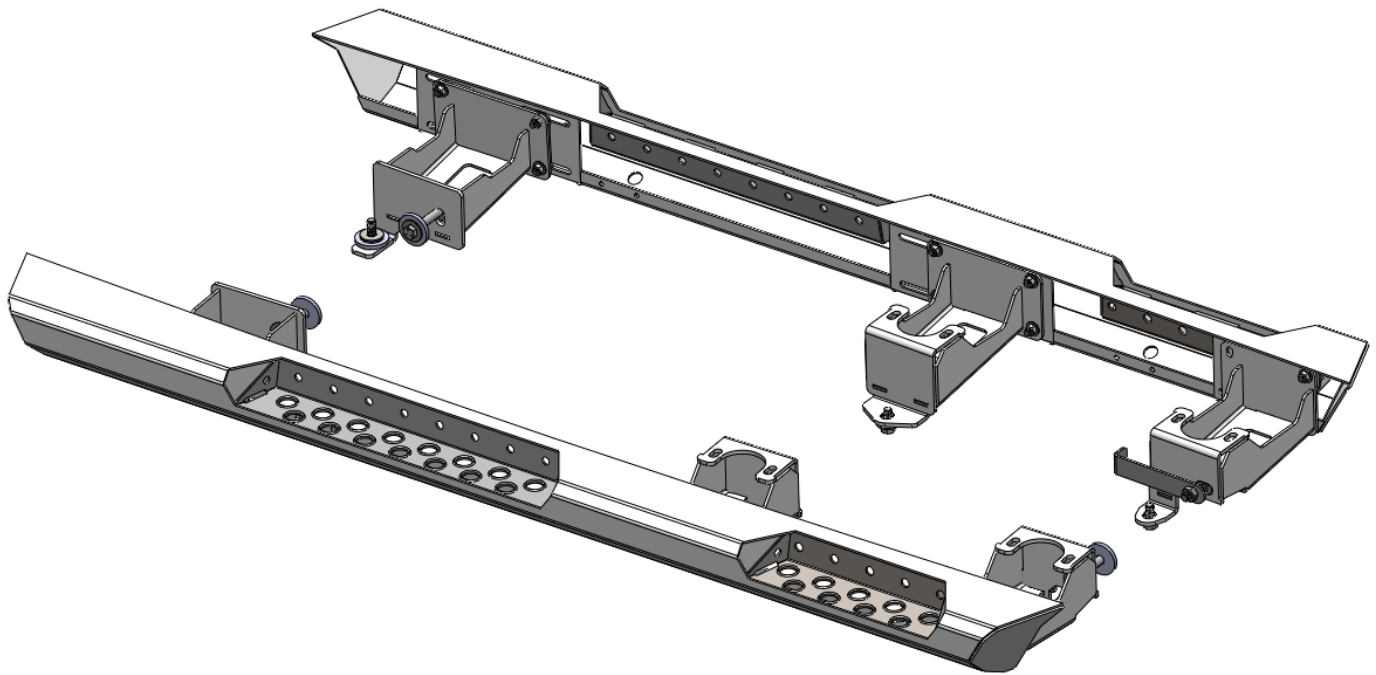

VERIFY YOU HAVE ALL THE COMPONENTS BEFORE STARTING THE INSTALLATION. REFER TO THE ENGINEERING DRAWINGS AT THE END OF THIS DOCUMENT FOR A COMPLETE PARTS LIST



Getting Started:

Before installation be sure to check your the bottom of your frame near where the mounts are installed for any oversize or drippy welds. The bottom of the frame should be smooth, if not you will need to grind the welds down slightly. Be sure to touch up the grinding area with paint to prevent rust.

Start by laying out each mount in their position, front-center-rear for both driver and passenger sides. On the bottom of each mount, there are two marks, the small hex indicates that the mount is for a Jeep JKU, the arrow/triangle points towards the front of the Jeep.

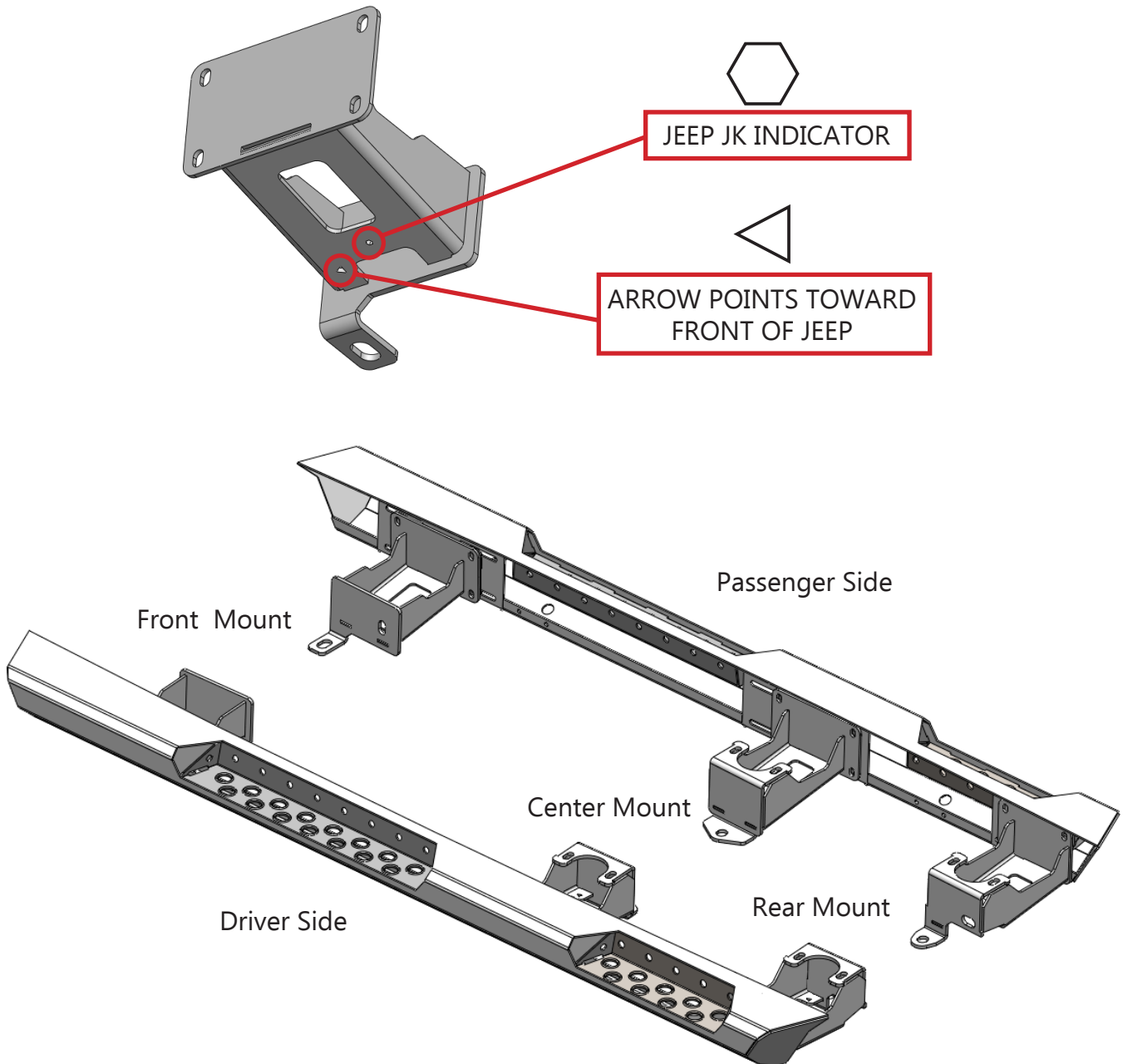

Installing the Front Mounts:

Install the Front Mounts as shown (passenger side shown here). Install the 1/2" Hex Bolt and Washers from inside the frame rail. Be sure to use the thick Backing Washer over the large hole on the inside of the frame rail.

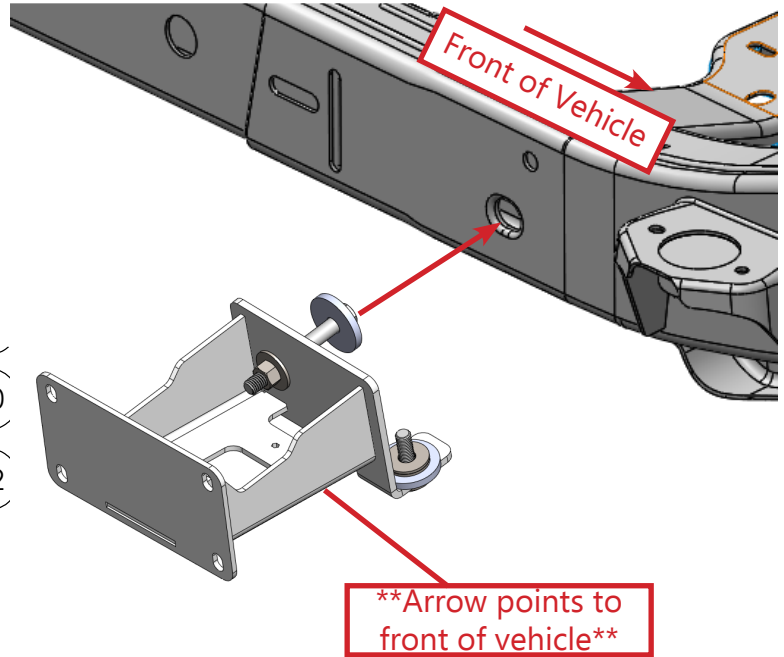
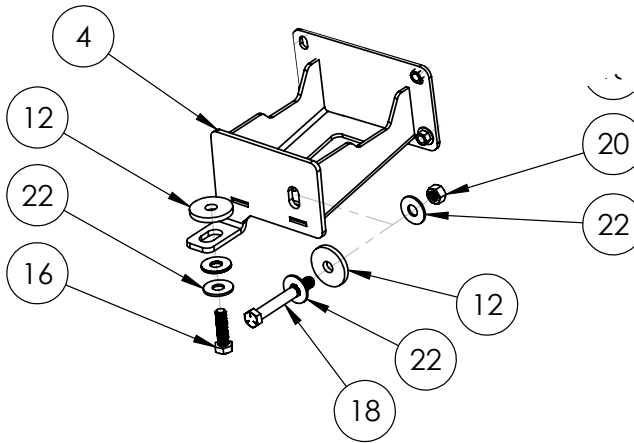

Install the M12 Hex Bolt and Washer thru the lower mounting hole into the bottom of the frame. There should be a frame nut already in this position for the front cross member.

Depending on your Jeep model and year, you may have a transmission cross member using the same mounting hole as Destroyer Front Mount. We provide additional Washers and Backing Washers that you may use to correctly space your slider up and down which helps maintain a consistent gap between the slider and your Jeep body. See the diagram below, based on your Jeep install the washers as shown.

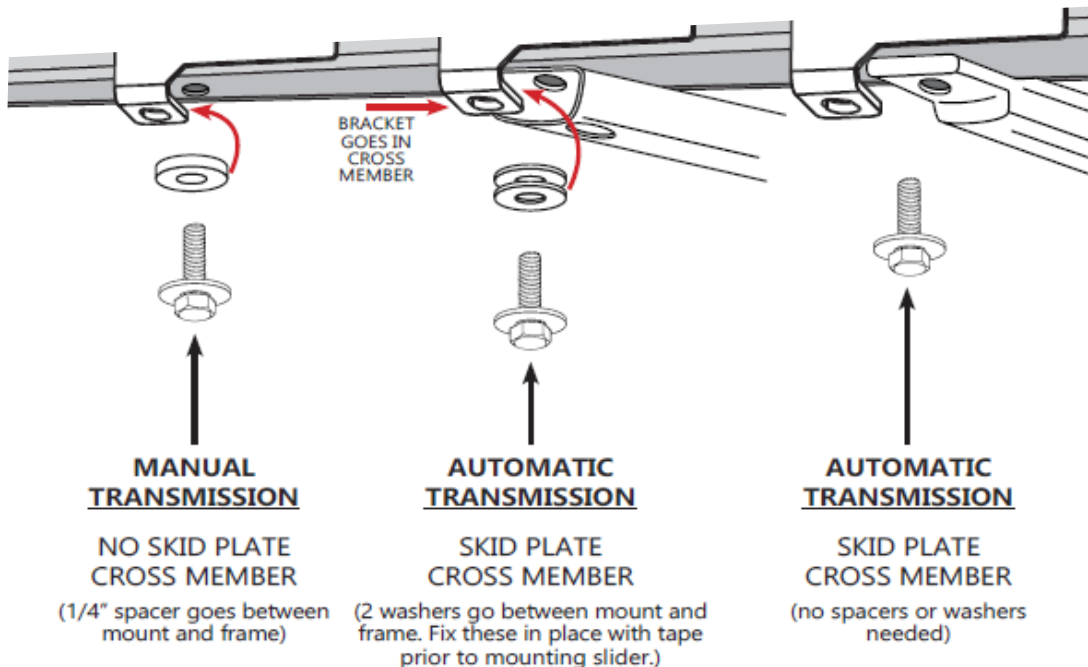

Installing the Center Mounts:

Install the Center Mounts as shown using the two body isolator nuts "A" shown below. You may need to loosen the large center bolt slightly if the large washer is in the way, but do not remove it.

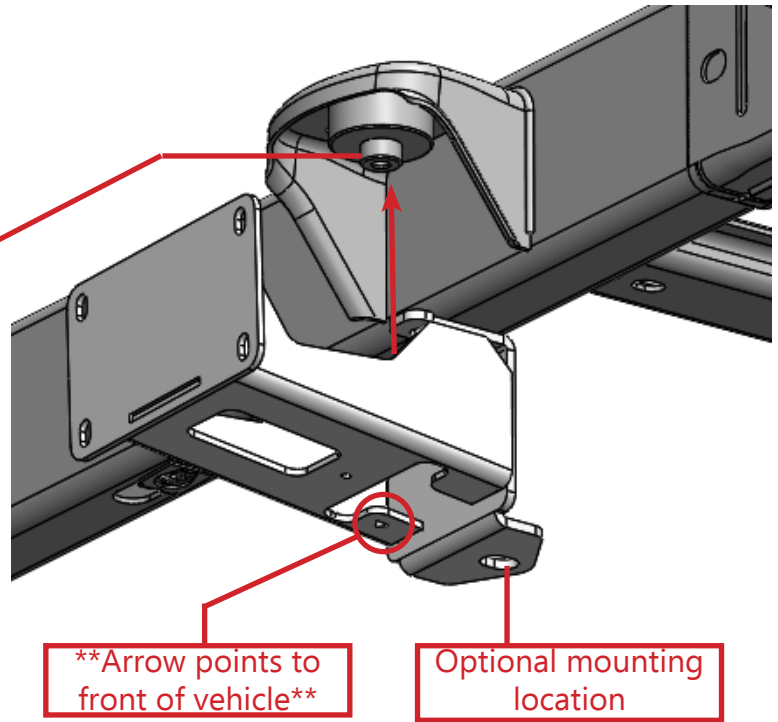
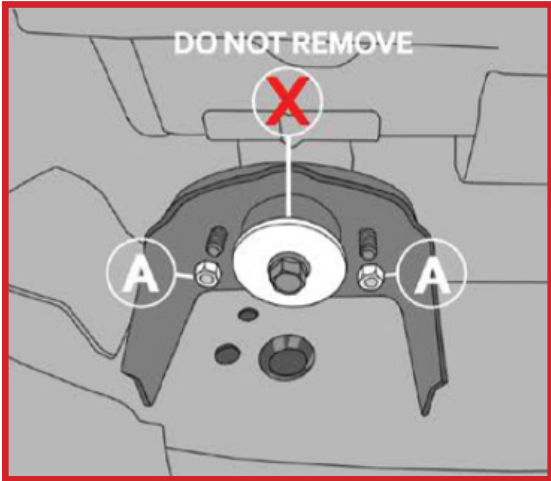

Some welds and seams may need to be ground flat with a hand grinder.

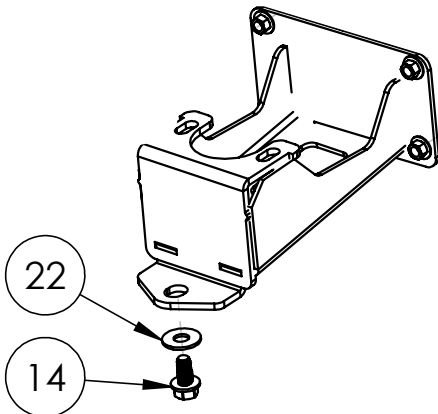

The lower mounting hole is optional (on both passenger and driver side Center and Rear Mounts), but recommended for offroad use. Drill 7/16"Ø hole and insert the self tapping Thread Roller Bolts provided. Slowly tighten until fully seated.

Installing the Rear Mounts:

Install the Rear Mounts as shown using the two body isolator nuts "A" shown below. You may need to loosen the large center bolt slightly if the large washer is in the way, but do not remove it.

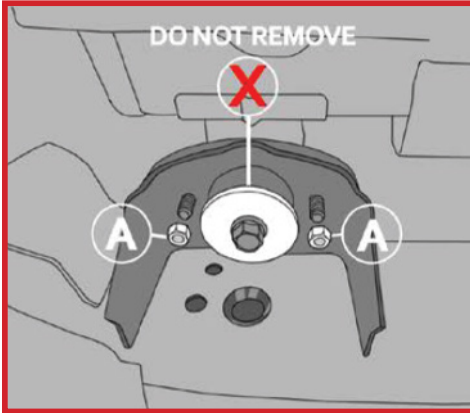

The lower mounting hole is optional (on both passenger and driver side Center and Rear Mounts), but recommended for offroad use. Drill 7/16"Ø hole and insert the self tapping Thread Roller bolts provided. Slowly tighten until fully seated.

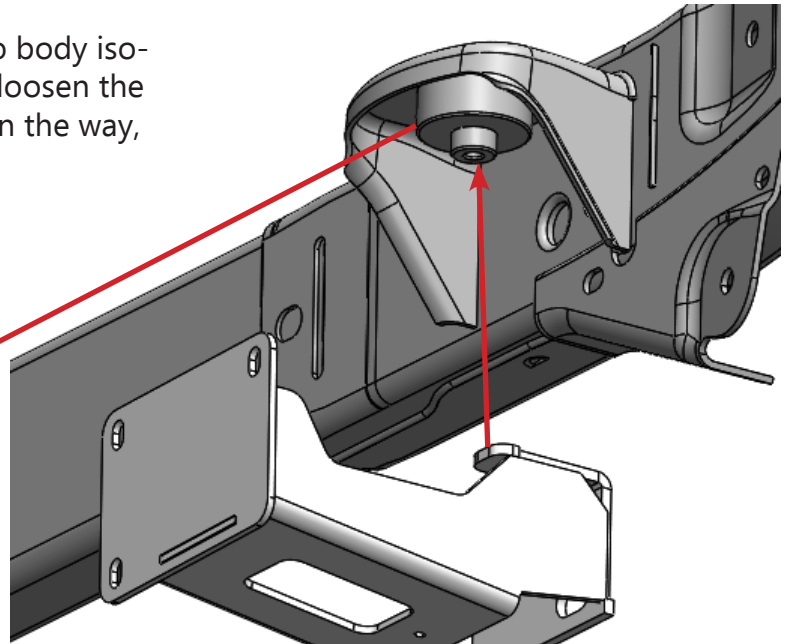

****Arrow points to front of vehicle****

Optional mounting location

****Some welds and seams may need to be ground flat with a hand grinder.****

Passenger Side

On the passenger side, install the Flag Nut provided into the frame rail, install the 1/2" Hex Bolt and Washer as shown.

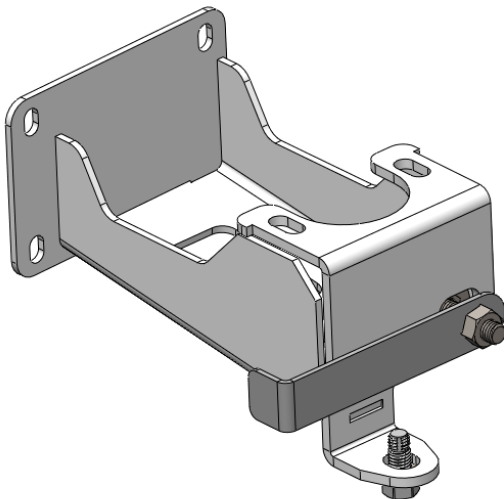

Driver Side

On the driver side, install the 1/2" Hex Bolt and Washers from inside the frame rail. Be sure to use the thick Backing Washer over the large hole on the inside of the frame rail.

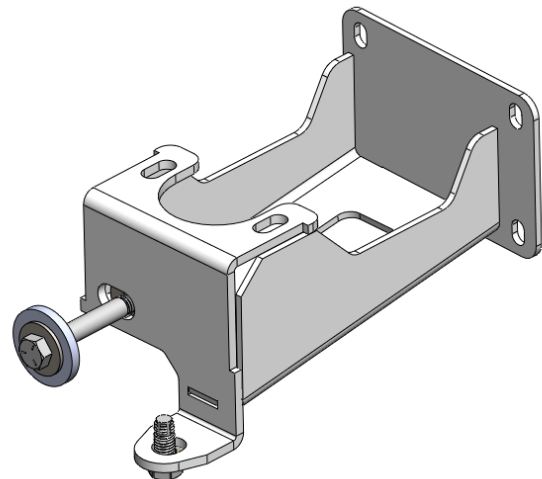

Installing the Slider Body:

With your mounts installed and all bolts tight you can mount the Slider Body into position. The driver side is shown here, the installation will be the same for both sides.



Place the Slider Body up to the Mounts and hold in the position shown while a helper installs the carriage bolts and backup plates for each mount.

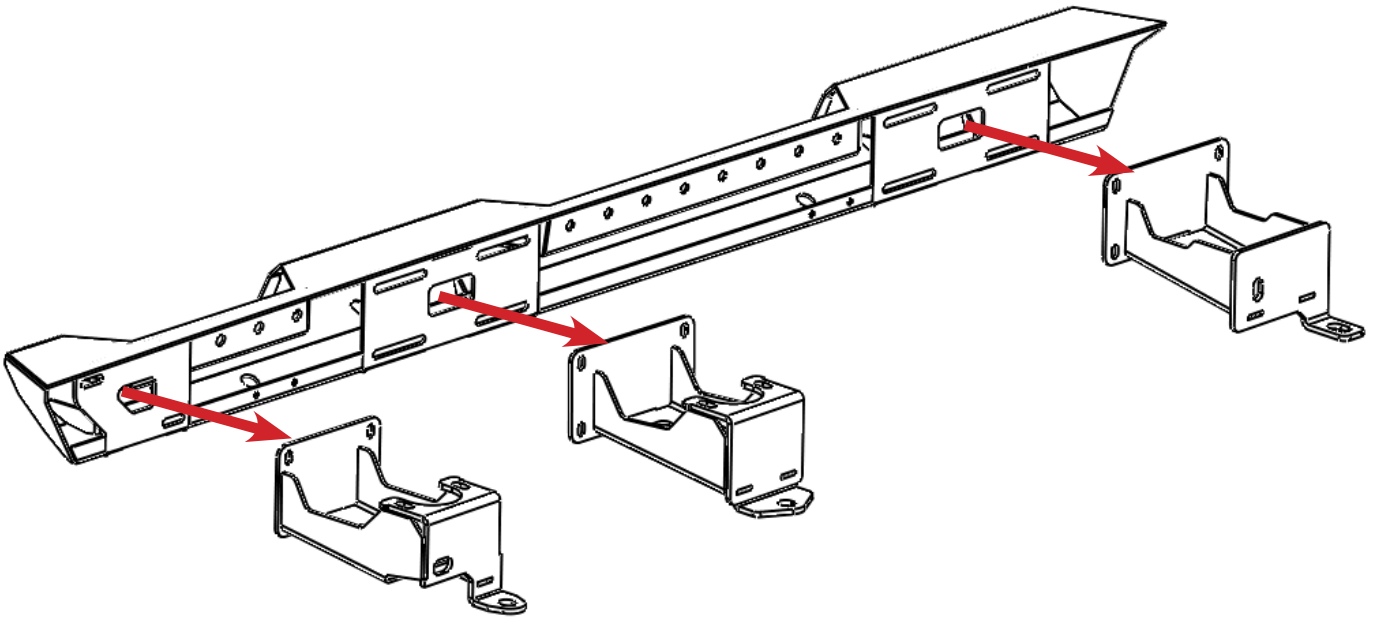

The Front and Center Mounts will use the Backup Plate shown here. Install the Backup Plate from inside the Slider Body and secure with the 3/8" Carriage Bolt, Hex Nut and Washer. Leave these loose while you install the other Backup Plates.

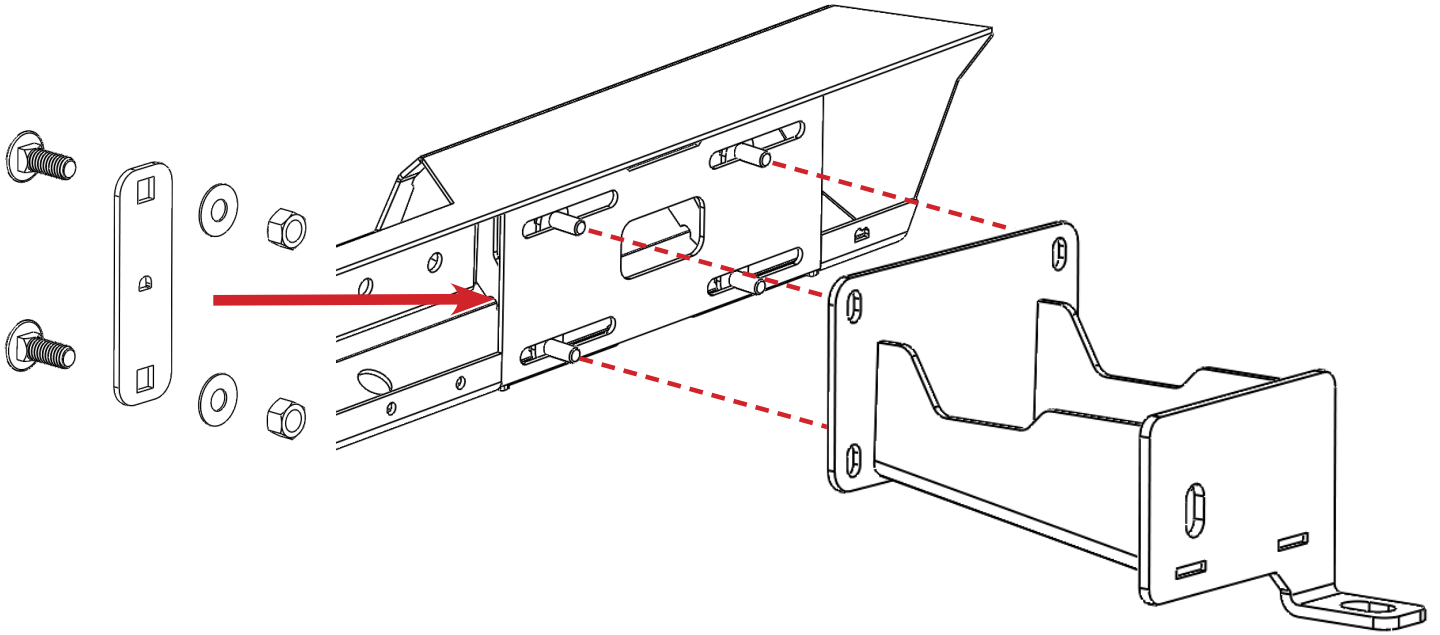

The Rear Mounts will use the Single Backup Plate shown here. Install the Backup Plate from inside the Slider Body and loosely secure with the 3/8" Carriage Bolt, Hex Nut and Washer.

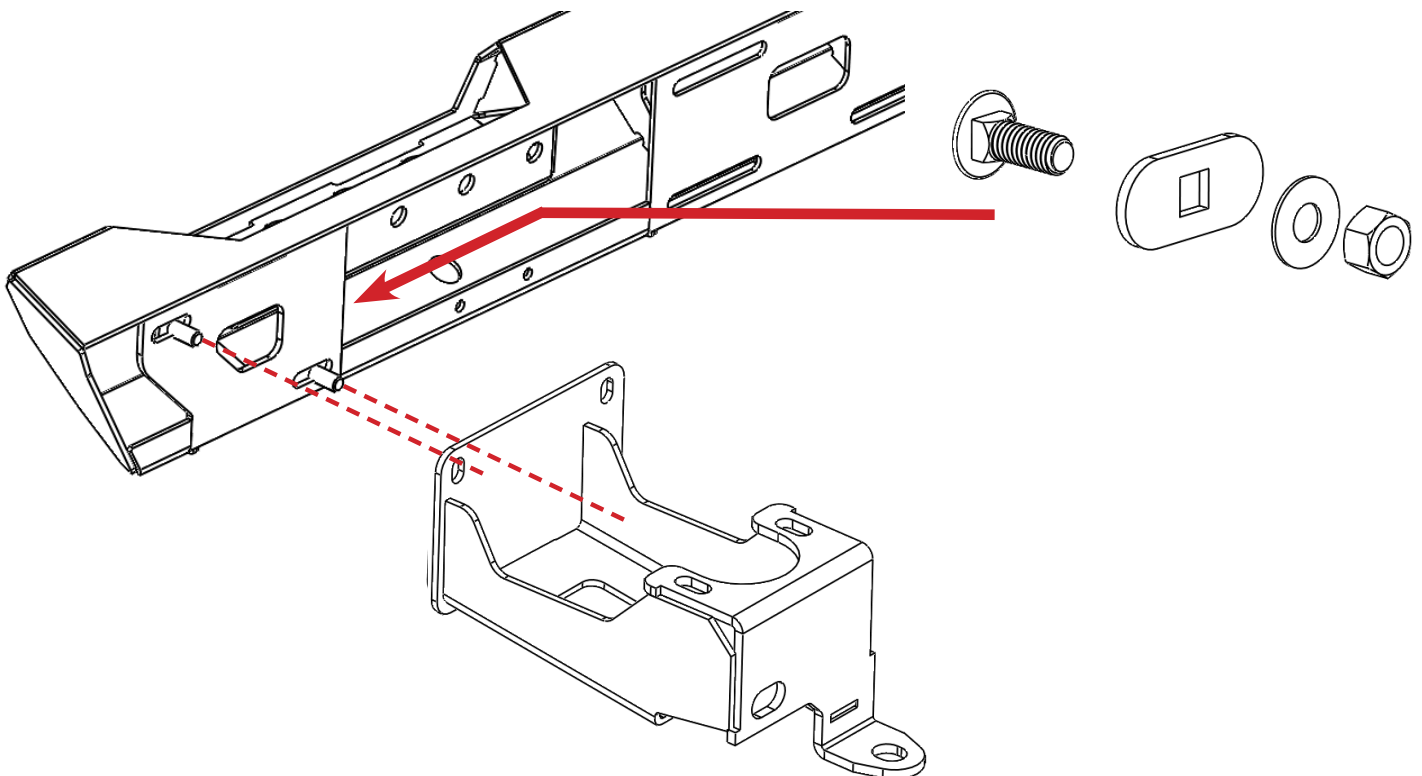

If necessary adjust the sliders slightly by rotating it, or moving up/down or forward/backward to center the sliders and get an even gap between the top sliders and your Jeep body.

For offroad use, we recommend that the Slider Body be in its lowest position possible to provide a greater gap between the Slider Body and the Jeep rocker panel.

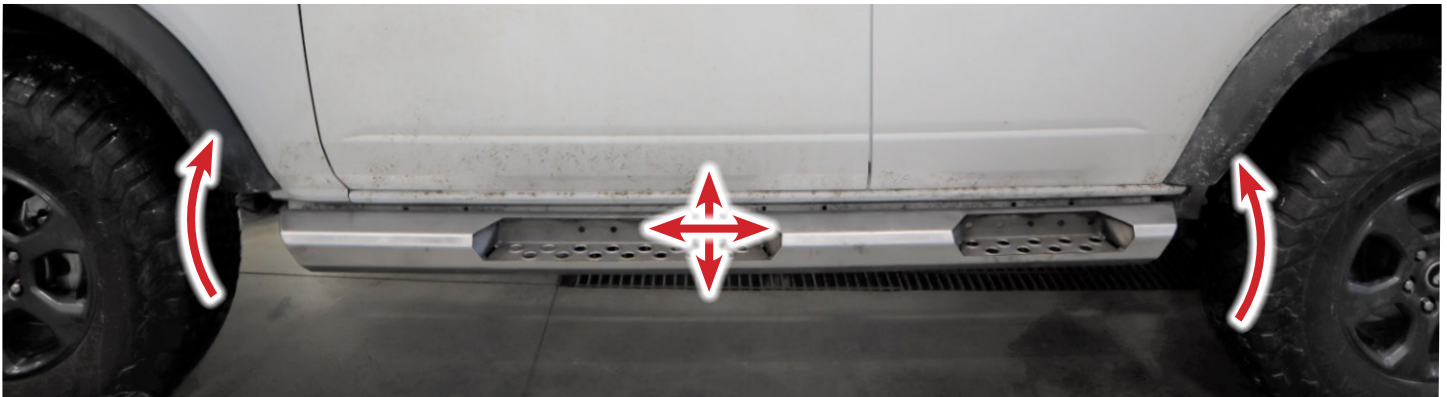

Once you have your Slider in the perfect position, be sure to tighten all the bolt plates evenly.

Every Jeep is different and due to the Jeep manufacturing process, you might find that your slider is a little too close to the body of your Jeep. To resolve this we provide Shim Plates to help get the perfect gap. These plates can be installed without completely removing your slider. Simply loosen a few of the mounting bolts and slide the Shim Plate in where needed between the mount and back of the slider body.

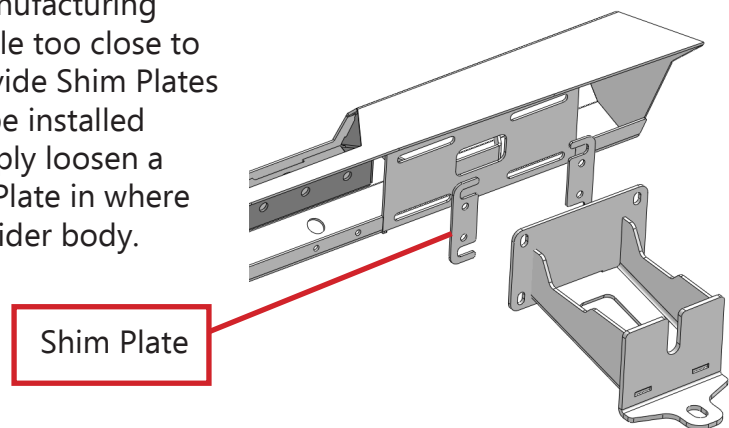

****Maintenance****

- Periodically check and re-tighten all fasteners.
- Periodically check your Sliders for scratches or dings which can happen over time or after heavy use or highway driving. It is important to address these areas as soon as possible to prevent flaking and corrosion or rust from spreading. We recommend using Rustoleum® brand Black Semi-Gloss Protective Enamel (oil based). Remove loose powder coating, sand the area and clean using alcohol. Apply using a foam brush by dabbing to match the powder coat texture.



ITEM NO.	PART NUMBER	DESCRIPTION	QTY.
1	4JRS1854-01	JK/JL DESTROYER BODY - PS WELDMENT	1
2	4JRS1854-02	JK/JL DESTROYER BODY - DS WELDMENT	1
3	4JRS0760-01	JK SLIDER FRONT MOUNT DS	1
4	4JRS0760-04	JK SLIDER FRONT MOUNT PS	1
5	4JRS0760-02	JK SLIDER CENTER MOUNT DS	1
6	4JRS0760-05	JK SLIDER CENTER MOUNT PS	1
7	4JRS0760-03	JK SLIDER REAR MOUNT DS	1
8	4JRS0760-06	JK SLIDER REAR MOUNT PS	1
9	4JRS0754-09	FLAG NUT 1/2-13 ZINC PLATE GR5	1
10	2JRS1860-24	SINGLE BACKUP PLATE	4
11	2BRS2021-41	DESTROYER DOUBLE BACKUP PLATE	8
12	2JRS0754-19	BACKING WASHER / SPACER	5
13	2JRS1860-29	MOUNT SHIM PLATE	6

ITEM NO.	PART NUMBER	DESCRIPTION	QTY.
14	TR501316ZP	THREAD ROLLER 1/2-13 X 1.00 HEX ZINC PLATE	4
15	CB381616ZPGR5	CARRIAGE BOLT 3/8-16 X 1.00 ZINC PLATE GR5	20
16	HB12150M45ZPCL88	HEX BOLT M12-1.50 X 45mm ZINC PLATE CL8.8	2
17	HB501328ZPGR5	HEX BOLT 1/2-13 X 1.75 HEX BOLT ZINC PLATE GR5	1
18	HB501364ZPGR5	HEX BOLT 1/2-13 X 4.00 HEX BOLT ZINC PLATE GR5	3
19	HN3816ZPGR5	HEX NUT 3/8-16 ZINC PLATE GR5	20
20	HN5013ZPGR5	HEX NUT 1/2-13 ZINC PLATE GR5	3
21	FW3114ZP	FLAT WASHER Ø5/16" X .875" ZINC PLATE	20
22	FW5022ZP	FLAT WASHER Ø1/2" X 1.375" ZINC PLATE	17

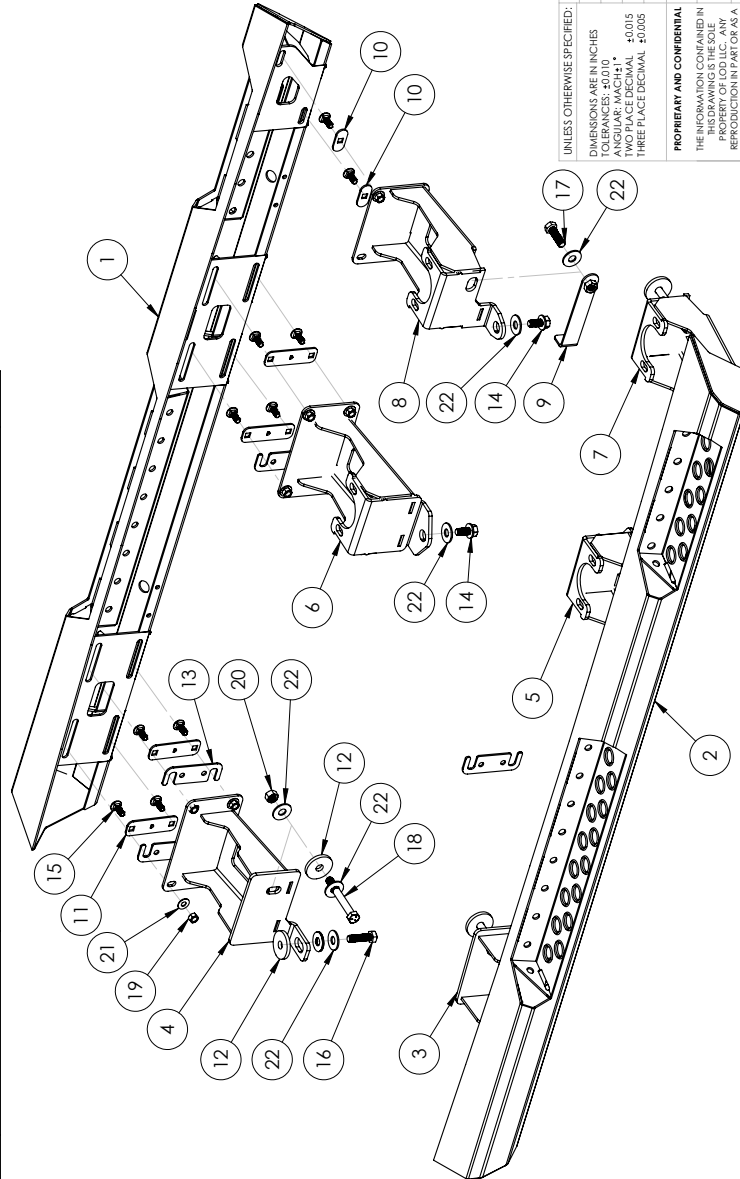

- NOTES:**
- JRS0704 = BARE STEEL OPTION
 - JRS0714 = BLACK POWDER COAT
 - WEIGHT = APPROX 125.38 LBS

UNLESS OTHERWISE SPECIFIED: DIMENSIONS ARE IN INCHES TOLERANCES: ±0.010 FINISH: UNLESS OTHERWISE SPECIFIED TWO PLACE DECIMAL THREE PLACE DECIMAL ±0.005		NAME MCH	DATE 4/6/2022
DRAWN		CHECKED	ENG APPR.
MEG APPR.		MATERIAL: N/A	
FINISH: SEE NOTES		ECCO: 1081	
REPRODUCTION IN PART OR AS A WHOLE WITHOUT THE WRITTEN PERMISSION OF LOD LLC IS PROHIBITED.		PROPERTY OF LOD LLC. ANY REPRODUCTION IN PART OR AS A WHOLE WITHOUT THE WRITTEN PERMISSION OF LOD LLC IS PROHIBITED.	
<p>LOD LLC.</p> <p>DESCRIPTION: JEEP JK 4DR DESTROYER SLIDER</p>		<p>DWG. NO. JRS0704 JRS0714</p> <p>SCALE: 1:8 SHEET SIZE: B</p>	
<p>REV C</p>		<p>SHEET 1 OF 1</p>	



Jk Jeep
DESTROYER SERIES
 JEEP Jk 4DR DESTROYER
 SLIDERS
 SHIPPING SHEET - BOX 1

Packaged by:

On:

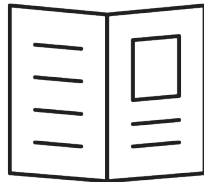

Instruction
Booklet

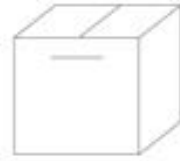

Hardware Kit

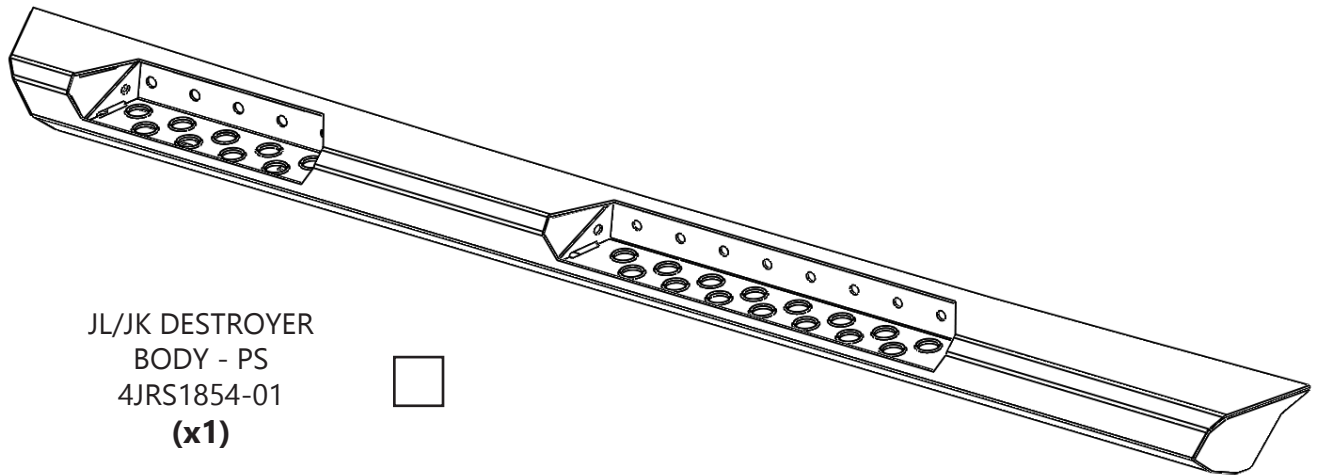

JL/JK DESTROYER
 BODY - PS
 4JRS1854-01
(x1)

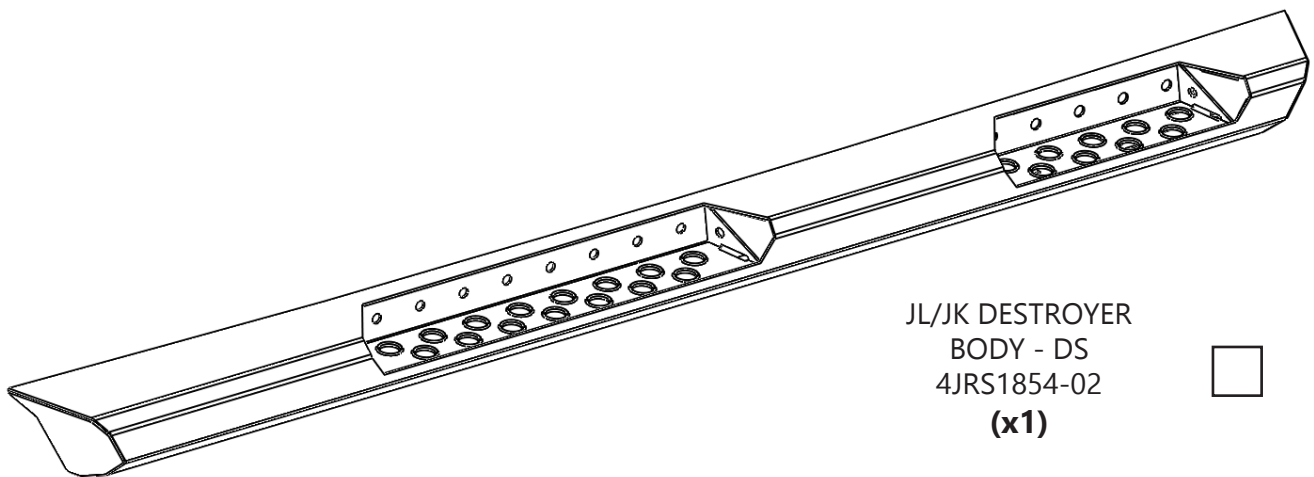

JL/JK DESTROYER
 BODY - DS
 4JRS1854-02
(x1)





JK Jeep
DESTROYER SERIES
 JEEP JK 4DR DESTROYER
 SLIDERS
 SHIPPING SHEET - BOX 2

Packaged by: _____

On: _____

JK SLIDER FRONT MOUNT - PS
 4JRS0760-04

(x1)

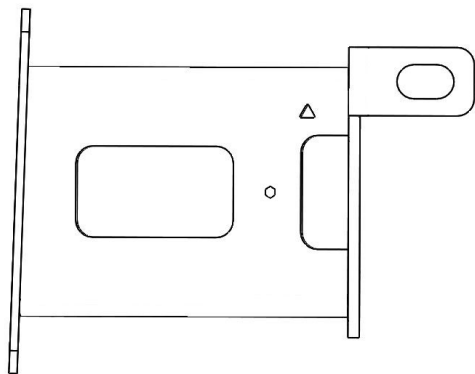

JK SLIDER CENTER MOUNT - PS
 4JRS0760-05

(x1)

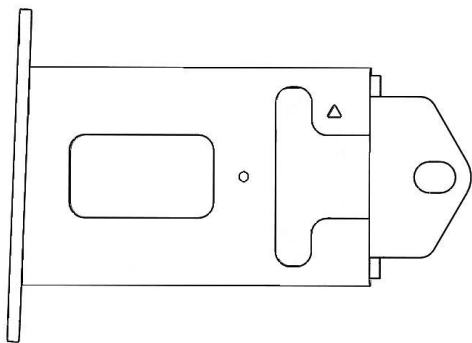

JK SLIDER REAR MOUNT - PS
 4JRS0760-06

(x1)

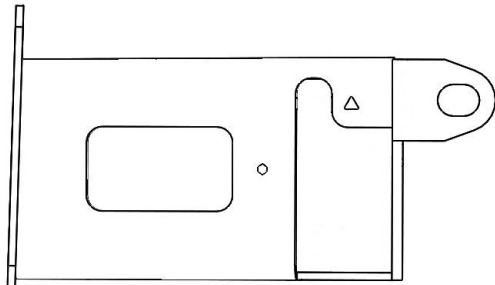

JK SLIDER FRONT MOUNT - DS
 4JRS0760-01

(x1)

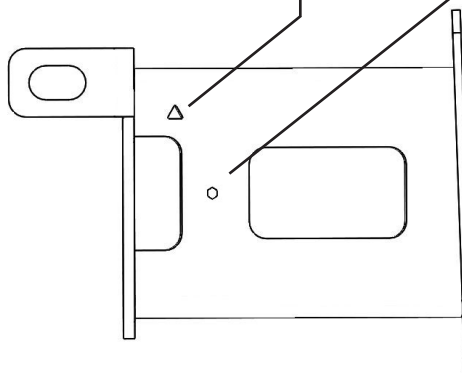

JK SLIDER CENTER MOUNT - DS
 4JRS0760-02

(x1)

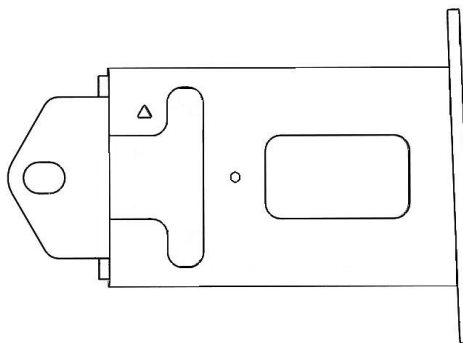

JK SLIDER REAR MOUNT - DS
 4JRS0760-03

(x1)

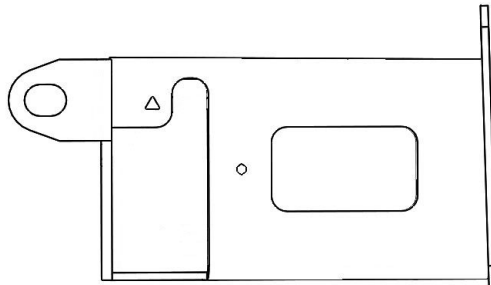

ARROW POINTS TOWARD
 FRONT OF JEEP



JEEP JK INDICATOR



JK Jeep
DESTROYER SERIES
 JEEP JK 4DR DESTROYER
 SLIDERS
 HARDWARE KIT

Packaged by:

On: _____

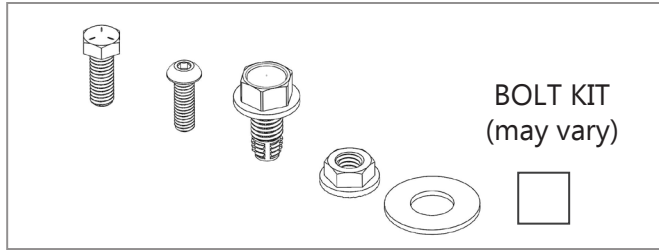

BOLT KIT
 (may vary)

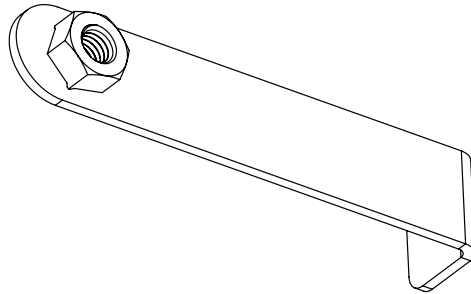

FLAG NUT 1/2-13
 4JRS0754-09
(x1)

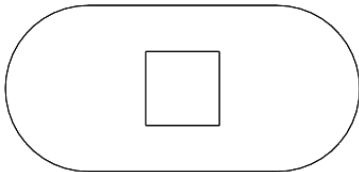
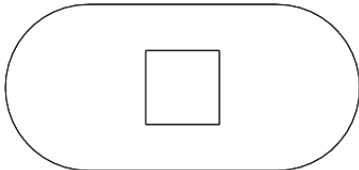
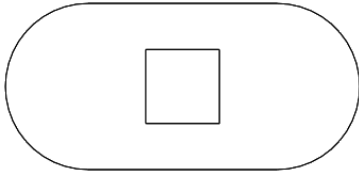
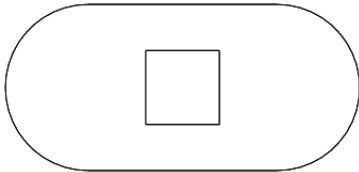

SINGLE BACKUP PLATE
 2JRS1860-24
(x4) 

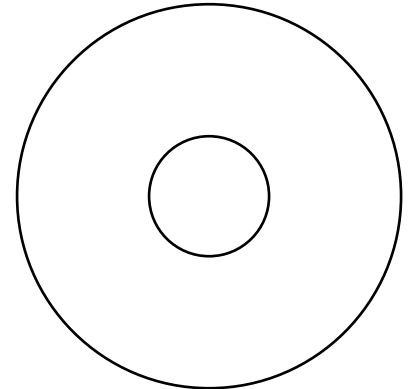
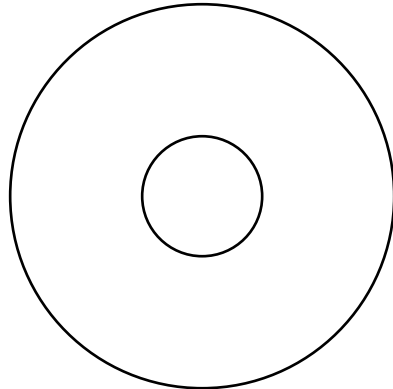
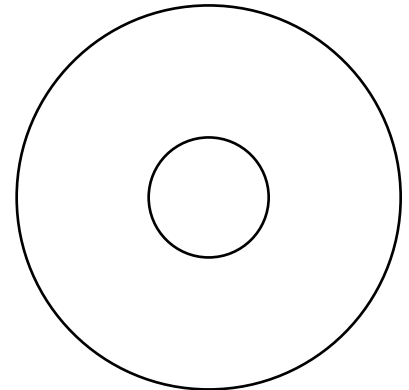
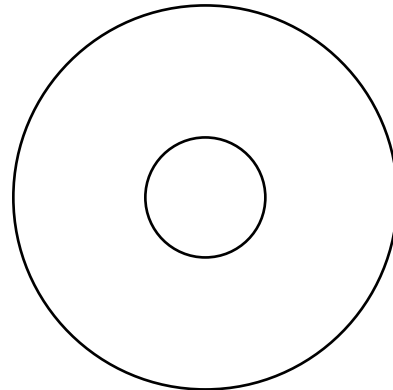

BACKING WASHER
 2JRS0754-19
(x5)

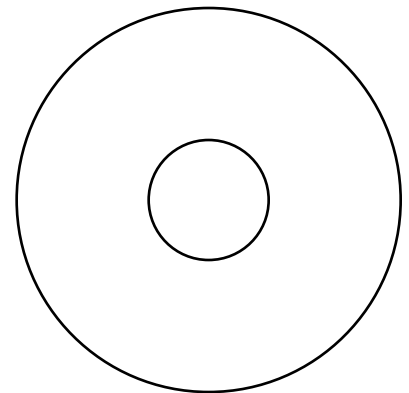

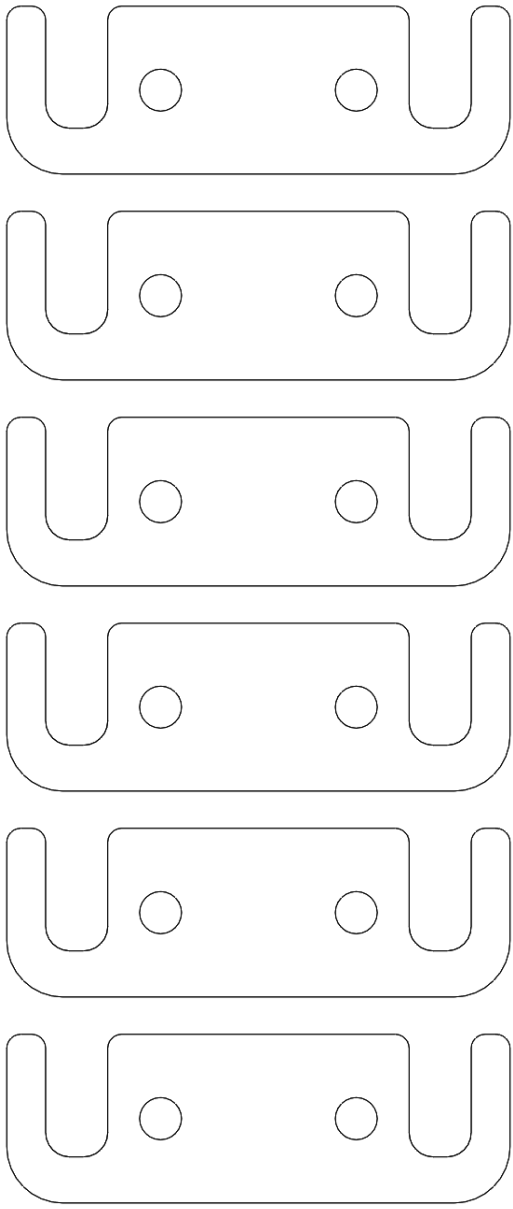

MOUNT SHIM PLATE
2JRS1860-29
(x6)

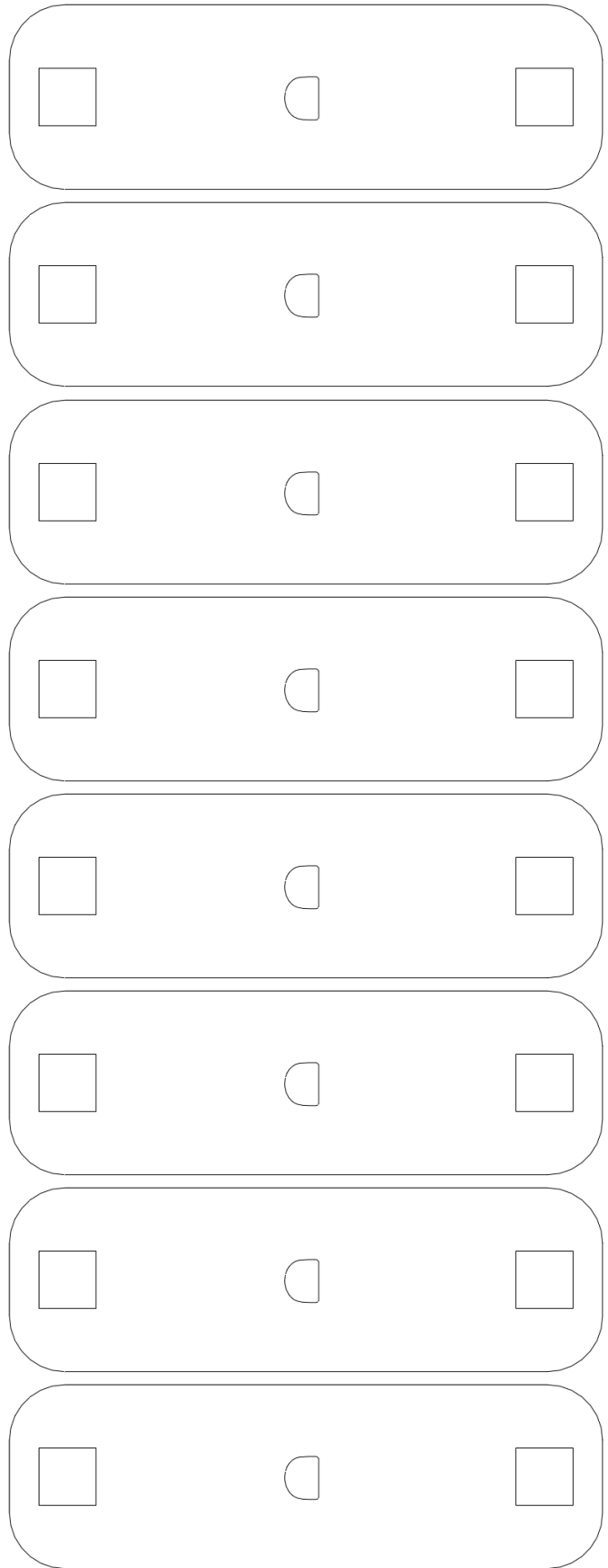

DESTROYER DOUBLE
BACKUP PLATE
2BRS2021-41
(x8)





JK Jeep
DESTROYER SERIES
 JEEP JK 4DR DESTROYER
 SLIDERS
 BOLT KIT

Packaged by:

On:

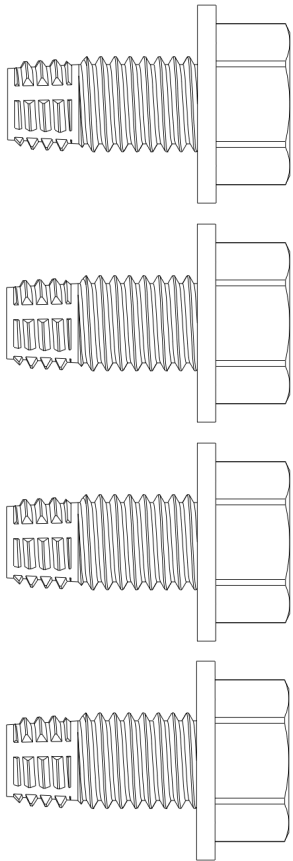

THREAD ROLLER 1/2-13 X 1.00
(x4)

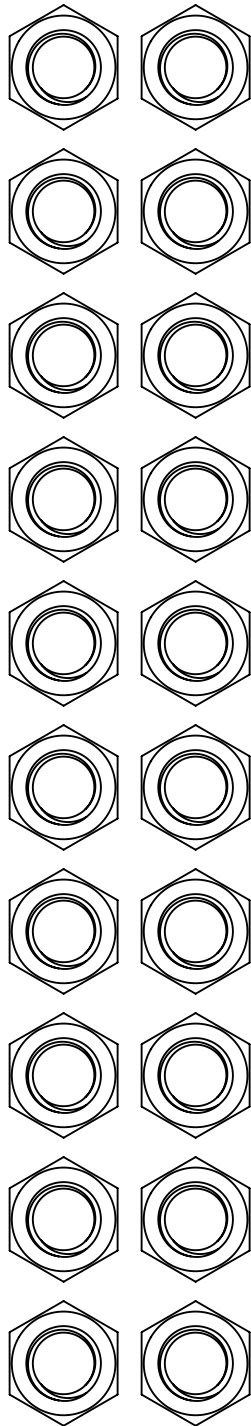

HEX NUT 3/8-16
 1136306
(x20)

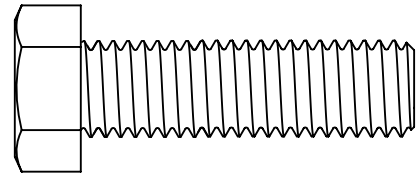

HEX BOLT 1/2-13 X 1.75
 (0137546)
(x1)

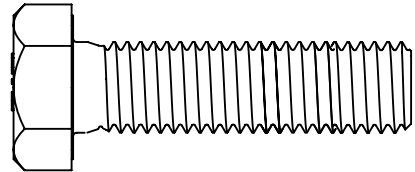
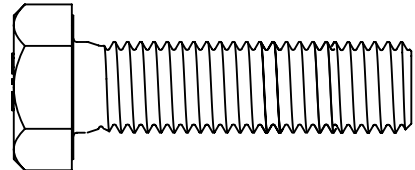

HEX BOLT M12-1.50 X 45MM
 0159743
(x2)

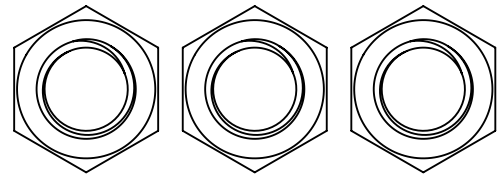

HEX NUT 1/2-13
 1136310
(x3)



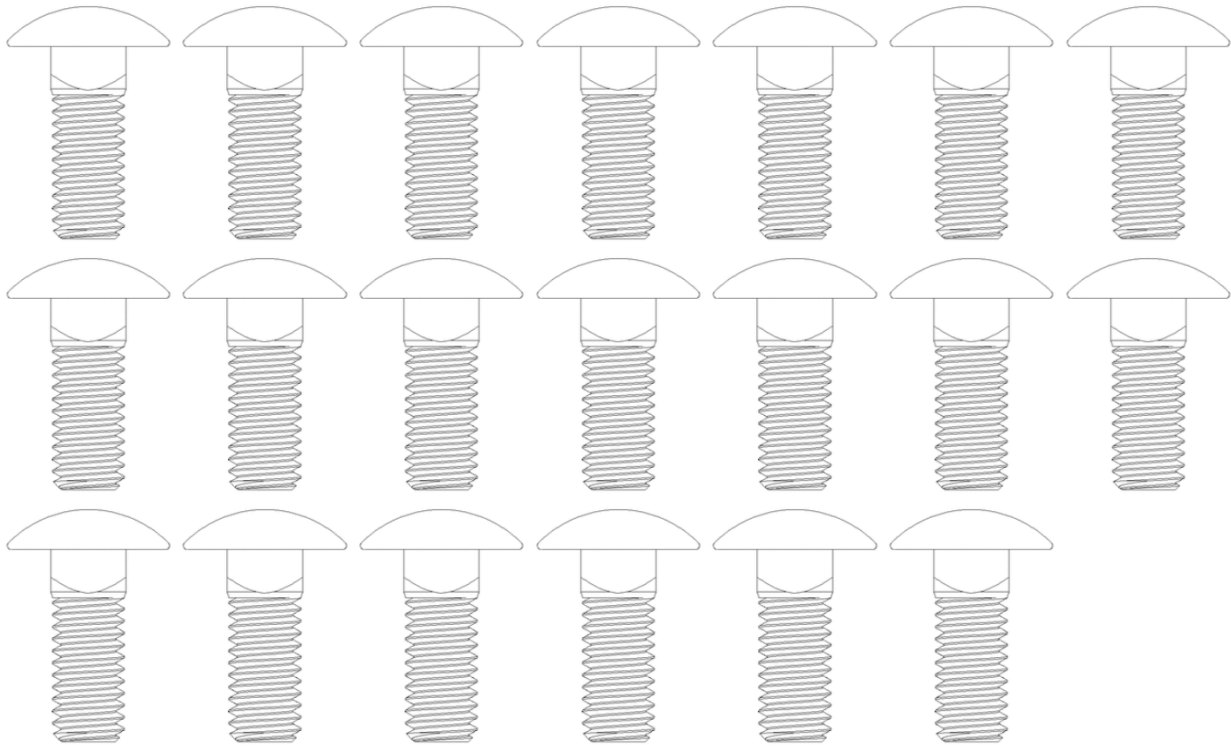

CARRIAGE BOLT 3/8-16 X 1.00
(0155068)
(x20)

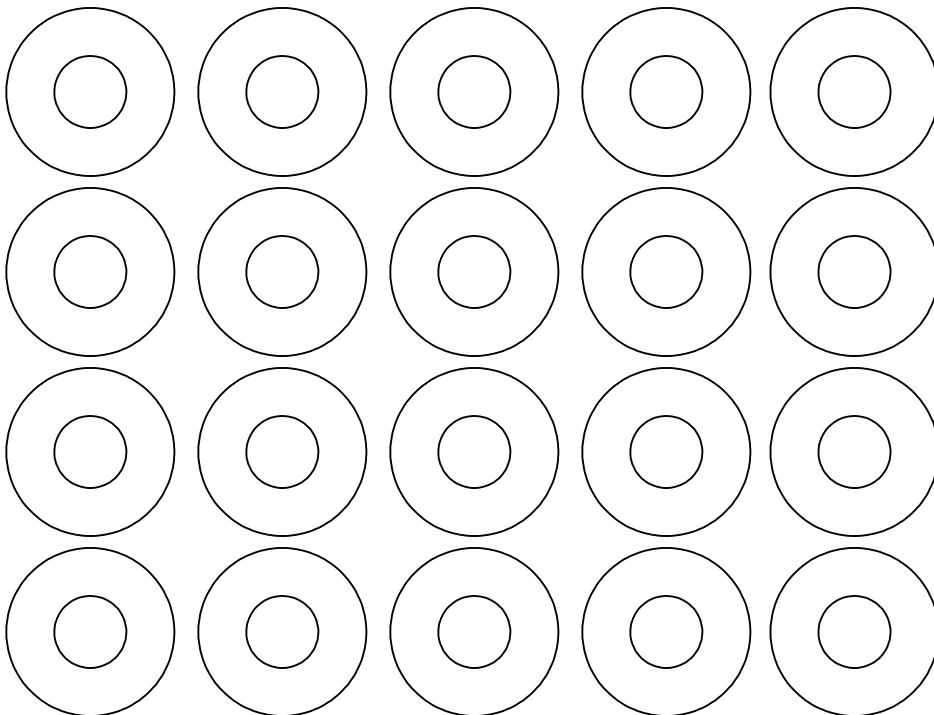

FLAT WASHER
5/16 X .875
1133006
(x20)

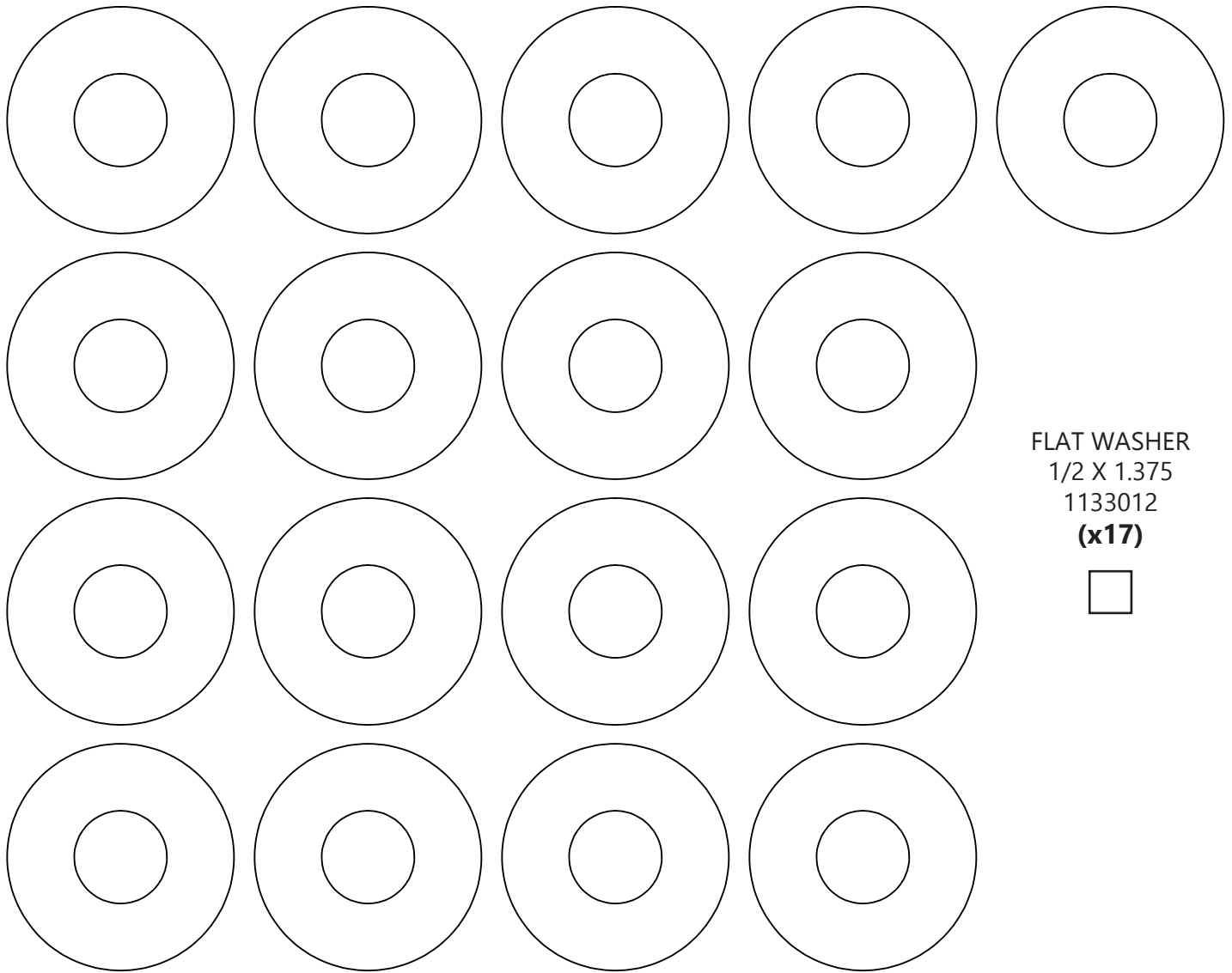

FLAT WASHER
1/2 X 1.375
1133012
(x17)

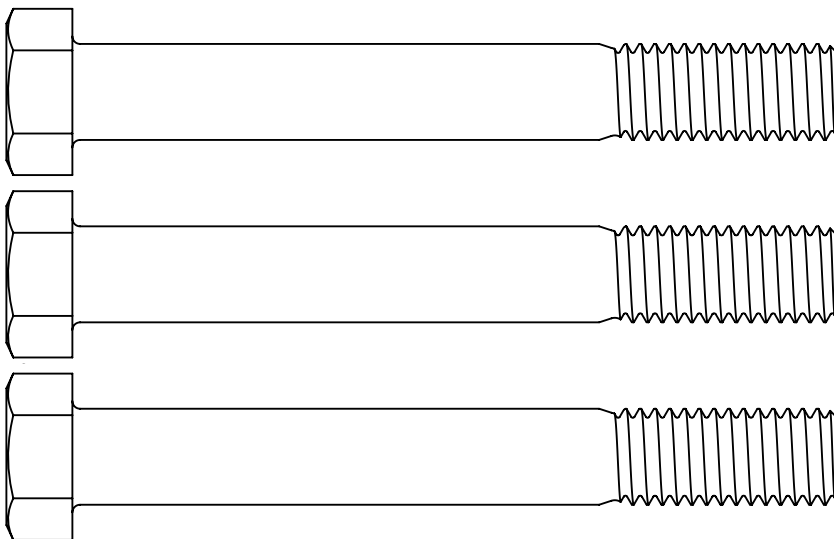

HEX BOLT 1/2-13 X 4.00
110120390
(x3)

