



**GMC SIERRA/CHEVROLET SILVERADO
2500/3500 BASE RAIL BRACKET KIT - 2 PIECE**

Assembly, Installation, Operation,
and Maintenance Instructions

PART NUMBER	33222
INSTALL TIME	90-120 MINUTES

DEALER / INSTALLER	Provide a copy of these instructions to the end user of this product. These instructions provide important operating and safety information for proper usage of this product. Demonstrate the proper use of the product with the end user. Have the end user demonstrate that they understand the proper use of the product.
END USER WARNING	Read and follow all instructions included in this manual. Ask your Dealer/Installer for assistance if you do not understand the proper use of the product. Never remove any decals from the product. Failure to follow these instructions can result in injury or death.

APPLICATION

For use on GMC Sierra 2500/3500 & Chevrolet Silverado 2500/3500

WARNING DO NOT EXCEED Recommended towing limits. SEE VEHICLE'S OWNER'S MANUAL.

Use with 10 bolt 30686 base rails. Base Rails are not included with this kit.

PARTS DIAGRAM Meets SAE J2638 Standard

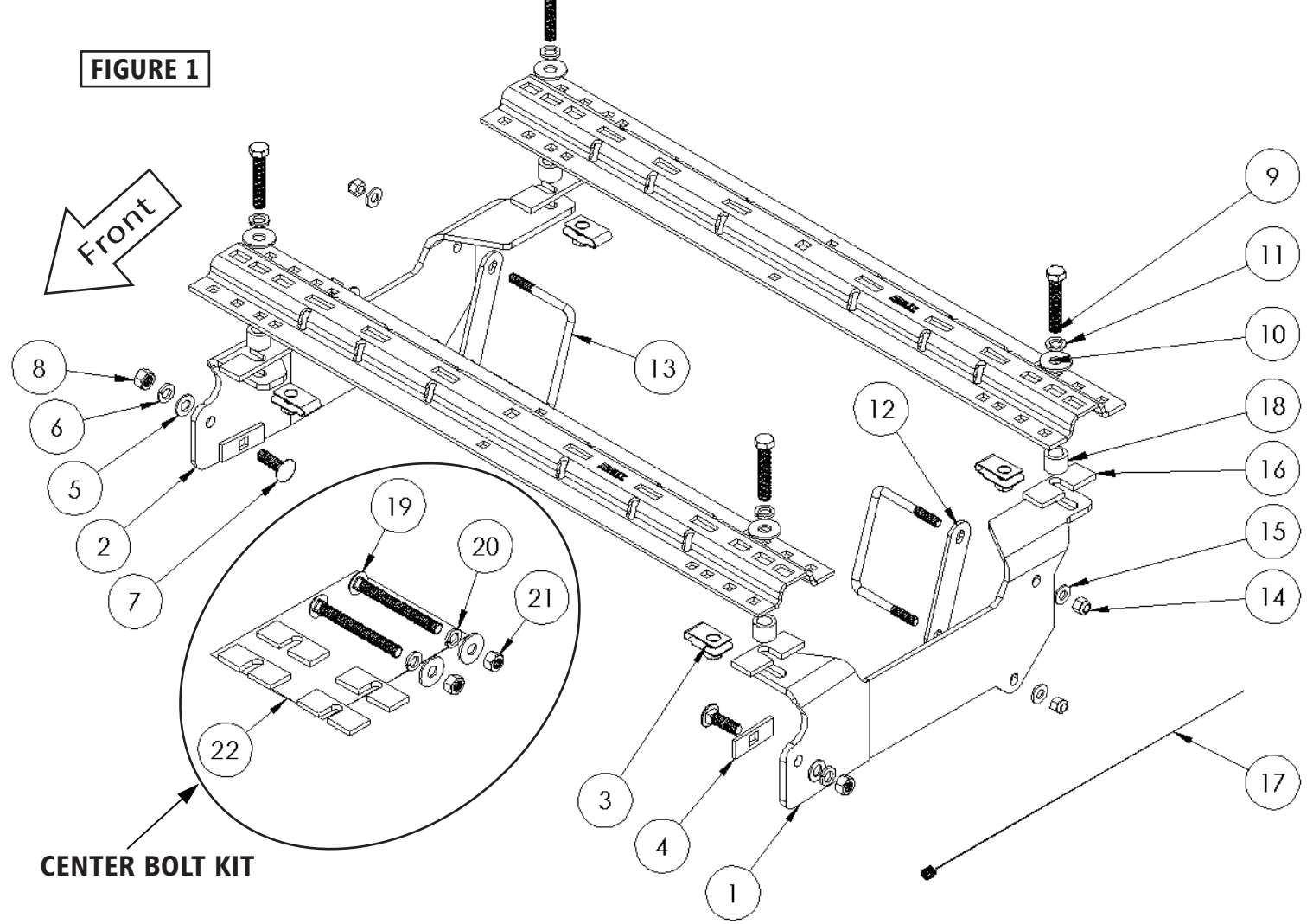

⚠ WARNING ⚠
CHOKING HAZARD

Small Parts. Not for children under 5 years

TOOLS REQUIRED

3/4" WRENCH & SOCKET

15/16" WRENCH & SOCKET

5/8" DRILL BIT

5/8" TRANSFER PUNCH

150 FT. LB. TORQUE WRENCH

SAFETY GLASSES

CONTENTS		33222 GM/CHEVROLET 2500/3500 BASE RAIL BRACKET KIT	31419 BASE RAIL 1/4" SPACER KIT	32254 BASE RAIL SPACER TUBE	33156 CENTER BOLT KIT	32767 CLIP-ON NUT SERVICE KIT
ITEM NO.	DESCRIPTION	QTY	QTY	QTY	QTY	QTY
1	DRIVER SIDE BRACKET	1	-	-	-	-
2	PASSENGER SIDE BRACKET	1	-	-	-	-
3	CLIP-ON NUT	4	-	-	-	4
4	SPACER PLATE FOR 5/8" CARRIAGE BOLT	2	-	-	-	-
5	5/8" FLAT WASHER	2	-	-	-	-
6	5/8" LOCK WASHER	2	-	-	-	-
7	5/8" -11 X 2.25" CARRIAGE HEAD BOLT	2	-	-	-	-
8	5/8" -11 HEX NUT	4	-	-	-	-
9	5/8" -11 X 3.5" HEX HEAD BOLT	4	-	-	-	-
10	5/8" FLAT WASHER (BLACK)	6	-	-	2	-
11	5/8" LOCK WASHER (BLACK)	4	-	-	-	-
12	U-BOLT SPACER	2	-	-	-	-
13	U-BOLT	2	-	-	-	-
14	1/2" -13 NYLOCK NUT	4	-	-	-	-
15	1/2" FLAT WASHER	4	-	-	-	-
16	SPACER PLATE	8	4	-	4	-
17	PULL WIRE	1	-	-	-	-
18	SPACER TUBE	4	-	4	-	-
19	5/8" -11 X 6" CARRIAGE HEAD BOLT	2	-	-	2	-
20	5/8" LOCK WASHER	2	-	-	2	-
21	5/8" -11 NUT	2	-	-	2	-
22	CENTER BOLT KIT INSTRUCTION	1	-	-	1	-

WARNINGS/SAFETY PRECAUTIONS

1. The following instructions should be used to mount the base rail. Care and attention to detail will ensure a quick quality installation. Check parts against parts list to become familiar with parts in kit.
2. Raise rear of truck high enough to allow jack stands to be placed under rear spring hanger bracket of truck. This will provide maximum room to install the fifth wheel brackets.



WARNING: If the truck is raised, be sure that the truck is properly blocked and restrained to prevent the truck from falling. Failure to do so may result in the truck suddenly falling, causing death or serious injury.

3. Do NOT install base rails over plastic bed liners or bed mats. Plastic bed liners must be cut out of the way. Base rails may be installed on dry/cured spray in liner. Note: Consult installer for recommended curing time.
4. Use only the supplied bolts, nuts, and washers to install this kit. All nuts and bolts are Grade 5 unless specified otherwise.



WARNING: These instructions are guidelines only. Actual installation is the responsibility of the installer and the owner. Always measure truck and trailer before installing hitch to be sure that there is clearance at the cab and at the bumper to allow for turns.

5. The rear wheel well liners and the spare tire will need to be removed to access the frame for bracket installation. Removing the rear wheels is not mandatory but can greatly decrease the number of obstacles when performing the installation.
6. In most applications the measurements are given from the rear edge of truck bed to rear edge of the closest base rail.
7. Place the two base rails across the truck bed between the wheel wells. Position the 5th wheel uprights between the base rails so that the tabs in the base of each upright will fit into the slots in the ends of the bed rails. Secure the uprights in place with the rail hitch pins and hair pins supplied with the 5th wheel installation kit. Securely attach 5th wheel cross member to uprights.
8. On most applications, the 5th wheel assembly should be positioned so that it is approximately centered over the truck axle and between the wheel wells on the bed floor. See **Figure 2** on page 4



WARNING: Check for obstructions before drilling. Failure to do so could result in damaged fuel or brake lines, structural members, etc. HUSKY TOWING PRODUCTS does its best to communicate tow vehicle manufacturer changes; however, it is ultimately the responsibility of the installer to prevent damage due to installation.

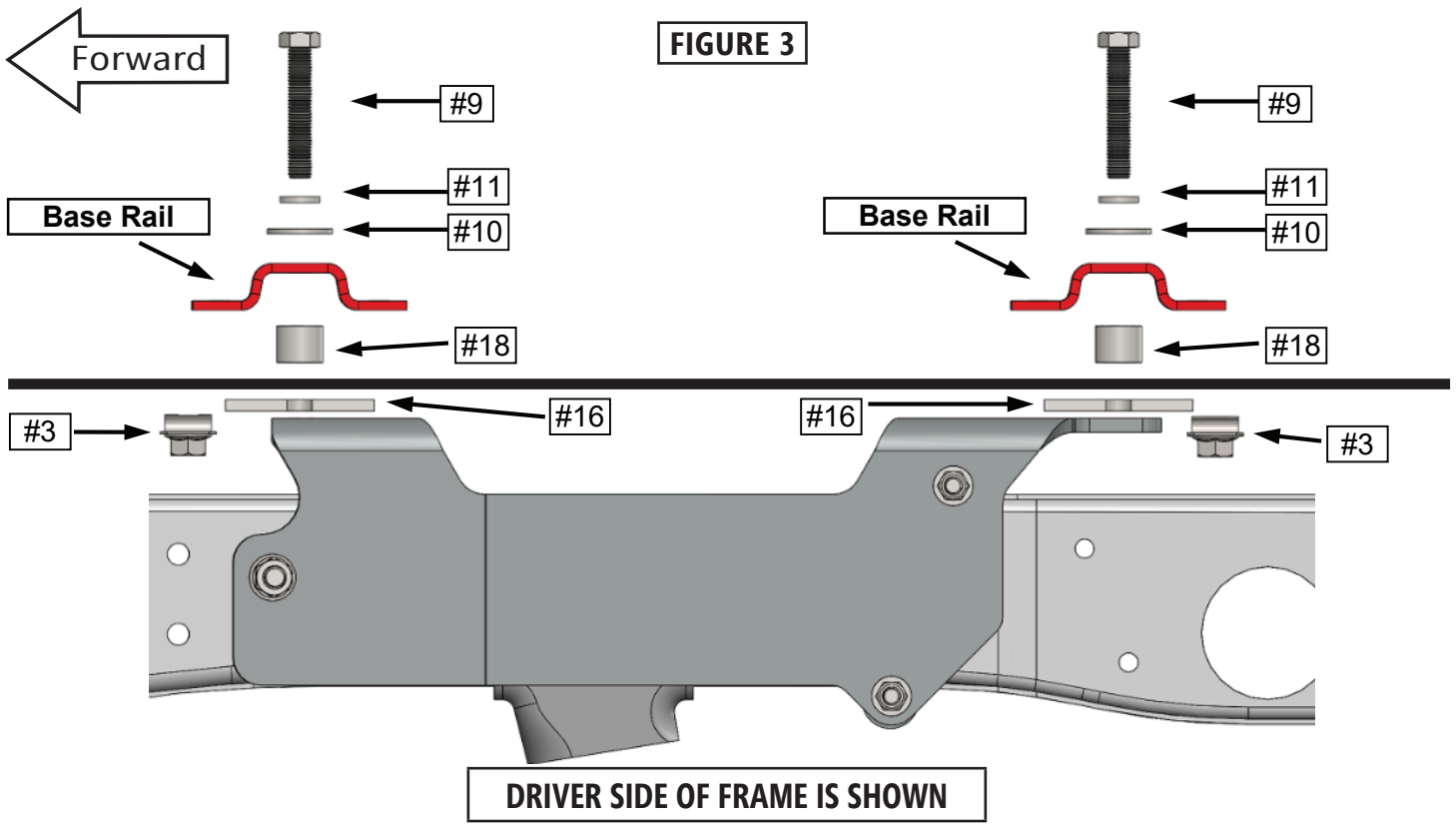
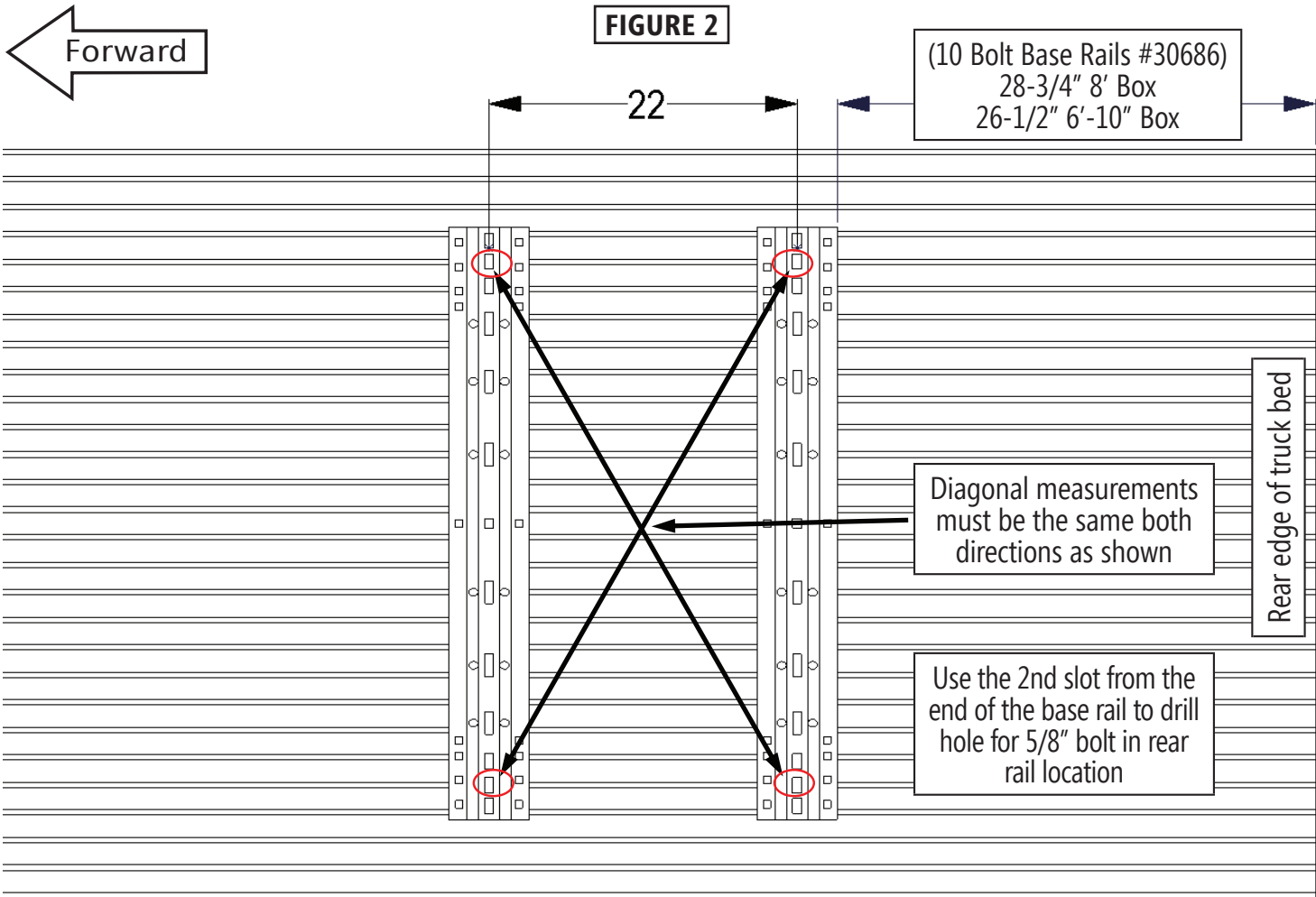

NOTE: To keep the trailer from hitting the cab on tight turns, there must be at least 52" between the center of the hitch and the cab. A roller/glider should be used when installing a fifth wheel with a truck bed shorter than 8'. Consult the Husky Towing Products catalog to select the product that best matches your needs.

9. When the hitch is correctly positioned in the bed and the bed rails are parallel (See **Figure 2** for measurements) mark the four attachment points on the truck bed using the 5/8" rectangular slots towards the ends of each bed rail as a guide. The use of a 5/8" transfer center punch will ensure that the marks are correctly marked on the bed floor. **CHECK BELOW THE BED BEFORE DRILLING HOLES TO ENSURE THAT ALL WIRING, BRAKE LINES OR OTHER OBSTRUCTIONS ARE MOVED OUT OF THE WAY AND WILL NOT BE CONTACTED BY THE DRILL BIT.** Move the hitch assembly out of the way and drill four 5/8" diameter attachment holes down through the bed at the previously marked points.

10. Reposition the bed rails in the bed so that the square 5/8" hole in the end of each rail is lined up over the drilled holes see fig. 2. Place a 1" spacer tube (#18) under ends of each bed rail, in line with the drilled holes as shown in **Figure 4**.

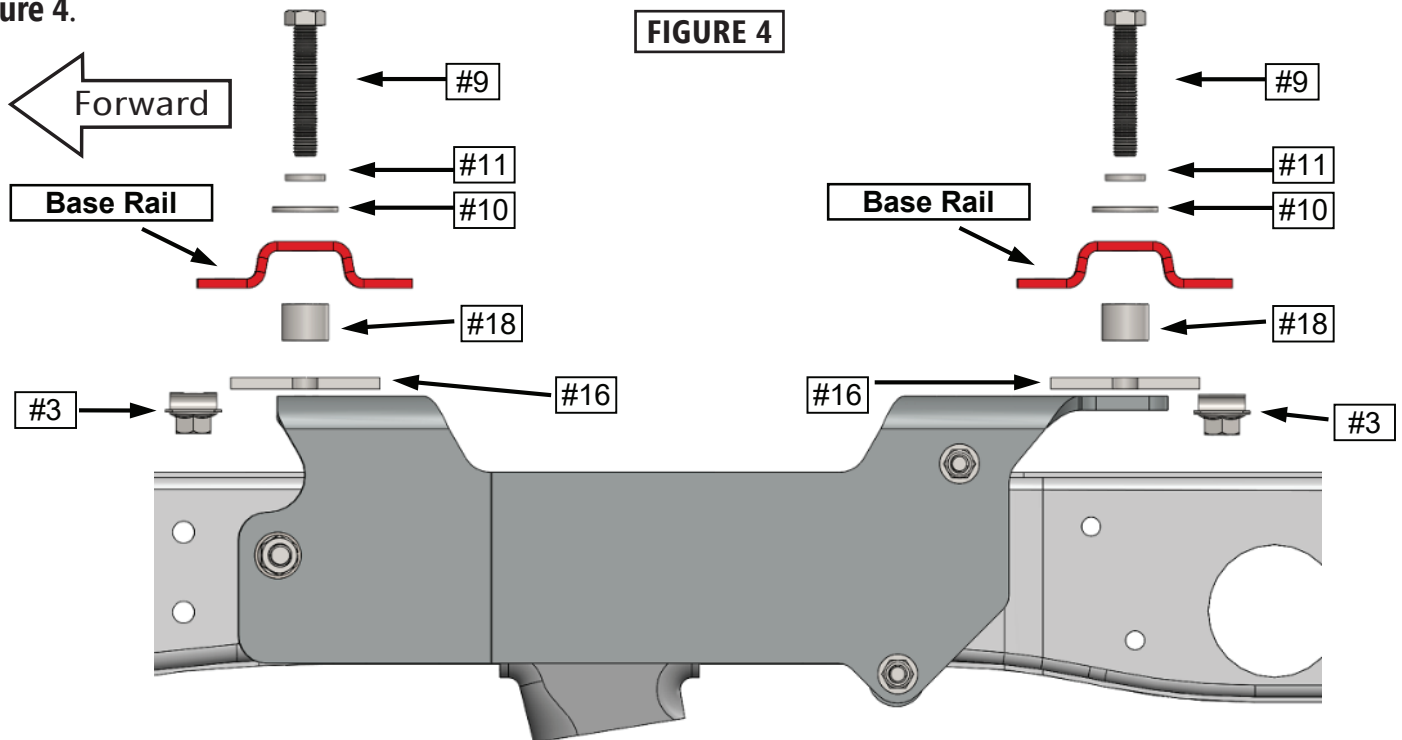

11. If the bed corrugation above the frame bracket is UP, leaving a space above the frame bracket, place a spacer plate (#16) in this location as shown in **Figure 5A**. If the corrugation is DOWN, at this location, place a spacer plate (#16) in the bed, under the base rail as shown in **Figure 5B**.

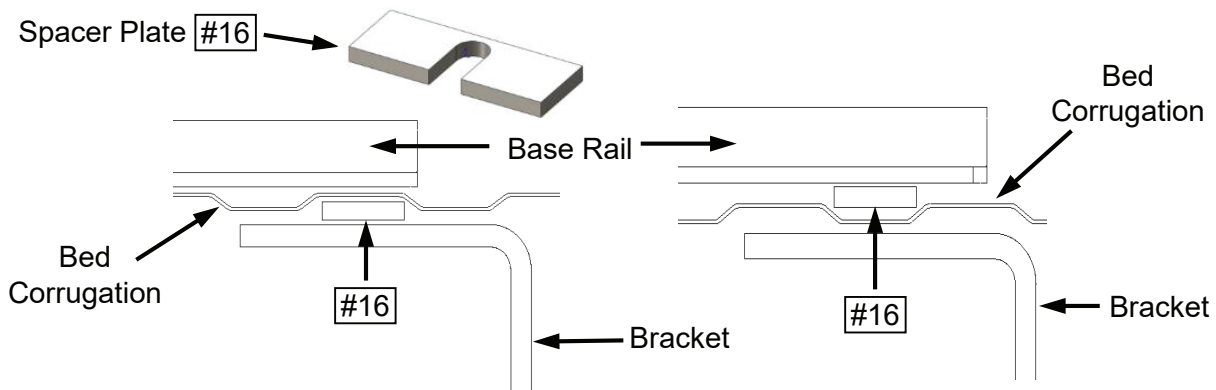
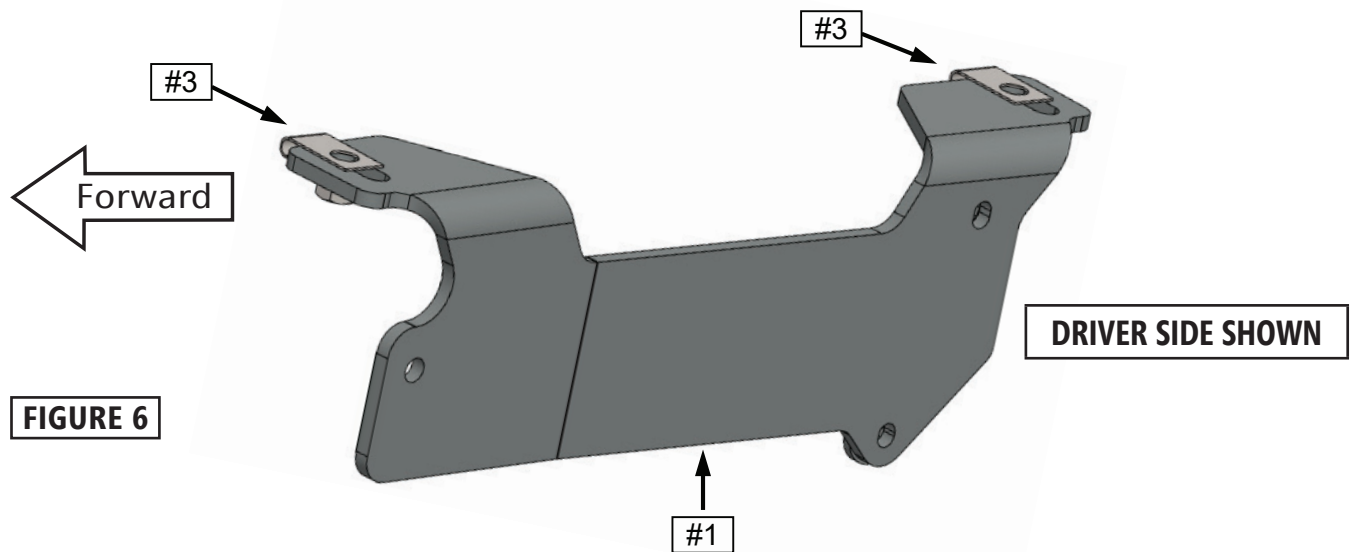

FIGURE 5A Spacer Plate under the bed

FIGURE 5B Spacer Plate over the bed

12. Position the clip-on nuts (#3) on the driver side bracket (#1) as shown. See **Figure 6**.



13. Position the driver side bracket (#1) up against the outer surface of the truck frame with the mounting tabs positioned over the frame and under the bed in-line with previously drilled holes in the truck bed. See **Figure 7**.

14. Install u-bolt (#13) on inside of truck frame; facing outward. See **Figure 7**.

15. Slide spacer plate (#12) over u-bolt (#13) and between the driver side bracket (#1) and the truck frame. See **Figure 7**.

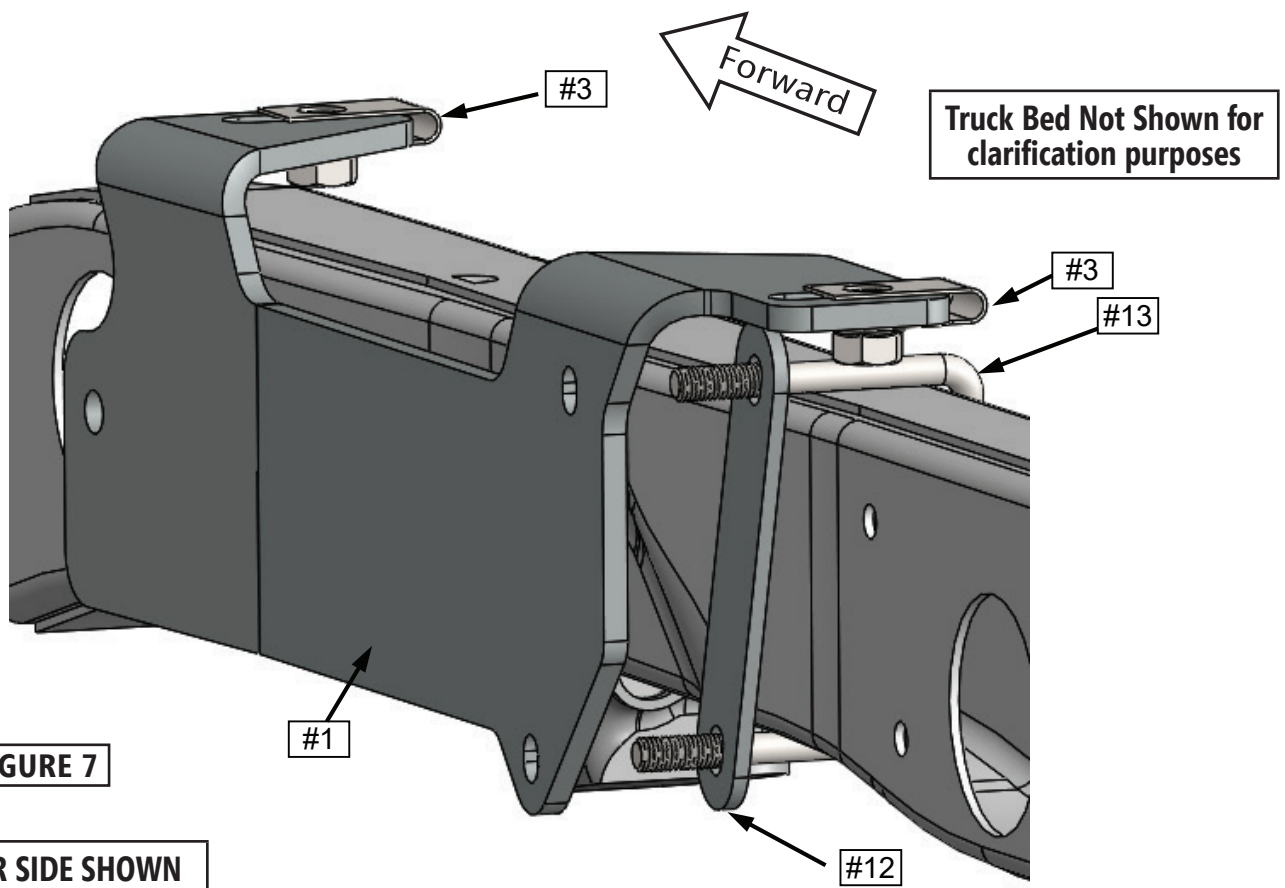

16. Loosely install 1/2" nylock nuts (#14) and 1/2" washer (#15) as shown. See **Figure 8**.

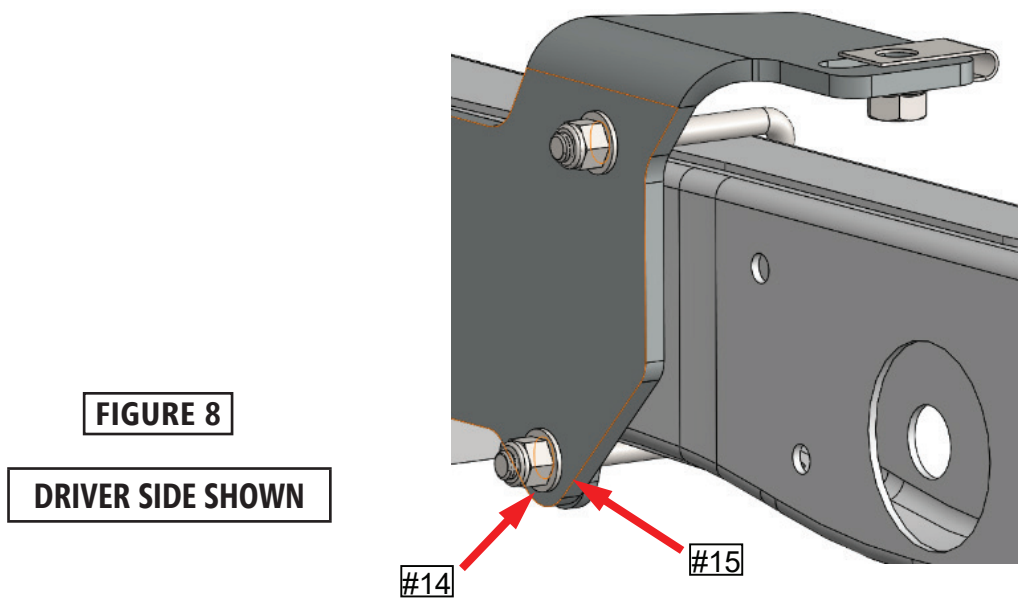

17. Attach pull wire (#17) to 5/8" carriage bolt (#7) and slide 5/8" spacer plate (#4) over pull wire onto carriage bolt. Pull carriage bolt and spacer through the hole on the back side of the truck frame and pull through the front of the driver side bracket. See **Figure 9**.

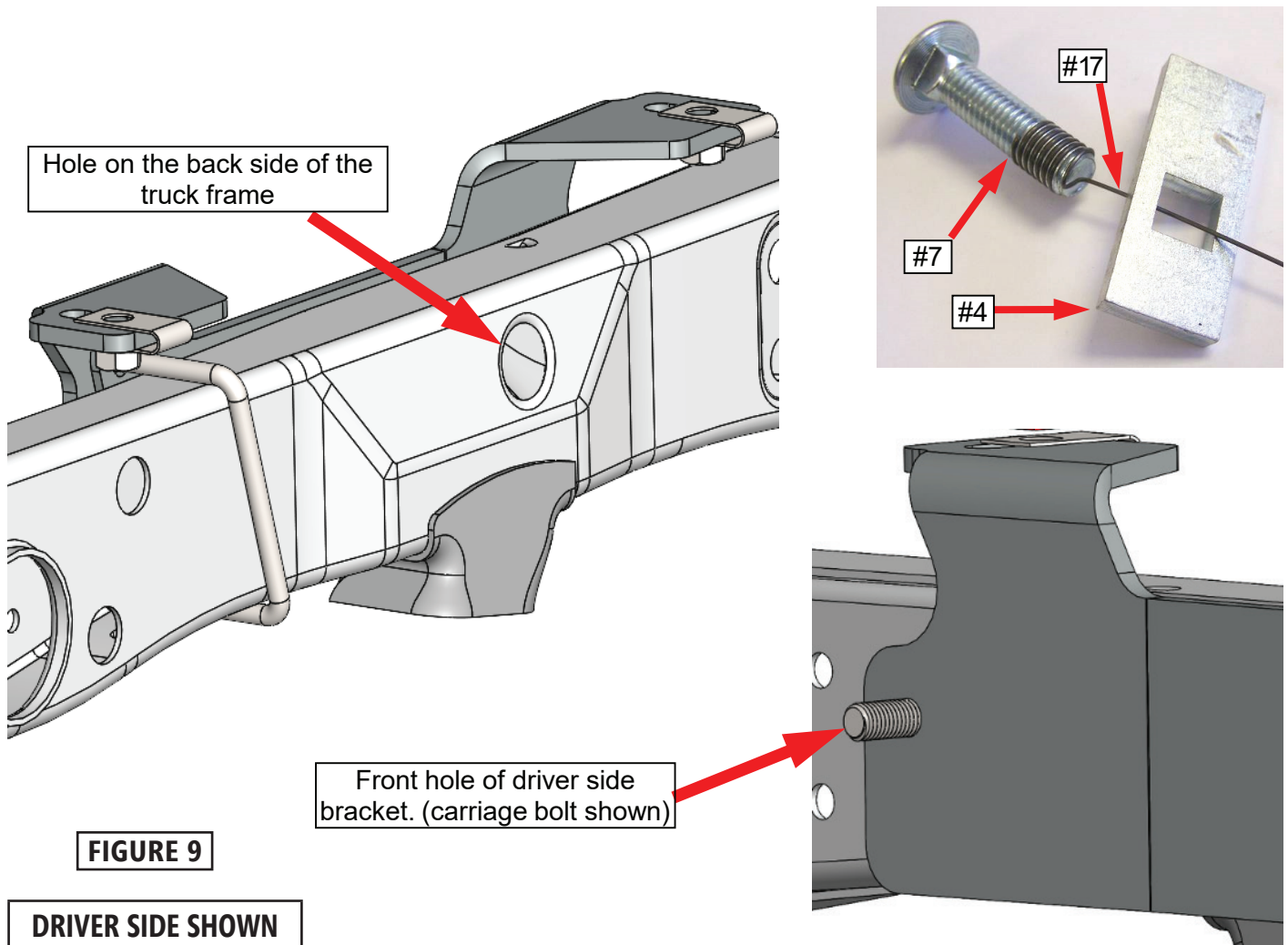

18. Loosely install 5/8" flat washer (#5), 5/8" lock washer (#6) and 5/8" nut (#8) onto 5/8" carriage bolt (#7) as shown. See **Figure 10**.

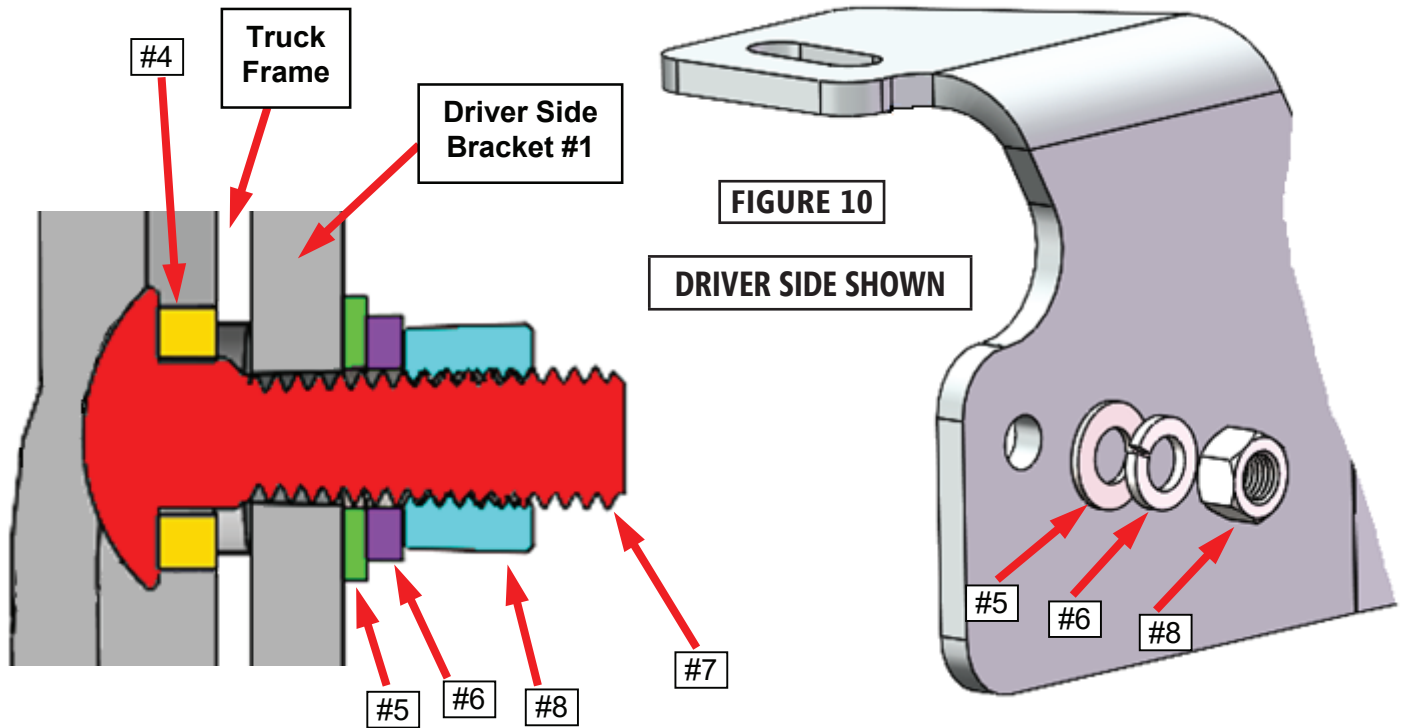

19. Loosely install the 5/8" bolt (#9), 5/8" lock washer (#11) and 5/8" flat washer (#10) through the base rail, the 1" spacer tubes, the spacer plate, the truck bed, the 5/8" holes drilled in the truck bed into the clip nuts (#3). See **Figure 11**.

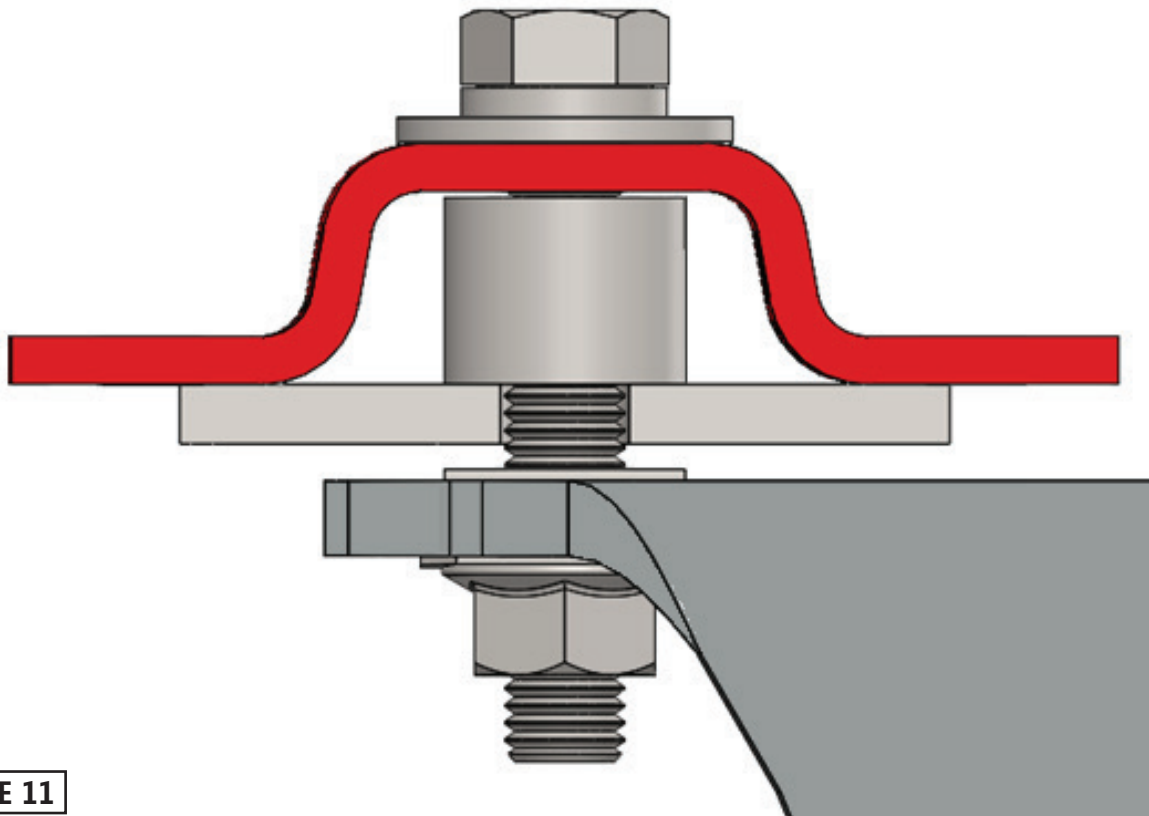

20. Repeat Steps 11 through 19 for the passenger side bracket (#2).

21. Tighten all 1/2" attachment fasteners to 75 ft.-lbs. and the 5/8" fasteners to 150 ft.-lbs. torque. Failure to tighten bolts as described may result in fastener loss or failure.

DO NOT TIGHTEN CLIP-ON NUTS (#3). YOU WILL DAMAGE THE CLIP-ON NUT IF YOU DO. APPLY TORQUE TO THE 5/8" BOLT INSTEAD.

22. Install center bolt kit as directed in center bolt instructions (#22).

23. Check each rail hitch pin for freedom of movement in the bed rail connection. Adjust uprights, if necessary, by placing shim between the upright and the cross member to obtain free pin movement. See **Figure 12**.

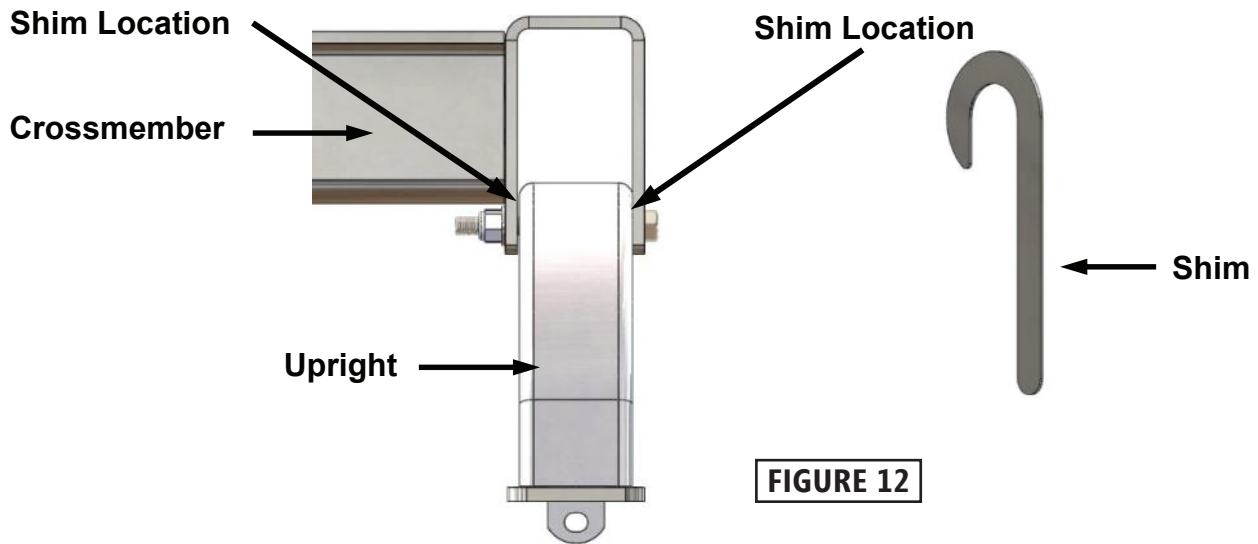

24. Re-install the rear wheel well liner, the rear spare tire, and any removed wheels. You have completed the installation of your bracket kit.

MAINTENANCE

1. Inspect the hitch and installation kit each time before connecting a trailer, check to ensure all fasteners are tight and there are no cracks or excessive wear.
2. Check hardware for correct torque after first 100 miles, and annually thereafter.

FAQS

PROBLEM	WHAT TO LOOK FOR	SOLUTION
Hitch is difficult to install and remove from the base rails	Hitch is not assembled correctly.	Refer to Hitch Assembly section for proper assembly instructions.
	Base Rails are not parallel with each other.	Use spacer or 5th wheel uprights to hold both base rails parallel while loosening and retightening the carriage bolts.
	Truck bed collapsing around carriage bolts in base rails.	Install proper spacers between the base rail and corrugations. Refer to installation instructions for specific directions.

WARRANTY

TECH & WARRANTY SUPPORT:

PHONE: 877-544-4449

EMAIL: warranty@lkqspg.com

FAX: 855-485-1195

WARRANTY TERMS

5 Year Limited Warranty:

Husky Towing Products and Keystone Automotive Operations Inc. make no guarantees or warranties for products not manufactured by Keystone Automotive Operations Inc. Such products are covered solely under any applicable warranty of the manufacturer. It is always recommended that the operating instructions and warranty instructions provided by the manufacturer are followed.

Keystone Automotive Operations Inc. warrants its products to be free from manufacturing and material defects to the original purchaser for the length of warranty stated above from the date of retail purchase. If any products are found to have a manufacturing or material defect, the product will be replaced or repaired at the option of Husky Towing Products and Keystone Automotive Operations Inc. with proof of purchase by the original purchaser. The original purchaser shall pay all transportation and shipping costs associated with the return of the defective product and the defective product shall become the property of Keystone Automotive Operations Inc.

The Warranty applies to Keystone Automotive Operations Inc. products used for individual and recreational purposes. Commercial usage of the Keystone Automotive Operations Inc. products limits the warranty to 90-days from date of purchase.

The Warranty applies only to Keystone Automotive Operations Inc. products which are found to be defective in manufacturing or material. This warranty does not apply to normal wear and tear of the finish placed on Keystone Automotive Operations Inc. products.

Husky Towing Products and Keystone Automotive Operations Inc. are not responsible for any labor costs incurred for removal or replacement of the defective product.

Husky Towing Products and Keystone Automotive Operations Inc. are not responsible for repair or replacement of any product under the limited warranty where the product was improperly installed, misapplied, altered, abused, neglected, overloaded, misused or damaged as a result of an accident, including any use of the product not in accordance with all product operating and safety instructions.

Without limiting the generality of the foregoing, Husky Towing Products and Keystone Automotive Operations Inc. shall under no circumstances be liable for any incidental or consequential loss or damage whatsoever arising out of, or in any way relating to any such breach of warranty or claimed defect in, or non-performance of the products. Some states do not allow the exclusion or limitation of incidental or consequential damages, so the above exclusion or limitation may not apply to you.

This limited warranty gives you specific legal rights, and you may also have other rights that vary from state to state.