

CRAWLTEK R E V O L U T I O N

491 W. GARFIELD AVE., COLDWATER, MI 49036 • 517.278.1039
CRAWLTEKREVOLUTION.COM • E-MAIL: SALES-CRAWLTEK@RIDEFOX.COM

INSTALLATION INSTRUCTIONS

PYRO FRONT BUMPER

JK10101 - STUBBY
JK10201 - MIDWIDTH
JK10301 - FULLWIDTH

FOR USE WITH ALL
JK AND JKU MODELS FROM 2007-2018

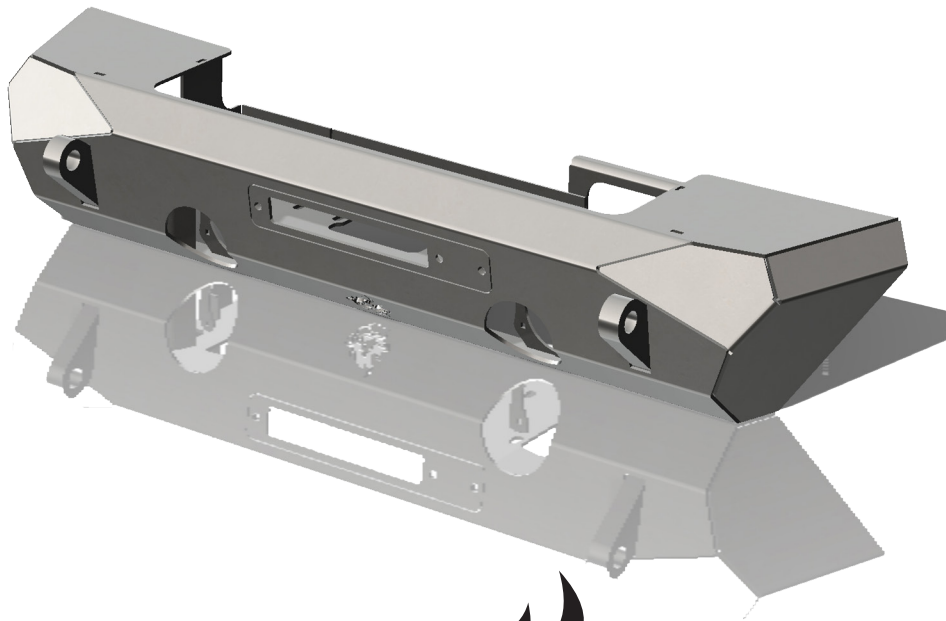

CrawlTek YouTube

PLEASE READ THROUGH INSTRUCTIONS BEFORE INSTALLING

2023-02-07

WHAT'S IN THE BOX?

PLEASE VERIFY KIT CONTENTS BEFORE BEGINNING INSTALLATION

PART #	Qty	DESCRIPTION
06032/06033/06034	1	BUMPER - JK FRONT - PYRO
06030	1	JK PYRO FRONT BUMPER NUTSTRIP - YELLOW ZINC
06031	1	JK PYRO FRONT BUMPER FAIRLEAD MOUNT
CWLU30010	1	DECAL: CRAWLTEK GEARSHIFT 3.5" X 3.5"
CWLU30020	1	DECAL: CRAWLTEK EYES 6" X 2"
CWLU30030	1	DECAL: CRAWLTEK JAX 3.75" X 2.8"
	8	7/16"-14 X 1" GRADE 8 YELLOW ZINC HEX CAP SCREW
	8	7/16" X 0.922" YELLOW ZINC STEEL SAE FLAT WASHER
	8	7/16"-14 ZINC SERRATED FLANGE NUT
	1	3/8"-16 X 1-1/4" GRADE 5 ZINC FINISH HEX CAP
	2	3/8"-16 X 3/4" STAINLESS STEEL BUTTON SOCKET CAP SCREW
	1	3/8" X 0.812" YELLOW ZINC STEEL SAE FLAT WASHER
	2	3/8"-16 ZINC SERRATED FLANGE NUT
	1	M6-1.0 X 50MM CLASS 10.9 YELLOW ZINC FINISH HEX CAP SCREW
	1	M6 X 12MM OD YELLOW ZINC GENERAL PURPOSE FLAT WASHER
	1	M6-1.0 FREE SPINNING WASHER NUT 19MM OD YELLOW ZINC
	8	NYLON NUT #6 SCREW SIZE .060-.150 RANGE

TOOLS REQUIRED

SAFETY GLASSES

18MM SOCKET OR WRENCH

10MM SOCKET OR WRENCH

11/16" SOCKET OR WRENCH

5/8" SOCKET OR WRENCH

7/16" SOCKET

7/32" ALLEN HEAD SOCKET

FLAT HEAD SCREWDRIVER

SMALL HAMMER

CLIP TOOL



PRE-INSTALLATION NOTES

1. 2012 OR NEWER MODELS WILL NEED TO RELOCATE THE VACUUM PUMP.
2. IF INSTALLING A LARGE BODIED WINCH ADDITIONAL CUTTING MAY BE REQUIRED TO THE TOP OF THE FRAME HORNS.

FACTORY FRONT BUMPER REMOVAL

STEP 1:

REMOVE 2 CLIPS HOLDING TRIM PIECE ON. (FIG. 1)

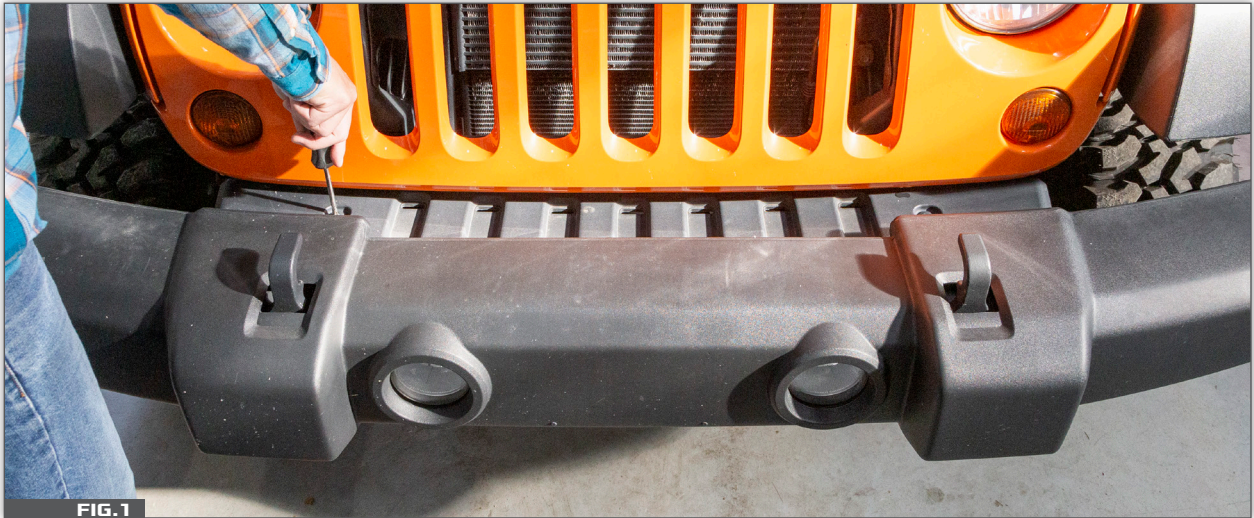

FIG. 1

STEP 2:

REMOVE LOWER BUMPER VALANCE. (FIG. 2)

IF EQUIPPED, REMOVE 6 SPLASH GUARD SCREW RETAINERS. (FIG. 3)



FIG. 2



FIG. 3



STEP 3:

REMOVE FACTORY (8) BUMPER BOLTS. **(FIG. 4)**



STEP 4:

REMOVE FACTORY BUMPER FROM FRAME HORNS.

STEP 5:

DISCONNECT FACTORY FOG LIGHTS. **(FIG. 5)**



STEP 6:

REMOVE FACTORY FOG LIGHTS FROM FACTORY BUMPER, KEEP (8) FACTORY SCREWS.



ASSEMBLING THE PYRO FRONT BUMPER

STEP 7:

INSTALL (8) NYLON NUTS INTO BUMPER FOG LIGHT MOUNTING BRACKETS. (FIG. 6)



STEP 8:

INSTALL FACTORY FOG LIGHTS REUSING (8) FACTORY SCREWS. (FIG. 7)

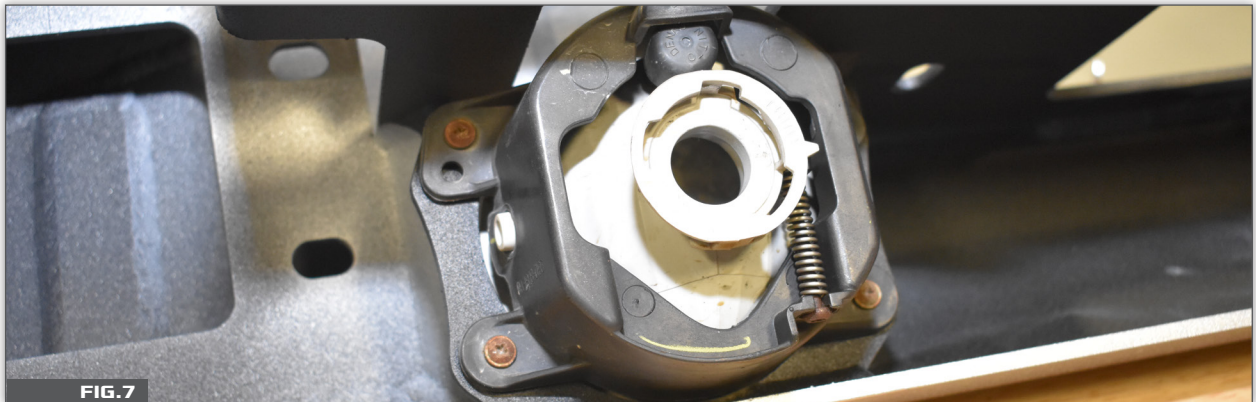

STEP 9 (OPTIONAL):

REMOVE VACUUM PUMP, IF YOUR VEHICLE HAS STUDS HOLDING THE VACUUM PUMP IN PLACE YOU WILL NEED TO REMOVE THE FRONT STUD. EITHER BY CUTTING THE STUD FLUSH OR SIMPLY BREAKING IT OFF WITH PLIERS.

STEP 10 (OPTIONAL):

ROTATE AND REORIENT VACUUM PUMP AS PICTURED. (FIG. 8)



STEP 8 NOTE:
REMOVE FRONT MOUNTING
STUD FOR VACUUM PUMP



STEP 11 (OPTIONAL):

INSTALL WINCH ON TO BUMPER ASSEMBLY WITH BOLTS SUPPLIED FROM WINCH MANUFACTURER.

INSTALLATION OF THE PYRO FRONT BUMPER

STEP 12:

RECONNECT FOG LIGHT HARNESSSES AND SET BUMPER ONTO FRAME RAILS. USING A SLIGHT UPWARD ANGLE TILT THE BACK OF THE BUMPER BACK AND OVER THE FRAME HORNS. IF YOU ARE INSTALLING A WINCH YOU MAY NEED A HELPER, AS THE WINCH AND BUMPER ASSEMBLY ARE HEAVY.

STEP 13:

ATTACH VACUUM PUMP TO BUMPER ASSEMBLY WITH SUPPLIED M6 HARDWARE.

STEP 14:

LIFT ONE SIDE OF THE BUMPER AT A TIME INTO POSITION AND INSTALL A 7/16" BOLT AND WASHER FROM THE REAR OF THE BUMPER THROUGH THE FRAME HORNS AND INTO THE BUMPER. ATTACH 7/16" SERRATED FLANGE NUT TO BOLT AND TIGHTEN.

STEP 15:

INSTALL 3/8 NUT STRIP INTO PASSENGER POCKET INSIDE FRAME RAIL AND ATTACH BOLT THROUGH BUMPER INTO FRAME NUT STRIP LOCATED BELOW THE WINCH PLATE. (FIG. 9, FIG. 10)



STEP 14 NOTE:
FOR EASE OF NUT STRIP AND BOLT INSTALL, 2 PEOPLE MAY BE REQUIRED DUE TO LACK OF VISIBILITY



STEP 16:

INSTALL THE REVERSIBLE FAIRLEAD BRACKET WITH THE 3/8 BUTTON HEAD AND FLANGE NUT. IF YOU INSTALLED A WINCH, INSTALL YOUR FAIRLEAD USING THE SUPPLIED HARDWARE. **(FIG. 11)**



FIG. 11



YOU'RE NOT DONE YET!

Thank you for your new CrawlTek Revolution purchase! Follow us on facebook for up to date coverage of new product releases. We love feedback, if you have any questions about the installation or parts were missing please contact us at sales-crawltek@ridefox.com or call us at 517.278.1039.

Be sure to show off your jeep to the rest of the CrawlTek Revolution online. Find us on facebook and instagram to keep up on new products, upcoming events and more action. Tag us @crawltek for a chance to get featured

