



**Alumilite Steps**  
**part# 840121412944**

**DIRECTIONS FOR INSTALLATION & USE**  
**2009-2018 Dodge Ram 1500**  
**&**  
**2010-2021 Dodge Ram HD 2500/3500**  
**Crew Cab (4-door)**

*For technical support,*  
call **1-800-626-8746** or email **sales@icionline.com**  
visit **icionline.com** to download instructions



**ATTN:** STATE OF CALIFORNIA CONSUMERS  
**WARNING:** CANCER AND REPRODUCTIVE HARM  
-WWW.P65WARNINGS.CA.GOV



**WARNING:** FAILURE TO COMPLY WITH INSTALLATION,  
SAFETY, AND PRODUCT USE INSTRUCTIONS MAY RESULT IN  
SERIOUS BODILY INJURY OR DEATH.

### **IMPORTANT NOTES**

The contents of this installation and operation manual should be read and comprehended before initializing the installment of the above listed product. This will help minimize risk to injury through the installation process and through the operation of the product.

### **TABLE OF CONTENTS**











1. SAFETY, WARNINGS, AND OPERATION .....	02
2. PARTS AND TOOLS REQUIRED .....	03
4. REFERENCE DIAGRAM .....	04-06
5. ICI STEP INSTALLATION .....	07-10
6. SOCIAL MEDIA REFERENCE .....	11



## SAFETY, WARNINGS, AND OPERATION

- Please ensure that the installer and end-user of this product have familiarized themselves with the contents in this manual. This manual provides important information about the possible safety and operation risks that are involved with the usage of this product.
- Our number one concern is the safety of our customers. This product is intended to be installed by a professional to minimize risk of an improper installation. Improper installations can lead to product damage, vehicle damage, and bodily injury. We ask that you reach out for professional assistance if this installation is beyond your capabilities.
- Please ensure to safeguard this installation and operation manual to reference in the future or to pass on to a future owner of the product.
- Please follow all instructions and take all safety precautions necessary throughout the entirety of the installation process.

## PARTS AND TOOLS REQUIRED

SYMBOL	DESCRIPTION	TOOL	DESCRIPTION
	HAZARDOUS WARNING		RATCHET/SOCKET WRENCH
	WARNING: SHARP ELEMENTS		SOCKETS : 13mm
	WARNING: CRUSHING OF HANDS		13mm
	WARNING: HOT SURFACE		(Allen wrench included)
	MANDATORY: WEAR EYE PROTECTION		EYE PROTECTION

## PARTS AND TOOLS REQUIRED

### Hardware Kit includes:

- (1). Qty x 18 = M8 x 30mm Hex Head Bolts**
- (2). Qty x 12 = M8 Lock Washers**
- (3). Qty x 42 = M8 x 24 x 2mm Flat Washers**
- (4). Qty x 18 = M8 x 35mm Hex Head Countersunk Bolts**
- (5). Qty x 18 = M8 Finish Washers**
- (6). Qty X 24 = M8 Nylock Nuts**
- (7). Qty x 12 = M6 x 25mm Hex Head Bolts**
- (8). Qty x 24 = M6 x 22 x 2mm Flat Washers**
- (9). Qty x 12 = M6 Nylock Nuts**
- (10). Qty x 6 = Double Nutsert Tab (100539)**

### Components List:

- (a). Side Bars - Qty x 2 - Driver and Passenger**
- (b). Front Brackets - Qty x 2 - (100536)  
1 Driver / 1 Passenger**
- (c). Front-Support Brackets - Qty x 2 - (100535)  
1 Driver / 1 Passenger**
- (d). Middle and Rear Brackets - Qty x 4 - (100537)  
2 Driver / 2 Passenger**
- (e). Middle and Rear Support-Brackets - Qty x 4 - (100538)  
2 Driver / 2 Passenger**
- (f). Hoop Steps - QTY x 4**

## REFERENCE DIAGRAM

DRIVER SIDE example below:

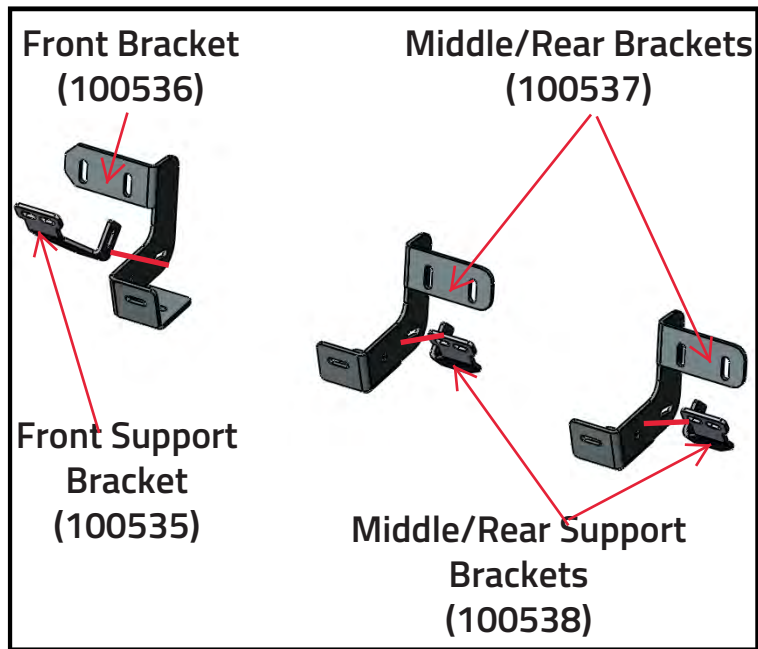

## REFERENCE DIAGRAM

DRIVER SIDE example below:

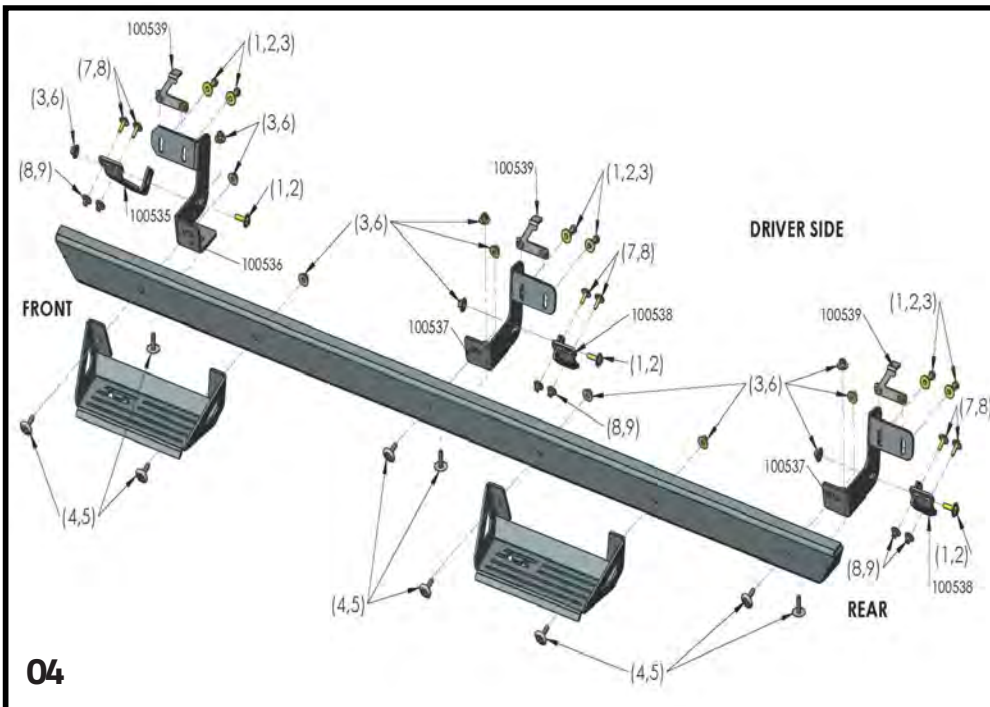
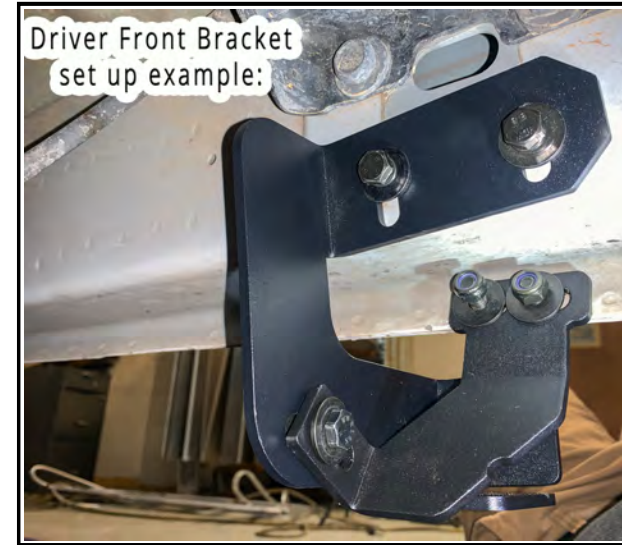

## REFERENCE DIAGRAM

Set up for Double Nutsert Tab (100539). Only applicable for Ram's without pre-threaded holes under rocker panel.

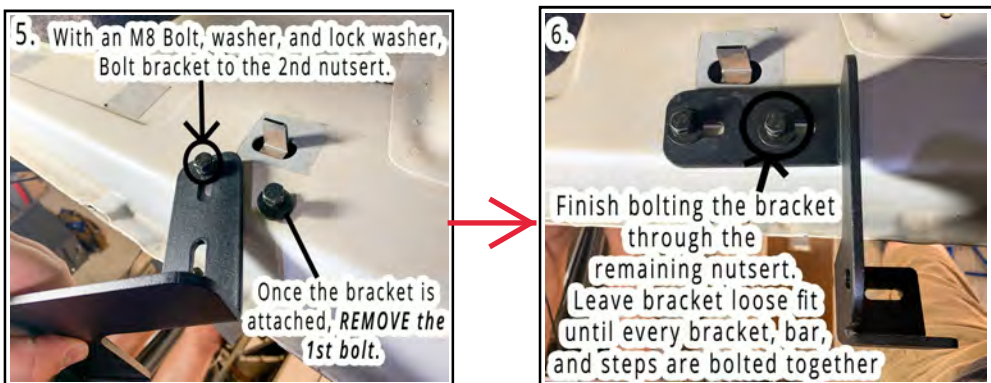
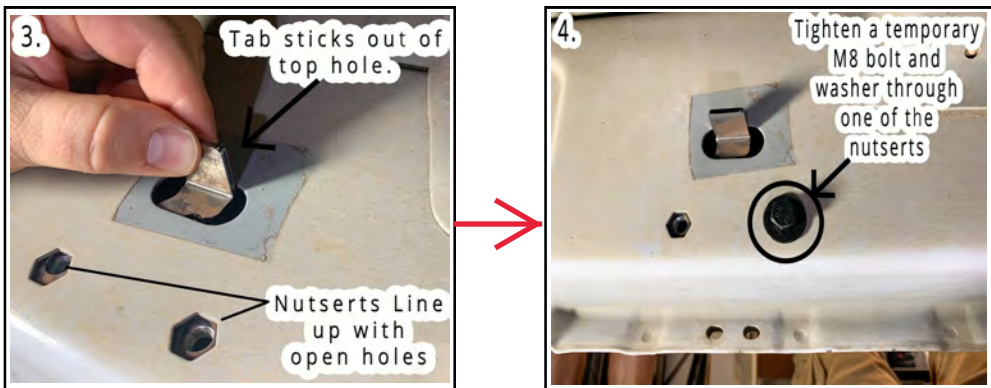
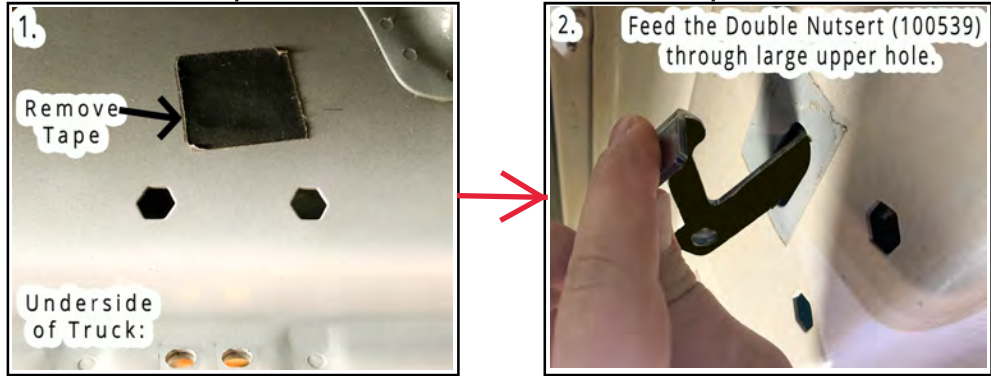

## ICI STEP INSTALLATION

### Step 1 (Prep)

Beginning on the Driver's side, remove any steps if equipped. Next, locate the 3 sets of mounting points on the underside of the vehicle. Please note that your vehicle may have tape or plugs covering up the mounting locations. These will need to be removed so that the mounting locations can be accessed.

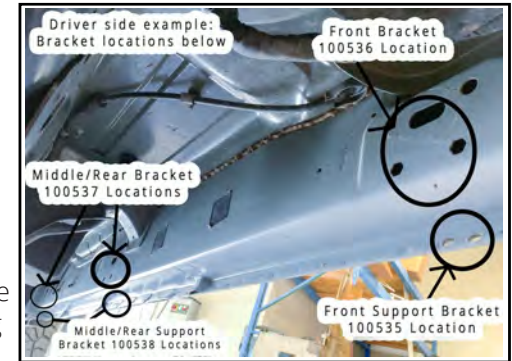

Figure 1.

### Step 2 (Install Front Bracket to Truck)

If your truck doesn't have pre-threaded holes, reference guide on pg. 5 on how to set up the double nutserts (100539). Begin with the driver front bracket (100536). Use a 13mm you will need (2 sets) of M8 hex head bolts, M8 lock washers, and M8 flat washers. Leave loose, do not fully tighten yet. In the next step, we will install the front support bracket (100535), to the front bracket (100536) and pinch weld.



Figure 2.

### Step 3 (Install Front-Support Bracket to Truck and Front Bracket)

Next, bolt the front-support bracket (100535) to the pinch weld and front bracket (100536). For the pinch weld, you will need (2 sets) of M6 hex head bolts, nylock nuts, and (2) M6 flat washers. When attaching to the front bracket, you will need (1 set) of M8 x hex head bolts, lock washers, flat washers, and nylock nuts. See diagram on pg. 4 for assistance.



Figure 3.

## ICI STEP INSTALLATION

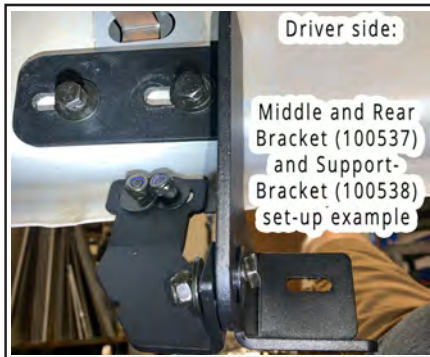

Figure 4.

### Step 4 (Install Middle and Rear Brackets to Truck)

Once the front bracket and support bracket are installed, move on to the middle and rear brackets (100537) and support brackets (100538). Repeat steps 2 and 3 for each bracket location.

### Step 5 (Hang Bar on Brackets)

Next, locate the driver side bar. The rear half of the bar has more holes than the front half of the bar. The top of the bar has a small lip, use the lip to hang the bar on the brackets. This will make the installation process easier and hands-free.



Figure 5.

### Step 6 (Bolt Front and Middle Bracket to Bar)

Next, bolt the middle bracket (100527) to the bar. You will need (2sets) of M8 finish washers, M8x24x2mm flat washers, M8x35mm hex countersunk bolts, and M8 Nylock Nuts. Use a 13mm socket and the provided Allen wrench. Do not fully tighten. Repeat steps above for the rear bracket (100537) See diagram on page 4 for reference.



Figure 6.

## ICI STEP INSTALLATION

### STEP 7 (Bolt Front Bracket to Bar and Front Hoop Step)

Begin by bolting the front bracket (100536) to the bar and the front hoop step. Note that the front bracket and hoop step share a bolt. Then, finish bolting the front bracket and hoop step to the bar. You will need (3 sets) of M8 finish washers, M8x24x2mm flat washers, M8x35mm hex countersunk bolts, and M8 Nylock Nuts. Use a 13mm socket and the provided Allen wrench. Do not fully tighten.

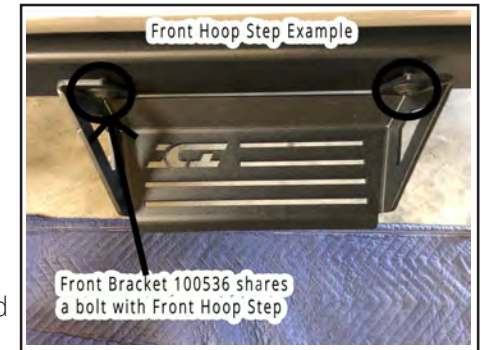

Figure 7.



Figure 8.

### STEP 8 (Bolt Rear Hoop Step to Bar)

Then, bolt the rear hoop step to the bar. You will need (2 sets) of M8 finish washers, flat washers, hex countersunk bolts, and M8 Nylock Nuts. Use a 13mm socket and the provided Allen wrench. Do not fully tighten.

### STEP 9 (Tighten Brackets to truck)

Make sure all 3 brackets, 3 support-brackets, the bar, and the 2 hoops steps are loosely fitted to each other and to the vehicle. Using 13mm socket, fully tighten the front bracket to the vehicle, then to the support-bracket. Make sure the brackets are flush with the mounting surface. Repeat on the middle and rear bracket checking the bracket alignment as needed.

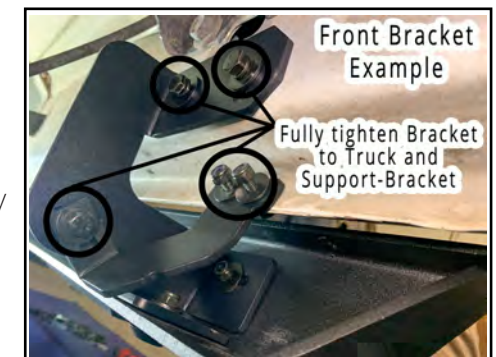

Figure 9.

## ICI STEP INSTALLATION

### STEP 10 (Tighten Brackets to the Bar and Hoop-Steps)

Now, adjust the bar from front to back and tighten the bar to the brackets with a 13mm socket and provided Allen wrench. Make sure the bar is flush with the front and bottom face of the brackets as you are tightening them.

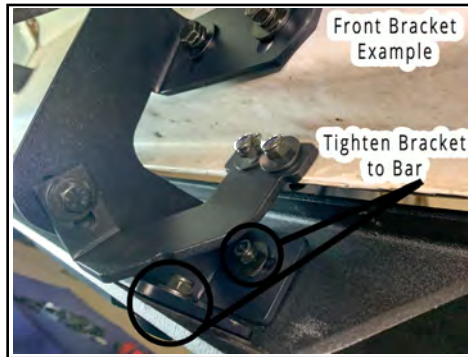

Figure 10.

**\*PRO TIP:** When tightening the Finish Washers, hold the Allen Key tight so the Bolt does not spin. Then, tighten the Nut on the backside. This will prevent the Bolt and Finish Washer from spinning and scratching the Bar.



Figure 11.

### STEP 11 (Finish)

Check all hardware and make sure they are fully tightened. Reference diagram on page 4 for hardware locations. Repeat Steps 1-11 for the Passenger Side.

## TAG ICI ON SOCIAL MEDIA

**AMAZING!**

*Drop us a Review!*

*You have successfully completed the installation of your new Alumilite steps. Time to flex on your friends through Social Media! Don't forget to Tag us!*



[www.facebook.com/InnovativeCreationsInd](http://www.facebook.com/InnovativeCreationsInd)



[www.instagram.com/ici\\_usa](http://www.instagram.com/ici_usa)



*Hashtags:*

*#ICIUSA  
#ICIALumilite  
#AlumiliteSteps  
#AlumiliteBumpers*