



## **Performance Oil Catch Can Kit**

**Part Number: 860-025**

**Lexus 2006-2013 IS250 2.5L V6**

**Lexus 2006-2013 IS350 3.5L V6**

**Lexus 2010-2015 IS250C 2.5L V6**

**Lexus 2010-2015 IS350C 3.5L V6**

## **Installation Instructions**

For technical inquiries please email us at [tech@hpsperformance.com](mailto:tech@hpsperformance.com)

In the email, please include the following information for faster response:

- Year / Make / Model / Engine of your vehicle
- If it is a fitment issue, please include pictures showing the fitment problem
- If there are missing parts, please list the part number(s) from the bill of materials on the 2nd page
- Optional but recommended – Your contact phone number and preferred call back time

You can also give us a call via 626-747-9200 for tech support Monday-Friday, 9:00am-5:00pm Pacific Time.

# Bill of Materials

## Kit Number: 860-025

Line #	Description	Part Number	Qty
1	Oil Catch Can	OCC-14	1
2	Oil Catch Can Bracket #1	OCC-BRKT-029	1
3	Oil Catch Can Bracket #2	OCC-BRKT-030	1
4	Straight Aluminum Adapter, AN-6 to 16mm x 1.50	AN816-6-M1615	2
5	Push-On Aluminum Hose End, AN-6, 90 Degree	150-9006	2
6	Barb Fitting, 3/8"	HW-BF-038	1
7	Fuel Injection Clamp, 16mm - 18mm	FIC-16	3
8	Bolt, M5 x 0.8, 10mm Long	HW-B5-10	3
9	Bolt, M6 x 1.0, 16mm Long	HW-B6-16	4
10	Flat Washer, M6, 16mm OD	HW-FW6L	2
11	Allen Bolt, M6 x 1.0mm, 15mm Long	92095A128	1
12	150 Series Push-On Hose, AN-6	150-06	30 inches
13	150 Series Push-On Hose, AN-6	150-06	30 inches

- **Before installing any parts of this oil catch can kit, please read the instructions thoroughly.**
- **Verify the contents of this oil catch can kit before disassembling your vehicle.**
- **Report any defective or missing parts to HPS directly. The HPS dealer you purchased this product from might not have the replacement parts you need.**
- **Installation requires moderate mechanical skills. A qualified mechanic is highly recommended.**
- **Do not attempt to install the oil catch can kit while the engine is hot.**
- **This installation may require the removal of coolant lines that may be hot.**
- **For technical inquiries, please email us at [tech@hpsperformance.com](mailto:tech@hpsperformance.com)**

## **PLEASE READ CAREFULLY BEFORE INSTALLATION!**

This installation is not for the novice customer. Install this product with EXTREME caution! Misuse of this product can destroy your engine! If you are not mechanically inclined, please have a professional automotive mechanic install this kit.

***NOTE: HPS holds no responsibility for any engine damage that results from misuse of this product.***

## **GETTING STARTED**

1. Turn the ignition OFF and disconnect the vehicle's negative battery cable. If the engine has run within the past two hours let it cool down.

NOTE: Disconnecting the negative battery cable erases pre-programmed electronic memories. Write down all memory settings before disconnecting the negative battery cable. Some radios will require an anti-theft code to be entered after the battery is reconnected. The anti-theft code is typically supplied with your owner's manual. In the event your vehicle's anti-theft code cannot be recovered, contact an authorized dealership to obtain your vehicle's anti-theft code. We also highly recommend NOT discarding any stock parts after the installation.

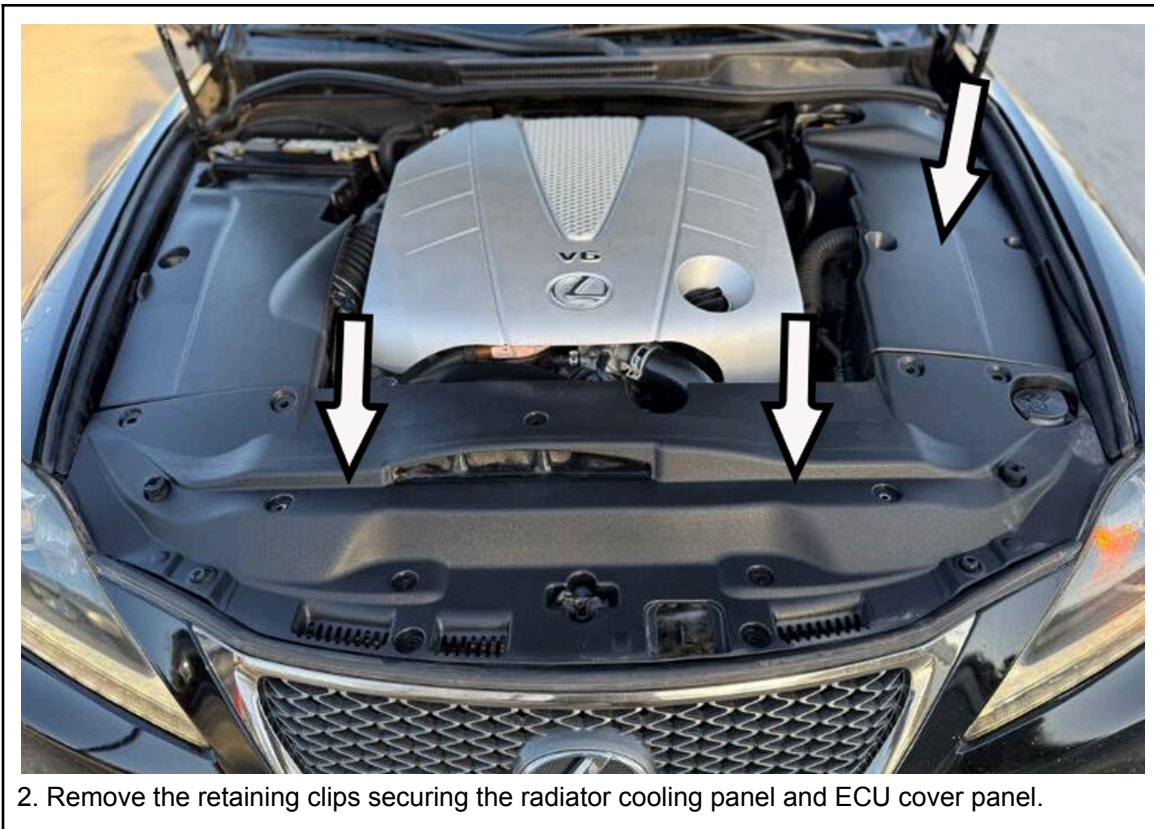

2. Remove the retaining clips securing the radiator cooling panel and ECU cover panel.



3. Locate the PCV valve near the brake booster master cylinder. Disconnect the PCV hose from the valve.

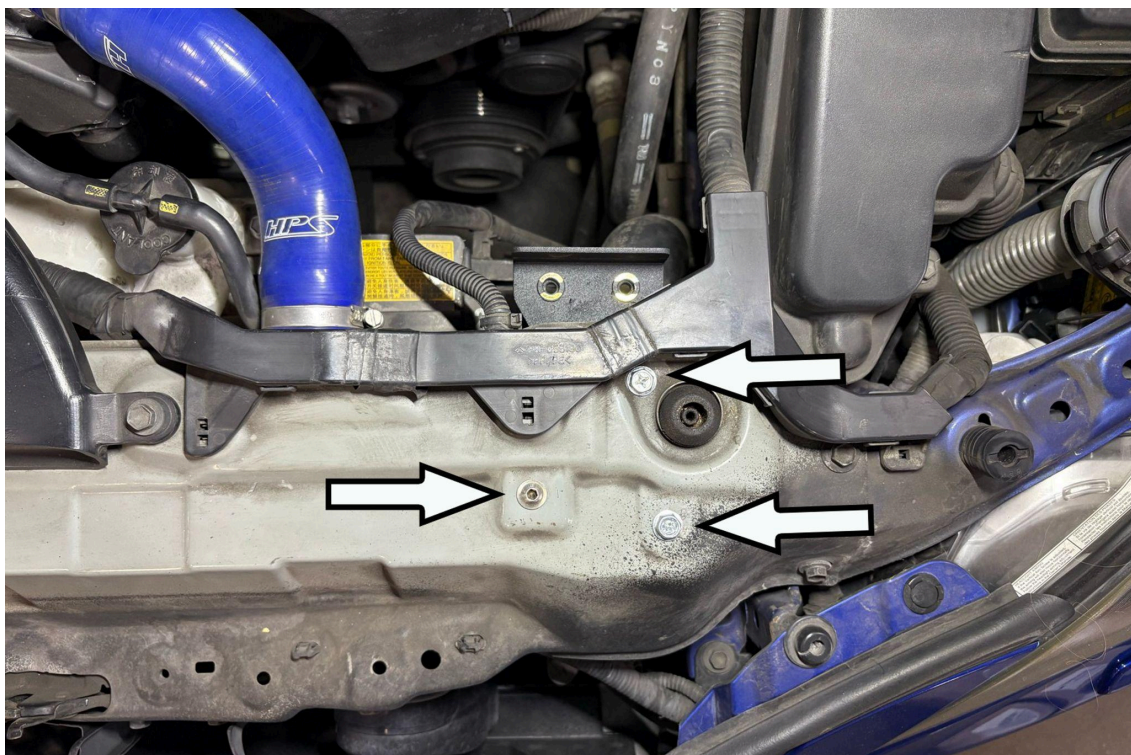

4. Secure the lower oil catch can bracket to the radiator support using the two provided M6, 16mm long bolts, and M6 Allen bolt.

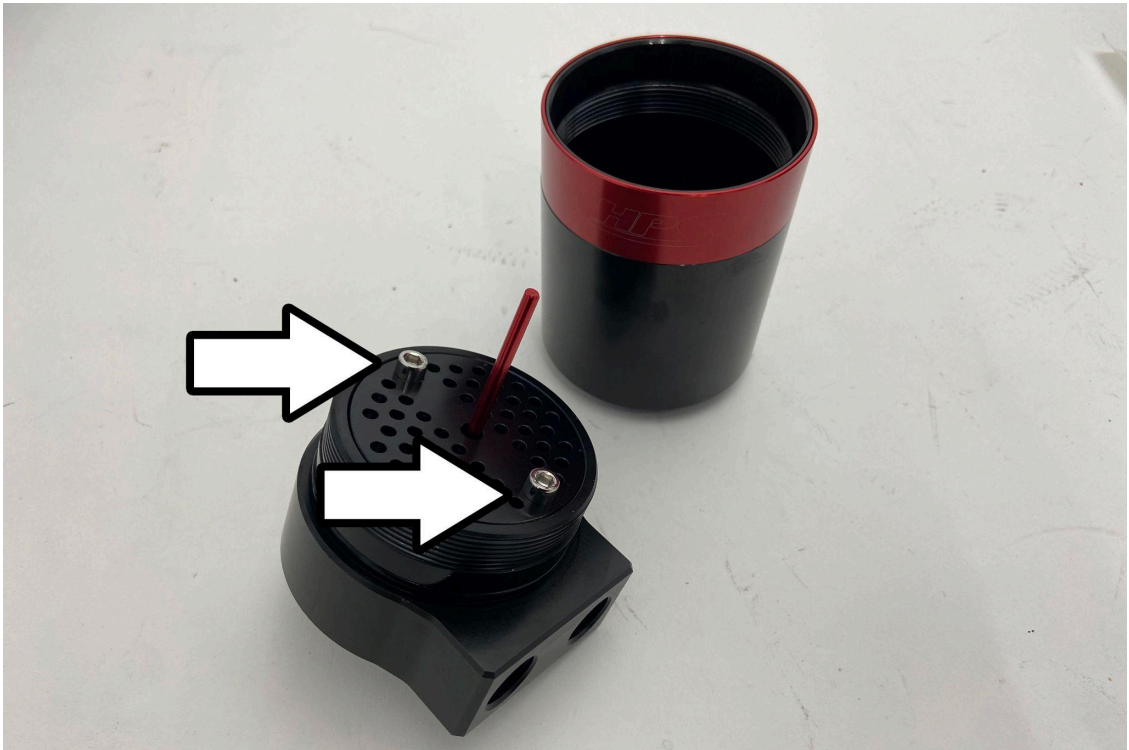

5. Unscrew the top of the HPS Oil Catch Can and check that the Allen bolts are tight.



6. Slide the provided crush washers onto the metric side of the provided AN to M16 adapter fittings, then fasten the adapters onto the oil catch can.

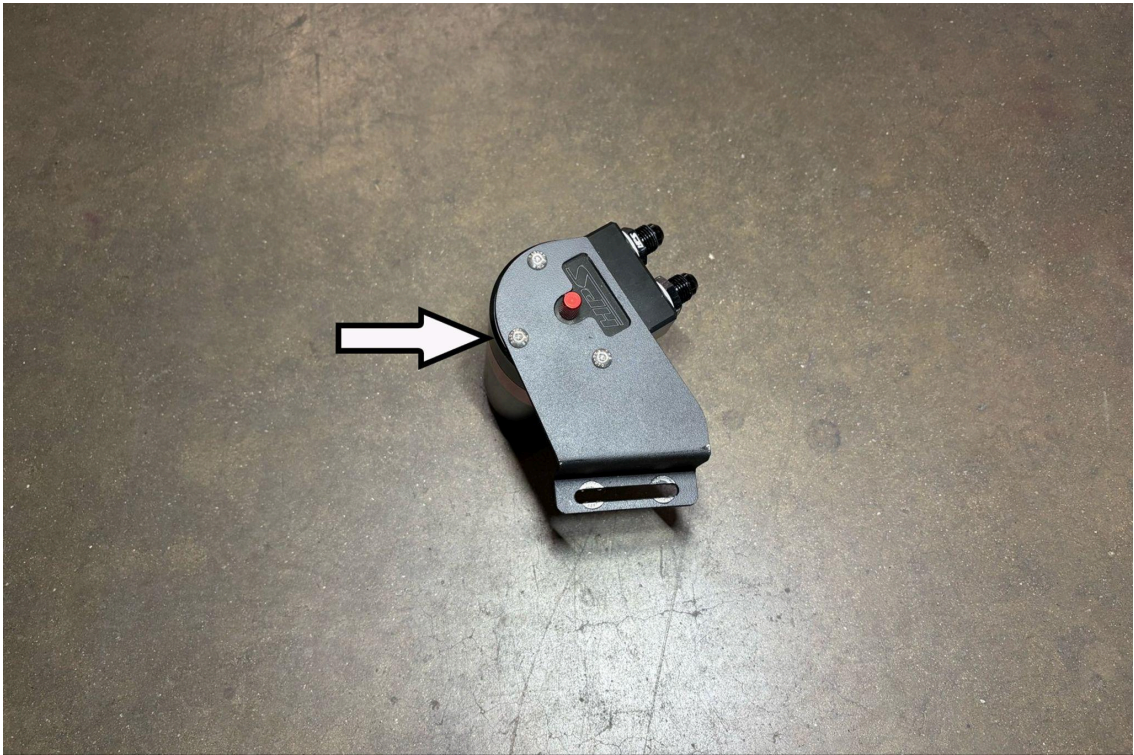

7. Secure the upper oil catch can bracket onto the oil catch can using the three provided M5 bolts.



8. Secure the upper oil catch can bracket to the lower bracket using two of the provided M6, 16mm long bolts, and two washers.

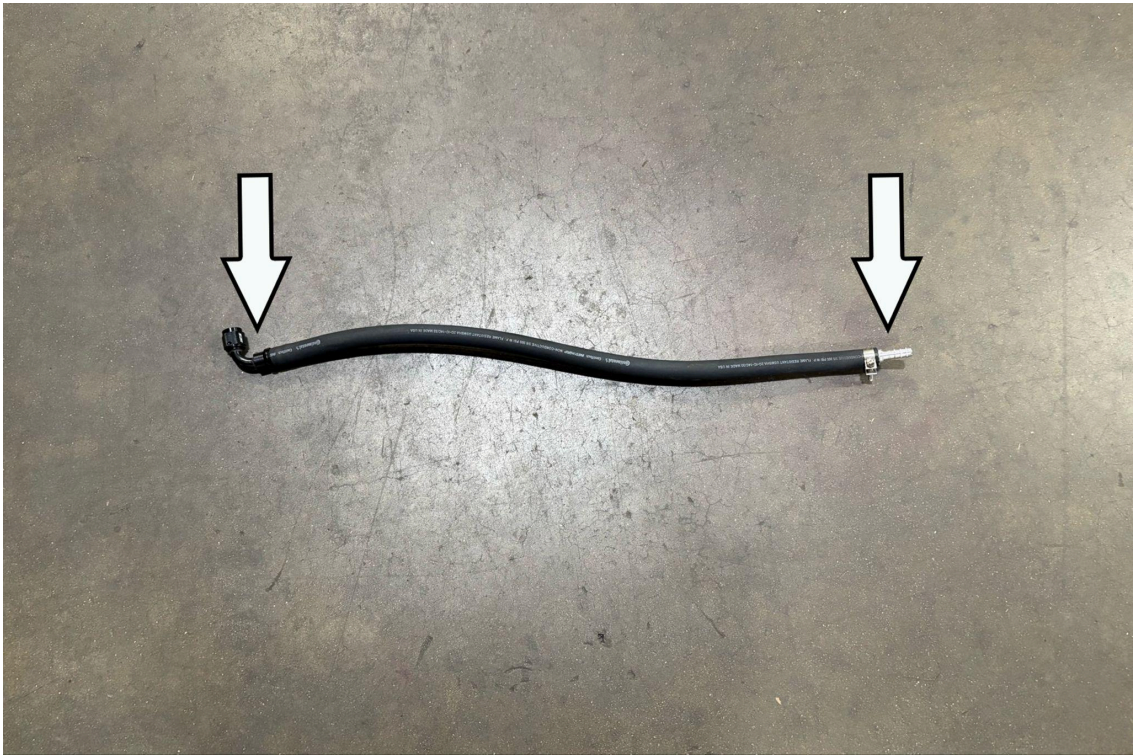

9. Push the 90 degree AN hose end fitting into one side of the provided AN-6 hose. Then push on and secure the 3/8" barb to the other side using one of the provided fuel injection clamps.

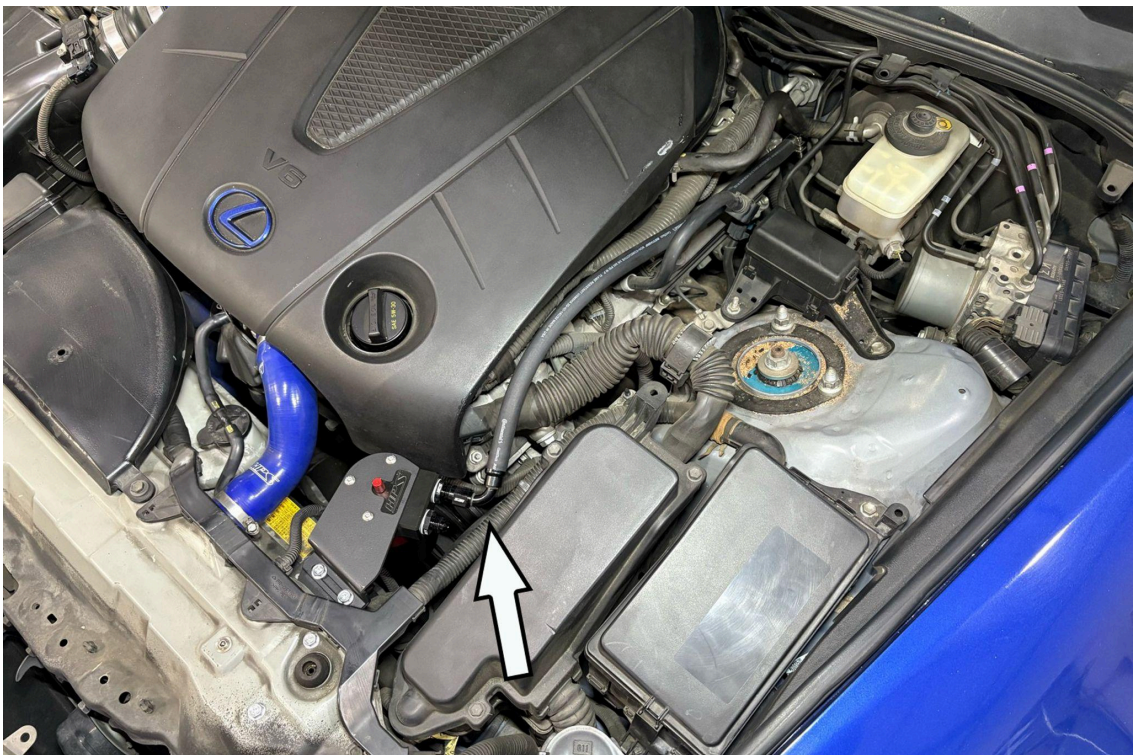

10. Secure the AN fitting to the right side adapter of the oil catch can.

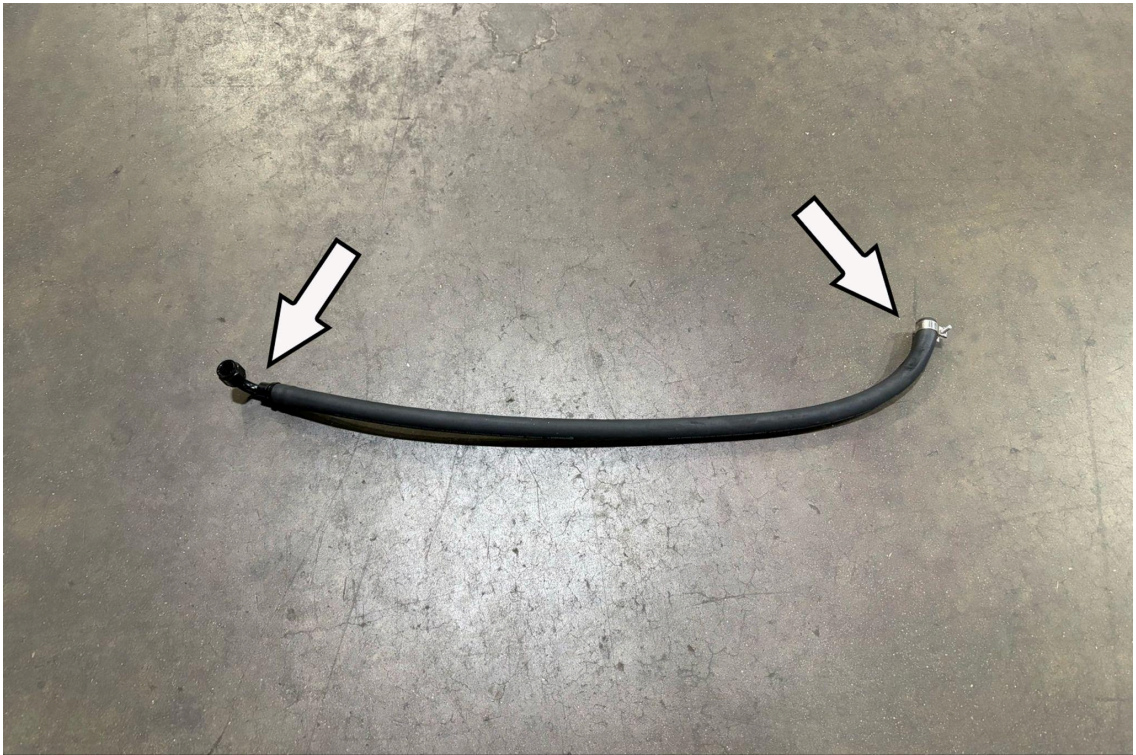

11. Push on the other 90 degree AN hose end fitting to one side of the second provided AN-6 hose. Then slip the remaining fuel injection clamp onto the opposite side of the hose.

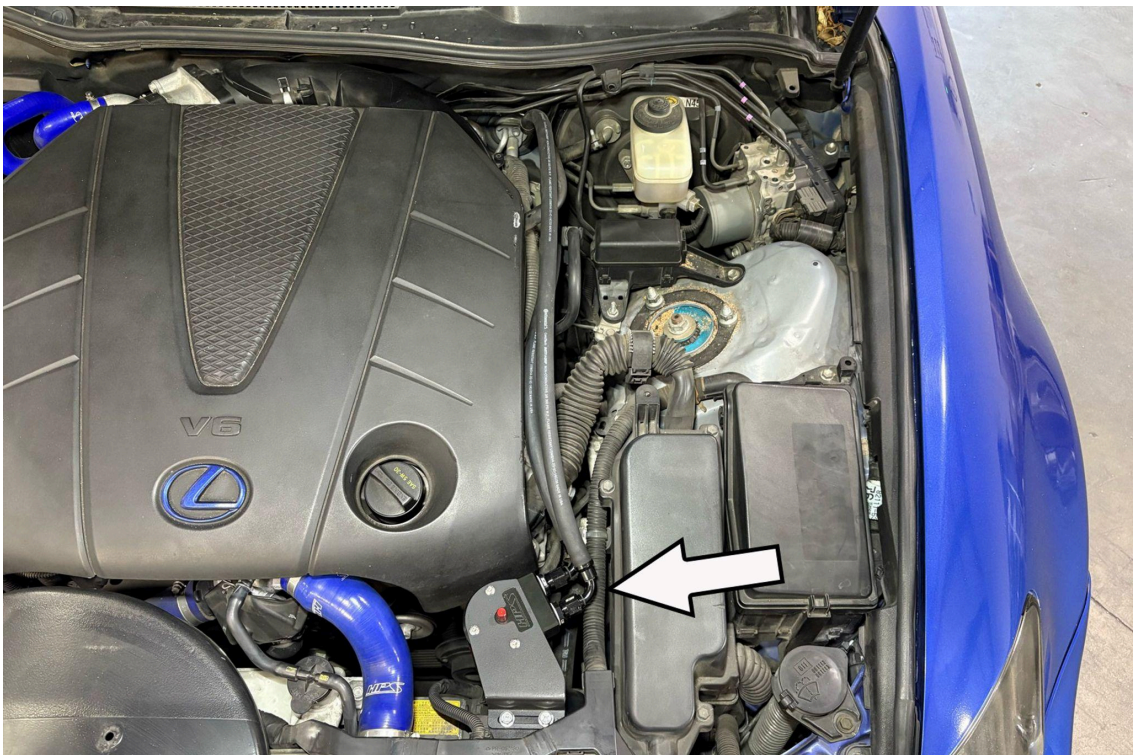

12. Secure the AN fitting to the left side adapter of the oil catch can.



13. Secure the AN hose without the barb fitting onto the PCV valve using the fuel injection clamp.



14. Connect the factory PCV hose to the barbed AN hose and secure it using the remaining fuel injection clamp.

## **FINAL STEPS**

Upon completion of the installation, reconnect the negative battery terminal before you start the engine and reinstall the engine covers back into the vehicle. Double check to make sure everything is tight and properly positioned before starting the vehicle.

Start the engine. Let the car idle for 3 minutes. Perform a final inspection before driving. Listen carefully for any odd noises or rattles prior to taking it for a test drive. If any problems arise, go back and check the hoses and clamps that may be causing the issue and correct the problem.

Ensure that the dipstick on the HPS oil catch can is fully seated. Failure to install the dipstick properly will result in a check engine light and poor performance.



**Also available for**

**Lexus 2006-2013 IS250 2.5L V6**

**Lexus 2006-2013 IS350 3.5L V6**

**Lexus 2010-2015 IS250C 2.5L V6**

**Lexus 2010-2015 IS350C 3.5L V6**



**HPS Performance Air Intake Kit**

Part Number [827-597](#)



**HPS Performance Air Intake Kit**

Part Number [827-710](#)



**HPS Performance Air Intake Tube**

Part Number [27-710](#)



**HPS Silicone Radiator Coolant Hose Kit**

Part Number [57-1267](#)

Contact an authorized HPS Performance dealer or visit us at [hpsperformance.com](http://hpsperformance.com) for more details