

Fluidampr® Installation / Removal Tool

Full installation instructions are included with every damper and are available at: www.fluidampr.com
Please refer to these instructions for more detailed information.

Install:

Thread the high nut onto the mainshaft.

Place the chamfered side of the thrust bearing on the main shaft so it stops against the high nut.

Thread the insert into the front of the crank snout until it stops.

Thread the mainshaft into the threaded insert until it stops and then back off 1/2 turn.

While holding the mainshaft with a wrench, tighten the high nut until the damper is fully seated on the crank snout.

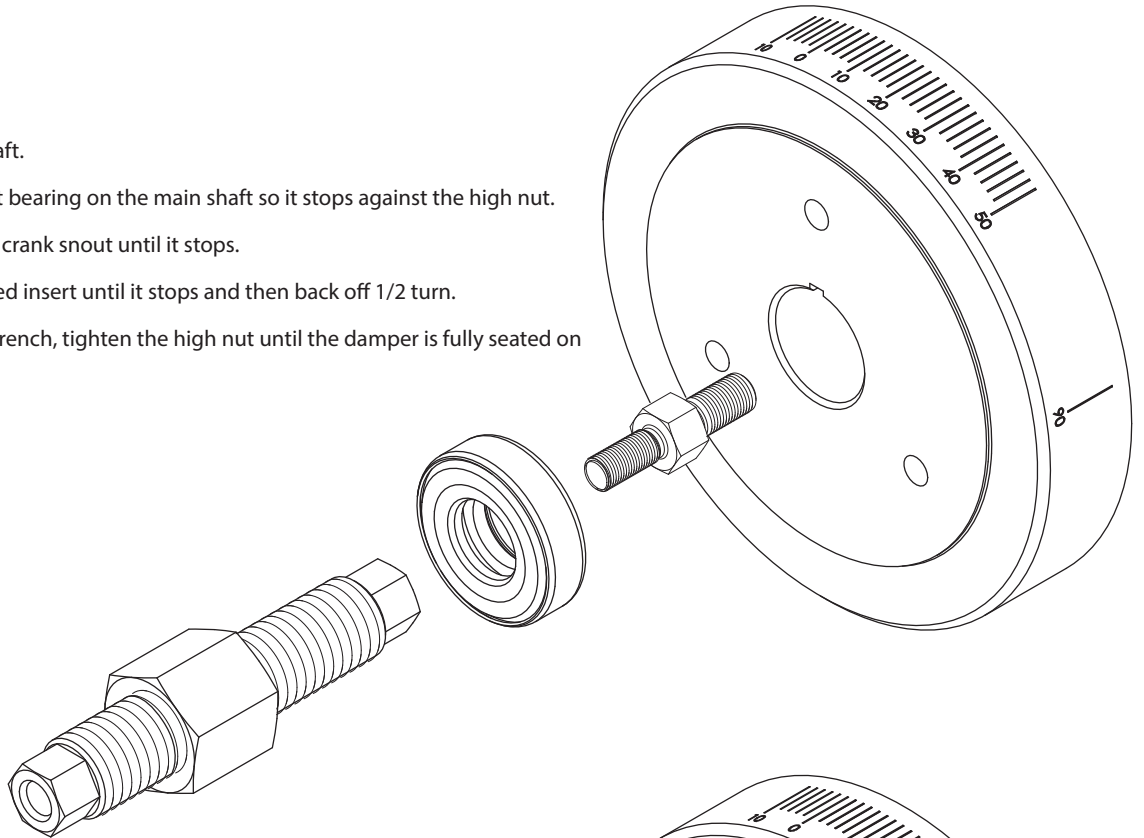

Removal:

Thread the puller flange onto the mainshaft.

Place the pivot center onto the mainshaft.

Place the puller bushing into the front of the crank snout.

Place the 3 bolts into the proper slots on the puller flange and thread them into the damper making sure you have full thread engagement in the damper.

Tighten the mainshaft until the damper is pulled off the crank snout

