

INSTALLATION MANUAL

Level of Difficulty

Moderate

Electrical Ratings

Signal circuits	5.0-amps per side
Tail / Running Circuits	7.5-amps total

Check vehicle owner's manual or contact the vehicle manufacturer for more information.

Wiring Location(s)

S9 and S10

Wiring Location Guide* for SUVs and Vans (S)

S1	Behind driver side taillight housing
S2	Behind passenger side taillight housing
S3	Behind driver side rear access panel
S4	Behind passenger side rear access panel
S5	Behind driver side rear bumper
S6	Behind center of rear bumper
S7	Behind passenger side rear bumper
S8	Under rear floor panel
S9	Behind driver side rear access panel
S10	Behind passenger side rear access panel

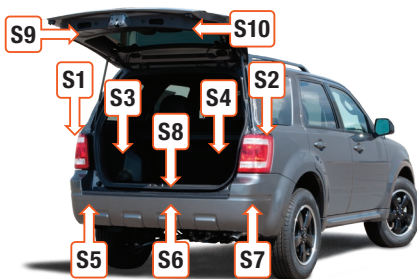

* Representative vehicle shown

Tools Required

Ratchet	Cutting tool
Socket extension	Wire crimper
Torx bit, T-20, T-15	Wire stripper
Panel trim removal tool	Electrical tape
Flathead screwdriver	--

WARNING

Do not exceed product rating or tow vehicle lamp load rating, whichever is lower.

The battery connection must be fuse-protected, 15-amp max. Exceeding the product rating can cause loss of warranty, overheating and potential fire.

Product Photo

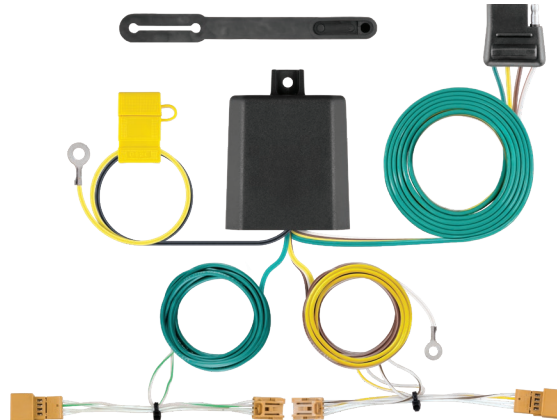

Hardware Photo

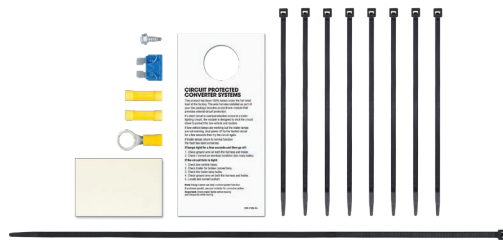

NOTICE

Before you begin installation, read all instructions thoroughly.

Proper tools will improve the quality of installation and reduce the time required.

All steps must be followed to ensure the product will function properly. Once installed, test for proper function by using a test light or connecting a properly wired trailer.

This harness will not function until all connectors and panels are reinstalled and the vehicle hatch is closed. If the connectors and panels are not replaced, the taillight will not function and an error message will be shown on the vehicle dash display. Due to the connection of this custom trailer light harness, The vehicle will not have functionality of taillights when the hatch is open. The hatch must be closed for trailer lights function to correctly.

Maintenance

Periodic inspection of all wires and connections should be performed to ensure there is no visible damage or loose connections.

Product Registration and Warranty

CURT Group stands behind our products with industry-leading warranties. Provide feedback and help us to improve our products by registering your purchase at: warranty.curtgroup.com/surveys

Step 1

Open the rear lift gate and remove all trunk floor coverings and the trunk storage tray. Disconnect the housing for the sub-woofer and loosen the spare tire tie-down. Remove both the sub-woofer and spare tire and set aside.



Step 2

Lift the floor panel exposing the battery. Disconnect the negative battery terminal. Be sure to fasten this wire down and away from the battery when completing the installation process.



Step 3

Using the panel trim removal tool, loosen the fasteners securing the rear scuff panel. Remove the scuff panel by pulling out on the bottom and then up. Take care not to damage the alignment tabs on the back. Disconnect the latch sensor connector from the scuff panel.



Step 4

Locate and remove the taillight access panel in the rear lift gate. Starting on the driver side, use the panel trim removal tool to remove the taillight access panel. Behind this cover is a fastener. Use the T-20 Torx bit to remove (one per side).

Repeat on the passenger side of the lift gate. In the center of the hatch is an access panel to manually open the rear hatch. Open this cover and use the T-20 Torx bit to remove both fasteners.



Step 5

Using the panel trim removal tool, loosen the push fasteners on the rear hatch trim. Locate and disconnect the lift gate light and push-button hatch close connector from the lift gate trim panel. Take care not to damage any housings or alignment tabs on the back of the trim panel.

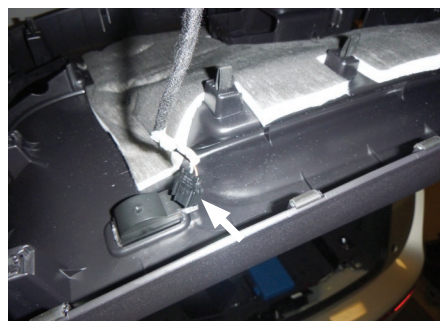

Step 6

On the driver side, locate and remove the trim cover on the lift gate hinge. Use the panel trim removal tool to loosen the push fasteners in the hatch door on the driver side.



Step 7

On the driver side, remove the side access panel. Use the twist knob to unlock and remove. Behind the rear seat release lever, remove the screw using a T-15 torx bit.



Step 8

On the driver side, starting on the top near the lift gate hinge, remove the weather stripping. Remove until you reach the lower felt trim panel located inside the cargo area. Use the panel trim removal tool to loosen the push fasteners in the plastic side wall trim (Carefully pull outwards on the side trim panels to allow routing of the custom wiring harness).



Step 9

Remove the screw on the upper trim using a T-15 Torx bit.



Step 10

Open the battery compartment and locate a spot to mount the converter close enough to connect the power and ground.

Do not connect these at this point.



Step 11

Route the custom wiring ends of the custom wiring harness along the floor to the driver-side access panel and up the side wall behind the vehicle side trim panels, along the removed weather stripping to the lift gate hinge.

Route the custom wiring ends along the lift gate hinge and out under the removed lift gate trim panel to the driver-side taillight connectors.

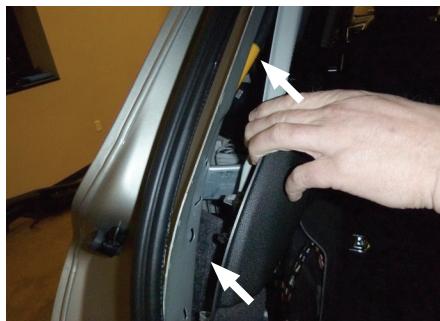

Step 12

Disconnect the driver-side factory wiring and install the custom wiring end with the yellow wire inbetween the factory harness. Separate the connectors from the taillight housing, taking care not to damage the locking tabs.



Step 13

Route the custom wiring ends with the green wire to the passenger-side taillight connectors and repeat step 10. Use the provided cable ties to secure any loose wires while routing the custom wiring harness.

Step 14

Reinstall all removed panels and plug in the two connectors that were disconnected. The vehicle will not have functionality of taillights when the hatch is open. The hatch must be closed for trailer lights function to correctly.

Route the black power wire from the vehicle battery as shown on the last page of this manual.

NOTICE

Once the 12 volt power wire is connected to the harness verify that the harness is functioning by attaching the battery and testing with a test light, 4-flat tester, or a functioning trailer.

When in use, route the 4-flat to the center of the vehicle and out of the trunk. When not in use, roll up and store in a convenient, out of the way location inside the trunk. Secure any loose wires with the provided cable ties.

Reinstall all items removed during install. If it was disconnected at the beginning of the installation, reconnect the negative battery terminal. Install the provided 4-flat dust cover to help prevent corrosion.

POWERED CONVERTER LEAD INSTRUCTION SHEET

FICHE DE CONSIGNES DU CONVERTISSEUR D'ALIMENTATION

HOJA DE INSTRUCCIONES DEL CONDUCTOR DEL ADAPTADOR ALIMENTADO POR BATERÍA

NOTICE AVIS / AVISO

Illustrations are for reference only. Battery location may differ depending on the vehicle.

Les images ne sont fournies qu'à des fins de référence. L'emplacement de la batterie peut varier en fonction du véhicule.

Las ilustraciones son solo para referencia. La ubicación de la batería puede variar según el vehículo.

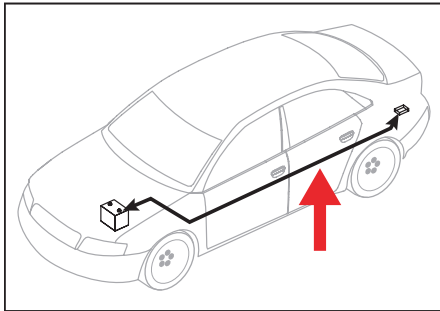

WARNING AVERTISSEMENT / ADVERTENCIA

Route 12 GA wire to vehicle battery location, taking care to avoid any pinch points and hot or rotating components.

Acheminer le câble de calibre 12 à la batterie du véhicule en prenant soin d'éviter les points de pincement et les éléments chauds ou pivotants.

Pase el cable calibre 12 hacia la ubicación de la batería del vehículo, con cuidado de evitar atascos y componentes calientes o giratorios.

WARNING AVERTISSEMENT / ADVERTENCIA

To avoid personal injury or property damage, check for miscellaneous items that may be behind or under any surface before drilling.

Pour éviter les blessures et les dommages matériels, vérifier les divers articles qui peuvent se trouver derrière ou sous la surface avant de percer.

Para evitar lesiones personales o daños materiales, verifique que no haya ningún elemento detrás o debajo de la superficie antes de perforar.

NOTICE AVIS / AVISO

1. This converter system is to be used only on 12 volt negative ground systems.
2. Secure power wire to vehicle chassis using cable ties provided.
3. When passing the power wire through sheet metal, use an existing grommet, add a grommet or use silicone to protect the power wire from sharp edges.
4. Overall T-connector design may differ from illustration. The illustration should be used for power lead instruction only. Illustration is not to scale.

1. Ce système de convertisseur ne doit être utilisé qu'avec une prise de masse de polarité négative de 12 volts.
2. Fixer le câble d'alimentation au châssis du véhicule à l'aide des courroies d'attache de câble fournies.
3. Utiliser un œillet existant, ajouter un œillet ou appliquer du silicone pour protéger le câble d'alimentation des rebords tranchants au moment de le passer à travers la tôle.
4. La disposition générale du connecteur en T peut différer de l'illustration. Celle-ci ne doit être utilisée que pour le convertisseur d'alimentation. L'illustration n'est pas à l'échelle.

1. Este sistema de adaptadores solo se debe utilizar con sistemas con polo negativo a masa de 12 voltios.
2. Sujete el cable de alimentación al chasis del vehículo utilizando los sujetacables suministrados.
3. Al pasar el cable de alimentación por la lámina de metal, utilice la arandela pasacable existente, agregue una arandela pasacable o utilice silicona para proteger el cable de alimentación de los bordes filosos.
4. El diseño general del conector T puede ser distinto de la ilustración. La ilustración solo se debe utilizar para la instrucción del conductor de alimentación. La ilustración no está a escala.

