

INSTALLATION INSTRUCTIONS

⚠ WARNING: DO NOT EXCEED PRODUCT RATING OR TOW VEHICLE LAMP LOAD RATING, WHICHEVER IS LOWER

APPLICATIONS

Make	Model
Chrysler	Town & Country
Dodge	Caravan
Dodge	Durango
Dodge	Grand Caravan
Plymouth	Grand Voyager
Plymouth	Voyager

CUSTOM WIRING HARNESS

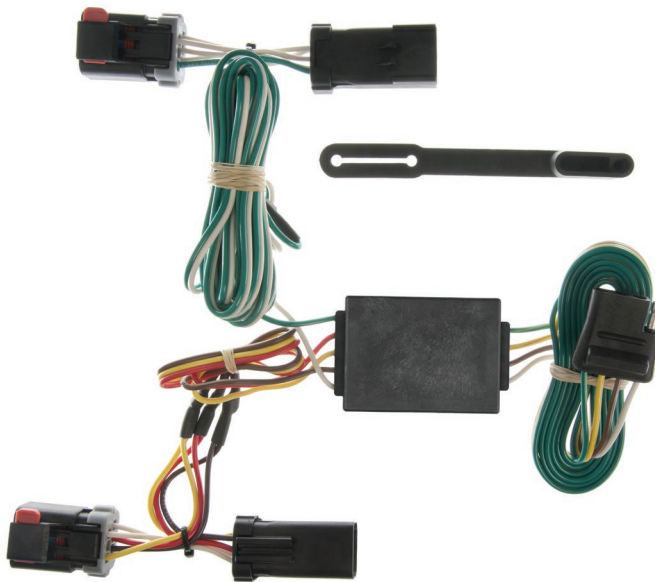

WIRING LOCATION GUIDE

SUVs, MINI & FULL-SIZED VANS (S)

Representative vehicle shown below

S1 - Behind driver side taillight housing

S2 - Behind passenger side taillight housing



NOTICE

All steps must be followed to ensure the wiring harness will function properly. Once installed, test for proper function by using a test light or connecting a properly wired trailer.

TOOLS NEEDED

- Phillips screwdriver
- Flat blade screwdriver
- Panel trim removal tool
- Wire stripper
- Wire crimper
- Cutting tool

⚠ WARNING

Exceeding the product rating can cause loss of warranty, overheating and potential fire. Do not exceed product rating or tow vehicle lamp load rating, whichever is lower.

Signal Circuits - 3.0 amps per side

Tail / Running Circuits - 6.0 amps total

Check vehicle owner's manual or contact the vehicle manufacturer for more information.

DURANGO INSTALLATION / SAFETY INSTRUCTIONS

Dodge Durango

Step 1

Remove the two screws securing the taillight assembly and carefully pull outward (A). Slide the red locking tab on the harness connector to the unlocked position and disconnect the vehicle wiring harness from both taillights (B).

Step 2

Remove the black air baffle (B) and pull out the rubber grommet (E) behind the taillight. Remove the hatch threshold (C) and pull back the interior panels on each side of the vehicle and remove the rubber grommet (E) behind the panels (D).

Step 3

Insert custom wiring harness into the space behind the air baffle. Route the wiring harness with yellow wire up through the grommet mounting location and insert the between the separated vehicle connectors. Make sure the connectors are fully inserted with locking tabs in place (F).

Step 4

Slit the grommet as shown in (E). Place the custom wiring harness wires into the slit and reseal into mounting location.

Step 5

Secure black box in harness to metal behind rubber grommet using the provided double-sided tape and cable ties. Route 4-flat and housings with green wire attached up through inside rubber grommet mounting location. Slit the rubber grommet as before and reseal into the mounting location (D). Use the provided sealant to seal the cut in the grommet and around all the wires.

Step 6

Route the custom wiring harness with green wire to the passenger side under threshold or in the jack compartment and repeat driver side steps working from inside of the vehicle out to the taillight (G).

Step 7

Route the 4-flat into the jack compartment for storage (G).

 **WARNING:** Check for miscellaneous items that may be hidden behind or under any surface before drilling to avoid damage and / or personal injury.

Step 8

Reinstall all items removed during install. Install the provided 4-flat dust cover to help prevent corrosion.

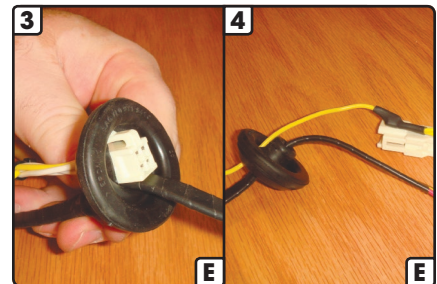
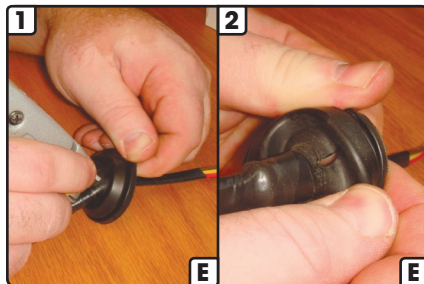
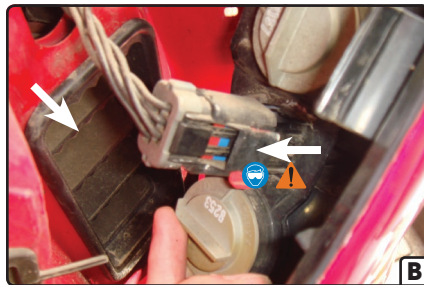
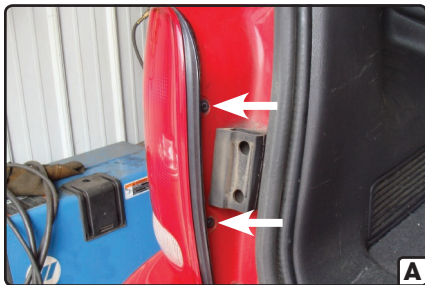

MINI VAN INSTALLATION / SAFETY INSTRUCTIONS

Mini Van

Step 1

Remove the two screws securing the taillight assembly and carefully pull outward (H). Slide the red locking tab on the harness connector to the unlocked position and disconnect the vehicle wiring harness from both taillights (B).

Step 2

Pull out the rubber grommets (E) behind the taillights. Remove the jack storage cover. Remove the hatch threshold (H) and pull back the interior panels on each side of the vehicle.

Step 3

Insert the custom wiring harness into space behind the jack storage compartment (I). Route the wiring harness with yellow wire through the grommet mounting location on the driver side to the taillight and insert the between the separated vehicle connectors. Make sure the connectors are fully inserted with locking tabs in place (J).

Step 4

Slit the grommet as shown in (E). Place the custom wiring harness wires into the slit and reseal into mounting location. Use the provided sealant to seal the cut in the grommet and around all the wires.

Step 5

Secure black box in harness to metal behind the jack compartment using the provided double-sided tape and cable ties. Route the wiring harness end with green wire out the interior panel, under the hatch threshold to the passenger side and repeat steps 3-4 (K).

Step 6

Route the 4-flat into the jack compartment for storage (I).

Step 7

Replace any trim panels removed during the previous steps. Reinstall the tail lamp housing, careful to avoid any areas that would cut or pinch the wire.

 **WARNING:** Check for miscellaneous items that may be hidden behind or under any surface before drilling to avoid damage and / or personal injury.

Step 8

Reinstall all items removed during install. Install the provided 4-flat dust cover to help prevent corrosion.

