

INSTALLATION MANUAL

18021

Level of Difficulty

Easy

Installation difficulty levels are based on time and effort involved and may vary depending on the installer level of expertise, condition of the vehicle and proper tools and equipment.

Weight Carrying Capacity

1 bike	45 lbs.
2 bikes	90 lbs.
4 bikes*	180 lbs.

*Maximum capacity of 180 lbs. evenly distributed when expanded to 4 bike carrier with extension arms (#18020, sold separately)

Parts List

Item	Qty	Description
1	1	Arm post
2	1	Connecting post
3	1	Shank, 1-1/4"
4	1	U-type plastic shank adapter, 2"
5	2	Adapter, socket head cap screw
6	6	Arm straps, rubber
7	1	Bolt kit, hex head (bolt, two washers, nut)
8	2	Bolt kit, (bolt, one washer, nut)
9	1	Anti-rattle bolt and clip
10	1	Support strap buckle
11	1	Support strap cinch
12	1	Wrench, 19mm
13	1	Allen wrench, 5mm
14	1	Allen wrench, 8mm

Tools Required

Allen wrench, 5mm	Wrench, 19mm
Allen wrench, 8mm	--

Product Registration and Warranty

CURT stands behind our products with industry-leading warranties. To get copies of the product warranties, register your purchase or provide feedback, visit: warranty.curtgroup.com/surveys

⚠ WARNING

Never exceed the vehicle manufacturer's recommended towing capacity.

Never exceed the product's weight capacity.

Do not modify or use this accessory for purposes other than for which it was designed.

Failure to use support straps on trailer hitches with 1-1/4" receiver tubes voids the trailer hitch and bike rack warranties.

Check straps for wear, and replace if worn.

This product is not intended for off-road use, tandems or recumbents

It is the user's responsibility to adhere to all state and federal laws regarding obstruction of vehicle lighting (i.e. brake lights, taillights, turn signals and backup lights) and license plate when using this accessory.

For use with any frame-mounted 2" class 3 or higher trailer hitch receiver.

Note: Clamp-on bumper receivers and traditional 4" square bumpers should not be used to mount bike racks. Do not exceed receiver weight limits

Product Photo



NOTICE

Visit www.curtmfg.com for a full-color copy of this instruction manual, as well as helpful videos, guides and much more!

Before you begin installation, read all instructions thoroughly.

Proper tools will improve the quality of installation and reduce the time required.

Periodic inspection of your product should be performed to ensure all hardware and / or components remain secure.

ASSEMBLY

Parts List

Item	Qty	Description
1	1	Arm post
2	1	Connecting post
3	1	Shank, 1-1/4"
4	1	U-type plastic shank adapter, 2"
5	2	Adapter set screw
6	6	Arm straps, rubber
7	1	Bolt kit, hex head (bolt, two washers, nut)
8	2	Bolt kit, (bolt, one washer, nut)
9	1	Anti-rattle bolt and clip
10	1	Support strap buckle
11	1	Support strap cinch
12	1	Wrench, 19mm
13	1	Allen wrench, 5mm
14	1	Allen wrench, 8mm

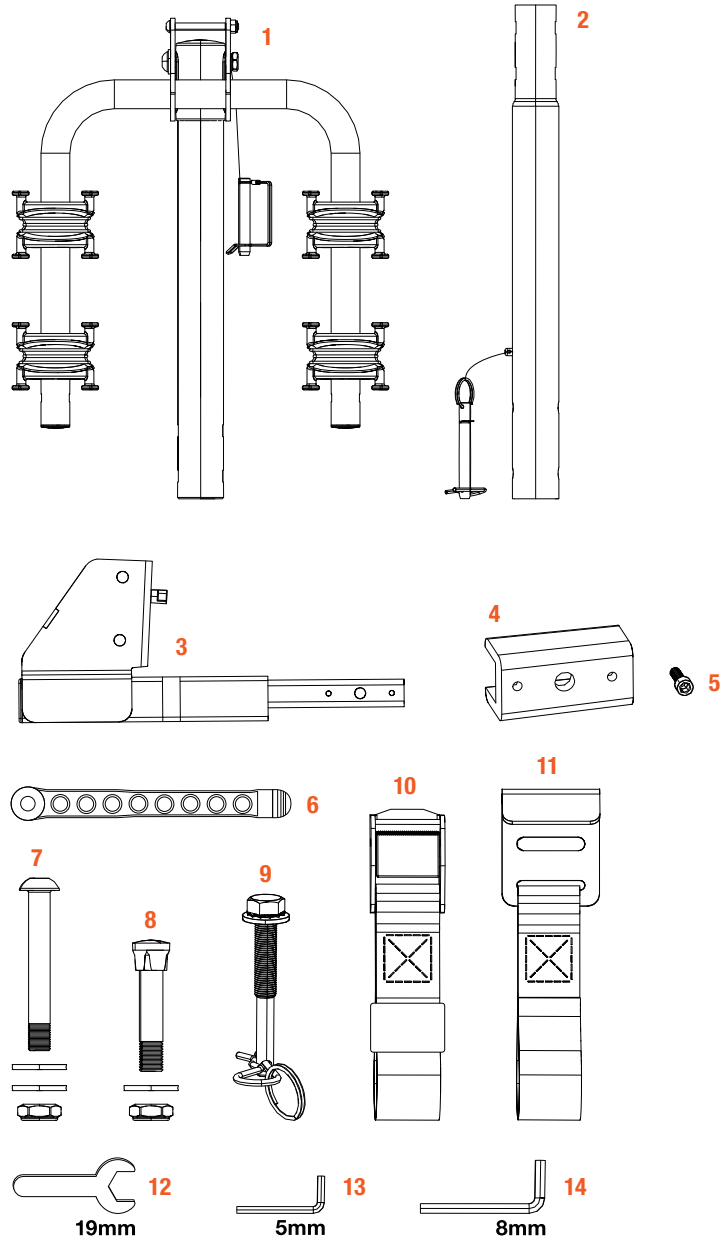

ASSEMBLY

Step 1

Raise the arms to the outright position, and secure with the attached lynch pin. See figure 1-A

Step 2

Connect the arm post (#1) and the connecting post (#2) using bolt kit (#8). See figure 1-B.

Step 3

Using the hex head bolt kit (#7), attach the bottom of the connecting post (#2) to the shank (#3). Make sure to install the bolt in the bottom hole. See figure 1-C. Insert the bolt that is connected to the post through the top hole of the shank and secure with the provided clip. See figure 1-D.

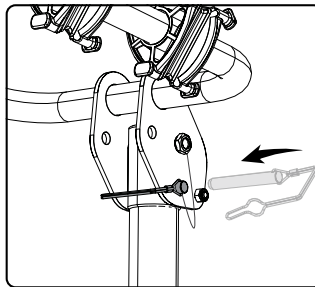
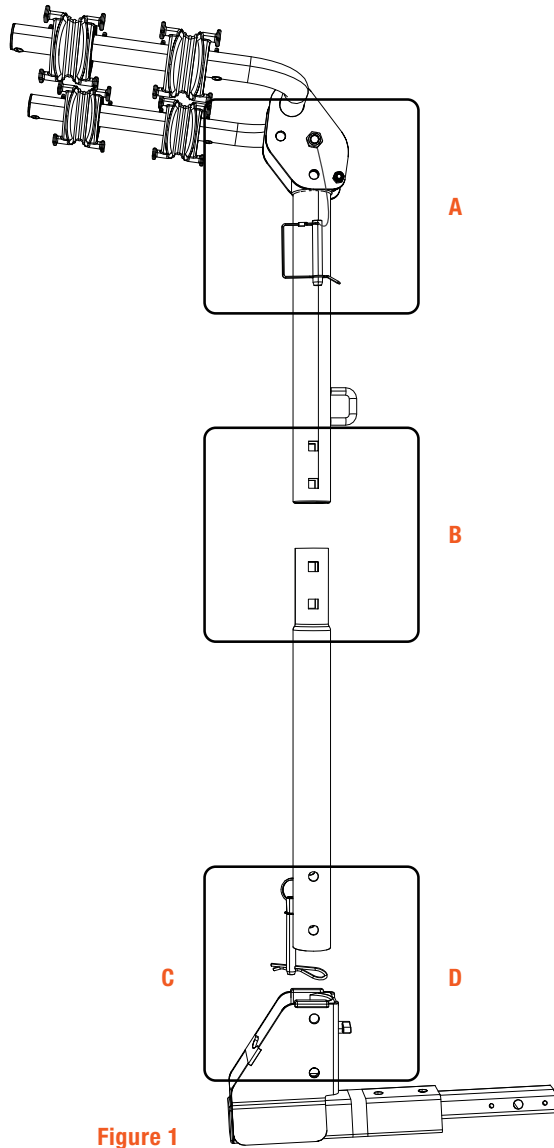

Figure 1-A

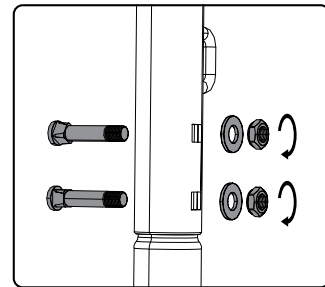

Figure 1-B

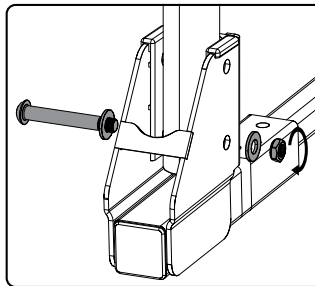

Figure 1-C

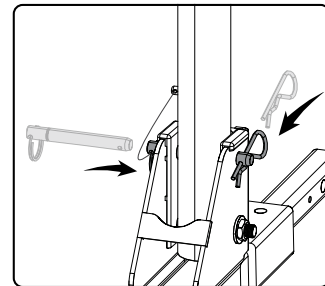
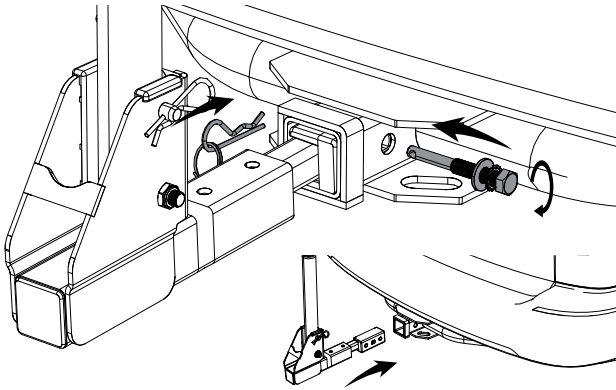

Figure 1-D

INSTALLATION

Step 1

Insert the bike rack shank into the vehicle receiver tube. Secure with 1/2" hex head bolt, flat washer, star washer and clip (#9).



Note: To adapt the 1-1/4" shank to fit a 2" receiver tube opening, assemble the U-type adapter (#4) onto the 1-1/4" shank (#3). Align the holes and secure with the two provided socket head cap screw adapters (#5).

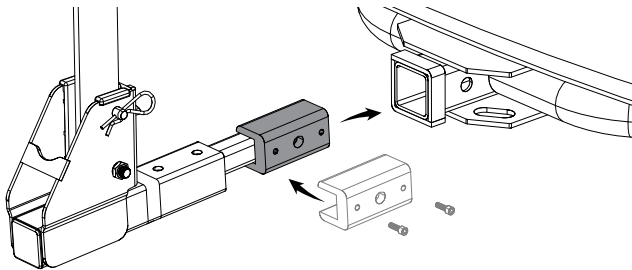
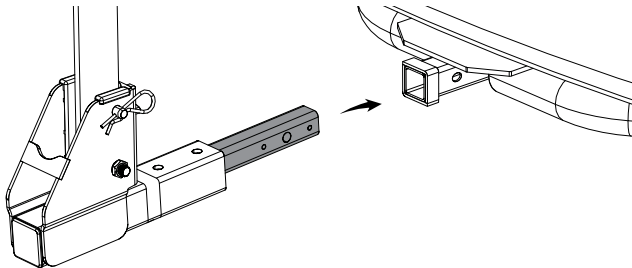

Step 2

Install the safety support strap. Loop the strap (#11) to the center section of the bike rack where the arms connect to the bike rack post, as shown in the figure below. Hook the strap buckle (#10) to the back of the tow vehicle. Cinch the strap until there is no bounce in the rack. Secure the extra strap length.

⚠ WARNING

Any bike rack with a 1-1/4" shank requires the use of a support strap (CURT #18050). Failure to use a support strap will void the warranty of the trailer hitch and bike rack.

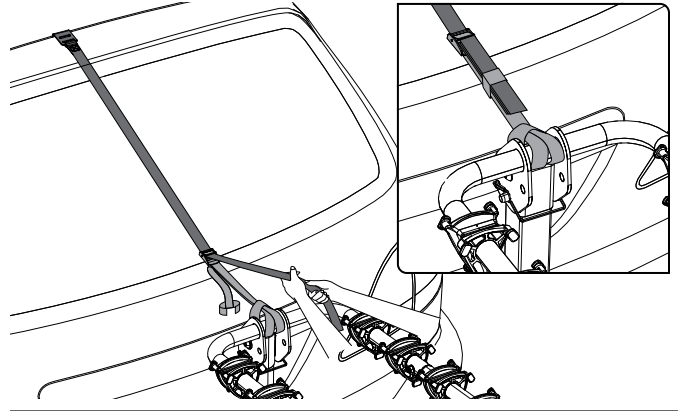

Step 3

Install the bikes on the rack and secure with the provided rubber bike arm straps (#6). Be sure to secure the cross post and seat post to the rack.

Note: When towing more than one bike, be sure to alternate the directions the bikes are facing on the rack. First bike faces right, 2nd bike faces left. See the figure below.

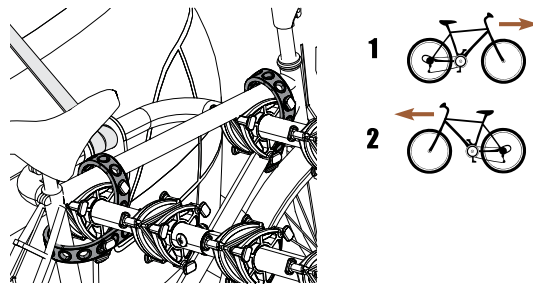

FOLDING FEATURES

Feature 1

At the base, remove the clip from the upper bolt holding the bike rack in the vertical position. Remove the bolt and tilt the rack away from the vehicle. The rear cargo area is now accessible

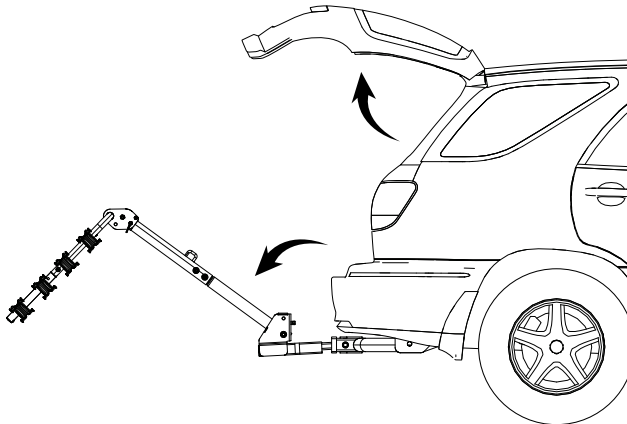

Feature 2

At the top, pull the lynch pin that secures the arms in the outward position. Fold the bike rack arms down to the transport position, and replace the lynch pin.

