

13423

ACURA RDX

07/10/2025

GROSS LOAD CAPACITY WHEN USED AS A WEIGHT CARRYING HITCH: 3,500 LBS. TRAILER WEIGHT & 350 LBS. TONGUE WEIGHT.

**WARNING: *** DO NOT EXCEED VEHICLE MANUFACTURER'S RECOMMENDED TOWING CAPACITY *****FOR MORE INFORMATION LOG ONTO WWW.CURT.MFG.COM

HAVING INSTALLATION QUESTIONS? CALL TECHNICAL SUPPORT AT 1-877-287-8634



Parts List			
ITEM	QTY	PART NUMBER	DESCRIPTION
1	4	10-10529	HHCS,M12x1.25,40,CL8.8,YZ
2	4	30-00149	WASHER, S-CON,1/2,YZ

TOOLS REQUIRED	
RATCHET	
19mm SOCKET	
EXHAUST REMOVAL PLIERS	
TORQUE WRENCH	
6" SOCKET EXTENSION	
PRYBAR	
SAFETY GLASSES	

**RUBBER ISOLATOR
REMOVAL DIAGRAM**

This technique can be used if an Exhaust Hanger Removal Pliers is not available.

Using a 5/8" open end wrench, slide the wrench up to the rubber isolator, cradling the hanger rod as shown. Next place the flat edge of a pry bar between the wrench and the hanger stop or hanger rod. Then simply rotate the pry bar toward the wrench to remove the rubber isolator.

Note: Using a spray lubricant or soapy water on the hanger rod and the rubber isolator helps removal.

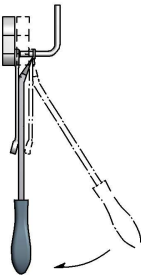

DRIVER FRAME
RAIL

EXISTING WELD NUTS
(BOTH SIDES)

PASSENGER
FRAME RAIL

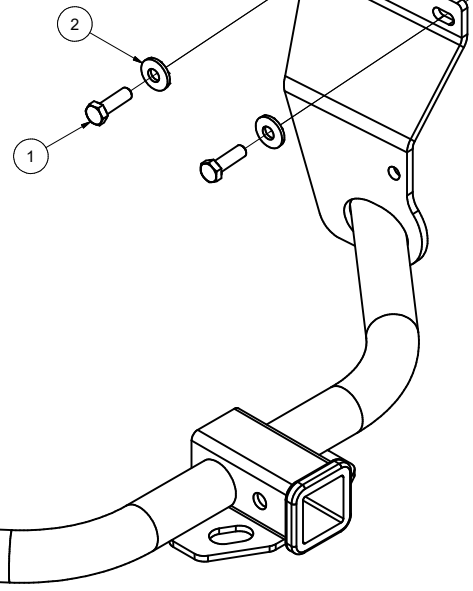
**WELDNUT CLEANING**

To remove debris from weldnuts in frame, spray lubricant or compressed air into hole. For heavy debris, use a small wire brush. (Be careful not to damage threads).

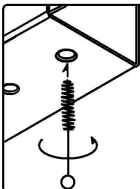

HITCH WEIGHT: 27 LBS.

INSTALL TIME

PROFESSIONAL: 30 MINUTES

NOVICE (DIY): 60 MINUTES

INSTALL NOTES:

- LOWER EXHAUST
- LOWER SPARE TIRE
- NO DRILLING

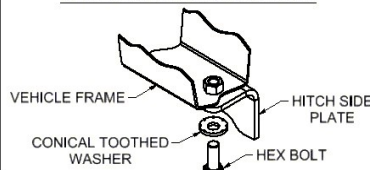
**CONICAL TOOTHED WASHER
ORIENTATION DIAGRAM**

FRONT
↑
REAR

INSTALLATION STEPS

NOTE: Hitch may interfere with functionality of liftgate sensor.

1. Lower spare tire by locating the lowering tools and mechanism.

NOTE: Consult vehicle owner manual.

2. Lower exhaust by locating and removing (2) rearmost rubber exhaust isolators from frame mounted hangers.

NOTE: Support exhaust to prevent damage.

3. Raise hitch into position, secure using provided M12 hardware.

4. Torque all M12 hardware to 60 ft-lbs.

5. Reinstall exhaust and spare tire in original vehicle position.

**PERIODICALLY CHECK THIS RECEIVER HITCH TO ENSURE THAT ALL FASTENERS
ARE TIGHT AND THAT ALL STRUCTURAL COMPONENTS ARE SOUND.**



Scan
for more
information

CURT Manufacturing LLC., warrants this product to be free of defects in material and/or workmanship at the time of retail purchase by the original purchaser. If the product is found to be defective, CURT Manufacturing LLC., may repair or replace the product, at their option, when the product is returned, prepaid, with proof of purchase. Alteration to, misuse of, or improper installation of this product voids the warranty. CURT Manufacturing LLC.'s liability is limited to repair or replacement of products found to be defective, and specifically excludes liability for incidental or consequential loss or damage.

This product complies with safety specifications and requirements for connecting devices and towing systems of the state of New York, V.E.S.C.Regulation V-5 and SAE J684.