



BX88431

Mad Flap Heat Shield

Installation Instructions

Serial Number



Mud Flap Heat Shield
1.0 mm thick stainless steel

The Heat Shield is an accessory item that protects your mud flap from high exhaust temperatures. It allows for closer installation of the Mud Flap System to your tail pipe(s) by providing heat disbursement of hot exhaust gases.

Please read these Installation Instructions in their entirety prior to installing or operating this equipment.

CAUTION

Consumer assumes all risks associated with product performance after installation. Blue Ox™ Mud Flap Heat Shield will not protect everything and everyone from harm. Results may vary depending upon vehicle types and installation. Please apply common sense to you expectations relating to product performance.

BX88431
Mud Flap Heat Shield
Installation Instructions

Important

Exhaust Systems

Note: Any Modifications to the factory installed exhaust system may void your manufacturer's warranty.

Car Washes

You must remove rock guard system before entering any drive-through car wash.

Prop 65

⚠ WARNING: This product can expose you to chemicals including chromium, which is known to the state of California to cause cancer, birth defects, or reproductive harm. For more information go to www.P65Warning.ca.gov.

Clearance

Center Hub Requires a Minimum of 1" Clearance.



Inch-Pound (in-lbs)	Foot Pounds (ft-lbs)	Newton-Meters (N-m)	Kilogram-Centimeters (kgf-cm)
20	1.7	2.3	23
30	2.5	3.4	34
70	5.87	7.9	79
80	6.7	9.0	90
180	15	20	203
1500	125	169	1690

WARNING

Ensure that vehicle exhaust is cool during alignment and install. A hot exhaust can cause severe burns.

WARNING

Mud Flap Bolt Bumpers should not be used on any vehicle with rear-facing exhaust. Remove before use.

BX88431 Mud Flap Heat Shield Installation Instructions

Tools Required

Ruler or Straight Edge
White Pencil or Chalk
Drill
3/8" Drill Bit

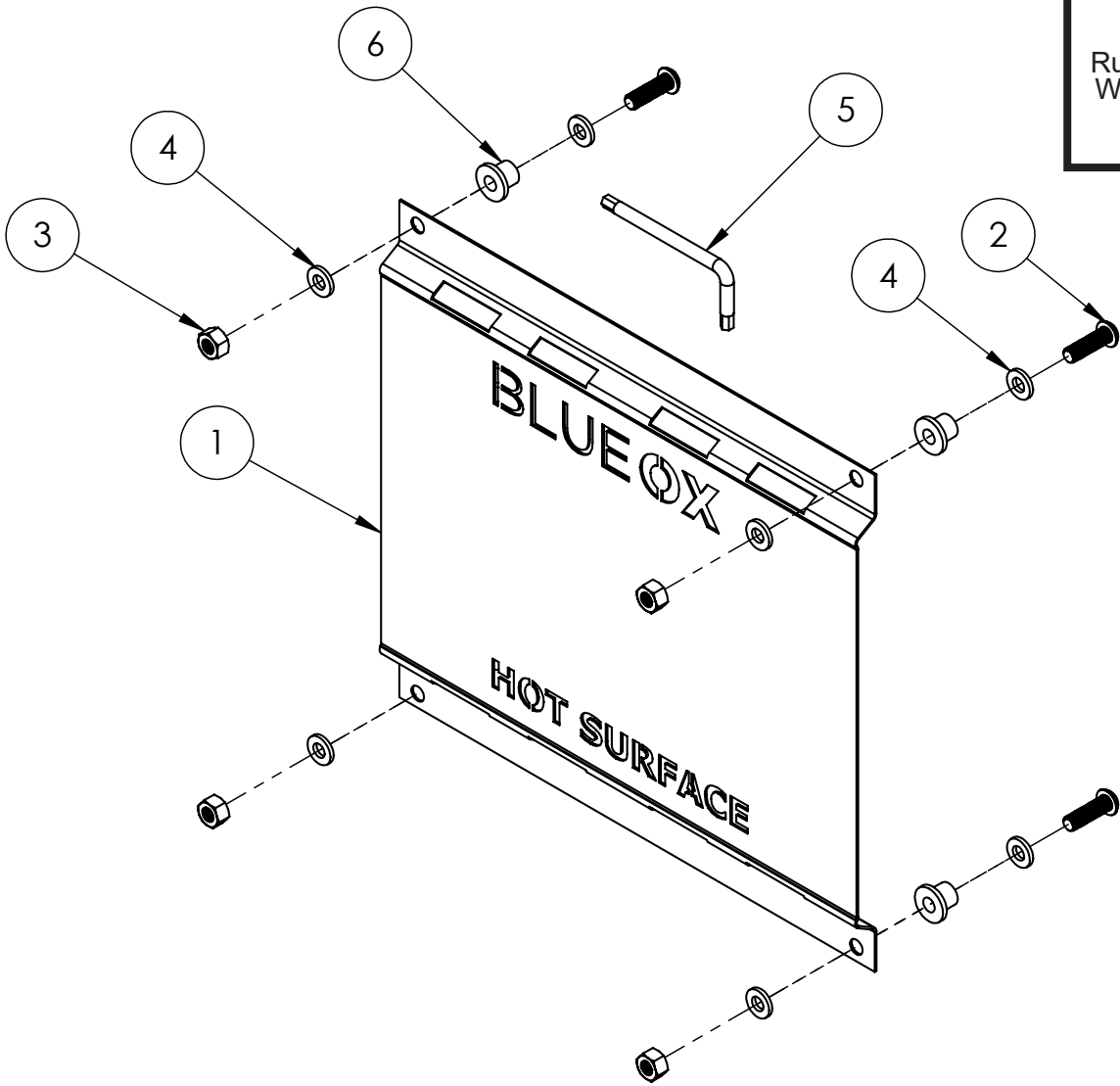

Item No.	Part No.	Description	Qty.
1.....	101-10882	Heat Shield Plate.....	1
2.....	201-1158	M6-1MM x 20 Btn Head Tamper-Resistant Torx, Grd 6..	4
3.....	202-0264	M6 x 1MM Locking Star Pin Bolt	4
4.....	203-0208	6MM Flat Oversized Washer, ZP.....	8
5.....	229-1237	6MM Tamper-Resistant Torx Wrench	1
6.....	201-1167	M6 x 10.35MM Height Ceramic Washers.....	4

Important:

Use only genuine factory replacement parts on your baseplate. Do **NOT** substitute homemade or non-typical parts. If a bolt is lost or in need of replacement, for your safety and the preservation of your baseplate, be sure to use a replacement bolt of the same grade (In most cases it will be Grade 5, please reference the parts list above). Replacement parts may be ordered through Blue Ox®. Failing to follow and/or altering these installation instructions in either installation or required equipment will void the manufacturer's warranty. Towing behind a non-motorized vehicle will void the warranty.

BX88431
Mud Flap Heat Shield
Installation Instructions

Installation Instructions:

1. Mud Flap System must be installed on the vehicle. To locate the correct placement for the heat shield, it must be placed directly in line with the vehicle exhaust.
NOTE: Tape a ruler or straight edge onto the exhaust to help with alignment of Mud Flap Heat Shield. Failure to properly align Mud Flap Heat Shield with exhaust gases will result in damage.
2. Place the Mud Flap Heat Shield on the Mud Flap, make note of the four (4) bolt holes at the corner of the Mud Flap Heat Shield.
3. Using a pencil or chalk, carefully mark the location of the four (4) bolt holes onto the Mud Flap.
4. Use either a 3/8" (9.52mm) drill bit or hole punch to carefully cut the four (4) holes in the Mud Flap.
5. Insert the ceramic spacers in the four (4) holes in the Mud Flap on the vehicle side of the Mud Flap and align the Mud Flap Heat Shield.
6. Attach the Mud Flap Heat Shield with the locking star pin bolts, M6 flat washers and M6 nylon insert hex nuts using included star pin wrench to 20 in-lbs torque.

WARNING: Do not overtighten hardware, as it will damage the Mud Flap Heat Shield.

BX88431
Mud Flap Heat Shield
Installation Instructions

Mud Flap Systems

BX88420	Mud Flap System, 2" Hitch
BX88421	Mud Flap System, 2-1/2" Hitch

Mud Flap System Accessory Kits

BX88429	Kit, Mud Flap Exhaust Outlet 2 Pack
BX88430	Kit, Mud Flap Rock Screen
BX88435	Kit, Mud Flap 3" Center Hub
BX88436	Kit, Mud Flap Wall Mount
BX88437	Kit, Mud Flap Trim Plates

CUSTOMER SERVICE COMMITMENT

Blue Ox® is committed to providing you with exceptional customer care throughout your lifetime with our products. Our team is here to assist you with any questions you may have regarding the performance of your product. Simply call (402) 385-3051 and you can speak with our technical service team.

Additionally, please visit our website to see which rallies our team will be attending. For a nominal fee, our service technician will service your towing system to ensure it's in proper working condition. Also, as a commitment to our customers, should you visit our factory, you can stay at our full service Blue Ox® campground at no charge along with enjoying a factory tour.

Again, thank you for being our customer and for the confidence you have shown in the performance of our products. It is because of customers like you we enjoy the success we have today.

© 2022 Blue Ox
One Mill Road, Industrial Park
Pender, Nebraska 68047
Phone: (402) 385-3051
Fax: (402) 385-3360
www.blueox.com