



BX3211 Installation Instructions 1997-03 Pontiac Grand Prix GT

Utilization of Blue Ox baseplates with any tow bar not approved by Automatic Equipment Manufacturing Company invalidates the limited warranty.

Installation of this baseplate requires removing the air dam. The air dam and the plastic piece that the air dam was mounted on will need to be notched. Holes in the engine cradle will need to be drilled out.

1. Baseplate mounts to the bottom of the steel inner bumper and the engine cradle using 5 bolts supplied with the baseplate. Note: This baseplate is heavy and awkward to handle. A second person should be used when positioning and starting bolts.
2. Hanging below the radiator is a vertical air dam. It is attached to another plastic part w/ springs. Unhook the springs and remove the air dam.
3. There is a black plastic shroud inside the bumper and in front of the radiator. The outside lower ends of the shroud will interfere with positioning the baseplate. Just outside the shroud you can see the steel inner bumper. There are two 3/8" holes on each side of the bottom of the steel bumper. The baseplate will bolt the inner pair of these. Hold the baseplate under the bumper in its approximate position. The rear braces will match up to three hexagonal holes in the black engine cradle. The plastic piece the air dam was mounted on will also need to be notched. Also note which hex holes will be used for the baseplate.
4. Notch the plastic parts and drill out the three hex holes to 17/32".
5. Bend the wire nuts so they will position over the appropriate holes.
6. With an assistant guide the baseplate into its mounted position. You will need to start the tabs through the grill and then tip the back of the baseplate into position. When the baseplate aligns with the holes, apply loctite to all bolts and start them. When all bolts are started, tighten completely.
7. Hold the air dam in position, it will need to be notched. Notch the air dam and replace it.
8. The dimensional variations between otherwise identical cars can be considerable. While the location and size of the holes in the baseplate were designed to allow for easy installation, it may be necessary to file a hole slightly to allow a bolt to clear.
9. Do not substitute other devices if the tow bar pin and clip are lost.
10. Install the tow bar and safety cables according to the instructions included in their packages.
11. **DEALER OR INSTALLER: BE CERTAIN THE USER RECEIVES THE INSTRUCTION SHEET.**

Automatic

	Tools Required	
17/32" Drill Bit	3/4" Wrench	Drill
9/16" Socket	Ratchet	Loctite
Utility knife		

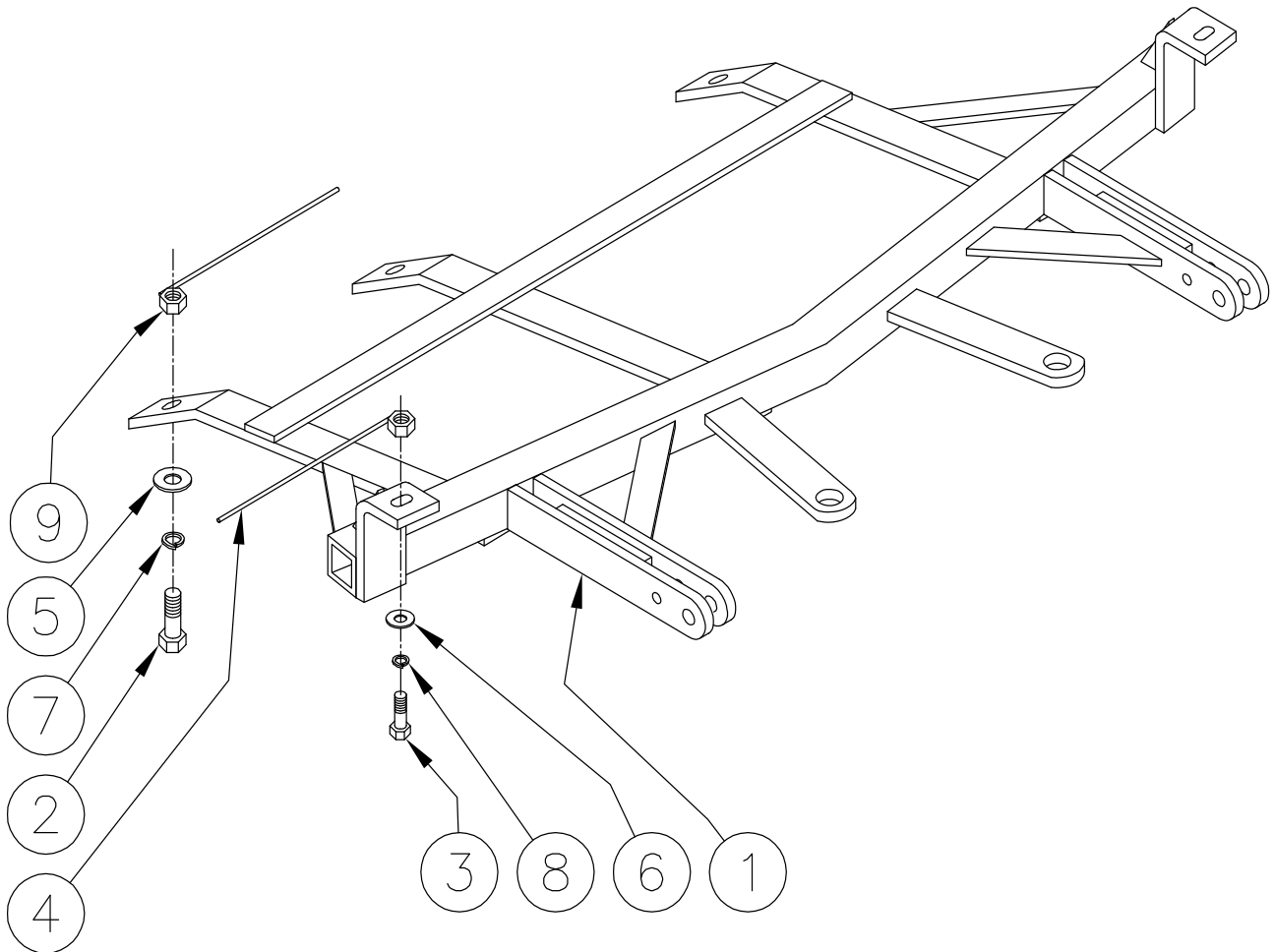

Parts List

Ref. No.	Qty.	Part No.	Description
1	1	61-5160	Weldment, Baseplate, BX3211
2	3	201-0051	1/2-13 x 1 1/2, Hex Bolt
3	2	201-0368	3/8-16 x 1 1/4, Hex Bolt
4	2	61-4978	3/8-16 Weldnut
5	3	203-0005	1/2 Flatwasher
6	2	203-0003	3/8 Flatwasher
7	3	203-0012	1/2 Lockwasher
8	2	203-0010	3/8 Lockwasher
9	3	61-4029	1/2-13 Weldnut

General Information

1. Ensure that your product(s) are registered online at www.blueox.com. It is crucial to register your product(s) so that you may be alerted of product offerings, updates, upgrades, maintenance and safety bulletins, and/or recalls.
2. **It is the owner's responsibility to inspect all towing equipment for cracked welds, missing or worn parts and loose bolts before each towing trip.** Be sure to use Loctite® Red on all bolts and tighten to the recommended specifications.
3. **It is the owner's responsibility to hook up all towing equipment per manufacturer's instructions/recommendations.**
4. Remove the attachment tabs when not in use (if applicable).

Notice To Baseplate Installer

1. It is YOUR responsibility to watch for:

- Oil cooler and air conditioner lines
- Electrical wires and hoses
- Missing parts or attaching points on the frame

** If the baseplate is improperly installed and is against a wire or hose, it could cause fluid leaks or electrical shorts some time after the actual baseplate installation.

Permanent Baseplate Safety Cable Installation

Permanent baseplate safety cables are strongly recommended when towing a vehicle with a tow bar. The principle function of the permanent baseplate safety cables is to prevent the towed vehicle from breaking loose in the event the connection between the frame of the towed vehicle and the baseplate fails or becomes disconnected. The cables must be connected from the baseplate to the frame rail or cross member of the vehicle's frame. The illustrations below show the possible arrangements recommended by Blue Ox®. Each permanent baseplate safety cable must have an adequate weight rating for the towing system. The weight rating of the two (2) cables together will not qualify.

Do not mount the permanent baseplate safety cables against wires, hoses or brake lines.

These permanent baseplate safety cables should remain installed as long as the baseplate is installed on the vehicle. Permanent baseplate safety cables are to be used in conjunction with, and NOT a replacement for legally required safety cables attaching the towed vehicle to the towing vehicle.

OPTION #1

Permanent Baseplate Safety Cables to Cross Member or Frame of Towed Vehicle.



OPTION #2

Permanent Baseplate Safety Cables to Cross Member or Frame of Towed Vehicle.

