



BX2402 Installation Instructions
1989-93 Isuzu Amigo (2WD & 4WD)
1995-97 Isuzu Rodeo
1988 1/2-93 Isuzu Pickup (2WD & 4WD)
1995-97 Honda Passport

1. Read the General Instruction Sheet included with this baseplate.
2. The baseplate mounts to the front underside of the vehicle using six bolts: three on each side.
3. Remove the two bolts on each side which attach the bumper bracket to the chassis. A 17mm socket is required. Note the nuts are welded to the frame and the bumper stays in position.
4. There are two chassis mount assemblies provided, a left and a right. The bolt "pockets" on these are attached to the vehicle at the same place where the bumper bolts were removed. The "pockets" are open to the outside. In order to position the mount assemblies, carefully slide the bumper forward, one side at a time, until the bracket just clears the frame. The mount assembly will then slide onto the bumper bracket such that the "pockets" align with the holes. Slide the bumper back into position on the frame. Put a 1/2" lock washer on two 12mm bolts, apply Loctite, and assemble LOOSELY through the bolt pockets; a 19mm socket is required. Note that the "front to back hole" on the "inner" angle part of the mount assembly aligns to a hole in a box section of the frame. Put a 1/2" flat washer and some Loctite on a 1/2" x 1" bolt and slide it through from the rear. LOOSELY install a 1/2" lockwasher and a nut. Repeat these steps on the other side.
5. The main cross angle is attached to each chassis mount assembly, with two 1/2" x 1 1/2" bolts. Apply loctite and install the bolts.
6. Tighten the two 12mm bolts on each side and the four 1/2" bolts for the cross angle alternately on each side until firm.
7. Last, tighten the 1/2" x 1" bolts that are through the angles and oriented front to back. Tighten these very firmly to assure the chassis and mount assembly are contacting each other.
8. The dimensional variations between otherwise identical cars can be considerable. While the location and size of the holes in the baseplate were designed to facilitate easy installation, it may be necessary to file a hole slightly to allow a bolt to clear.
9. Install the tow bar and safety cables according to the instructions included in their packages.
10. Do not substitute other devices if the pin and clip are lost.
11. DEALER OR INSTALLER: BE CERTAIN THE USER RECEIVES THE INSTRUCTION SHEET.

Automatic

Page 1 of 2 292-0988 Rev. B 12/29/10

Tools Required

19mm Socket

3/4 Socket

17mm Socket

Parts List

Ref. No.	Qty.	Part No.	Description
1	1	61-3497	Baseplate, BX2402
2	1	61-4136	Weldment, Rear Bracket, PS
3	1	61-4137	Weldment, Rear Bracket, DS
4	4	201-0051	1/2-13 x 1 1/2 Hex Head Bolt, Grade 5
5	2	201-0060	1/2-13 x 1 Hex Head Bolt, Grade 5
6	4	201-0411	12mm-1.25 x 40 mm Hex Head Bolt
7	6	202-0005	1/2-13 Hex Nut
8	2	203-0005	1/2 Flat Washer
9	6	203-0012	1/2 Lock Washer
10	4	203-0105	12mm Lock Washer
	2	226-0046	Baseplate Safety Cable, 36" CL III (Not Shown)
	4	229-0359	Quicklink, 3/8, ZP (Not Shown)

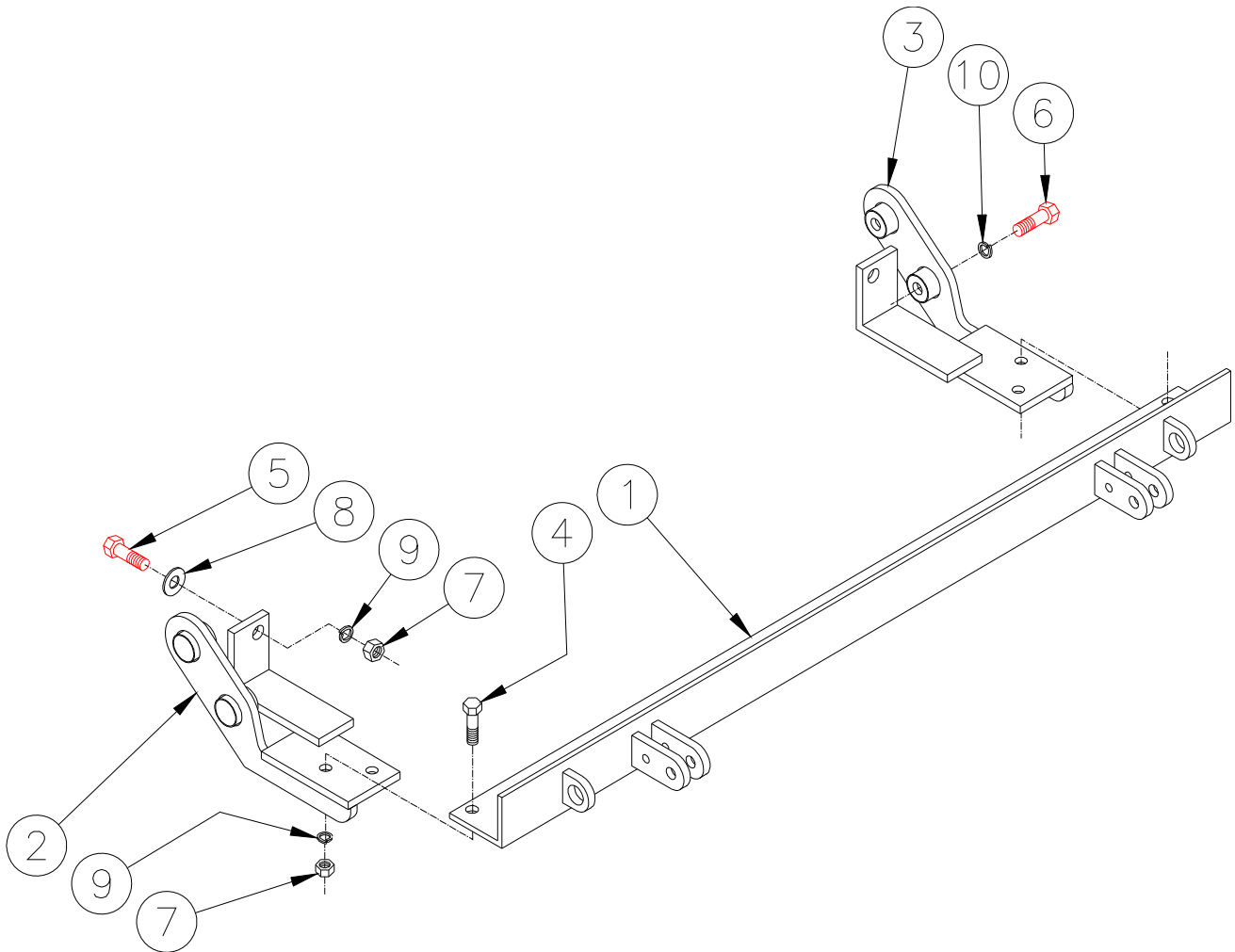

General Information

1. Ensure that your product(s) are registered online at www.blueox.com. It is crucial to register your product(s) so that you may be alerted of product offerings, updates, upgrades, maintenance and safety bulletins, and/or recalls.
2. **It is the owner's responsibility to inspect all towing equipment for cracked welds, missing or worn parts and loose bolts before each towing trip.** Be sure to use Loctite® Red on all bolts and tighten to the recommended specifications.
3. **It is the owner's responsibility to hook up all towing equipment per manufacturer's instructions/recommendations.**
4. Remove the attachment tabs when not in use (if applicable).

Notice To Baseplate Installer

1. It is YOUR responsibility to watch for:

- Oil cooler and air conditioner lines
- Electrical wires and hoses
- Missing parts or attaching points on the frame

** If the baseplate is improperly installed and is against a wire or hose, it could cause fluid leaks or electrical shorts some time after the actual baseplate installation.

Permanent Baseplate Safety Cable Installation

Permanent baseplate safety cables are strongly recommended when towing a vehicle with a tow bar. The principle function of the permanent baseplate safety cables is to prevent the towed vehicle from breaking loose in the event the connection between the frame of the towed vehicle and the baseplate fails or becomes disconnected. The cables must be connected from the baseplate to the frame rail or cross member of the vehicle's frame. The illustrations below show the possible arrangements recommended by Blue Ox®. Each permanent baseplate safety cable must have an adequate weight rating for the towing system. The weight rating of the two (2) cables together will not qualify.

Do not mount the permanent baseplate safety cables against wires, hoses or brake lines.

These permanent baseplate safety cables should remain installed as long as the baseplate is installed on the vehicle. Permanent baseplate safety cables are to be used in conjunction with, and NOT a replacement for legally required safety cables attaching the towed vehicle to the towing vehicle.

OPTION #1

Permanent Baseplate Safety Cables to Cross Member or Frame of Towed Vehicle.



OPTION #2

Permanent Baseplate Safety Cables to Cross Member or Frame of Towed Vehicle.

