



## BX2205 Installation Instructions 1984-85 Honda Accord

Installation of this baseplate requires removing the plastic belly pan.

1. Read the General Instruction Sheet included with this baseplate.
2. The tow bar consists of a permanently mounted baseplate, two tie down clamps, two bumper brackets and a detachable tow bar.
3. The baseplate mounts to the front underside of the vehicle using eight bolts, four on each side, using four which are provided and four existing,
4. Remove the plastic belly pan. The two plastic push pins at the front outside corners are removed by pulling down on the pin head with pliers.
5. Remove the two bolts which secure the front bumper to its mounting brackets. These bolts are accessible through holes in the plastic trim located just below the bumper.
6. Place a jack below the center of the engine support cross brace and raise it enough to hold the cross brace in position when removing the four bolts that secure it to the frame.
7. Remove the two bolts and inspect them for reuse. See General Instruction Sheet.
8. Position the baseplate by inserting the short tube on the baseplate into the metal core of the rubber cross brace bushing. Hand start the four cross brace bolts.
9. Using the 10mm bolts which are provided, loosely install the two bumper brackets through the holes in the plastic trim into the bumper. Note the right and left brackets.
10. Fasten the bumper brackets to the baseplate using the 3/8" bolts, lock washers and nuts which are provided.
11. Insert the small square part of the tie down clamps into the large upper end of the oblong hole in the tie down brackets on the vehicle. These brackets are stamped metal parts with an oblong hole facing downward and are welded to each side of the vehicle.
12. Slide the 1/2" spacer washers between the baseplate sides and the tie down bracket outer sides.
13. Install the 1/2" bolts, lock washers and nuts through this assembly.
14. When all bolts align, attach the baseplate to the vehicle.
15. Replace plastic belly pan.
16. The dimensional variations between otherwise identical vehicles can be considerable. While the location and size of the holes in the baseplate were designed to allow easy installation, it may be necessary to file a hole slightly to allow a bolt to clear.
17. Install the tow bar and safety cables according to the instructions included in their packages.
18. Do not substitute other devices if the tow bar pin and clip are lost.
19. **DEALERS AND INSTALLERS:** BE CERTAIN THE USER RECEIVES THE INSTRUCTION SHEET.

# Automatic

## Tools Required

3/4 Socket	10mm Socket	14mm Socket	17mm Socket
3/4 Open End Wrench	Jack	Pliers	Socket Extension

## Parts List

Ref. No.	Qty.	Part No.	Description
1	1	61-3313	Tie Down Clamp, Passenger's Side
2	1	61-3314	Tie Down Clamp, Driver's Side
3	1	61-3326	Mount Bracket, Driver's Side
4	1	61-3327	Main Baseplate Assembly
5	1	61-3328	Mount Bracket, Passenger's Side
6	2	102-2930	Spacer Washer
7	2	201-0051	1/2-13 x 1 1/2 Hex Bolt
8	2	201-0427	10mm-1.25 x 100mm Hex Bolt/ 14mmHdHxBlt
9	4	201-0443	3/8-16 x 1 Hex Bolt
10	4	202-0003	3/8-16 Hex Nut
11	2	202-0005	1/2-13 Hex Nut
12	4	203-0010	3/8 Lock Washer
13	2	203-0012	1/2 Lock Washer
14	2	203-0104	10mm Lock Washer
	2	226-0046	Baseplate Safety Cable, 36" CL III (Not Shown)
	2	229-0359	Quicklink, 3/8, ZP (Not Shown)

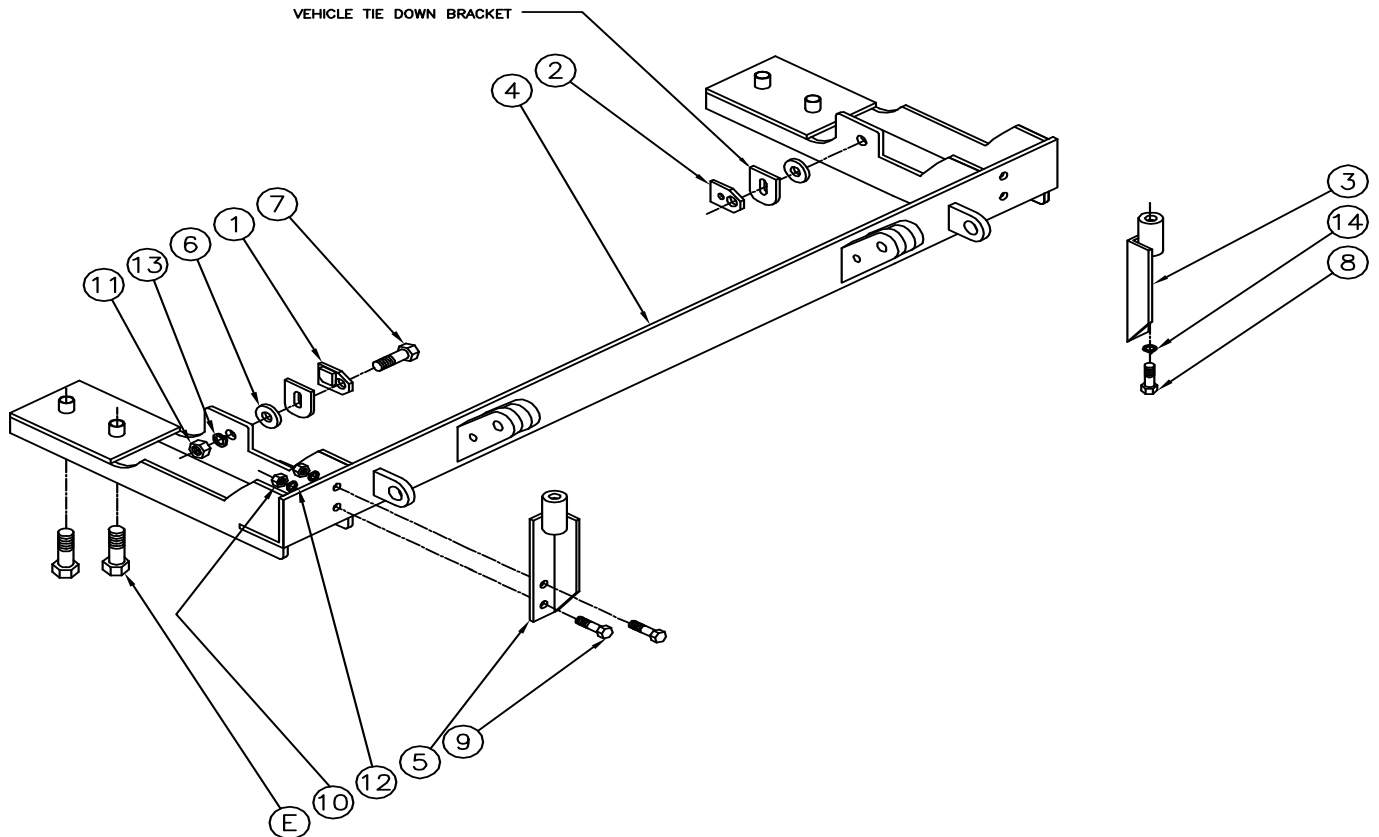

# General Information

1. Ensure that your product(s) are registered online at [www.blueox.com](http://www.blueox.com). It is crucial to register your product(s) so that you may be alerted of product offerings, updates, upgrades, maintenance and safety bulletins, and/or recalls.
2. **It is the owner's responsibility to inspect all towing equipment for cracked welds, missing or worn parts and loose bolts before each towing trip.** Be sure to use Loctite® Red on all bolts and tighten to the recommended specifications.
3. **It is the owner's responsibility to hook up all towing equipment per manufacturer's instructions/recommendations.**
4. Remove the attachment tabs when not in use (if applicable).

## Notice To Baseplate Installer

### 1. It is YOUR responsibility to watch for:

- Oil cooler and air conditioner lines
- Electrical wires and hoses
- Missing parts or attaching points on the frame

\*\* If the baseplate is improperly installed and is against a wire or hose, it could cause fluid leaks or electrical shorts some time after the actual baseplate installation.

## Permanent Baseplate Safety Cable Installation

Permanent baseplate safety cables are strongly recommended when towing a vehicle with a tow bar. The principle function of the permanent baseplate safety cables is to prevent the towed vehicle from breaking loose in the event the connection between the frame of the towed vehicle and the baseplate fails or becomes disconnected. The cables must be connected from the baseplate to the frame rail or cross member of the vehicle's frame. The illustrations below show the possible arrangements recommended by Blue Ox®. Each permanent baseplate safety cable must have an adequate weight rating for the towing system. The weight rating of the two (2) cables together will not qualify.

***Do not mount the permanent baseplate safety cables against wires, hoses or brake lines.***

These permanent baseplate safety cables should remain installed as long as the baseplate is installed on the vehicle. Permanent baseplate safety cables are to be used in conjunction with, and NOT a replacement for legally required safety cables attaching the towed vehicle to the towing vehicle.

### OPTION #1

Permanent Baseplate Safety Cables to Cross Member or Frame of Towed Vehicle.

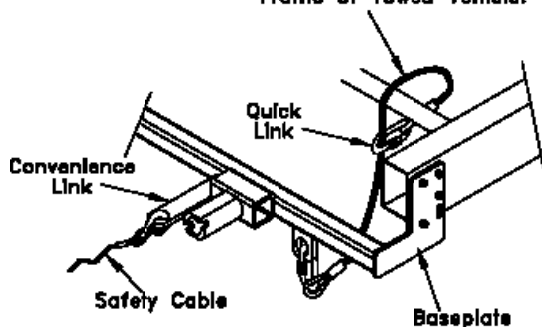

### OPTION #2

Permanent Baseplate Safety Cables to Cross Member or Frame of Towed Vehicle.

