



Strong As An Ox™

**BX1959 Installation Instructions
1995-2000 Plymouth Breeze**

Serial No.

The headlight assembly, front fascia and windshield washer reservoir are removed for baseplate installation. Drilling is required. Trimming of air dam on is required on some models. The BX8869 is available for the vehicle. Attachment Tabs are 24 inches center to center and a height of 13 inches.



1. Remove two torx bolts from the top side of headlight assembly with the T-30 torx, pull assembly forward, unplug electrical connections, and set aside, both sides.



2. Just between headlights, on fascia's edge, are five push pins to remove.



3. Just forward of front tire is one metric bolt to remove with the 10MM socket, both sides.



4. Remove two push pins from fascia's upper opening.



5. On bottom edge of fascia are eight push pins to remove, pull fascia forward and set aside.



Strong As An Ox™



6. Remove two front metric bolts from washer reservoir bracket on the passenger's side with the 10MM socket. Slide baseplate between reservoir bracket and frame. Align baseplate with the top edge of frame, as far forward as possible and clamp in place with vise grip, both sides.



7. Using the baseplate as a template, drill the four holes with the 13/32" drill bit, both sides. Insert 3/8-16 x 1" bolt through baseplate into drilled hole and tighten hex nut and lock washer, according to drawing on page 3, both sides. **Be sure to use loctite on all bolts before tightening. Tighten all bolts according to Torque Chart in General Instruction Sheet.**

8. Reinstall washer reservoir with existing bolts, fascia and headlight assemblies. **Be sure all electrical components and hoses are plugged in properly.**
9. The dimensional variations between otherwise identical cars can be considerable. While the location and size of the holes in the baseplate were designed to allow for easy installation, it may be necessary to file a hole slightly to allow a bolt to clear.
10. Install the tow bar and safety cables according to the instructions included in their packages.
11. Do **not** substitute other devices if the tow bar pin and clip are lost.
12. **DEALER OR INSTALLER: BE CERTAIN THE USER RECEIVES THE INSTRUCTION SHEET.**

Tools Required

| | | |
|-----------------------|---------------|------------------|
| 7MM Socket | 10MM Socket | 11MM Socket |
| 13MM Socket | Loctite | 13/32" Drill Bit |
| Phillips Screw Driver | Vise Grips | 9/16" Socket |
| Pry Bar | Utility Knife | |



Strong As An Ox™

Parts List

| Ref. No. | Qty. | Part No. | Description |
|----------|------|----------|--|
| 1 | 1 | 61-5917 | Weldment, Base Plate, BX1959 |
| 2 | 8 | 201-0443 | 3/8-16 x 1 Bolt, Grd. 5, ZP |
| 3 | 8 | 203-0010 | 3/8 Lock Washer, ZP |
| 4 | 8 | 202-0003 | 3/8-16 Hex Nut, ZP |
| 5 | 2 | 201-0979 | #12-14 x 1" Self Drilling Screw, ZP |
| 6 | 2 | 202-0047 | #10-32 Hex Nut |
| 7 | 2 | 203-0054 | #10 Lock Washer |
| 8 | 2 | 201-0192 | #10-32 x 1/2 Slot, Rd. Hd. Screw |
| 9 | 2 | 101-5822 | Adapter, 4 Way Connector |
| E | 2 | | Existing Metric Bolts |
| | 2 | 226-0046 | Baseplate Safety Cable, 36" CL III (Not Shown) |
| | 2 | 229-0359 | Quicklink, 3/8, ZP (Not Shown) |

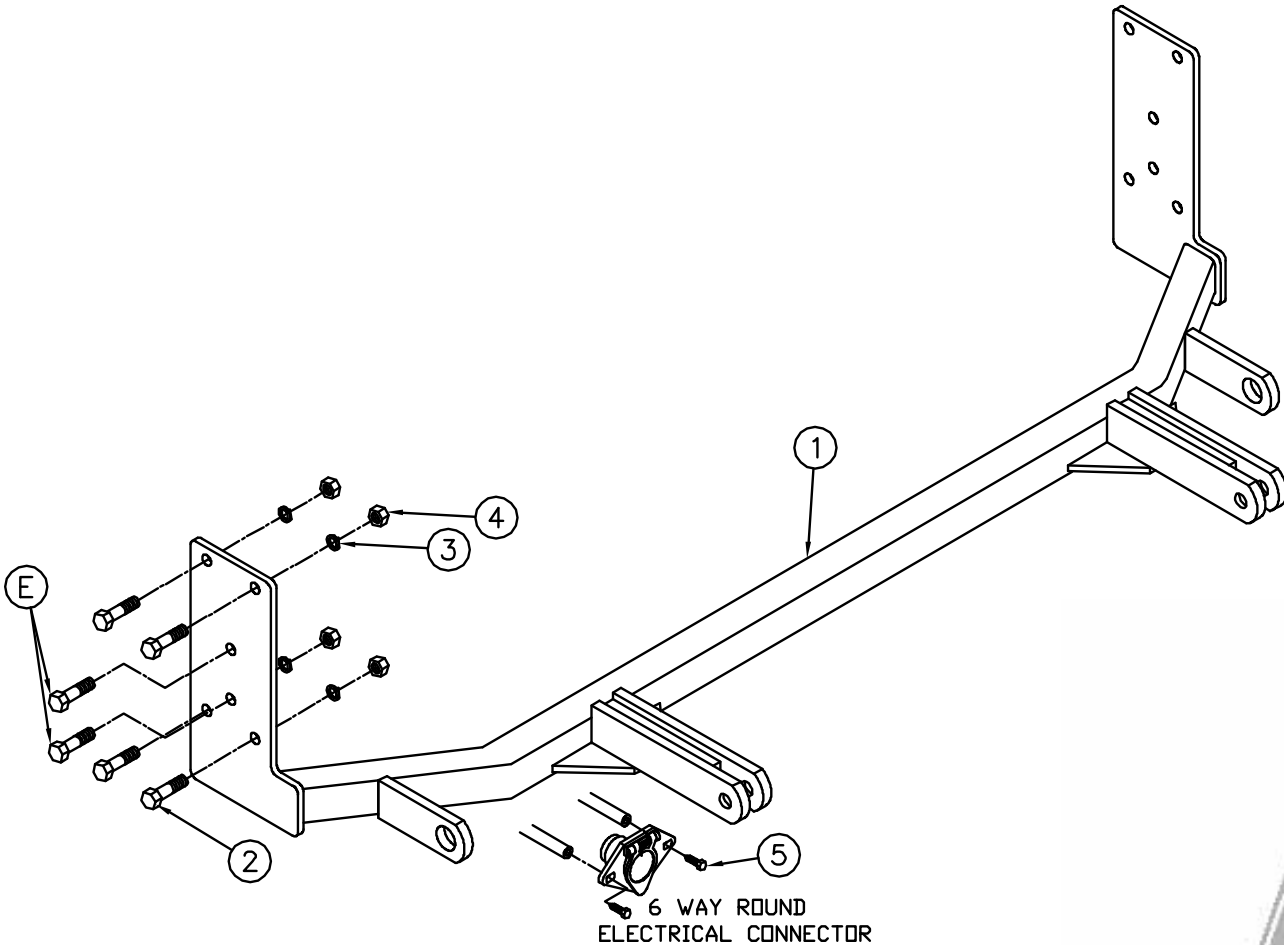

IMPORTANT: Use only genuine factory replacement parts on your Base Plate. Do not substitute homemade or nontypical parts. If a bolt is lost or in need of replacement, for your safety and the preservation of your Base Plate, be sure to use a replacement bolt of the same grade (Usually Grade 5, refer to parts list). Repair parts may be ordered through your nearest **Blue Ox** dealer or distributor.

General Information

1. Ensure that your product(s) are registered online at www.blueox.com. It is crucial to register your product(s) so that you may be alerted of product offerings, updates, upgrades, maintenance and safety bulletins, and/or recalls.
2. **It is the owner's responsibility to inspect all towing equipment for cracked welds, missing or worn parts and loose bolts before each towing trip.** Be sure to use Loctite® Red on all bolts and tighten to the recommended specifications.
3. **It is the owner's responsibility to hook up all towing equipment per manufacturer's instructions/recommendations.**
4. Remove the attachment tabs when not in use (if applicable).

Notice To Baseplate Installer

1. It is YOUR responsibility to watch for:

- Oil cooler and air conditioner lines
- Electrical wires and hoses
- Missing parts or attaching points on the frame

** If the baseplate is improperly installed and is against a wire or hose, it could cause fluid leaks or electrical shorts some time after the actual baseplate installation.

Permanent Baseplate Safety Cable Installation

Permanent baseplate safety cables are strongly recommended when towing a vehicle with a tow bar. The principle function of the permanent baseplate safety cables is to prevent the towed vehicle from breaking loose in the event the connection between the frame of the towed vehicle and the baseplate fails or becomes disconnected. The cables must be connected from the baseplate to the frame rail or cross member of the vehicle's frame. The illustrations below show the possible arrangements recommended by Blue Ox®. Each permanent baseplate safety cable must have an adequate weight rating for the towing system. The weight rating of the two (2) cables together will not qualify.

Do not mount the permanent baseplate safety cables against wires, hoses or brake lines.

These permanent baseplate safety cables should remain installed as long as the baseplate is installed on the vehicle. Permanent baseplate safety cables are to be used in conjunction with, and NOT a replacement for legally required safety cables attaching the towed vehicle to the towing vehicle.

OPTION #1

Permanent Baseplate Safety Cables to Cross Member or Frame of Towed Vehicle.

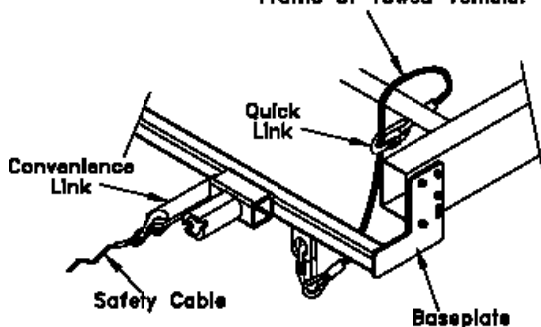

OPTION #2

Permanent Baseplate Safety Cables to Cross Member or Frame of Towed Vehicle.

