



Strong As An Ox™

**BX1645 Installation Instructions
2002 Chevy Avalanche 2500/ 4 x 4**

Serial No.

The baseplate mounts to the main frame, using two holes of the tow hooks and two drilled holes. The lower bumper molding should be removed for installation. This vehicle weighs over 5000lbs. and requires a Class IV rated tow bar and safety cables. The Bx8869 is recommended for this vehicle. Attachment tabs are 27 inches center to center and at 21 inches height.

1. Remove the plastic push pins that attach the lower plastic to the metal bumper and pull plastic off. **NOTE: This is not necessary, but will make the installation and trimming easier.**
2. Remove the inside and bottom bolts from each tow hook. Hold the baseplate, item 1, up to the frame so the baseplate bolt holes align with the tow hook bolt holes. Tighten items 2, 3 and 4 according to drawing on page 2.. **Be sure and use loctite on all bolts before tightening.** Tighten and torque each bolt according to the chart in the General Instruction Sheet.
3. Using the baseplate as a template, drill remaining two holes on the bottom of baseplate with the 17/32" drill bit. Insert items 2 and 3 into drill holes in baseplate and tighten item 5 according to drawing on page 2. **Be sure and use loctite on all bolts before tightening.** Tighten and torque each bolt according to the chart in the General Instruction Sheet.
4. Remove the remaining hex bolt that holds the tow hooks. Take the tow hook closure, item 7, and slide the open end over the end of the truck's tow hook. The other end bolts back to the bolt hole for the tow hook using items 3 and 7. **Be sure and use loctite on all bolts before tightening..** Tighten and torque each bolt according to the chart in the General Instruction Sheet.
5. Replace the bumper molding. The inside area on plastic openings where the attachment tabs should extend through, will need to be trimmed.
6. The dimensional variations between otherwise identical cars can be considerable. While the location and size of the holes in the baseplate were designed to allow for easy installation, it may be necessary to file a hole slightly to allow a bolt to clear.
7. Install the tow bar and safety cables according to the instructions included in their packages.
8. Do **not** substitute other devices if the tow bar pin and clip are lost.
9. **DEALER OR INSTALLER: BE CERTAIN THE USER RECEIVES THE INSTRUCTION SHEET.**





Strong As An Ox™

Tools Required

19MM Socket
Utility Knife

Loctite Blue
Phillips Screw Driver

17/32" Drill Bit

Parts List

Ref. No.	Qty.	Part No.	Description
1	1	61-5785	Weldment, Base Plate, BX1645
2	6	201-0415	12MM-1.75 x 50MM Hex Bolt Grd. 8.8, ZP
3	10	203-0105	12MM Lock Washer, ZP
4	4	203-0112	12MM Flat Washer, ZP
5	4	202-0117	12MM-1.75 Hex Nut, ZP
6	2	107-2495	Tow Hook Closure, BX1645
7	2	201-0669	12MM-1.75 x 40MM, Hex Bolt, Grd. 8.8, ZP
8	4	201-0050	1/4-20 x 3/4, Hex Bolt, Grd. 5, ZP
9	4	203-0008	1/4 Lock Washer, ZP
10	4	203-0001	1/4 Flat Washer, ZP
11	4	202-0069	1/4-20 Hex Flange Whiz Lock Nut, ZP
12	2	201-0192	#10-32 x 1/2 Slot, Rd. Hd. Screw
13	2	203-0054	#10 Lock Washer
14	2	202-0047	#10-32 Hex Nut
15	2	101-5822	Adapter, 4 Way Connector
16	1	101-6135	Electrical Bracket
	2	226-0049	Baseplate Safety Cable, 36" CL IV (Not Shown)
	4	229-0512	Quicklink, 1/2, ZP (Not Shown)

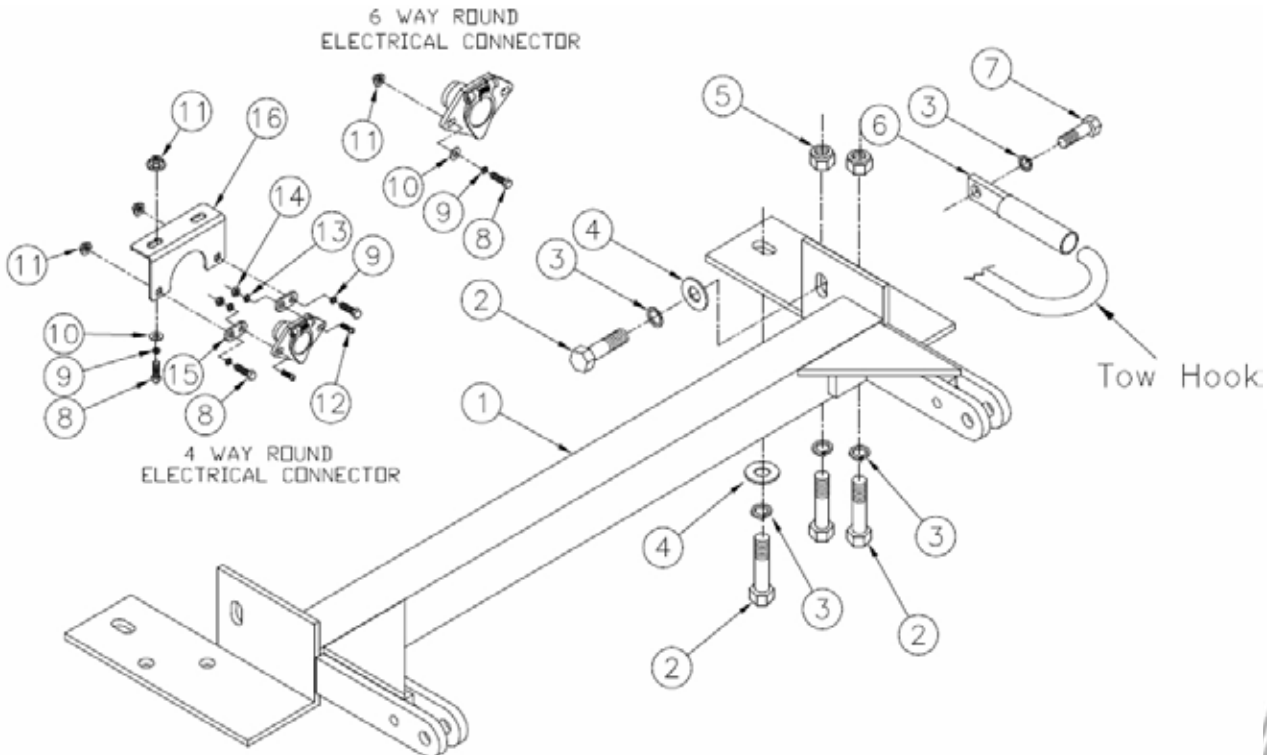

IMPORTANT: Use only genuine factory replacement parts on your Base Plate. Do not substitute homemade or nontypical parts. If a bolt is lost or in need of replacement, for your safety and the preservation of your Base Plate, be sure to use a replacement bolt of the same grade (Usually Grade 5, refer to parts list). Repair parts may be ordered through your nearest **Blue Ox** dealer or distributor.

General Information

1. Ensure that your product(s) are registered online at www.blueox.com. It is crucial to register your product(s) so that you may be alerted of product offerings, updates, upgrades, maintenance and safety bulletins, and/or recalls.
2. **It is the owner's responsibility to inspect all towing equipment for cracked welds, missing or worn parts and loose bolts before each towing trip.** Be sure to use Loctite® Red on all bolts and tighten to the recommended specifications.
3. **It is the owner's responsibility to hook up all towing equipment per manufacturer's instructions/recommendations.**
4. Remove the attachment tabs when not in use (if applicable).

Notice To Baseplate Installer

1. It is YOUR responsibility to watch for:

- Oil cooler and air conditioner lines
- Electrical wires and hoses
- Missing parts or attaching points on the frame

** If the baseplate is improperly installed and is against a wire or hose, it could cause fluid leaks or electrical shorts some time after the actual baseplate installation.

Permanent Baseplate Safety Cable Installation

Permanent baseplate safety cables are strongly recommended when towing a vehicle with a tow bar. The principle function of the permanent baseplate safety cables is to prevent the towed vehicle from breaking loose in the event the connection between the frame of the towed vehicle and the baseplate fails or becomes disconnected. The cables must be connected from the baseplate to the frame rail or cross member of the vehicle's frame. The illustrations below show the possible arrangements recommended by Blue Ox®. Each permanent baseplate safety cable must have an adequate weight rating for the towing system. The weight rating of the two (2) cables together will not qualify.

Do not mount the permanent baseplate safety cables against wires, hoses or brake lines.

These permanent baseplate safety cables should remain installed as long as the baseplate is installed on the vehicle. Permanent baseplate safety cables are to be used in conjunction with, and NOT a replacement for legally required safety cables attaching the towed vehicle to the towing vehicle.

OPTION #1

Permanent Baseplate Safety Cables to Cross Member or Frame of Towed Vehicle.

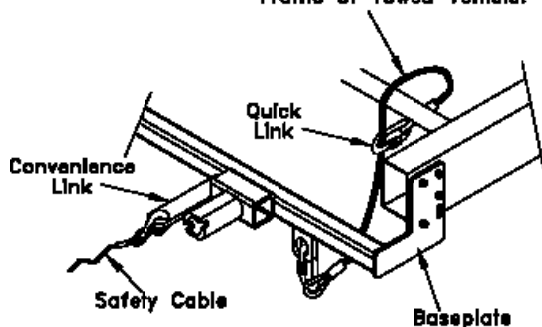

OPTION #2

Permanent Baseplate Safety Cables to Cross Member or Frame of Towed Vehicle.

