



# FITTING INSTRUCTIONS

Part Number: **3423230 | 6178713 | 6178714**

Product **ZENITH WINCH BAR | SUIT TACOMA MY24 ON**

Description:

Suited to **TOYOTA TACOMA MY24 ON**

vehicle/s: **SR5, TRD PreRunner, TRD Sport, TRD Off-Road, Limited, Trailhunter and TRD Pro**

Optional

**W89965** WARN ZEON EXTENDED CABLE KIT

**W106928** KIT WIRE EXTENSION VR EVO

Fitting Kits:

**3500410** WARN XDC ADAPTER KIT

**3500770** SMITTYBILT ADAPTER KIT

## WARNING

### REGARDING VEHICLES EQUIPPED WITH SRS AIRBAG:

When installed in accordance with these instructions, the front protection bar does not affect operation of the SRS airbag.

### ALSO, NOTE THE FOLLOWING:

- ◆ This product must be installed exactly as per these instructions using only the hardware supplied.
- ◆ In the event of damage to any bull bar component, contact your nearest authorised ARB stockist. Repairs or modifications to the impact absorption system must not be attempted.
- ◆ Do not use this product for any vehicle make or model, other than those specified by ARB.
- ◆ Do not remove labels from this bull bar.
- ◆ This product or its fixing must not be modified in any way.
- ◆ The installation of this product may require the use of specialized tools and/or techniques.
- ◆ It is recommended that this product is only installed by trained personnel.
- ◆ These instructions are correct as at the publication date. ARB Corporation Ltd. cannot be held responsible for the impact of any changes subsequently made by the vehicle manufacturer.
- ◆ During installation, it is the duty of the installer to check correct operation/clearances of all components.
- ◆ Work safely at all times.
- ◆ Unless otherwise instructed, tighten fasteners to specified torque.

## ARB 4x4 ACCESSORIES

Corporate Head Office

42-44 Garden St  
Kilsyth, Victoria  
AUSTRALIA 3137

Tel: +61 (3) 9761 6622  
Fax: +61 (3) 9761 6807

Australian enquiries  
North & South American enquiries  
Other international enquiries

sales@arb.com.au  
sales@arbusa.com  
exports@arb.com.au

[www.arb.com.au](http://www.arb.com.au)

# GENERAL CARE AND MAINTENANCE

By choosing an ARB Bar, you have bought a product that is one of the most sought after 4WD products in the world. Your bar is a properly engineered, reliable, quality accessory that represents excellent value. To keep your bar in original condition it is important to care and maintain it following these recommendations:



- Prior to exposure to the weather your bar should be treated to a Carnauba based polish on all exposed surfaces. It is recommended that this is performed on a six-monthly basis or following exposure to salt, mud, sand or other contaminants.
- As part of any Pre-Trip Preparation, or on an annual basis, it is recommended that a thorough visual inspection of the bar is carried out, making sure that all bolts and other components are torqued to the correct specification. Also check that all wiring sheaths, connectors, and fittings are free of damage. Replace any components as necessary. This service can be performed by your local authorized ARB Stockist.

## FITTING REQUIREMENTS

### REQUIRED TOOLS FOR FITMENT OF PRODUCT:

BASIC TOOL KIT	ELECTRIC DRILL WITH COMPLETE METRIC DRILL SET
JIG SAW OR OSCILATING MULTITool WITH BLADE SUITABLE FOR PLASTIC	LOW TACK MASKING TAPE
FILE	UTILITY KNIFE
TAPE MEASURE	CLAMP
STEEL RULE	WHITE FELT MARKER
HACK SAW	TORQUE WRENCH
TOUCH UP PAINT ANTI CORROSION	RIGHT ANGLE ELECTRIC DRILL
BLACK SPRAY PAINT OR BLACK SELF-ADHESIVE VINYL	

### HAVE AVAILABLE THESE SAFETY ITEMS WHEN FITTING PRODUCT:

Protective eyewear 	Hearing protection 
--	--

**NOTE: 'WARNING' notes in the fitting procedure relate to OHS situations, where to avoid a potentially hazardous situation it is suggested that protective safety gear be worn or a safe work procedure be employed. If these notes and warnings are not heeded, injury may result.**

### FASTENER TORQUE SETTINGS:

SIZE	Torque Nm	Torque lbft
M6	9Nm	7lbft
M8	22Nm	16lbft
M10	44Nm	32lbft
M12	102Nm	68lbft

**WINCH COMPATIBILITY:**

<b>WINCH MODEL</b>	<b>ADDITIONAL KITS</b>
Zeon 8:	<b>W89965</b> WARN ZEON EXTENDED CABLE KIT
Zeon 8s:	<b>W89965</b> WARN ZEON EXTENDED CABLE KIT
Zeon 10:	<b>W89965</b> WARN ZEON EXTENDED CABLE KIT
Zeon 10s:	<b>W89965</b> WARN ZEON EXTENDED CABLE KIT
Zeon 12:	<b>W89965</b> WARN ZEON EXTENDED CABLE KIT
Zeon 12s:	<b>W89965</b> WARN ZEON EXTENDED CABLE KIT
Zeon 10 Platinum:	<b>W89965</b> WARN ZEON EXTENDED CABLE KIT
Zeon 10-s Platinum:	<b>W89965</b> WARN ZEON EXTENDED CABLE KIT
Zeon 12 Platinum:	<b>W89965</b> WARN ZEON EXTENDED CABLE KIT
Zeon 12-s Platinum:	<b>W89965</b> WARN ZEON EXTENDED CABLE KIT
VR EVO 8:	<b>W106928</b> KIT WIRE EXTENSION VR EVO
VR EVO 8s:	<b>W106928</b> KIT WIRE EXTENSION VR EVO
VR EVO 10:	<b>W106928</b> KIT WIRE EXTENSION VR EVO
VR EVO 10s:	<b>W106928</b> KIT WIRE EXTENSION VR EVO
VR EVO 12:	<b>W106928</b> KIT WIRE EXTENSION VR EVO
VR EVO 12s:	<b>W106928</b> KIT WIRE EXTENSION VR EVO
XP:	-
XP:	-
M8000:	-
M8000s:	-
XD9:	-
XD9s:	-
9.5XDC:	<b>3500410</b> WARN XDC ADAPTER KIT
9.5XDC-s:	<b>3500410</b> WARN XDC ADAPTER KIT
Bushranger REVO MKII 10W:	-
Bushranger REVO MKII 10S:	-
Bushranger REVO MKII 12W:	-
Bushranger REVO MKII 12S:	-
Bushranger Covert 10-w:	-
Bushranger Covert 10-s:	-
Bushranger Covert 12-w:	-
Bushranger Covert 12-s:	-
Smittybilt X20 10lbs cable:	<b>3500770</b> SMITTYBILT ADAPTER KIT
Smittybilt X20 10lbs rope:	<b>3500770</b> SMITTYBILT ADAPTER KIT
Smittybilt X20 12lbs cable:	<b>3500770</b> SMITTYBILT ADAPTER KIT
Smittybilt X20 12lbs rope:	<b>3500770</b> SMITTYBILT ADAPTER KIT

**PARTS LISTING**

APPLICATION	PART NO.	QTY	DESCRIPTION
<b>OEM BUMPER</b>	37800295	1	ZEN CUT TEMPLT SUIT TACOMA
	6191030	1	PINCH WELD 520mm
	37500460R	1	ZEN BMPR RET BRKT RHS
	37500460L	1	ZEN BMPR RET BRKT LHS
	37800425	1	CUT TEMPLT ZENITH 3423210
	6821189	4	GROMMET RND FC 1500 080 090
	6151338	4	SCREW PHD 4.8x2.1x20   BTZP HI/LOW

APPLICATION	PART NO.	QTY	DESCRIPTION
<b>MOUNTS TO VEHICLE</b>	4655694	1	ZEN MNT WELD ASSY SUIT TACOMA
	37500336R	1	BRKT INNER CHAS SUIT J250 RH
	37500336L	1	BRKT INNER CHAS SUIT J250 LH
	37500337R	1	BRKT OUTER CHAS SUIT J250 RH
	37500337L	1	BRKT OUTER CHAS SUIT J250 LH
	3197056	2	ZEN RP SPCR LRG SUIT TACOMA
	6151817	2	BOLT HXHD FL M12x1.25x40   PC11.9 ZAB1000
	6151480	2	NUT FLANGE M12x1.25   PC8.8 TZP480 SERRATED
	4617103	2	CHASSIS CRUSH TUBE
	6152092	2	BOLT HXHD M12x1.75x110   PC 10.9 ZAS1000
	6151528	2	NUT HEX NYLOC M12x1.75   PC10.9 ZP
4584363	6	WASHER FLAT M12x26x4   HV300 TZP480	

APPLICATION	PART NO.	QTY	DESCRIPTION
<b>RECOVERY POINTS</b>	4655695R	1	ZEN REC POINT FORGED RHS
	4655695L	1	ZEN REC POINT FORGED LHS
	6151817	10	BOLT HXHD FL M12x1.25x40   PC11.9 ZAB1000
	6151480	8	NUT FLANGE M12x1.25   PC8.8 TZP480 SERRATED
	4584320	4	WASHER FLAT M12x29x4   TZP CLIPPED EDGE
	4584363	6	WASHER FLAT M12x26x4   HV300 TZP480
	2125484	2	RECOVERY POINT WARNING LABEL

APPLICATION	PART NO.	QTY	DESCRIPTION
<b>CAMERA AND SENSORS</b>	37501178	1	CAMERA BRACKET UPPER ZENITH
	6151443	2	SCREW BHD M6x20   BZP
	4584295	4	WASHER FLAT M6x12
	6151223	2	NUT HEX NYLOC M6x1.0   ZNB480
	3163222	2	PLUG SNSR BLANKING PAIR
	3163221	1	RADAR COVER
	3525010	1	SENSOR SURROUND KIT (4)   SUITS LC300
	6821451	4	HARNES EXTENSION SUITS TOYOTA

APPLICATION	PART NO.	QTY	DESCRIPTION
<b>BAR TO MOUNTS</b>	3197138	8	ZEN MOUNT SHIM SUIT TACOMA
	3423230	1	BULLBAR WELDMENT
	6151443	4	SCREW BHD M6x20   BZP
	4584295	4	WASHER FLAT M6x12
	6151817	4	BOLT HXHD FL M12x1.25x40   PC11.9 ZAB1000
	4584363	4	WASHER FLAT M12x26x4   HV300 TZP480
	6151480	4	NUT FLANGE M12x1.25   PC8.8 TZP480 SERRATED
	6151965	4	BOLT HXHD FL M10x1.5x30   PC8.8 ZNB480
	4581040	4	WASHER FLAT M10x25x3   TZP480
	6151752	4	NUT FLANGE M10x1.5   PC8.8 BTZP480

APPLICATION	PART NO.	QTY	DESCRIPTION
<b>WINCH FITMENT</b>	37500426	1	ZEN CNTRL BOX BRKT SUIT TACOMA

APPLICATION	PART NO.	QTY	DESCRIPTION
<b>VEHICLE COMPONENTS MOUNTED TO BASH PLATE</b>	37500327	1	RADAR BRKT UPPER SUIT J250
	37500328	1	RADAR BRKT LOWER SUIT J250
	6151443	4	SCREW BHD M6x20   BZP
	4584295	8	WASHER FLAT M6x12
	6151223	4	NUT HEX NYLOC M6x1.0   ZNB480
	6151584	2	BOLT HXHD M6x1.0x40   PC8.8 BTZP
	5670069	2	SPRING COMP STAINLESS 25X6.0ID
	4584421	2	WASHER FLAT M6X18X1.6 NYLON
	6821189	8	GROMMET RND FC 1500 080 090
	6151142	8	SCREW ST PHD 10Gx3/4   ZP REC

APPLICATION	PART NO.	QTY	DESCRIPTION
<b>NUMBER PLATE BRACKET</b>	3755085	1	LICENCE PLATE BRACKET
	37500881	1	BRKT NUM PLATE UPPER
	6151443	8	SCREW BHD M6x20   BZP
	4584295	14	WASHER FLAT M6x12
	5848302	2	PACKER RB NYLON
	6151223	6	NUT HEX NYLOC M6x1.0   ZNB480

APPLICATION	PART NO.	QTY	DESCRIPTION
<b>WINGS TO WELDMENT</b>	4681900R	1	WING BRACKET RH
	4681900L	1	WING BRACKET LH
	6151730	8	BOLT HXHD FL M8x1.25x20   FT PC8.8 BZP480
	6151655	8	NUT FLANGE M8x1.25   PC8 TZP480

APPLICATION	PART NO.	QTY	DESCRIPTION
<b>BASH PLATE TO BAR/MOUNTS</b>	4655693	1	BASH PLATE SUIT TACOMA ZENITH
	6151965	8	BOLT HXHD FL M10x1.5x30   PC8.8 ZNB480
	37501167	1	WINCH CRADLE UPPER
	4581040	2	WASHER FLAT M10x25x3   TZP480
	4584400	6	WASHER FLAT M10x30x4
	6151752	6	NUT FLANGE M10x1.5   PC8.8 BTZP480

APPLICATION	PART NO.	QTY	DESCRIPTION
<b>UNDER PANELS</b>	6523821	1	STONE TRAY
	6523691R	1	ZEN WING PANEL RHS SUIT TACOMA
	6523691L	1	ZEN WING PANEL LHS SUIT TACOMA
	37501168	1	STONE TRAY BRACKET
	37501169	2	WING PANEL BRACKET
	4584295	6	WASHER FLAT M6x12
	4584431	2	WASHER M8x24x5.8   SS EPDM DBLE-SEAL
	6151443	6	SCREW BHD M6x20   BZP
	6151475	6	NUT U M6x1.0   TZP480 PR1.6-3.0 L13
	6151730	12	BOLT HXHD FL M8x1.25x20   FT PC8.8 BZP480 ENS14-001
	6151655	2	NUT FLANGE M8x1.25   PC8 TZP480 ENS 14/002

APPLICATION	PART NO.	QTY	DESCRIPTION
<b>MISC</b>	180302	8	CABLE TIE 4.8 X 180 MM BLACK

## FITTING PROCEDURE



1. Remove the bolts underneath the bumper and discard.
2. Remove factory tow points. Discard tow points, but retain bolts for later use.

LHS SHOWN



3. Remove the clips & screws holding the front half of the wheel arch liners.  
Carefully unclip the front of the wheel arch liners.  
Discard the fasteners.



4. Open the bonnet and remove all eight scrivets retaining plastic cover. Set aside scrivets removed for re-use later on.

**TIP:** Depress centre to remove.



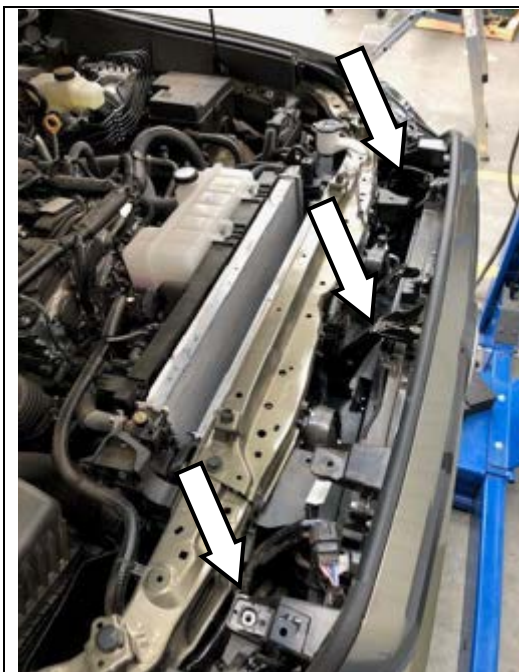

5. Remove the three bolts across the top of the radiator support connected to the grille.
6. Disconnect the electrical connectors on either side of the grille.



7. Gently peel back flare unclipping it from inside the bumper, revealing a silver screw. Remove and retain screw for re-fitment.  
Repeat for the other side.



8. Unclip the corners of the bumper from the vehicle. Remove the bumper and set aside on a soft surface to avoid scratching it.
9. Unclip plastic section from the crash beam.



10. Remove the eight bolts securing the crash beam to the chassis.
11. Remove the alloy crash beam and discard.
12. Remove lower air deflector between front chassis crossmember and AC condenser.

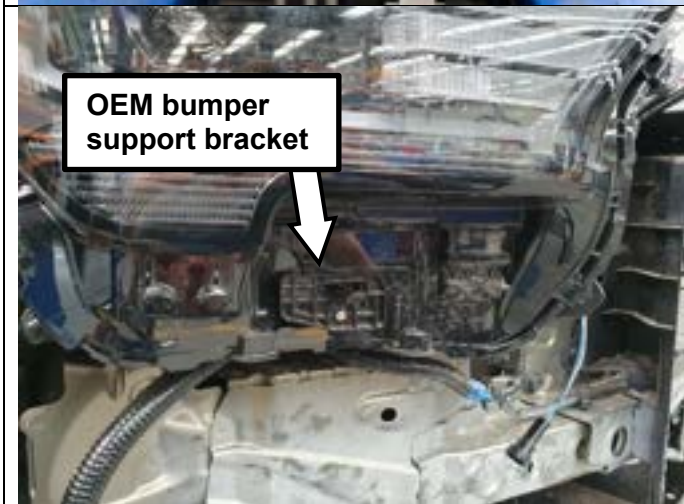
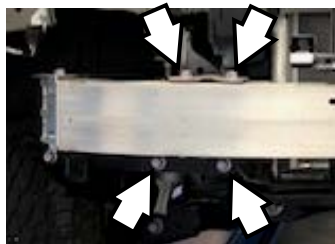

13. Remove factory bumper support bracket to exchange with Zenith bumper support bracket. Use same OEM fastener. Brackets fit one way only, right hand shown.

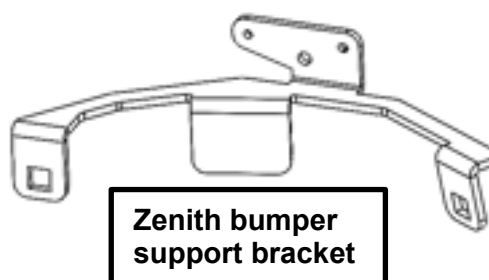

14. Remove six M6 bolts holding the factory air shutter assembly.



15. Unclip the loom from the lower half of the bumper.
16. Remove radar, camera and fog lamps from bumper.
17. Remove and label parking sensors (right outer, right inner, left outer and left inner). Also take note of sensor orientation.

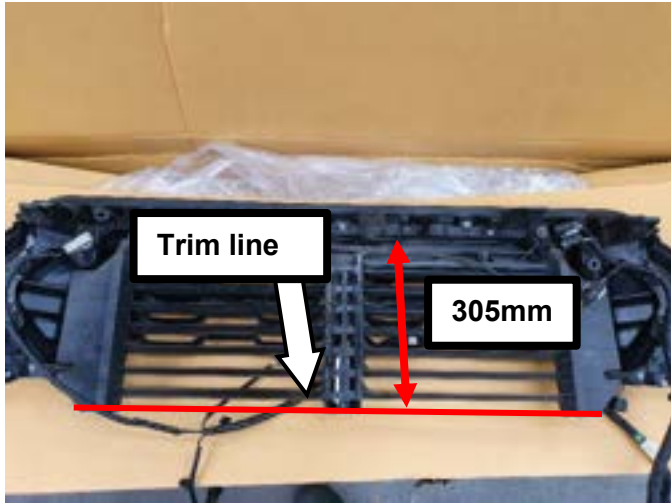

18. Trim active grille shutter 305mm below the top edge of the device, leaving the motor and the louvre it is directly attached to intact.
19. Fit grille shutter back to bumper with original three upper factory M6 bolts.

**NOTE:** Trimmed bumper shown for reference; bumper trimming occurs in later steps.

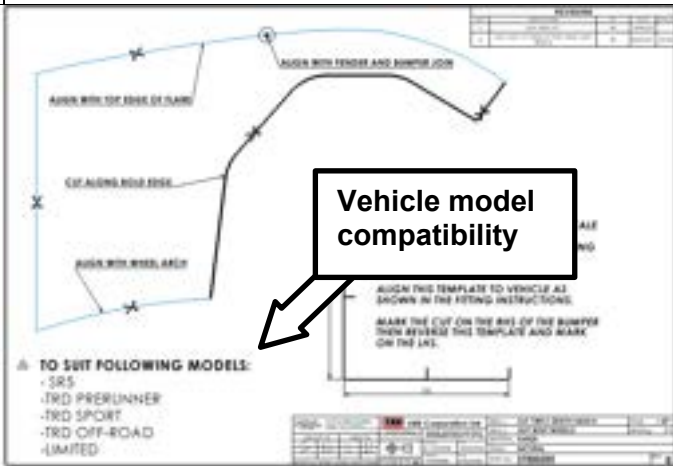

20. Identify appropriate template for vehicle model. Two different templates are supplied.
21. Confirm correct sizing of template by measuring the scale provided.
22. Cut out flare cut template.



23. Cover flare cut region with masking tape to mark out cut path.
24. Place cut template on masked flare using instructions on template and trace cut path onto flare. Retain template to use on other side.

*TRD Off-Road model shown.*

Right hand side shown, repeat for other side.

RHS SHOWN

Top edge of flare.

Fender and bumper join as described on template.

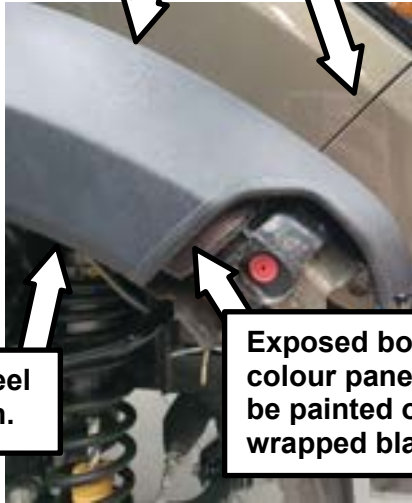

Wheel arch.

Exposed body colour panel to be painted or wrapped black.

25. Cut flare to templated marking and apply pinch weld to the cut edge as shown.
26. Remove trimmed flares and use black paint or vinyl to cover body colour section exposed by flare trim.



**WARNING:** Cutting operations can result in flying debris, safety glasses should be worn.



27. Re-fit the bumper and flares as it is much easier to trim the bumper on the vehicle.

28. Mark across the grille and bumper as shown, connecting to the edge of the templated cut on the flare. Cut through all bumper layers. Mirror cut for other side.

The cut from the centre of the vehicle to point A should follow the grille features as shown. The cut from point A to point B should be marked as a straight line (aided by a steel rule) from the corner of the grille shown (point A), at 110mm down from the headlight, through to the bumper feature at point B. A straight line can then be marked from point B through to the end of the templated flare cut at point C.

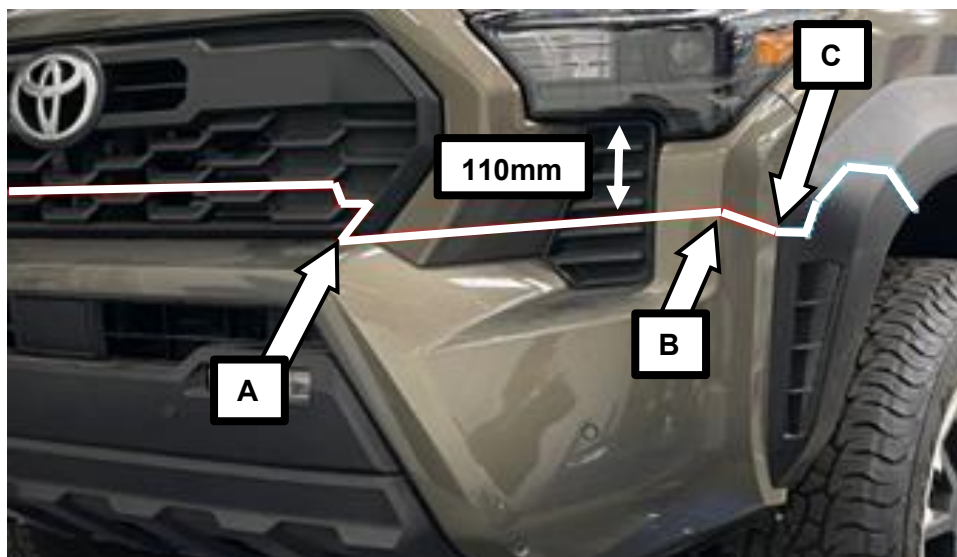

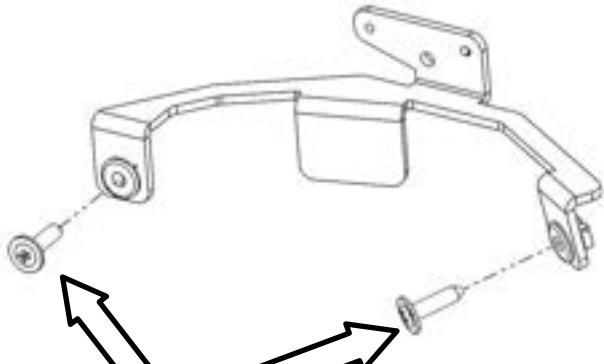

**Black 10G screws  
and screw grommets**

29. Using the bracket as a template, mark and drill two 5mm holes in the bumper.
- Secure trimmed bumper to bumper retention brackets using two 10G black screws and two screw grommets through the bumper. Right hand side shown.
- Repeat for other side.

**LHS SHOWN**



**Plastic grommet  
on outer face of  
chassis rail**

30. Remove the three forwardmost plastic grommets on the chassis rails. One on chassis rail outer face, one on inner face and one on lower face.
- Repeat for other side.

**RHS SHOWN**

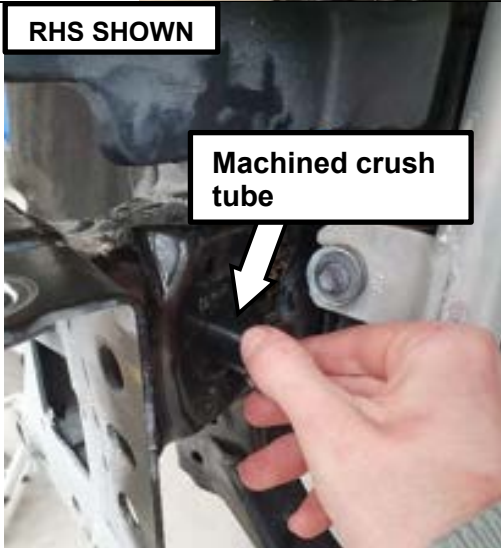

**Machined crush  
tube**

31. Identify and fit a machined crush tube into each chassis rail (RHS and LHS) from the inside.

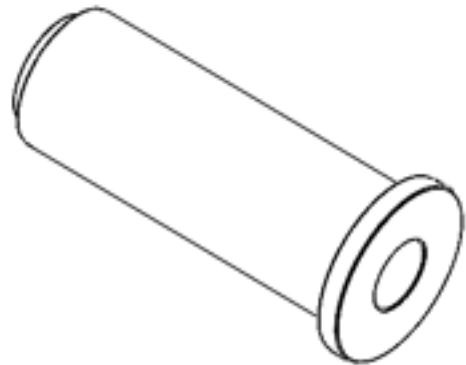

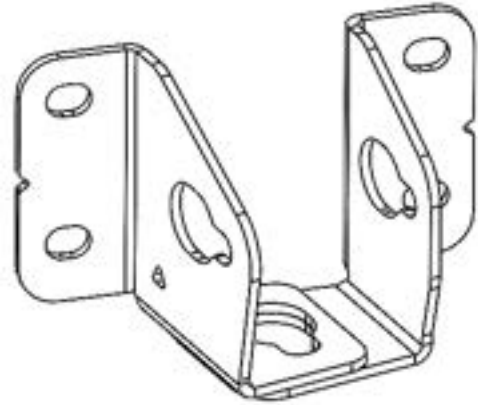
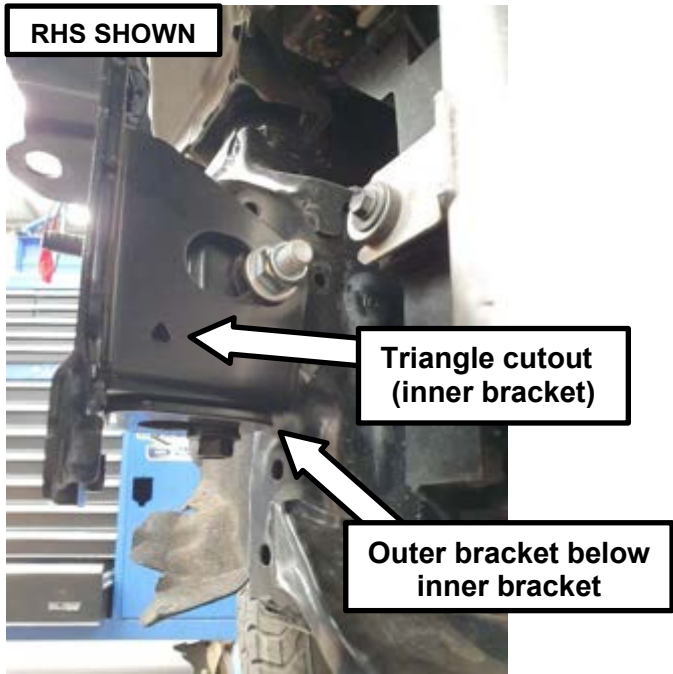

**RHS Chassis Support Brackets**

32. Identify and fit the chassis support brackets to the chassis rails and hold in place with the M12x1.25x40mm bolt, washer and serrated nut in bottom face. Note orientation of two brackets, right hand side shown. Triangle cutout identifies inner bracket. Leave fasteners finger tight.

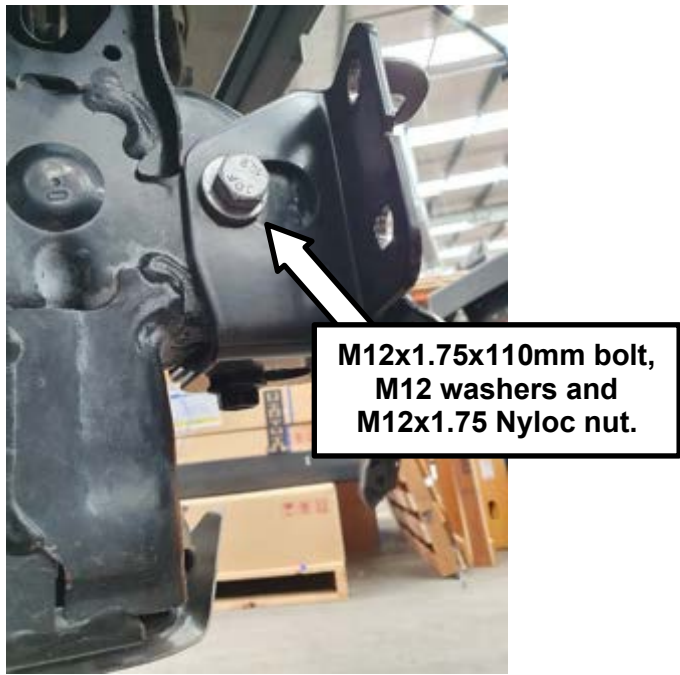

33. Install one M12x1.75x110 bolt, two M12 washers and a M12 Nyloc nut to each crush tube (two crush tubes). Leave fasteners finger tight.



34. Sit the winch cradle in place on the end of the chassis rails as shown. Use studs on front of chassis rail to help location.

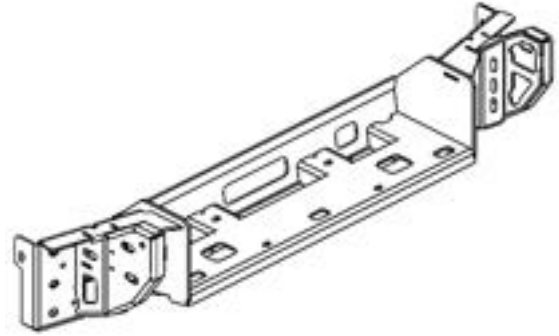

**M12x1.25x40mm flange bolt, M12 washer and M12 flange nut**

(finger tight)

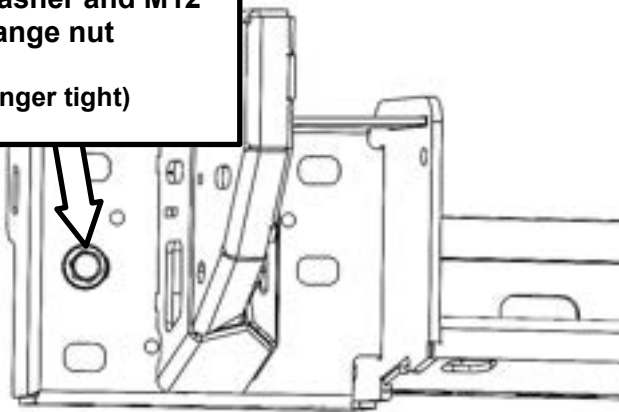

35. Install one M12x1.25x40mm flange bolt, one M12 washer, one M12 flange nut and one 2-hole spacer, to secure winch cradle to chassis. Leave these fasteners (nut and bolt) loose but torque lower bolt and nut to spec as shown. Repeat for other side.



M12 - 68lbft (102 Nm)

**M12x1.25x40mm flange bolt, M12 washer and M12 nut**  
(torque to spec)

2-hole spacer

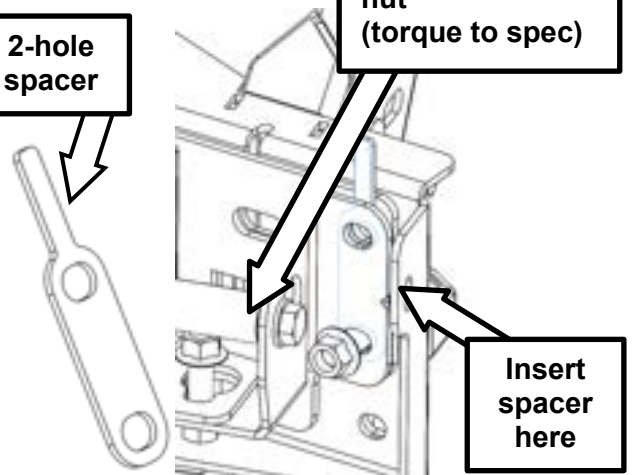

Insert spacer here

**RHS SHOWN**

**M12x1.25x40mm flange bolt, M12 washer and flange nut**

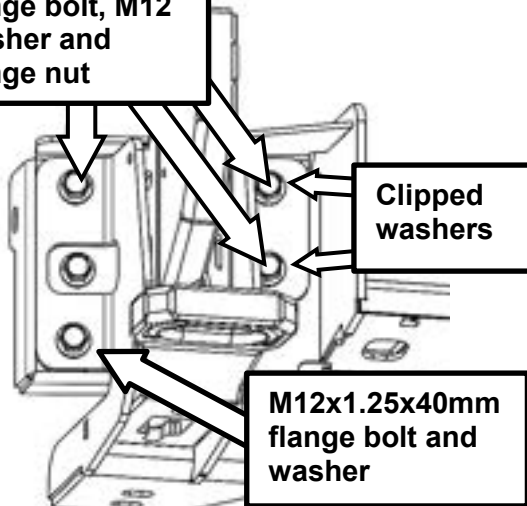

Clipped washers

M12x1.25x40mm flange bolt and washer

36. Install recovery point using four M12x1.25x40mm bolts, two M12 washers, two M12 clipped washers and three M12 flange nuts. Leave fasteners loose.

Repeat for other side.

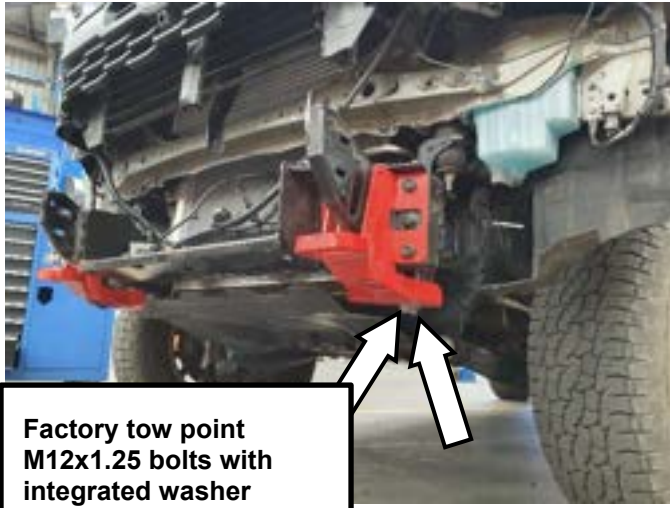

**Factory tow point  
M12x1.25 bolts with  
integrated washer**

37. Install two factory tow point M12x1.25 bolts with integrated washer removed in step 2. Left hand side shown. Leave fasteners loose.

Repeat for other side.

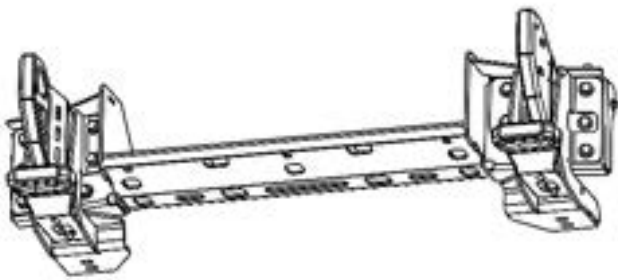

38. With all mount and recovery fasteners fitted, tighten all fasteners to specification.

 M6 - 102 Nm

SIZE	Torque lbft	Torque Nm
M12	68Nm	102lbft

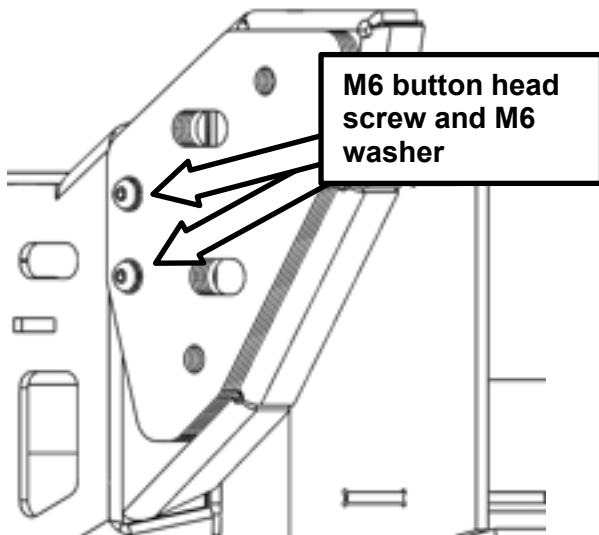

**M6 button head  
screw and M6  
washer**

39. Measure bar and select number of shims accordingly  
Install mount shims to the mount using two M6x20 button head bolts with M6 washers. Torque to spec.

Repeat for other side.

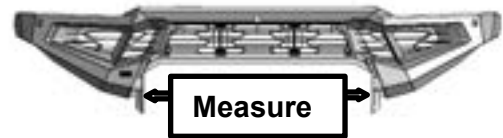

 M6 – 7lbft (9 Nm)

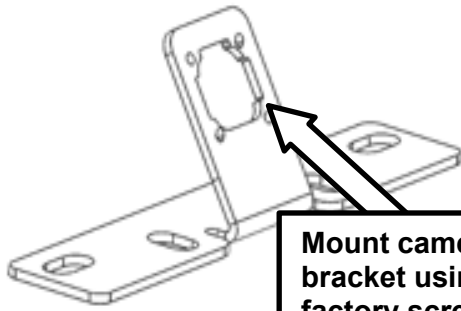

**Mount camera to bracket using factory screws**

40. Fit camera to bracket using factory screws. Tighten until firm taking care to not damage plastic camera bracket.

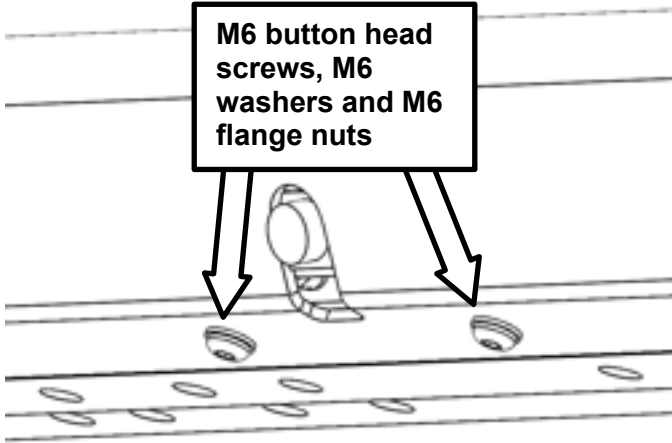

**M6 button head screws, M6 washers and M6 flange nuts**

41. Fit bracket with camera to the bar using two M6 button head screws, two M6 washers and two M6 flange nuts. Torque to spec.



**M6 – 7lbf (9 Nm)**

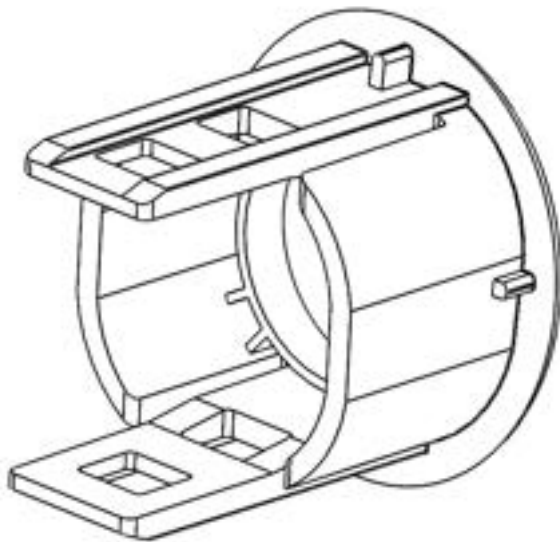

42. Fit two sensors surrounds (part number 3525010) to the bar.  
43. Clip sensors into surrounds and fit extension harnesses (part number 6821451) to each sensor.

**Up**

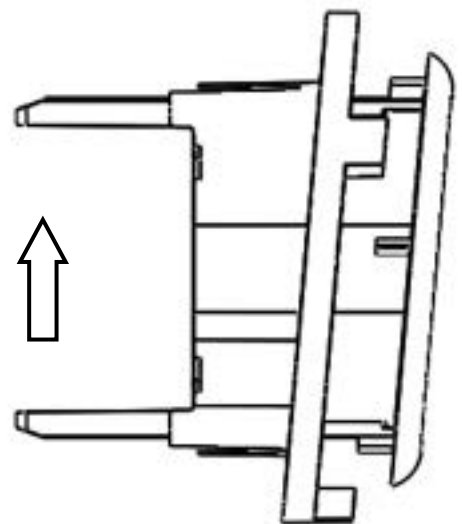



44. Fit bar to vehicle using lifting aid such as an elevating trolley.

Plug in the camera and outer parking sensors.

Ensure tight fit to mount shims. If a gap is present or bar does not fit on mounts, remove bar from vehicle to add/remove shims as required.

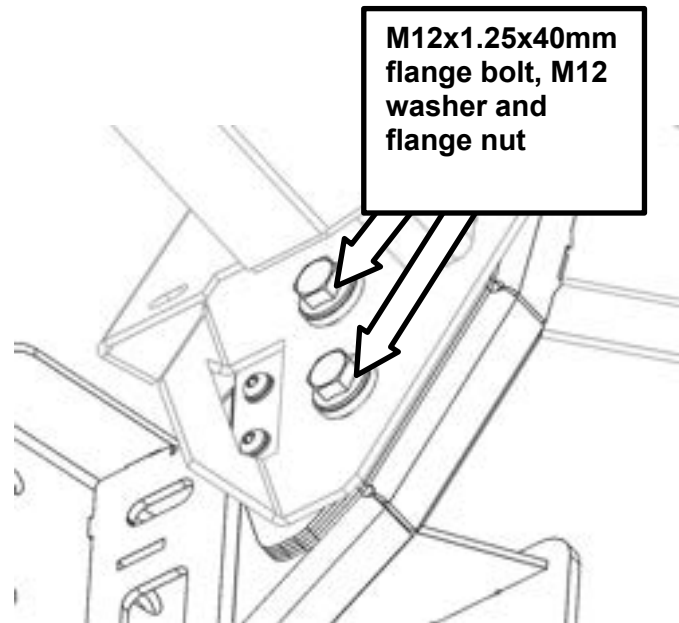

45. Install two M12x1.25x40mm flange bolts, M12 washers & M12 serrated flange nuts per side. Leave fasteners loose.

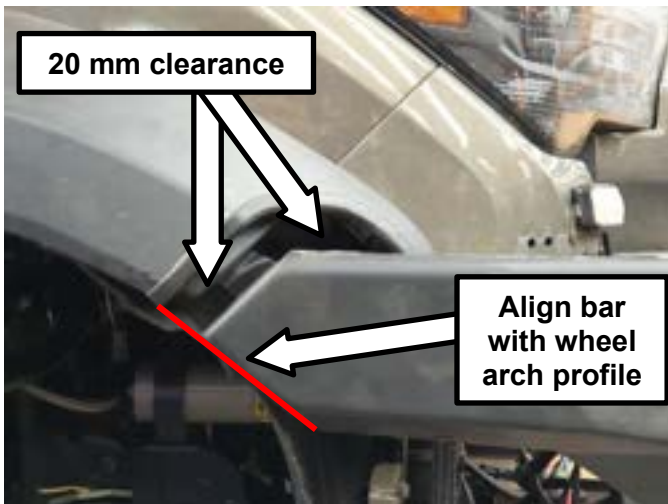

46. Adjust the bar to make the back edge of the bar run in line with the fender/bumper join and run parallel to the cut faces with a consistent gap of 20mm.

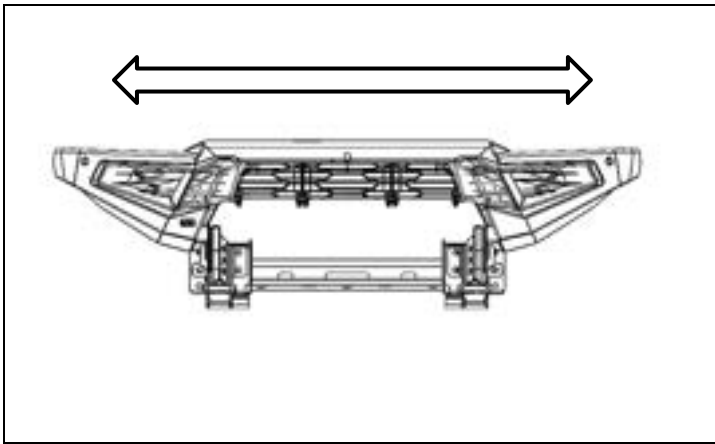

47. Ensure bar is centred on vehicle checking gap to fender on each side. Return to Step 39 if bar is not centred, and compensate accordingly with shim quantities on each side.

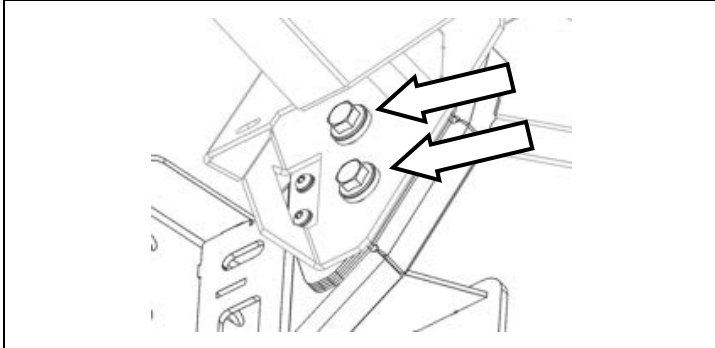

48. Torque mount fasteners to spec.

 M12 – 68lbft (102 Nm)

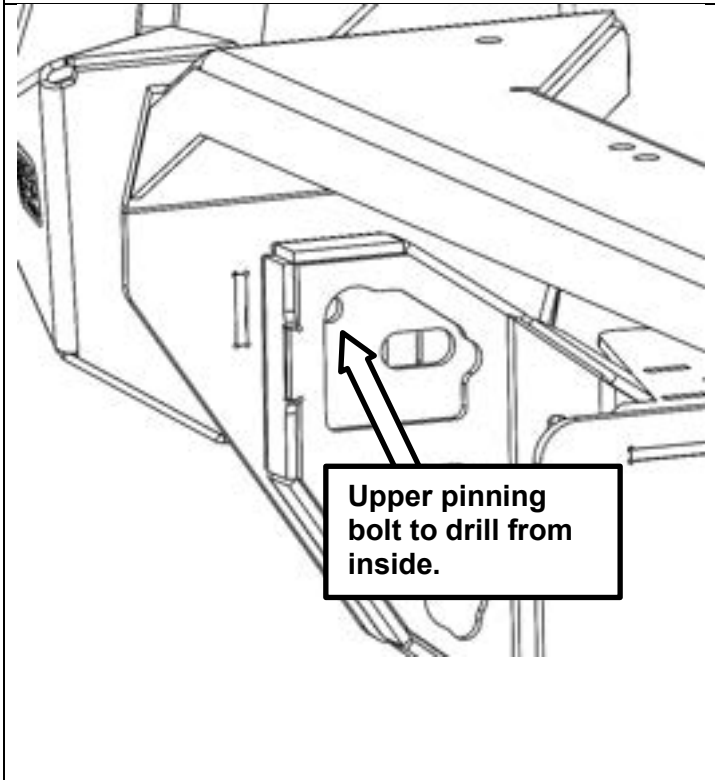

49. Drill Ø10mm pinning bolt holes through clearance holes provided. The lower pinning hole is drilled from the outside while the upper pinning hole is drilled from the inside.

**Lower pinning bolt to drill from outside.**

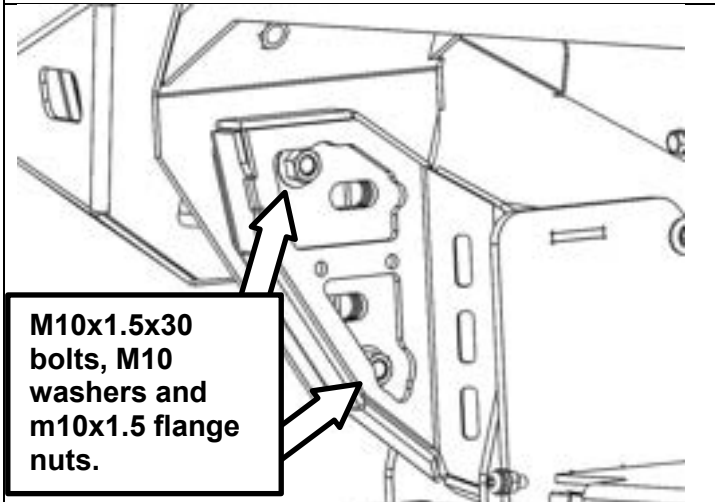
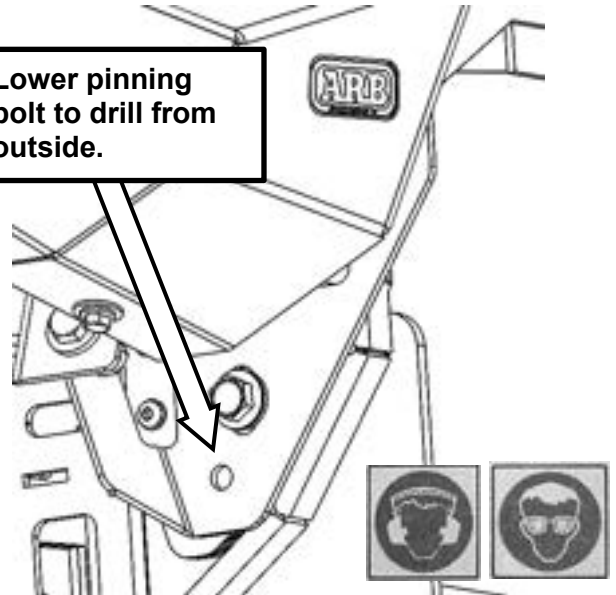

50. Install four M10x1.5x30mm flange bolts, two M10 washers and two M10x1.5 flange nuts as pinning bolts for the bar. Torque to spec.

 M10 – 32lbft (44 Nm)

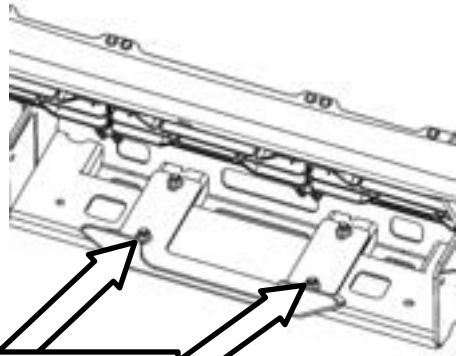

M10 bolts

51. Place upper winch cradle in place as shown. Secure with 4x M10 x 35mm bolts, 4x M10 washers and 4x M10 flange nuts. Leave loose for now. If installing a winch, these will be replaced with mounting hardware provided with winch.

52. If fitting winch or driving lights, continue from here for respective winch and light installation instructions. **If not fitting these accessories, skip to step 67.**

Recommended grille and accessory layouts shown below:

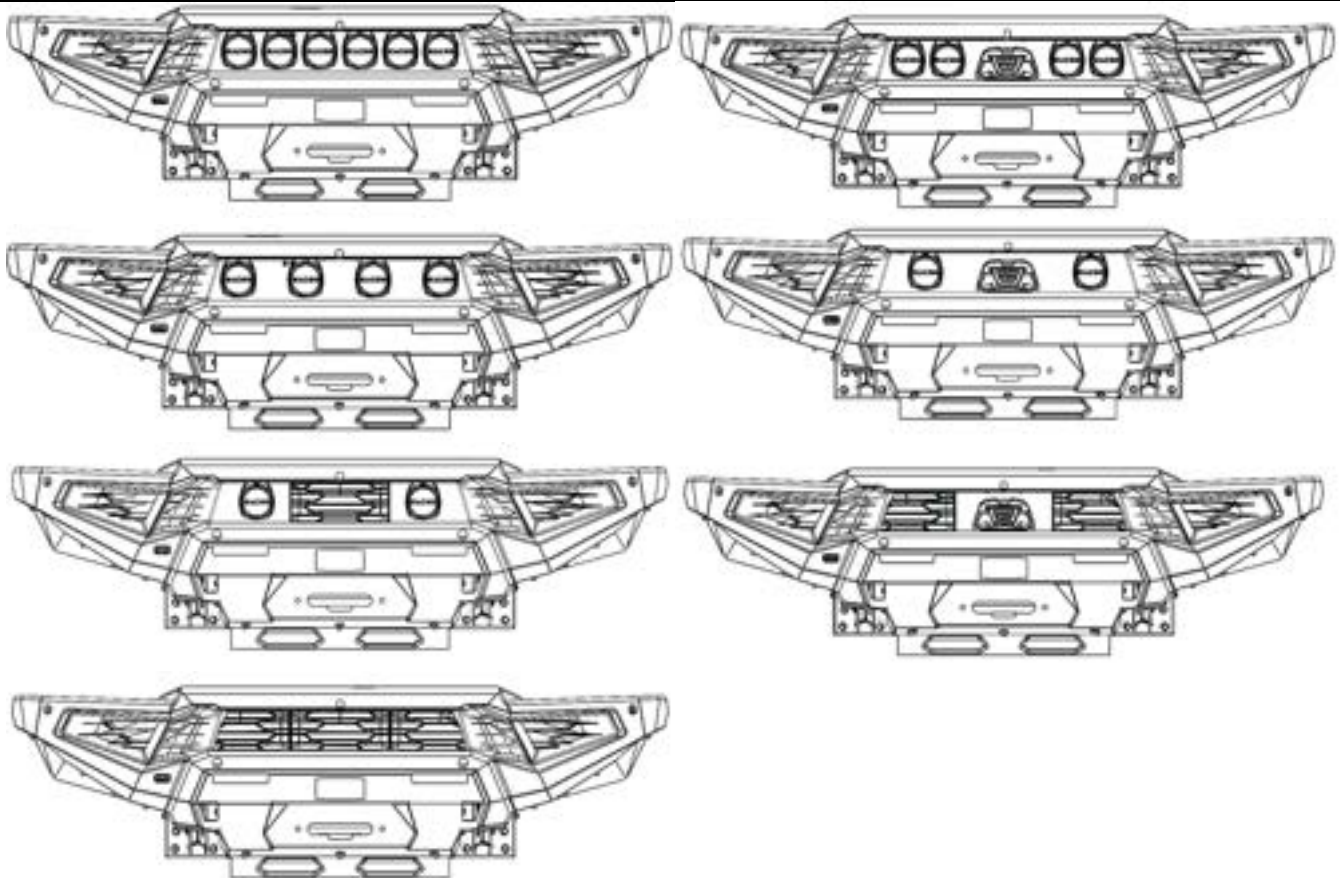

53. Fit driving lights, if doing so.

**Centre Grille Only**

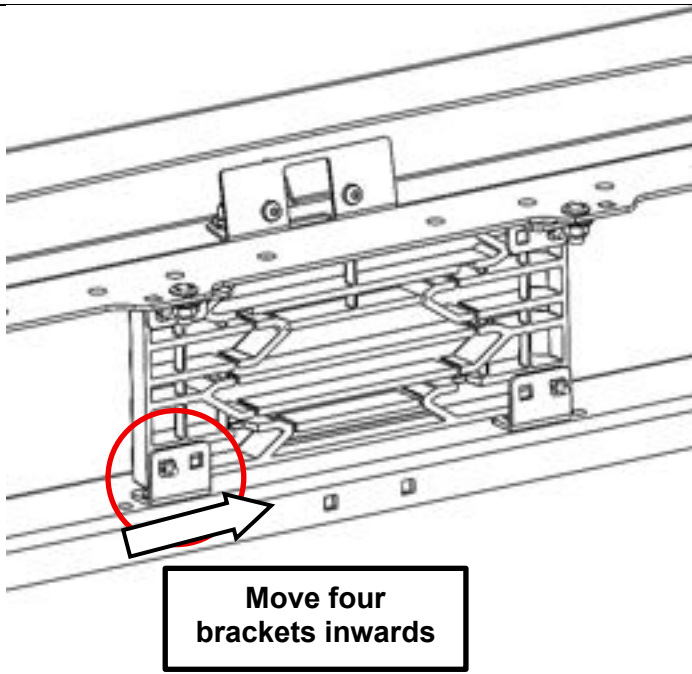
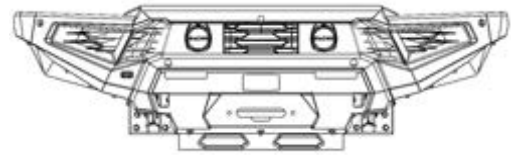

54. When fitting accessory layouts with the centre grille only, remove side grilles from the brackets by removing outer grille brackets retained by two M8 coach bolt, two M8 washers and two M8 nyloc nuts each.
55. Remove four M8 coach bolts, four M8 washers and four M8 Nyloc nuts from inner grille brackets. Move grille brackets inward to be hidden by the grille as shown.
56. Remove brackets by removing the M8 coach bolts, M8 washers and M8 Nyloc nuts.

**Side Grilles Only**

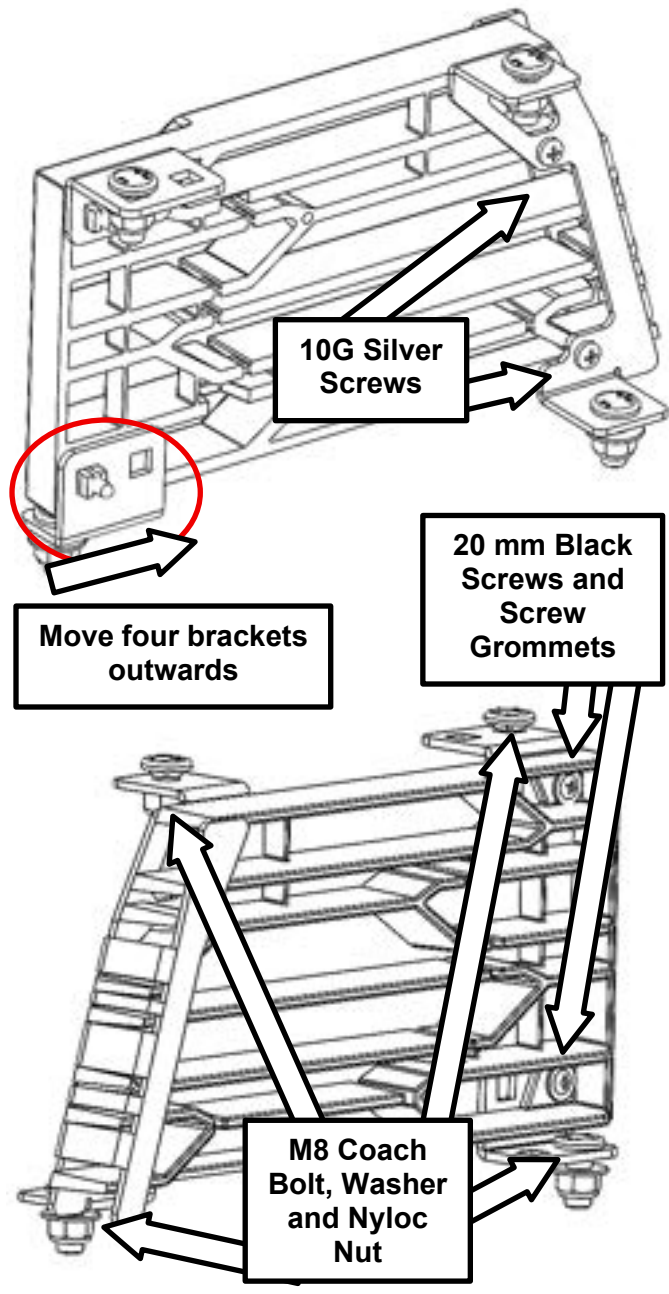
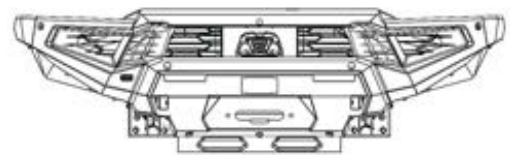

57. When fitting accessory layouts with the side grilles only, the centre grille can be removed as above.
  58. Remove four M8 coach bolts, four M8 washers and four M8 Nyloc nuts from inner grille brackets. Move grille brackets outward to be hidden by the grille as shown.
- Retain additional M8 coach bolts, M8 washers and M8 Nyloc nuts for winch control box relocation bracket.

59. If not fitting a winch, skip to step 65. Otherwise, winch fitment is as follows for each supported winch (step 60 through 65):

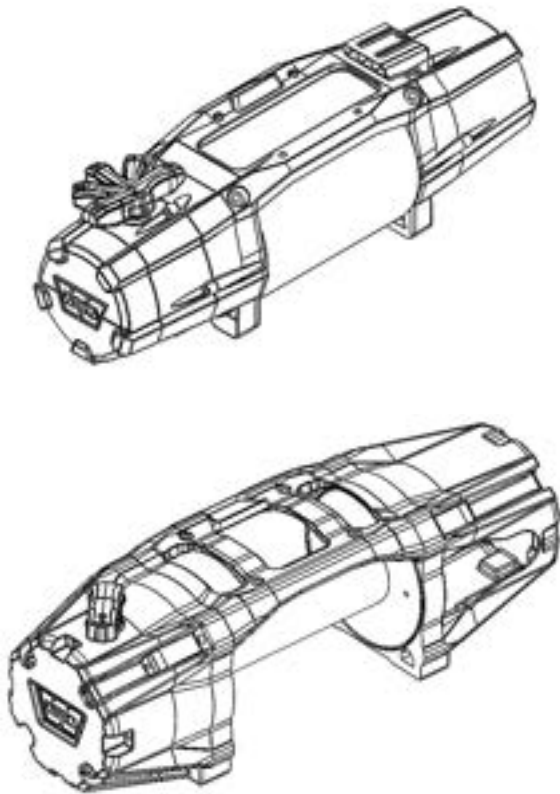

60. **Warn VR EVO and Zeon variants**

Remove the control box from the winch as detailed within the Warn winch instruction manual.

Fit the control box to the winch control box bracket using original hardware.

Fit the winch control box bracket with the control box fitted to the bar using two M8 coach bolts, two M8 washers and two M8 Nyloc nuts removed in step 58. Position the bracket in its highest position temporarily.

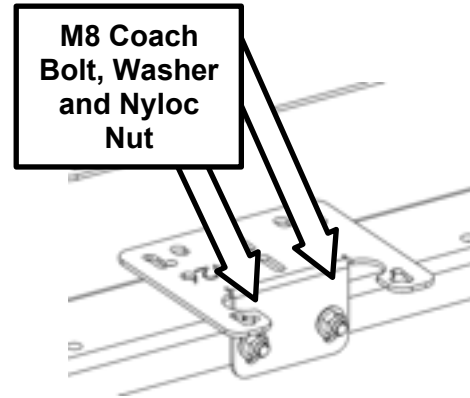

Fit the winch to the cradle and the hawse/fairlead to the bash plate. Leave winch mounting fasteners finger tight. Skip to step 67.

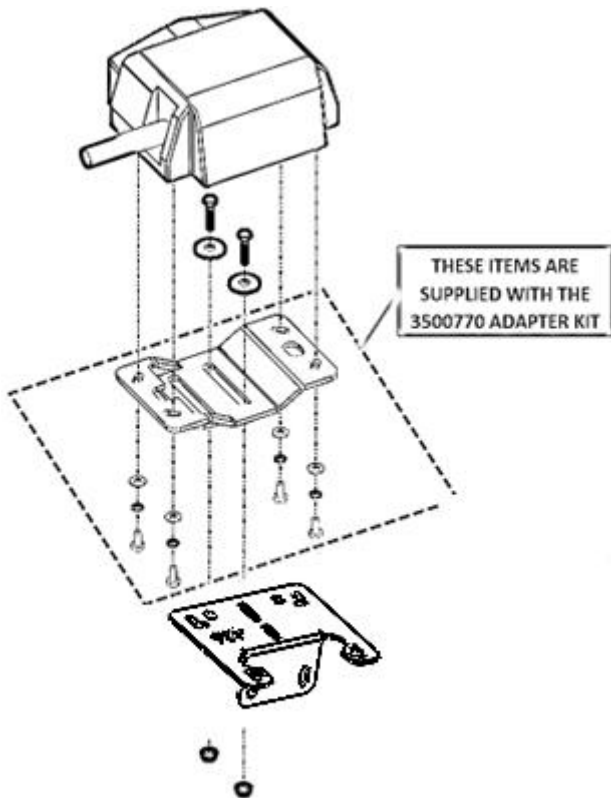

61. **Warn XDC variants**

Remove the control box from the winch as detailed within the Warn winch instruction manual.

Fit the control box to the winch control box bracket using optional fitting kit **3500770** as shown.

Fit the winch control box bracket with the control box fitted to the bar using two M8 coach bolts, two M8 washers and two M8 Nyloc nuts removed in step 58. Position the bracket in its highest position temporarily.

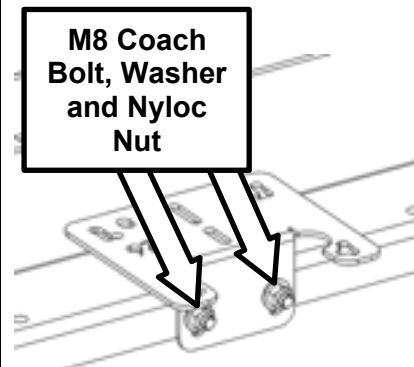

Fit the winch to the cradle and the hawse/fairlead to the bash plate. Leave winch mounting fasteners finger tight. Skip to step 67.

62. **Warn M8000, XD9 and 9.5XP variants are directly compatible and do not need to be clocked or disassembled for installation.**

Fit the winch to the cradle with the control box mounted to the winch itself. Fit the winch to the cradle and the hawse/fairlead to the bash plate. Leave winch mounting fasteners finger tight. Skip to step 67.

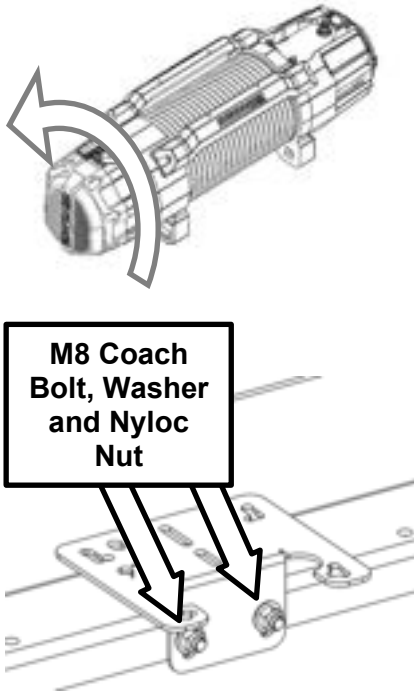

63. **Bushranger Revo MkII variants**

Following instructions included with the Bushranger winch, rotate the clutch assembly on the winch to position the handle on top of the winch when fitted foot down on the cradle.

Remove the control box from the winch as detailed within the Bushranger winch instruction manual.

Fit the control box to the winch control box bracket using original hardware.

Fit the winch control box bracket with the control box fitted to the bar using two M8 coach bolts, two M8 washers and two M8 Nyloc nuts removed in step 58. Position the bracket in its highest position temporarily.

Fit the winch to the cradle and the hawse/fairlead to the bash plate. Leave winch mounting fasteners finger tight. Skip to step 67.

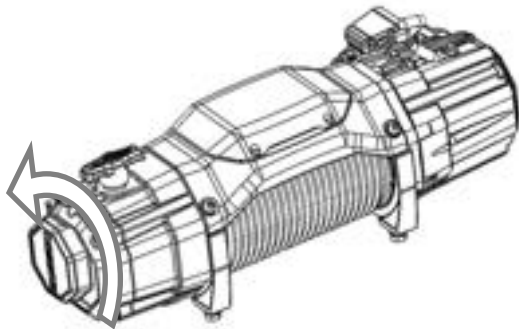

64. **Bushranger Covert variants**

Following instructions included with the Bushranger winch, rotate the clutch assembly on the winch to position the handle on top of the winch when fitted foot down on the cradle.

Fit the winch to the cradle and the hawse/fairlead to the bash plate. Leave winch mounting fasteners finger tight. Skip to step 67.

65. **Smittybilt X20 variants**

Remove the control box from the winch as detailed within the Smittybilt winch instruction manual.

Fit the control box to the winch control box bracket using original hardware.

Fit the winch control box bracket with the control box fitted to the bar using two M8 coach bolts, two M8 washers and two M8 Nyloc nuts removed in step 58. Position the bracket in its highest position temporarily.

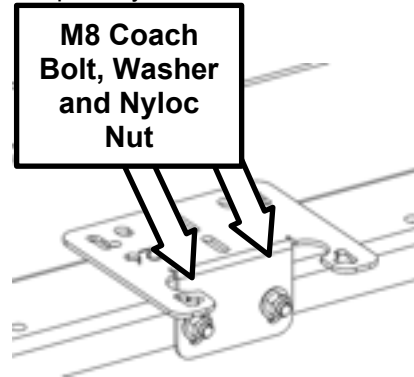
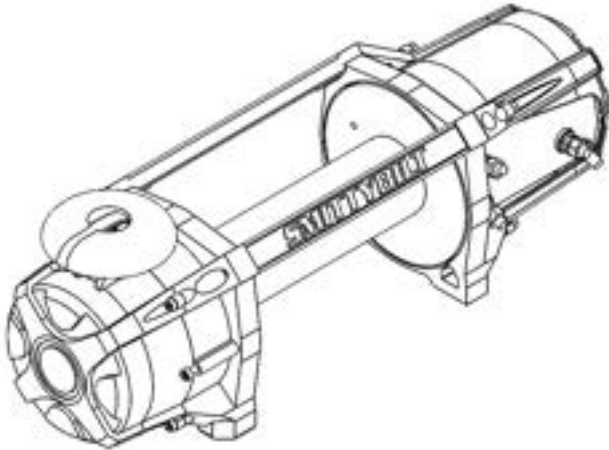

Fit the winch to the cradle and the hawse/fairlead to the bash plate. Leave winch mounting fasteners finger tight.

66. Fit eight screw grommets into bash plate fog light brackets.

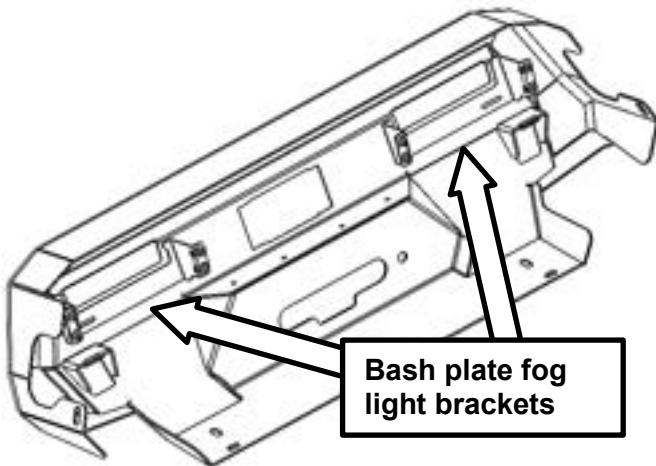

Nylon Washer

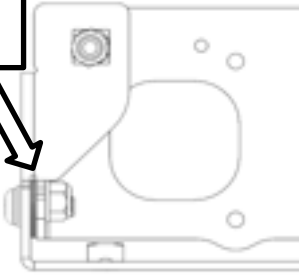

67. Assemble upper and lower half of radar bracket using two M6 button head screws, four M6 flat washers, two M6 nylon washers and two M6 nyloc nuts. Tighten to remove any play, while still allowing the bracket to pivot freely.

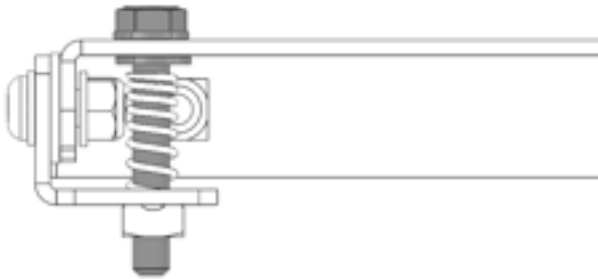

68. Assemble two M6x40 hex head bolts, two M6 flat washer and two springs provided. Position is not important at this stage.



69. Fasten radar module to the bracket using 3 factory phillips head screws.

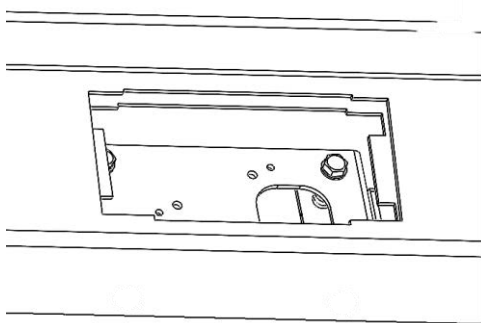

70. Place the radar assembly in the bash plate, to be fastened with number plate bracket in following steps.

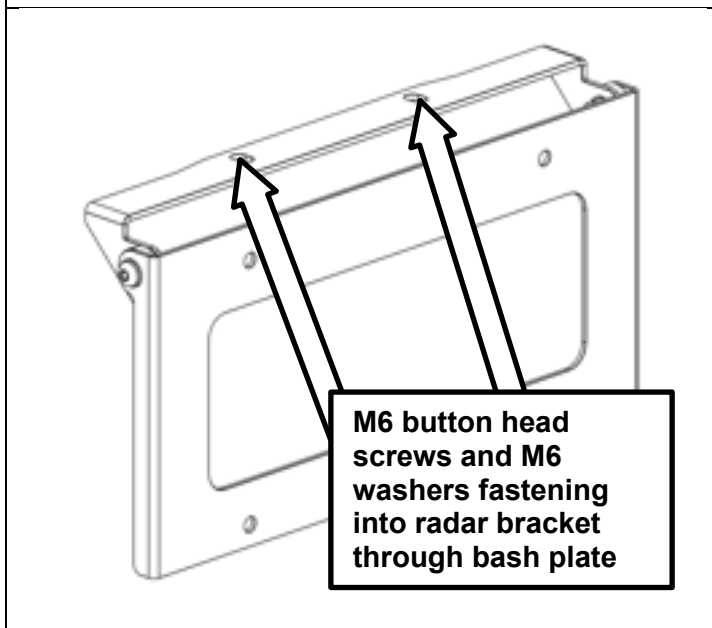
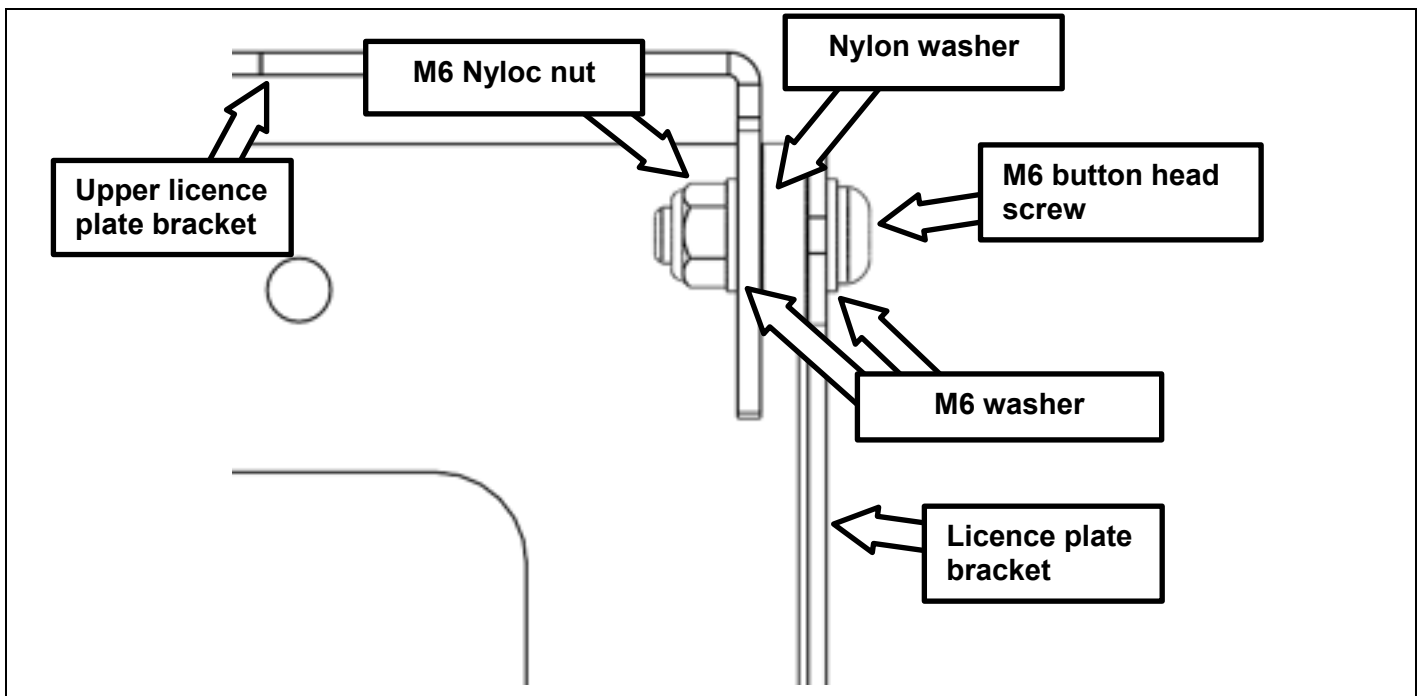

71. Assemble flip up licence plate bracket using two M6 button head screws, two M6 Nyloc nuts, two nylon spacers and four M6 washers. Tighten until firm but can still rotate.
72. Fit licence plate bracket to bash plate, using two M6 button head screws and two M6 washers **fastening into the radar bracket**. Torque to spec.

 M6 – 7lbft (9 Nm)



73. Fit fog lights removed in step 16 to bash plate using eight 10G silver screws. Light units are marked LHS and RHS. Adjust to ensure light is centred in aperture before tightening.  
Fit remaining sensor housings from step 42.



74. Place the dressed bash plate on the vehicle.

**NOTE:** Be careful not to scratch the powder coat on the bar or bash plate in the areas shown.

75. Plug in radar, parking sensors and fog lights.

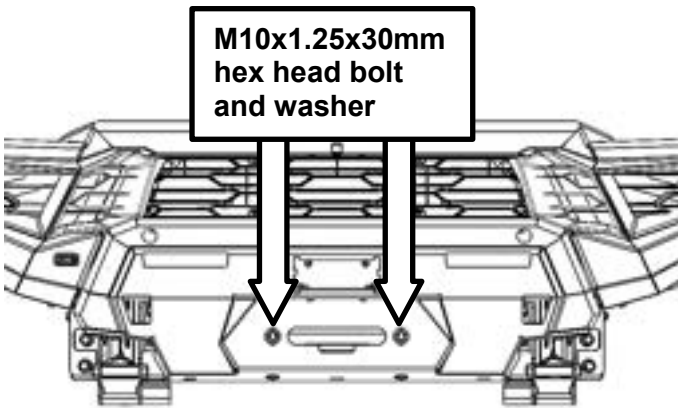

76. Fit two M10x1.5x30 bolts and two 4mm M10 washers to secure the bash plate to the winch cradle. Leave fasteners loose.

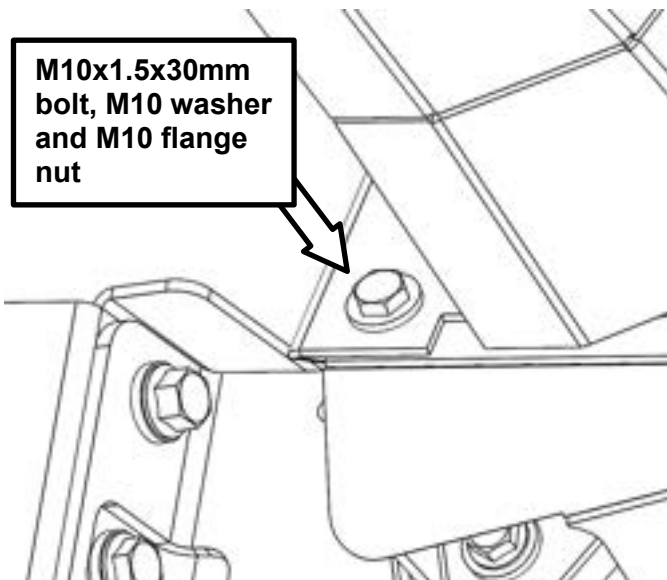

77. Fit two M10x1.5x20 flange bolts, two M10 washers and two M10 flange nuts to secure bash plate. Leave fasteners loose.

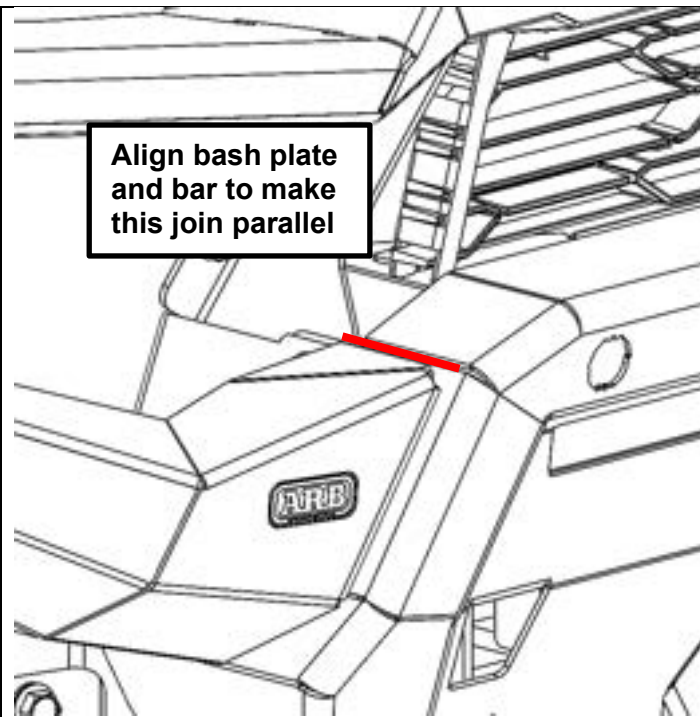

78. Align bash plate to bar, specifically with where it interfaces with the wings of the bar. The edge of the bash plate lines up parallel with the adjacent edge of the bar. Torque bash plate and winch cradle fasteners (qty 6) to spec.

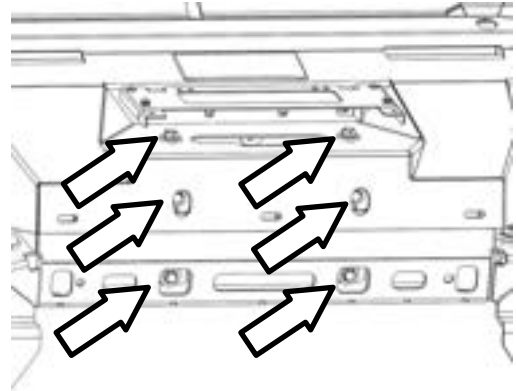

79. Torque two remaining M10 bolts on sides of bash plate to spec.

 M10 – 32lbft (44 Nm)

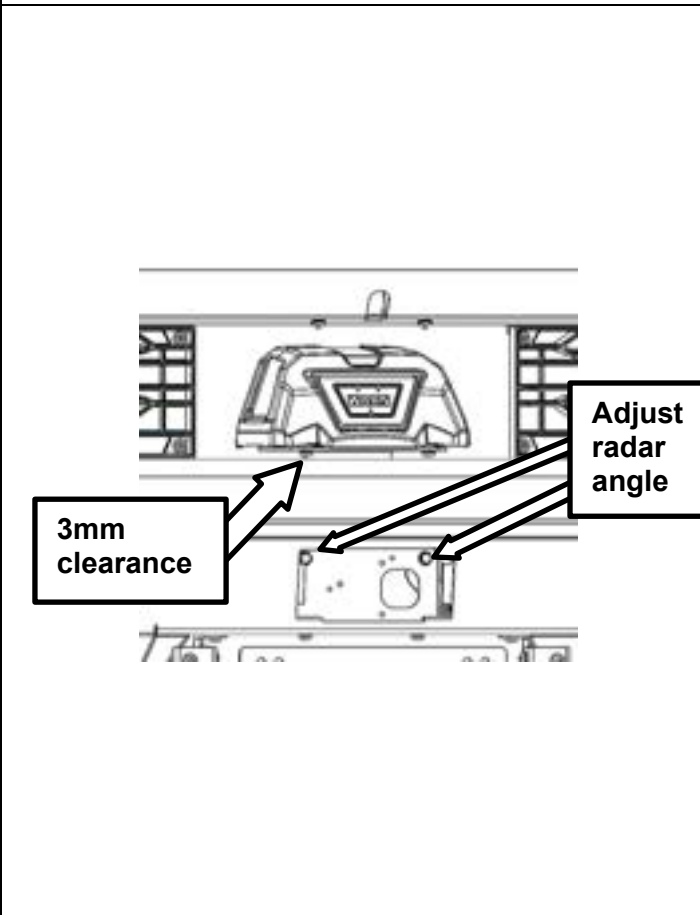

80. Place a digital level on the front face of the radar. The front face should be 90 degrees to level ground with a tolerance of  $\pm 1$  degree. Turn the two adjustment bolts evenly to alter the angle of the radar module to fall within this tolerance.

81. If fitted, move winch control box bracket down, allowing 3mm clearance from the control box fasteners to the bash plate. Torque M8 bracket bolts to spec.

 M8 – 16lbft (22 Nm)

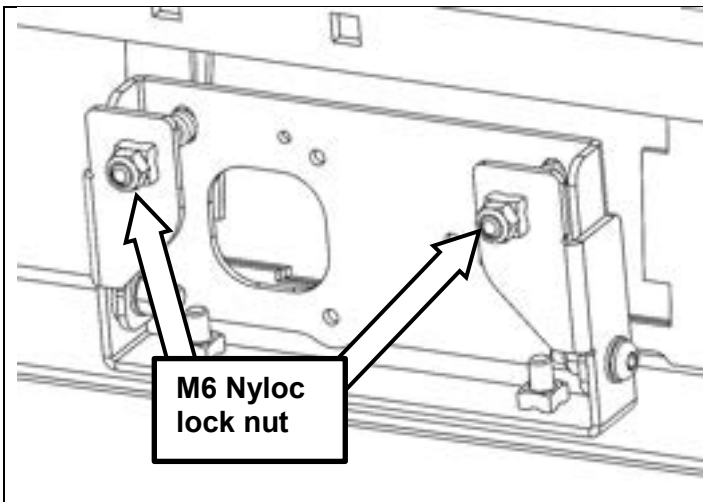

82. Lock the radar adjustment in position with two M6 Nyloc nuts tightened against the radar bracket as shown. Hold adjustment bolts in place when tightening. Torque to spec

 M6 – 7lbf (9 Nm)

83. Clip radar cover into aperture in bash plate. Make sure clips fully engage.



**RHS SHOWN**

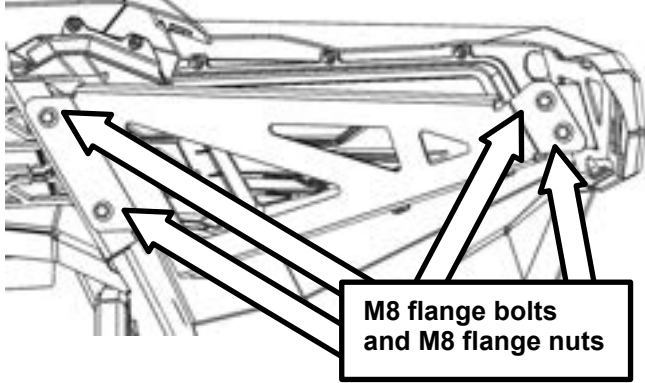

84. Fit wing braces to bar using eight M8 flange bolts and eight M8 flange nuts. Torque to spec.

 **M8 – 16lbft (22 Nm)**

**RHS SHOWN**

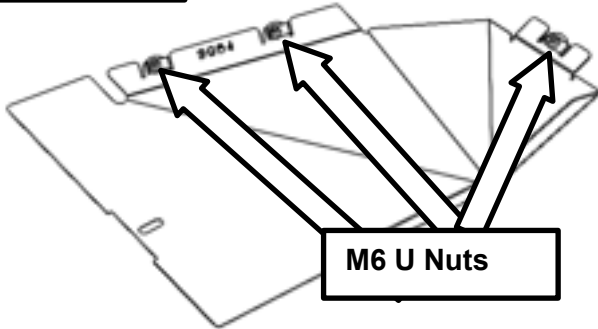

85. Fit M6 U nuts to both under panels as shown, six total.



86. Place the RH under panel in position while tucking the wheel liner in place.

Repeat for other side.



**RHS SHOWN**

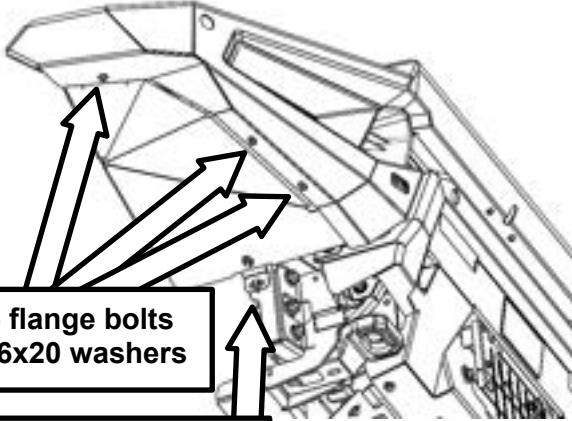

**M6x25 flange bolts and M6x20 washers**

**M8 bolts, M8 flange nuts and wing panel bracket**

87. Secure the RH wing under panel using three M6 flange bolts, three M6x20 washers, two M8 bolts, two M8 flange nuts and two wing panel brackets. Torque to spec.

**Wing panel bracket:**



Repeat for other side.

 M6 – 7lbft (9 Nm)

 M8 – 16lbft (22 Nm)

88. Remove front two bolts from factory under panel. Fit Zenith stone tray on top, securing with M8 bolts spaced downward by EPDM washers. Secure with further six M8 bolts and the stone tray bracket to the bash plate. Leave fasteners finger tight until all fasteners installed. Torque to spec.



**M8 Bolts and M8 EPDM Washers**

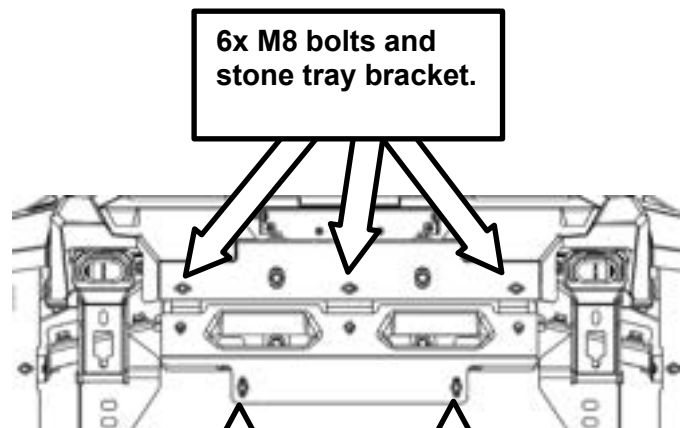

**6x M8 bolts and stone tray bracket.**

**2x M8 bolts + 2x EPDM washers**

 M8 – 16lbft (22 Nm)

**NOTE:** If fitting Zenith bar in conjunction with ARB Under Vehicle Protection (UVP), discard EPDM washers and fit stone tray between chassis cross-member and UVP front panel.

## FITTED PRODUCT

### NOTICE: ONCE ZENITH BAR IS FITTED:

- ◆ Ensure all bolts are tensioned correctly.
- ◆ All wiring is clear of sharp edges or moving surfaces and secured properly.
- ◆ Piping is secured well away from sharp or moving components.
- ◆ Check operation of winch, if fitted.
- ◆ Check all wiring and connections to sensors, camera and radar are functioning correctly.
- ◆ Misalignment of parking sensor to hole in bull bar may cause malfunction, if fitted.
- ◆ If fitted, test operation of parking sensors after fitment.

